

COORDINATE POINTS			
NO.	COORDINATES		ELEV.
	NORTHING	EASTING	
140	10 934.2	9 129.9	33.7
141	10 941.2	9 153.2	31.4
142	10 913.8	9 210.7	24.9
143	10 899.2	9 217.5	24.4
144	10 848.1	9 158.7	33.8

TEMPORARY BENCHMARKS				
NO.	COORDINATES		ELEV.	DESCRIPTION
	NORTHING	EASTING		
6	10 855.427	9 167.072	33.087	REBAR

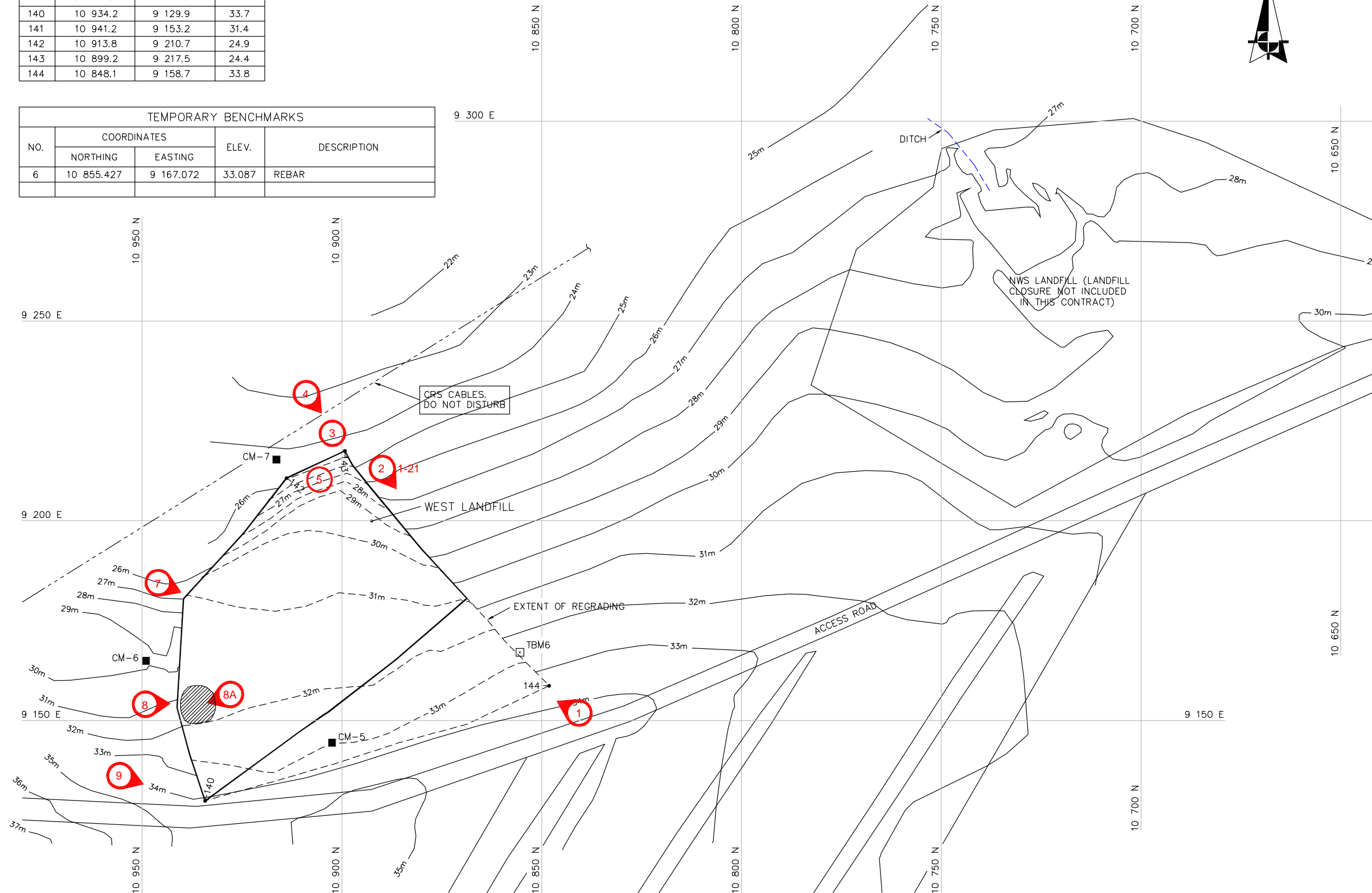

- LEGEND:**
- TBM6 □ TEMPORARY BENCHMARK
  - 140 • COORDINATE POINT
  - MONITORING SOIL SAMPLE LOCATION
  - ③ PHOTOGRAPH NUMBER AND LOCATION ( 3 = WLF3)
  - ⊘ LOCALIZED DEPRESSION

DATA SOURCES:  
DRAWING BY UMA  
CM-RD05.DWG  
DATED: 02/04/10  
DEW LINE CLEAN UP  
LANDFILL MONITORING PLAN  
CAM-M - CAMBRIDGE BAY  
WEST LANDFILL AND NWS LANDFILL FIGURE  
CAM-M.5

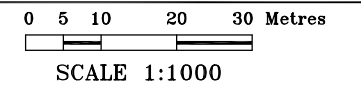

REVIEWED BY : DL/AK  
PREPARED BY : PW/NT0  
DATE ISSUED : OCTOBER, 2005  
PROJECT NO. : 50-714  
FILE NAME : 50714-1B-04.dwg  
REVISION : 0

Project: DEW Line Monitoring  
Location: Cambridge Bay, Nunavut  
Client: Defence Construction Canada

**WEST LANDFILL AND  
NWS LANDFILL**

Path: S:\AutoCad\acad-Prj\2005\50-714 DEW Cambridge\1B-Draft-Oct2005\ Plotted on: Oct 21, 2005-3:11pm Edited by: Public