

GENERAL NOTES:

1. ALL COORDINATES ARE REFERENCED TO NAD 83, UTM ZONE 17 N. BASED ON CM1 AND CM2.
2. SITE PLANS AND TOPOGRAPHIC INFORMATION ARE BASED ON AIR PHOTOS AND SURVEYS. CURRENT CONDITIONS MAY NOT BE EXACTLY AS SHOWN.
3. BORROW AREA INFORMATION AND TEST PIT LOCATIONS AS SHOWN ON THE DRAWINGS HAVE BEEN PROVIDED BY EBA ENGINEERING CONSULTANTS LTD.
4. INFORMATION REGARDING DELINEATION AND ANALYTICAL TESTING OF CONTAMINATED SOIL AREAS HAS BEEN PROVIDED BY EARTHTECH CANADA INC.
5. KEY TRENCH 1.0m BELOW EXISTING GROUND. EXCAVATION DEPTH TO BE FIELD CONFIRMED BY THE SITE ENGINEER, BASED ON THE PRESENCE OF SATURATED GROUND.
6. ALL SURFACE DEBRIS IS TO BE REMOVED FROM ALL CONTAMINATED SOIL AREAS AND EXISTING AND NEW LANDFILL AREAS PRIOR TO ANY FILL PLACEMENT OR EXCAVATION TAKING PLACE.
7. FOR GROUND TEMPERATURE CABLE INSTALLATION DETAILS, SEE DWG. C12. EXACT LOCATIONS TO BE FIELD DETERMINED BY THE ENGINEER.

LEGEND:

- 235m 2004 CONTOURS
- COORDINATE POINT
- VERTICAL GROUND TEMPERATURE CABLE INSTALLATION (4)

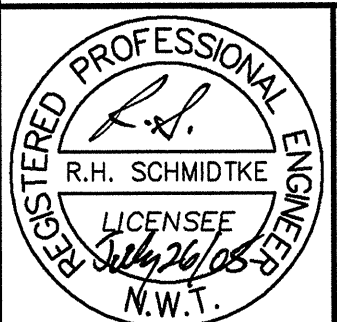

THE ASSOCIATION OF
PROFESSIONAL ENGINEERS,
GEOLOGISTS AND GEOPHYSICISTS
OF THE NORTHWEST TERRITORIES
PERMIT NUMBER
P 007
UMA ENGINEERING
LTD.

uma
An AECOM Company

0	ISSUED FOR CONSTRUCTION	05/07/25
REVISIONS	DESCRIPTION	DATE

A	A detail number number du detail	A
B	B source drawing no. de dessin no.	B
C	C detail on drawing no. detail sur dessin no.	C

project title titre du projet

**CAM-F Intermediate DEW Line Site
SARCPA LAKE
Site Restoration**

Nunavut

drawing title titre du dessin

**SECURE SOIL DISPOSAL FACILITY
KEY TRENCH EXCAVATION PLAN &
GRADING / INSTRUMENTATION PLAN**

designed by T. JACKLIN conceu par

drawn by D. JENSEN dessine par

approved by R. SCHMIDTKE approuve par

PIWGSC Project Manager J. BUCHKO Administrateur de Projets TPISGC

scale AS SHOWN echelle sheet 12 feuille

project no. 413334 projet no. C07

date FEBRUARY, 2005 date OF 12

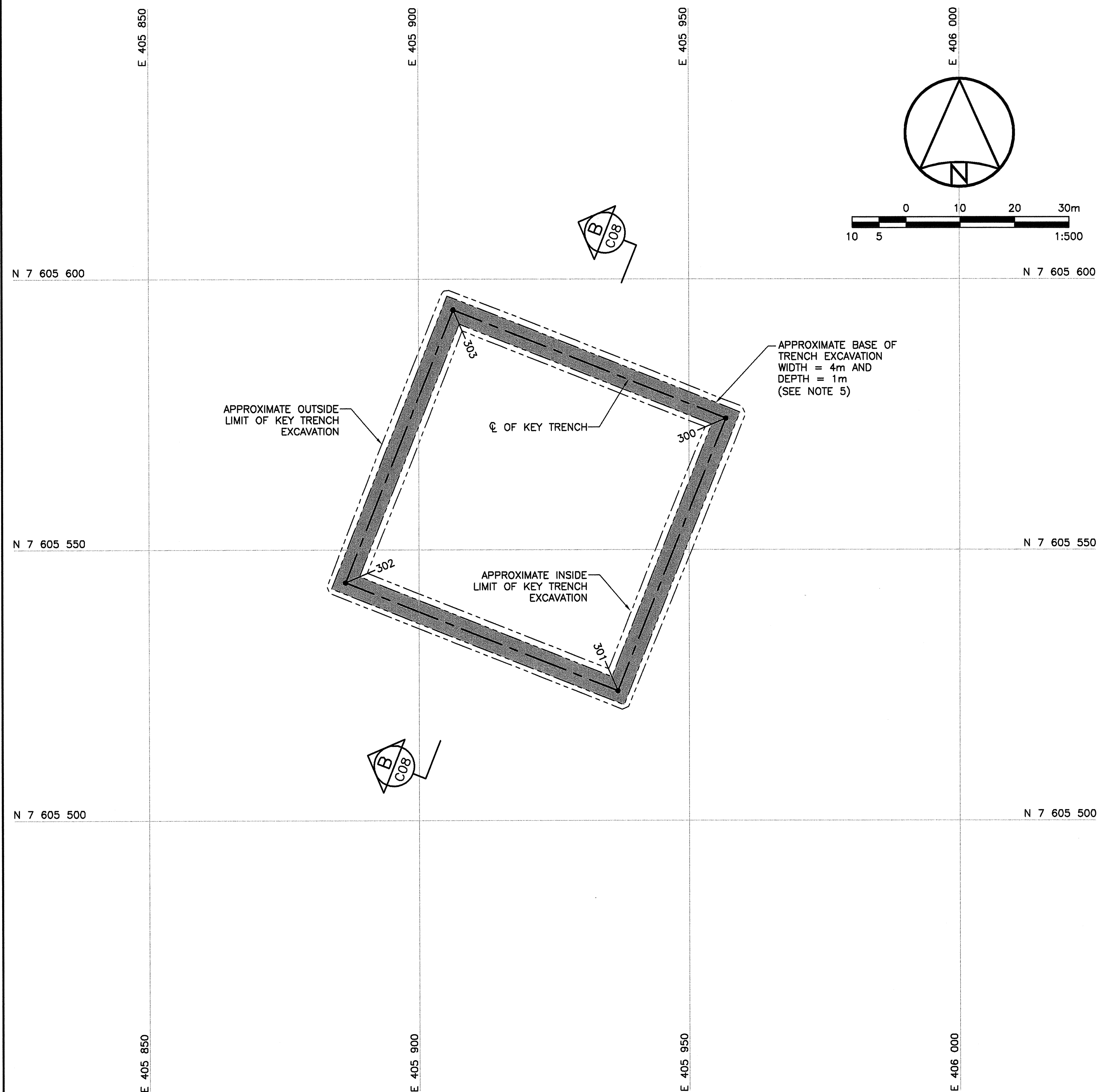

KEY TRENCH EXCAVATION PLAN

COORDINATE POINTS KEY TRENCH EXCAVATION		
NO.	NORTHING	EASTING
300	7 605 574.3	405 956.7
301	7 605 523.9	405 936.7
302	7 605 543.9	405 886.3
303	7 605 594.3	405 906.4

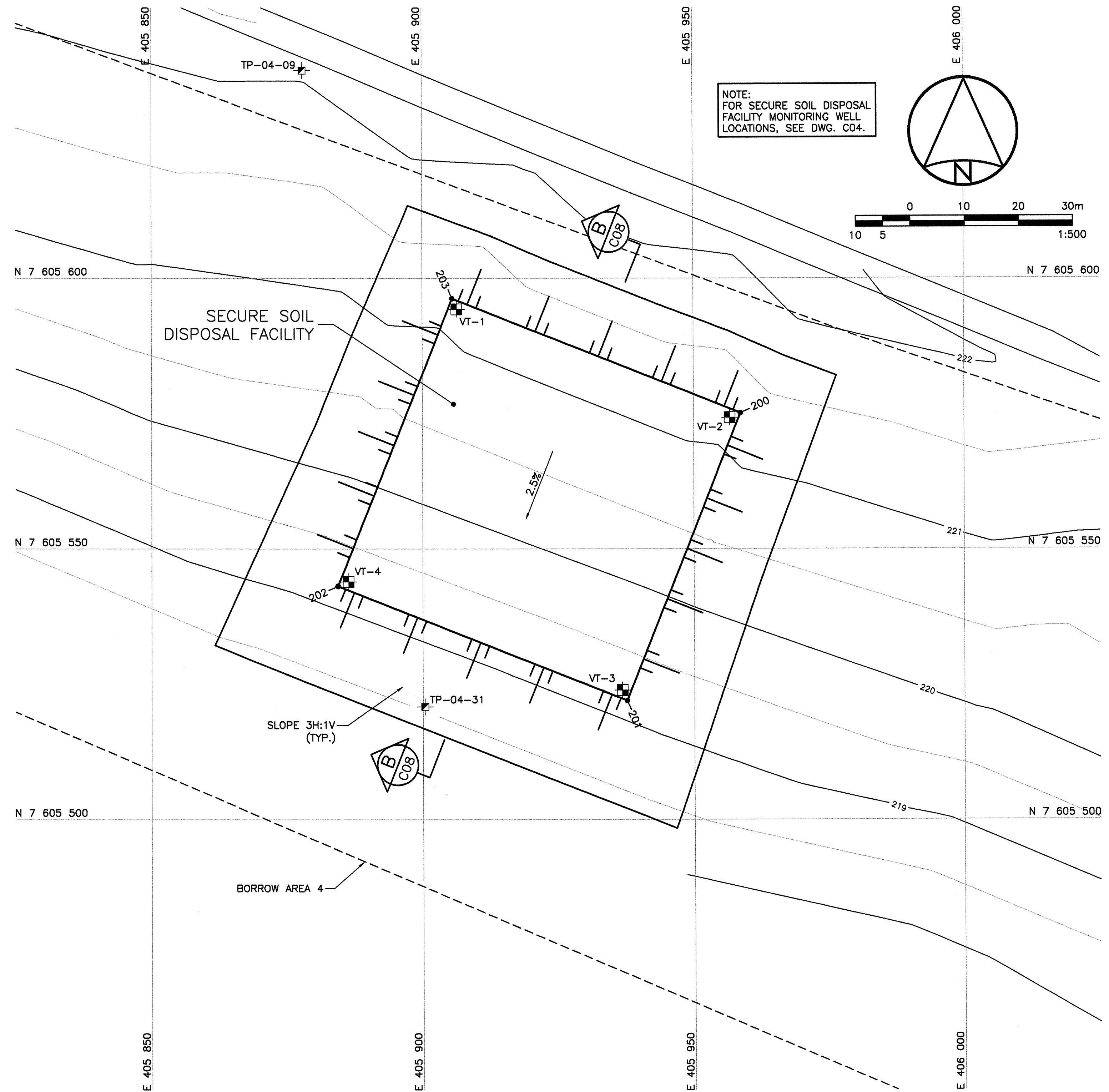

GRADING/INSTRUMENTATION PLAN

COORDINATE POINTS SECURE SOIL DISPOSAL FACILITY			
NO.	NORTHING	EASTING	ELEV.
200	7 605 575.1	405 958.7	226.03
201	7 605 521.9	405 937.6	224.57
202	7 605 543.1	405 884.4	224.60
203	7 605 596.2	405 905.5	226.03