

Sheet Size: B1 (1000mm x 707mm)

PLOT: Monday, March 03, 2008 5:32:21 PM

Saved by: Hassler, Brad

UMA FILE NO.: 416837-C08.DWG

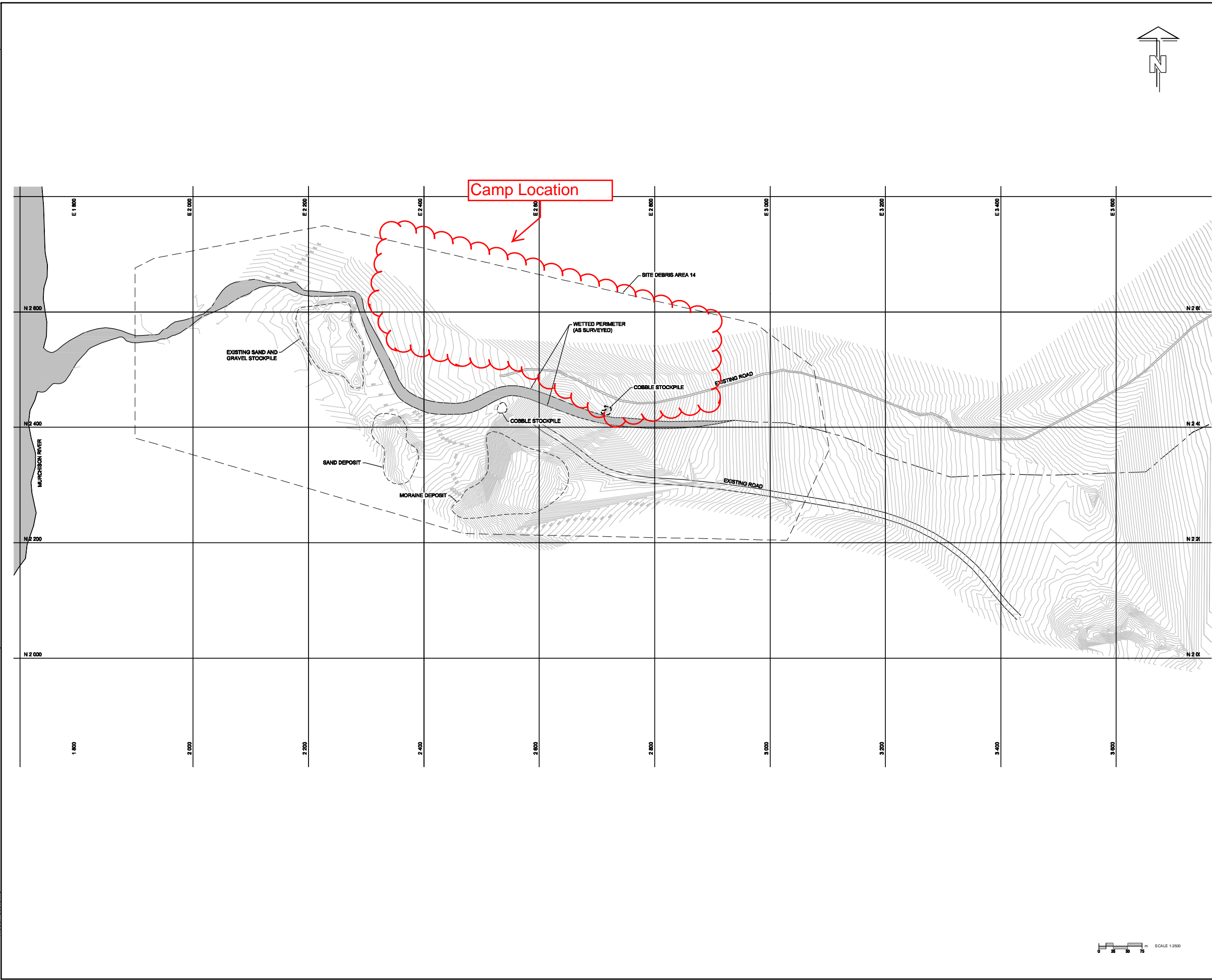

0 25 50 75 m SCALE 1:2500



Public Works and
Government Services
Canada

Travaux publics et
Services gouvernementaux
Canada

REAL PROPERTY SERVICES
Western Region

Client



Indian and Northern
Affairs Canada

Affaires indiennes
et du Nord Canada

Canada

NUNAVUT REGIONAL OFFICE
IQUALUIT, NUNAVUT

Client

Client

PRELIMINARY NOT FOR CONSTRUCTION

GENERAL NOTES:

1. ALL DIMENSIONS ARE IN METRES UNLESS NOTED OTHERWISE.
2. SITE PLANS AND TOPOGRAPHIC INFORMATION ARE BASED ON AIR PHOTOS AND SURVEY PROVIDED BY EARTH TECH AND INAC. CURRENT CONDITIONS MAY NOT BE EXACTLY AS SHOWN.
3. ALL COORDINATES ARE SITE COORDINATES AND ALL ELEVATIONS ARE BASED ON SITE DATUM.

LEGEND:



BODY OF WATER



WATERWAY / DRAINAGE

UMA | AECOM

REVISIONS	DESCRIPTION	DATE
D	ISSUED FOR TENDER	08/03/03
C	ISSUED FOR 99% REVIEW	08/02/14
B	ISSUED FOR 80% REVIEW	08/01/18
A	ISSUED FOR 75% REVIEW	07/11/30

A	A detail number number du detail	A
C	B source drawing no. de dessin no.	B/C
	C detail on drawing no. detail sur dessin no.	

project title
**CAM-D
REMEDATION PROJECT**
titre du projet

drawing title
**AREA 7
BORROW AREA 2**
titre du dessin

designed by
T. ESHPETER
conçu par

drawn by
B. HASSLER
dessiné par

approved by
R. SCHMIDTKE
approuvé par

PM/SC Project Manager
M. McELWANE
Administrateur de Projets TPSSC

scale
1:2500
échelle

project no.
416837
projet no.

date
MARCH, 2008
date

416837-C08