

C:\01_SITES\Hope Bay\ICT022000.320_2014_Doris_Annual_Inspection\IC0009_066-GT09-3-Figure 5.dwg

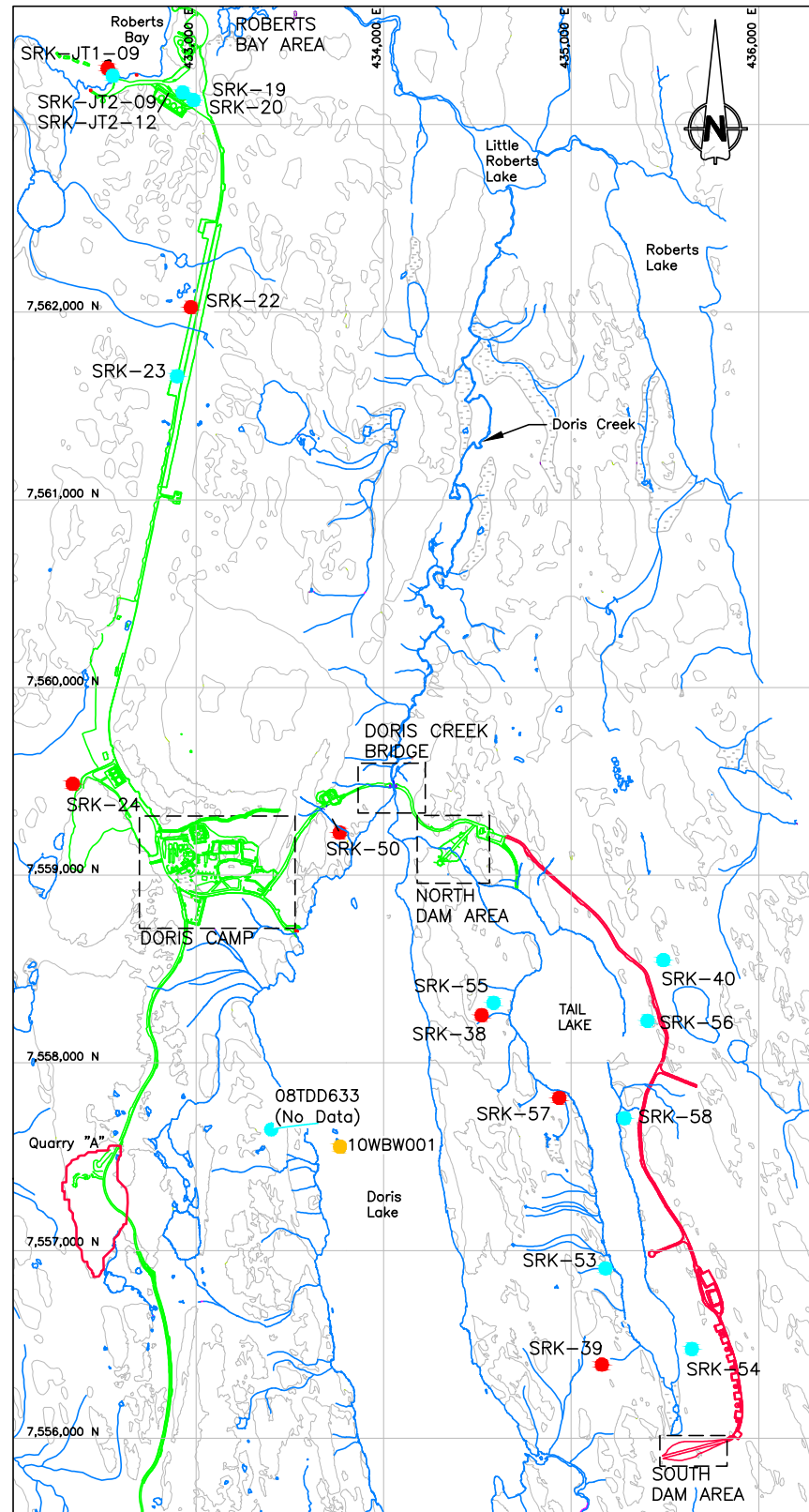

DORIS NORTH OVERVIEW

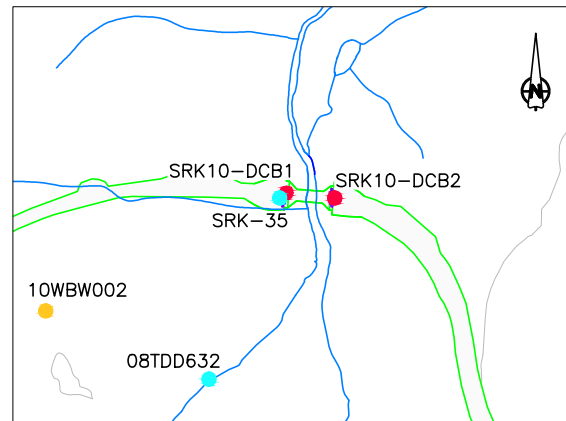

DORIS CREEK BRIDGE

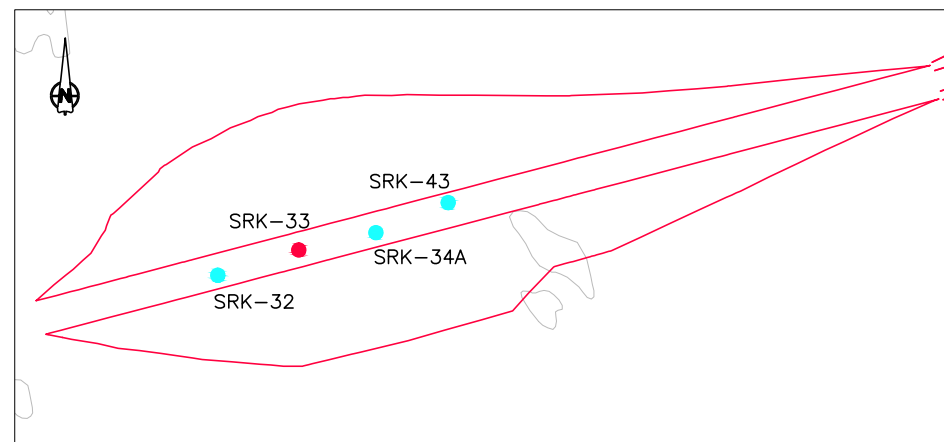

SOUTH DAM AREA

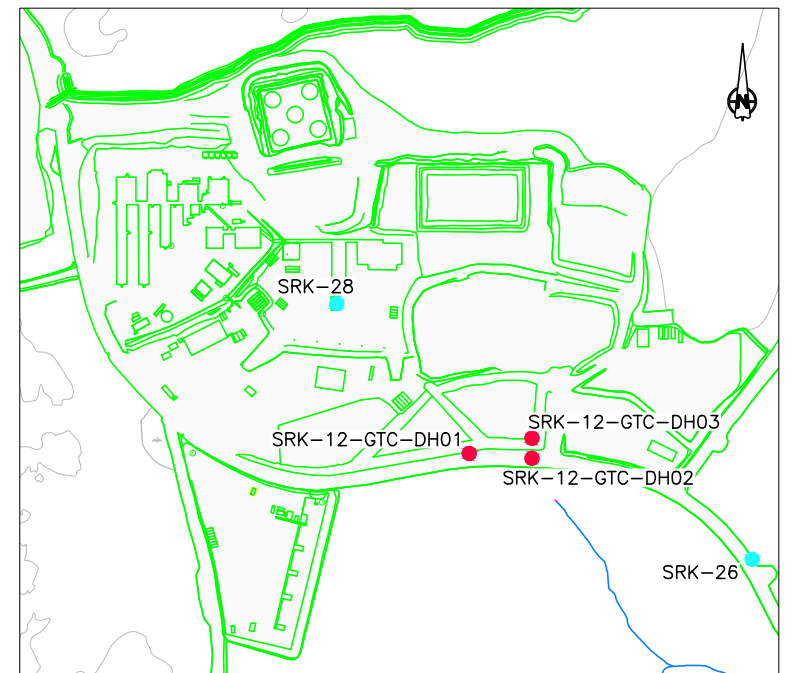

DORIS CAMP

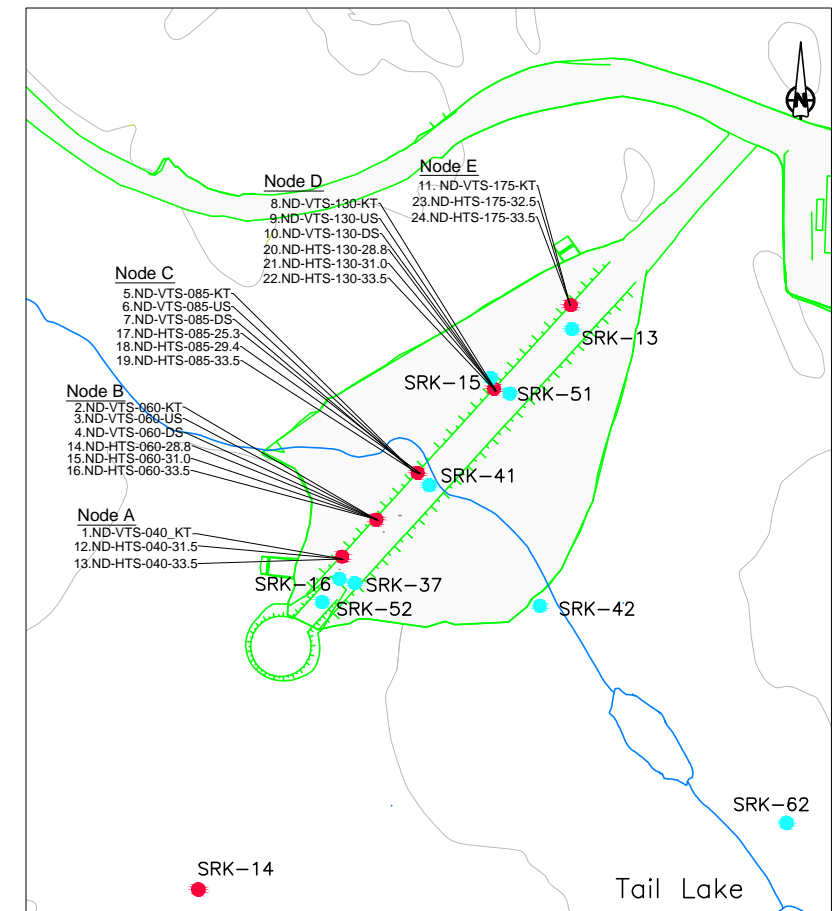

NORTH DAM AREA

LEGEND

- Active Thermistor Installation
- Inactive Thermistor Installation
- Status Unknown
- Westbay Wells
- Asbuilt
- Licensed but not yet Constructed



SRK JOB NO.: 1CT022.000

FILE NAME: 1CH008_066-GT09-3-Figure 5.dwg



HOPE BAY MINING LTD.

2014 Geotechnical Inspection

Thermistor Locations

DATE: Oct. 2014 APPROVED: EMR FIGURE: 5

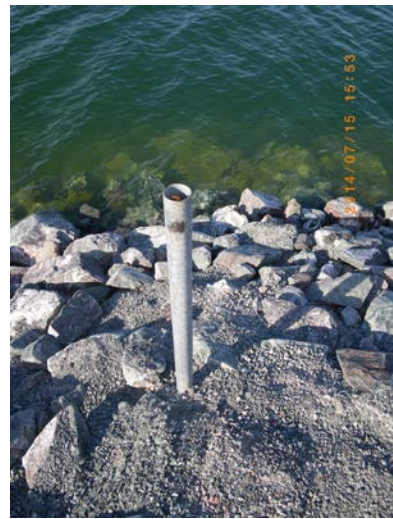

Survey monument 1500 on east end of jetty



East side of Jetty - looking south



Settlement/Pothole along west edge of Jetty – looking south



Survey monument 1501 on west end of the jetty

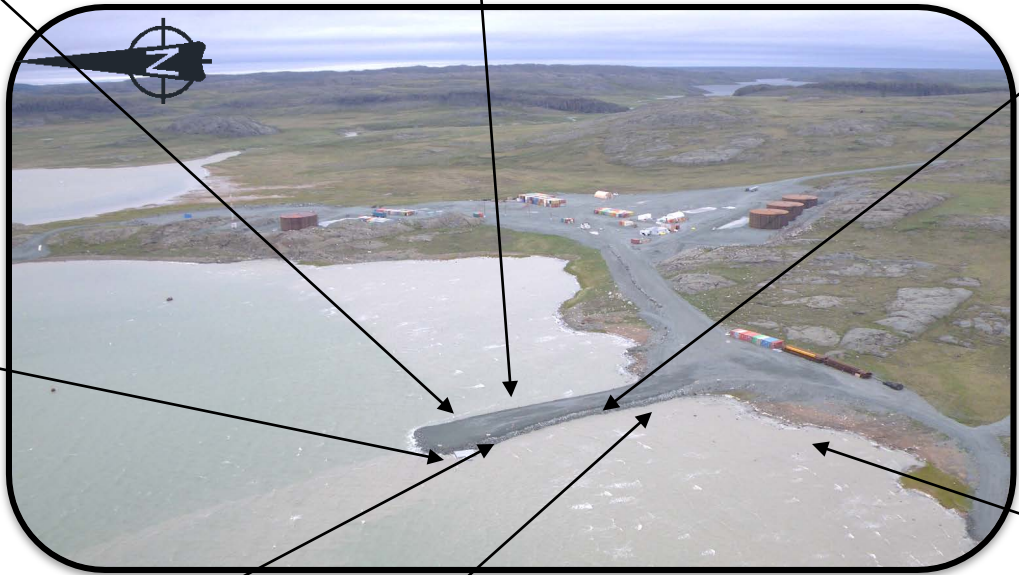

Western shoreline - looking southwest



Condition of thermistor cable SRK-JT1-09 – looking north



West side of jetty looking north, thermistor string SRK-JT-12 in foreground

			2014 Geotechnical Inspection	
	HOPE BAY MINING LTD.		Jetty and Shoreline Laydown Area	
Job No: 1CT022.001 Filename: 2014GeotechInsp_rev00.pptx	Date: Oct 2014	Approved: LW	Figure: 6	



Laydown area within Quarry #1 Tank Farm – looking southeast



East end of Quarry #1 laydown – looking southeast



West high wall of the Quarry #1 Tank Farm with the fuel transfer pipes disconnected – looking west

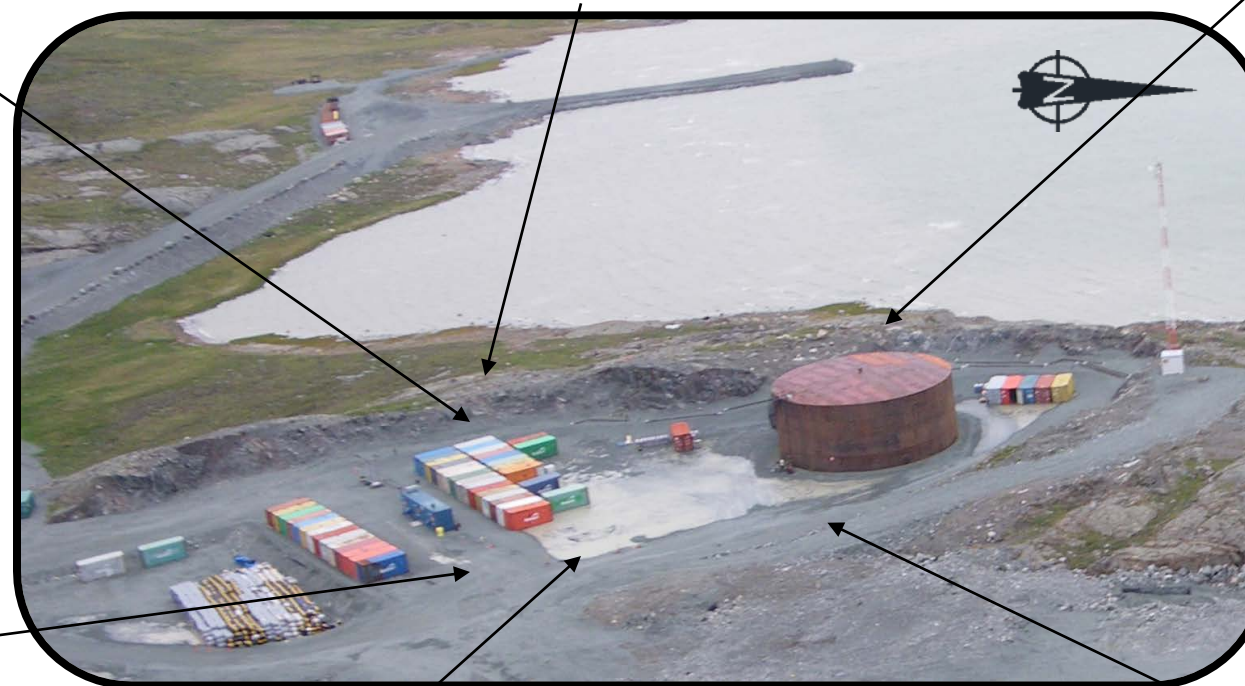

Condition of the decommissioned fuel transfer station – looking west from the access ramp into Quarry #1



Water ponding at the sump next to the access ramp into Quarry #1 Tank Farm – looking west



Southeast corner of Quarry #1 Tank Farm access ramp – looking northwest at the radio tower



Job No: 1CT022.001
Filename: 2014GeotechInsp_rev00.pptx



HOPE BAY MINING LTD.

2014 Geotechnical Inspection

Roberts Bay Quarry #1 5 ML Tank Farm

Date: Oct 2014	Approved: LW	Figure: 7
-------------------	-----------------	---------------------



Exposed liner and grounding cable along the containment berm behind Tank #1 – looking northwest



Condition of the rock bolts securing the mesh on high wall – looking down from above Tank #1



Mesh on high wall protecting the fuel tanks from falling rock – looking up from Tank #2



Tension cracks along the berm below the highwall – looking north from Tank #2



Exposed liner along the containment berm behind Tank #1

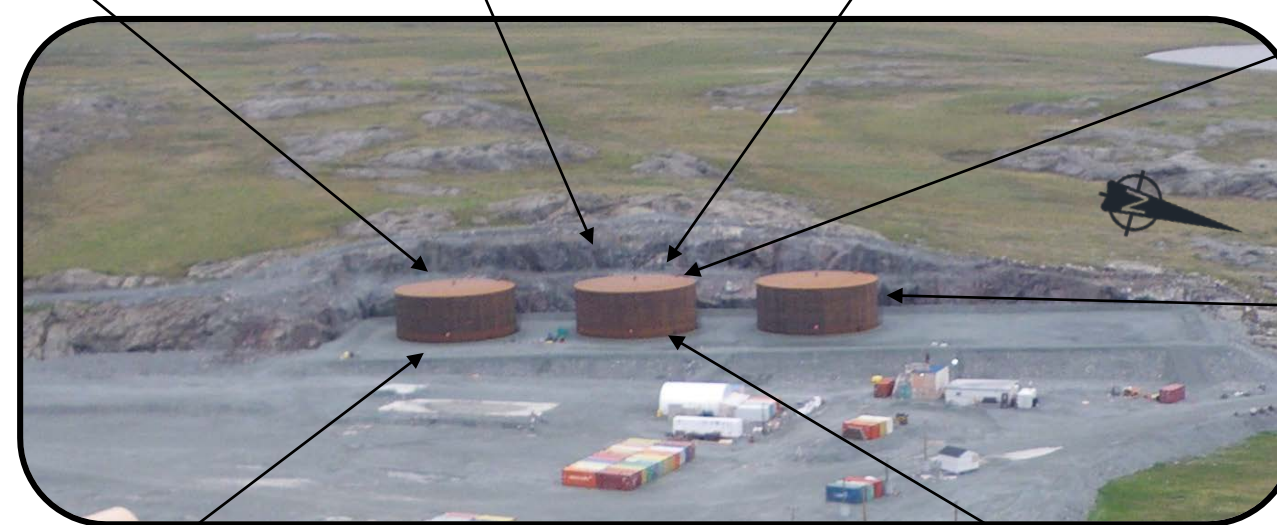

There has been vehicle traffic behind Tank #3. The condition of the liner is unknown – looking southeast



Erosion of Tank #1 pedestal due to snow and water



The sump east of the fuel tanks. The area surrounding the sump is covered with fine sediments – looking south towards the access ramp



Job No: 1CT022.001
Filename: 2014GeotechInsp_rev00.pptx



HOPE BAY MINING LTD.

2014 Geotechnical Inspection

Roberts Bay 20 ML Tank Farm

Date: Oct 2014	Approved: LW	Figure: 8
-------------------	-----------------	--------------



Looking along the east side of the laydown area – looking north towards Quarry #1 Fuel Tank Farm



Swampy areas to the east of the laydown area – looking north



Looking along the west edge of the laydown area – looking south towards the Primary Road

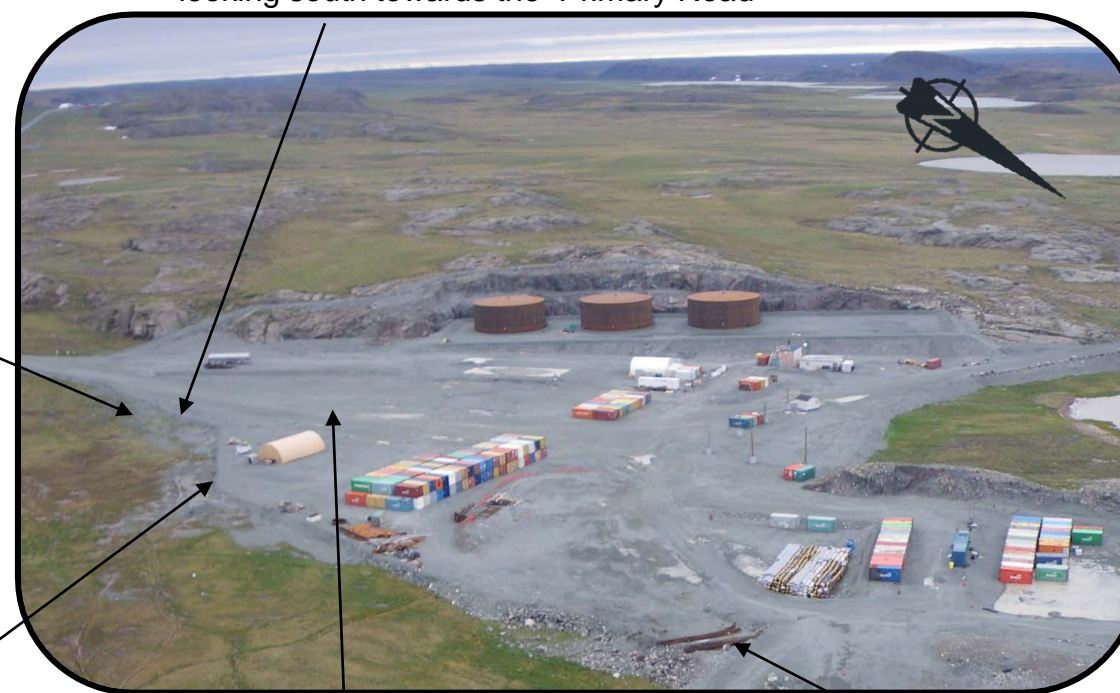

Oblique view of laydown area – looking northwest towards the Quarry #1 Fuel Tank Farm



Northeast end of the laydown area with fuel transfer road in the background



Laydown area – looking north

		2014 Geotechnical Inspection		
		Roberts Bay Laydown Area		
Job No: 1CT022.001 Filename: 2014GeotechInsp_rev00.pptx	HOPE BAY MINING LTD.	Date: Oct 2014	Approved: LW	Figure: 9



General condition of the Overburden Dump surface
- looking northwest



Oblique view of overburden dump – looking southeast
from the Roberts Bay Fuel Transfer Access Road



Tension cracks along the crest of the turn-a-round



Sink holes at the entrance of the Overburden Dump



Oblique view of the Fuel Transfer Access Road –
looking east from Roberts Bay

 Job No: 1CT022.001 Filename: 2014GeotechInsp_rev00.pptx	 HOPE BAY MINING LTD.	2014 Geotechnical Inspection		
		Roberts Bay Overburden Dump Area and Fuel Transfer Access Road		
		Date: Oct 2014	Approved: LW	Figure: 10



Tension cracks near south corner of the north apron behind the flight tower – looking north



Tension cracks near south corner of the north apron behind the flight tower – looking north



Aerial view of north apron – looking northwest



General surface condition of the South Apron – looking north

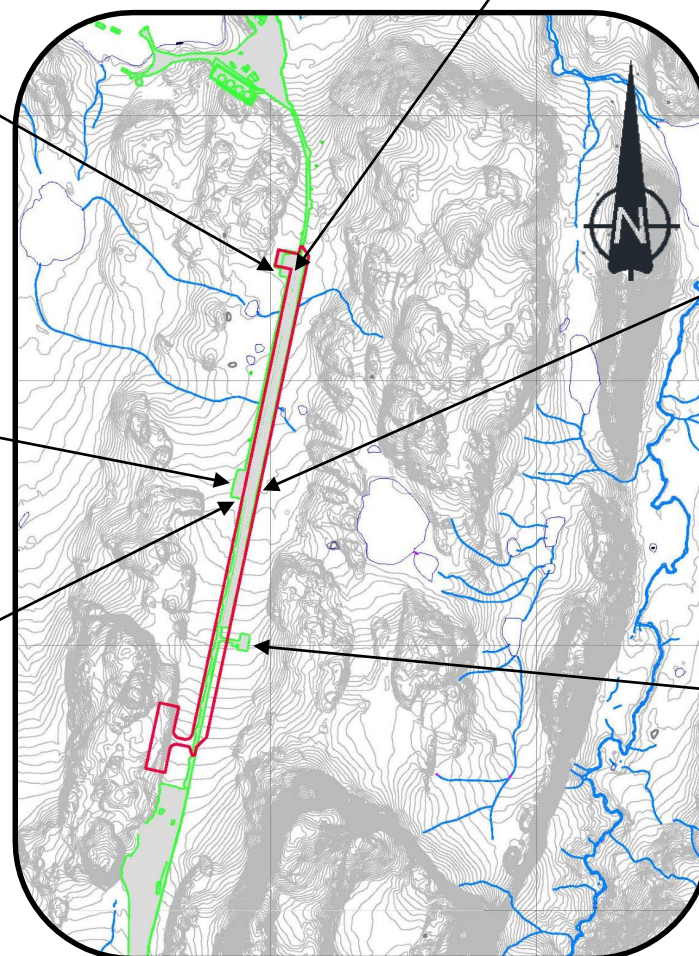



East side of airstrip – looking north



Tension cracks along the crest of the east side of the Wash Bay / Explosives Mixing Plant Pad



Aerial view of south apron – looking northwest

		2014 Geotechnical Inspection		
		Airstrip		
Job No: 1CT022.001	HOPE BAY MINING LTD.	Date: Oct 2014	Approved: LW	Figure: 11
Filename: 2014GeotechInsp_rev00.pptx				



Aerial view of the Upper Reagent Pad – looking west

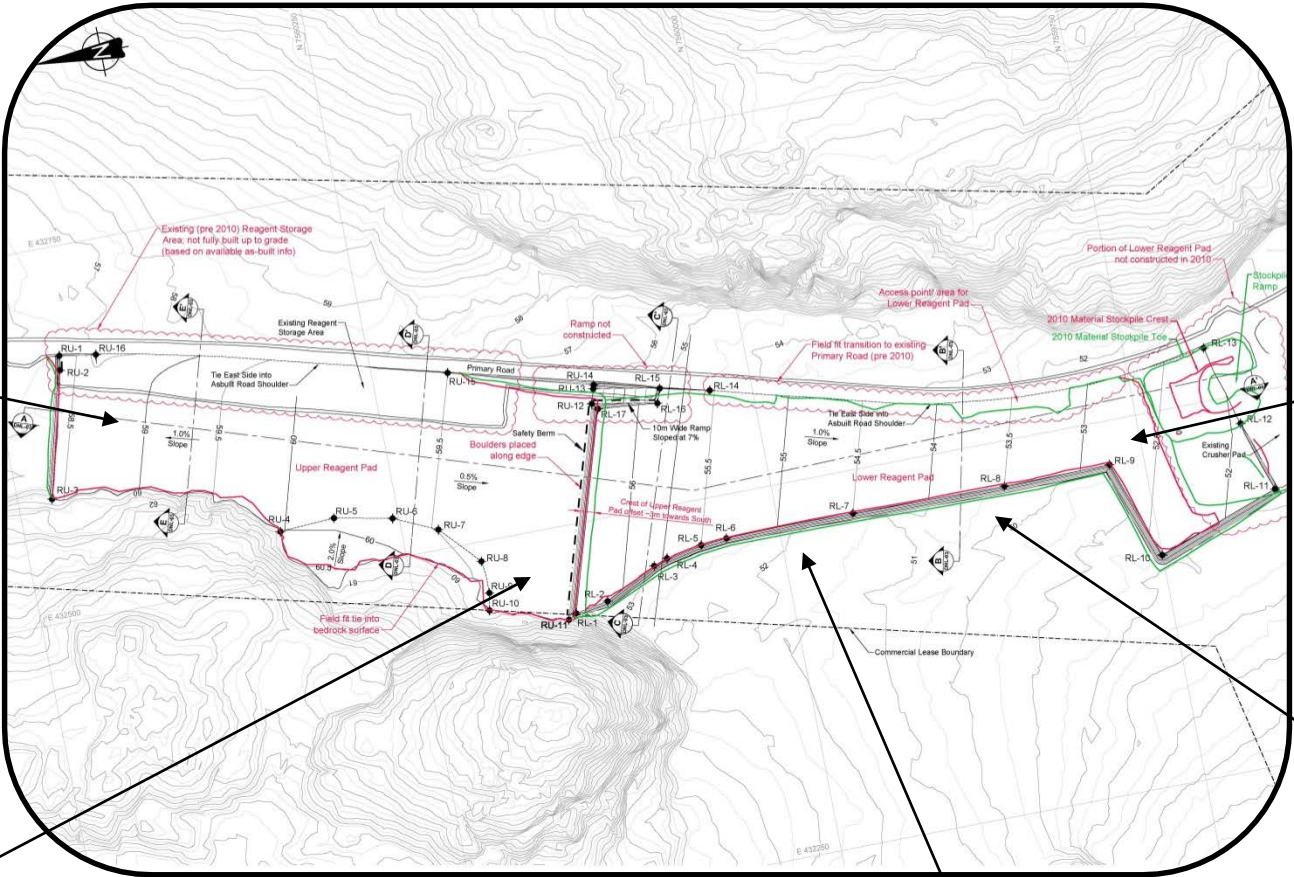

Aerial view of the Lower Reagent and Batch Plant Pads – looking west



Exposed geotextile along the perimeter of the AN Storage area in the southwest corner of the Upper Reagent Pad



Seacans located on the Lower Reagent Pad – looking east



Condition of the west edge of Lower Reagent Pad – looking north