



North Dam Weekly Walkover Survey Report

Date:	May 9, 2015
Inspected By:	Claire Brown
Conditions:	(ie. snow on ground, clear) Snow covered. Significant drifts.

Visual Inspection:

This weekly walkover survey report is a means to track the condition on the North Dam, please provide details on changes that have developed since the previous inspection and/or any observations of particular concern. All photos are appreciated. Please send the completed form (scans are fine) and any photos to hopebaymonitoring@srk.com and pluedke@srk.com

Upstream Side of Dam			
Any visible concerns? (cracks, depressions, erosion, etc.)	Yes	<input checked="" type="radio"/> No	
Downstream Side of Dam			
Any visible concerns? (cracks, depressions, erosion, seepage, etc.)	Yes	<input checked="" type="radio"/> No	
Crest of Dam			
Any visible concerns? (cracks, depressions, erosion, etc.)	Yes	<input checked="" type="radio"/> No	
Thermosyphons North Side			
Any visible concerns? (cracks, punctures, peeling paint, birds nests, etc.)	<input checked="" type="radio"/> A Yes	<input checked="" type="radio"/> No	
Thermosyphons South Side			
Any visible concerns? (cracks, punctures, peeling paint, birds nests, etc.)	<input checked="" type="radio"/> A Yes	<input checked="" type="radio"/> No	
Instrumentation (on crest and downstream side)			
Any visible concerns? (bent, rusted, cracked, etc.)	Yes	<input checked="" type="radio"/> No	
Thermistors and Dataloggers			
Any visible concerns? (frayed or cut cables, damaged boxes, etc.)	Yes	<input checked="" type="radio"/> No	
Suspended Sediment in TIA (When not frozen)			
Any suspended sediment in Tail Lake?	NA <input checked="" type="radio"/> B	Yes	No
<p>If you answered yes to any of the questions above please provide details and photos. Observations can be sketched on the figure provided on the next page. If seepage has been noted please estimate the flow.</p> <p><input checked="" type="radio"/> A Snow buildup on the upper portion of several thermistors. Will likely melt during daily temperature highs, but will inspect for additional buildup.</p> <p><input checked="" type="radio"/> B Frozen</p>			

Please provide any other observations you have made or items that did not fit in the space above



Photos:

Please collect the following photos:

Photo from north end looking south along the dam

Photo from south end looking north along the dam



Other photos, please describe

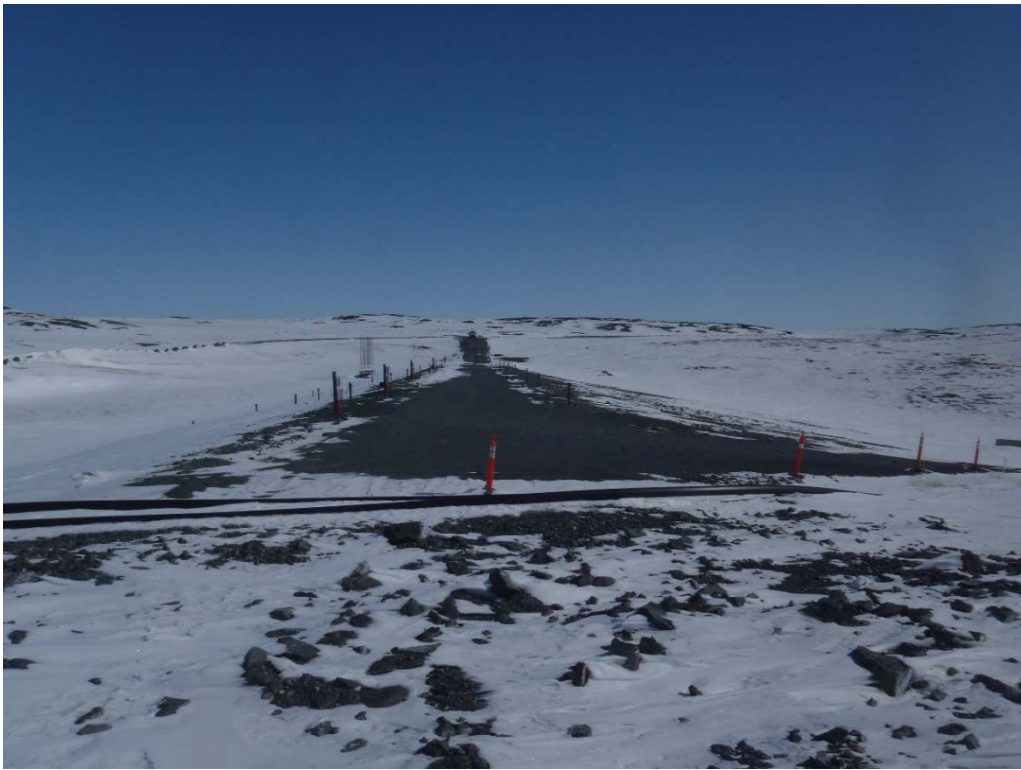

North Dam Weekly Walkover Survey Report

Date:	May 16, 2015
Inspected By:	SARAH WARNOCK
Conditions:	(ie. snow on ground, clear) Snow on ground, windy but clear

Visual Inspection:

This weekly walkover survey report is a means to track the condition on the North Dam, please provide details on changes that have developed since the previous inspection and/or any observations of particular concern. All photos are appreciated. Please send the completed form (scans are fine) and any photos to hopebaymonitoring@srk.com and pluedke@srk.com

Upstream Side of Dam		
Any visible concerns? (cracks, depressions, erosion, etc.)	PARTIALLY SNOW COVERED ② Yes	No
Downstream Side of Dam		
Any visible concerns? (cracks, depressions, erosion, seepage, etc.)	SNOW COVERED Yes	No
Crest of Dam		
Any visible concerns? (cracks, depressions, erosion, etc.)	Yes	No
Thermosyphons North Side		
Any visible concerns? (cracks, punctures, peeling paint, birds nests, etc.)	① Yes	No
Thermosyphons South Side		
Any visible concerns? (cracks, punctures, peeling paint, birds nests, etc.)	① Yes	No
Instrumentation (on crest and downstream side)		
Any visible concerns? (bent, rusted, cracked, etc.)	Yes	No
Thermistors and Dataloggers		
Any visible concerns? (frayed or cut cables, damaged boxes, etc.)	Yes	No
Suspended Sediment in TIA (When not frozen)		
Any suspended sediment in Tail Lake?	FROZEN Yes	No
<p>If you answered yes to any of the questions above please provide details and photos. Observations can be sketched on the figure provided on the next page. If seepage has been noted please estimate the flow.</p> <p>① Rust on joints of thermosyphon → previously noted in past inspections</p> <p>② Snow cover on u/s side. No visible issues in clean area</p>		

Please provide any other observations you have made or items that did not fit in the space above

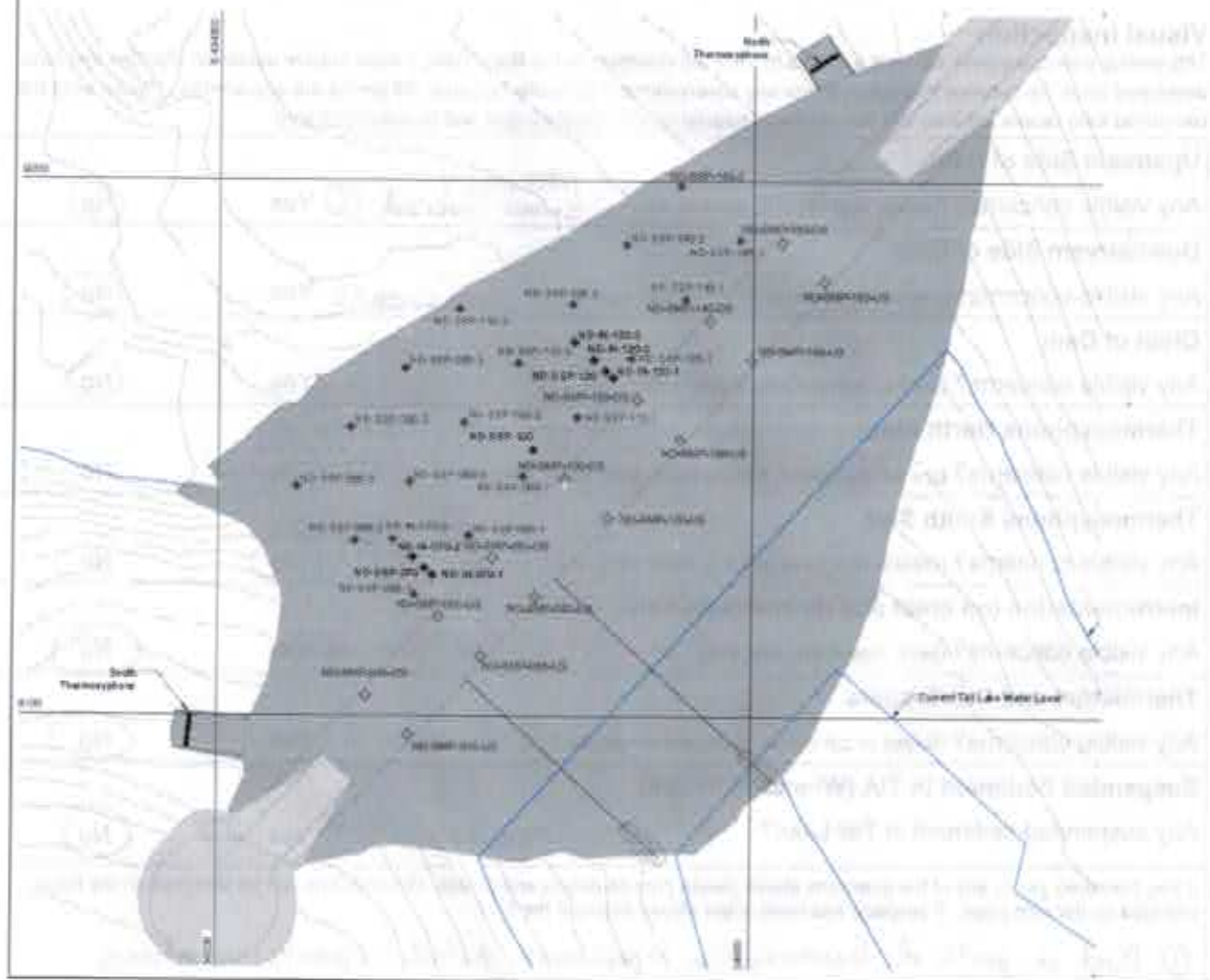

Photos:

Please collect the following photos:

Photo from north end looking south along the dam

Photo from south end looking north along the dam



Other photos, please describe

Rust on N4S thermographs.







North Dam Weekly Walkover Survey Report

Date:	MAY 24/2015
Inspected By:	SARAH WARNOCK
Conditions:	(ie. snow on ground, clear) Snow covering half on u/s slope ~50% covered Snow covering d/s slope ~75% covered

Visual Inspection:

This weekly walkover survey report is a means to track the condition on the North Dam, please provide details on changes that have developed since the previous inspection and/or any observations of particular concern. All photos are appreciated. Please send the completed form (scans are fine) and any photos to hopebaymonitoring@srk.com and pluedke@srk.com

Upstream Side of Dam			
Any visible concerns? (cracks, depressions, erosion, etc.)	SNOW COVER	Yes	No
Downstream Side of Dam			
Any visible concerns? (cracks, depressions, erosion, seepage, etc.)	SNOW COVER	Yes	No
Crest of Dam			
Any visible concerns? (cracks, depressions, erosion, etc.)		Yes	No
Thermosyphons North Side			
Any visible concerns? (cracks, punctures, peeling paint, birds nests, etc.)	①	Yes	No
Thermosyphons South Side			
Any visible concerns? (cracks, punctures, peeling paint, birds nests, etc.)	①	Yes	No
Instrumentation (on crest and downstream side)			
Any visible concerns? (bent, rusted, cracked, etc.)		Yes	No
Thermistors and Dataloggers			
Any visible concerns? (frayed or cut cables, damaged boxes, etc.)	②	Yes	No
Suspended Sediment in TIA (When not frozen)			
Any suspended sediment in Tail Lake?	FROZEN	Yes	No
Water at the Toe of the Downstream Side of the Dam (If yes refer to Doris North - North Dam and Tail Lake Outflow Seepage Monitoring Work Plan 2015)			
		Yes	No ③
If you answered yes to any of the questions above please provide details and photos. Observations can be sketched on the figure provided on the next page. If seepage has been noted please estimate the flow.			
① Rust noted in previous inspections ② Noticed that display light on CR1000 #1 is not orange (is on CR1000 #2 data logger) ③ Snow still accumulated at d/s toe of dam			

Please provide any other observations you have made or items that did not fit in the space above

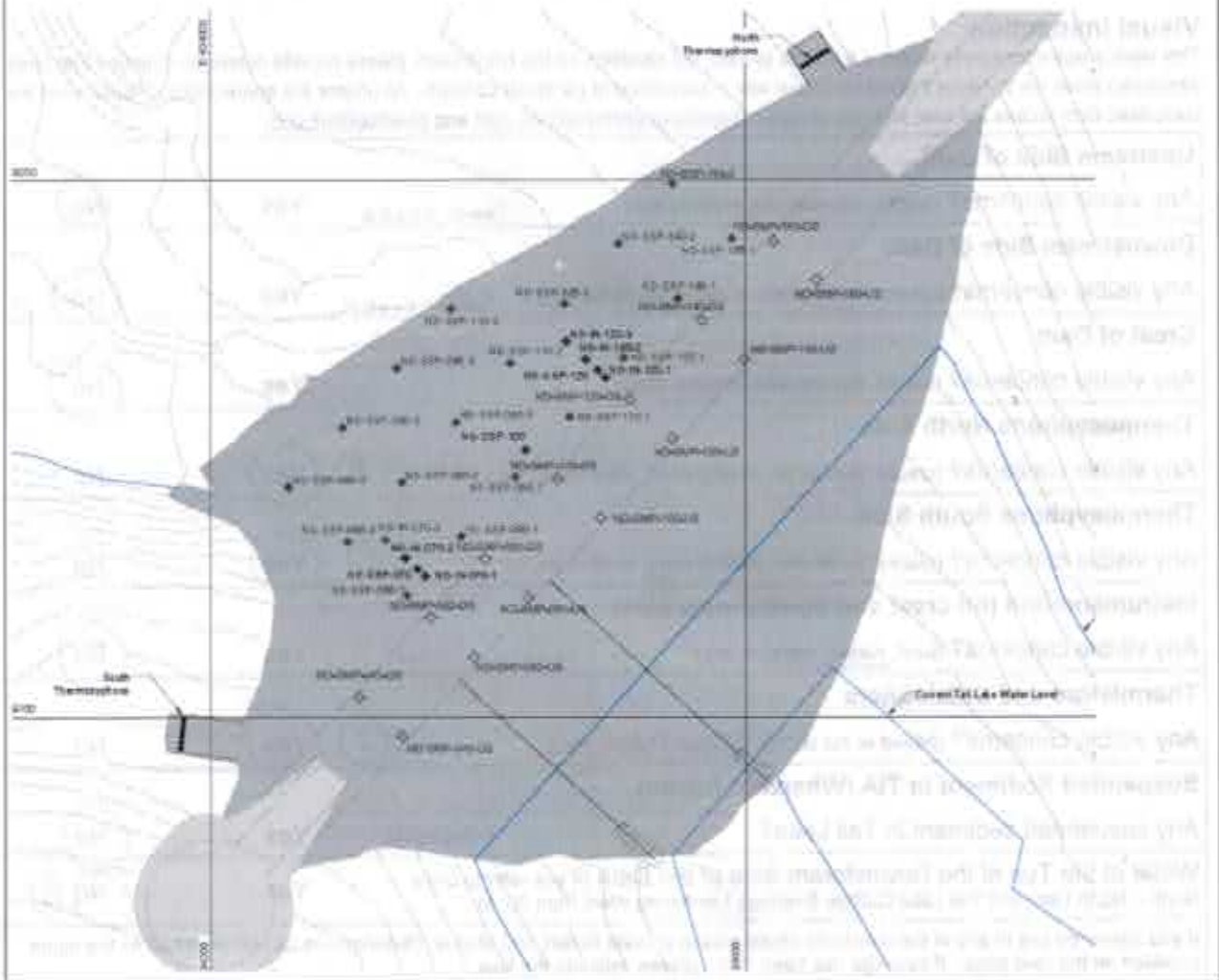

Photos:

Please collect the following photos:

- Photo from north end looking south along the dam
- Photo from south end looking north along the dam



Other photos, please describe

Snow cover on u/s, d/s slopes of dam.







North Dam Weekly Walkover Survey Report

Date:	MAY 31/2015
Inspected By:	SARAH W., ROBERT M.
Conditions:	(ie. snow on ground, clear) Some snow cover on d/s side, mist falling.

Visual Inspection:

This weekly walkover survey report is a means to track the condition on the North Dam, please provide details on changes that have developed since the previous inspection and/or any observations of particular concern. All photos are appreciated. Please send the completed form (scans are fine) and any photos to hopebaymonitoring@srk.com and pluedke@srk.com

Upstream Side of Dam	2	
Any visible concerns? (cracks, depressions, erosion, etc.)	Yes	No
Downstream Side of Dam	4	
Any visible concerns? (cracks, depressions, erosion, seepage, etc.)	Yes	No
Crest of Dam		
Any visible concerns? (cracks, depressions, erosion, etc.)	Yes	No
Thermosyphons North Side	3	
Any visible concerns? (cracks, punctures, peeling paint, birds nests, etc.)	Yes	No
Thermosyphons South Side		
Any visible concerns? (cracks, punctures, peeling paint, birds nests, etc.)	Yes	No
Instrumentation (on crest and downstream side)		
Any visible concerns? (bent, rusted, cracked, etc.)	Yes	No
Thermistors and Dataloggers		
Any visible concerns? (frayed or cut cables, damaged boxes, etc.)	Yes	No
Suspended Sediment in TIA (When not frozen)	1	
Any suspended sediment in Tail Lake?	Yes	No
Water at the Toe of the Downstream Side of the Dam (If yes refer to Doris North - North Dam and Tail Lake Outflow Seepage Monitoring Work Plan 2015)	Yes	No 5
If you answered yes to any of the questions above please provide details and photos. Observations can be sketched on the figure provided on the next page. If seepage has been noted please estimate the flow.		
<p>① Snow accumulation at shore line.</p> <p>② - Depressions marked in 2014 not visible due to snow cover.</p> <p>③ Rust noted in previous inspections.</p> <p>④ Some signs of erosion in area of sloping inclinometer 0702-3, snow cover on the downstream side makes it difficult to identify any depression.</p> <p>⑤ No visible seepage due to snow cover.</p>		

Please provide any other observations you have made or items that did not fit in the space above

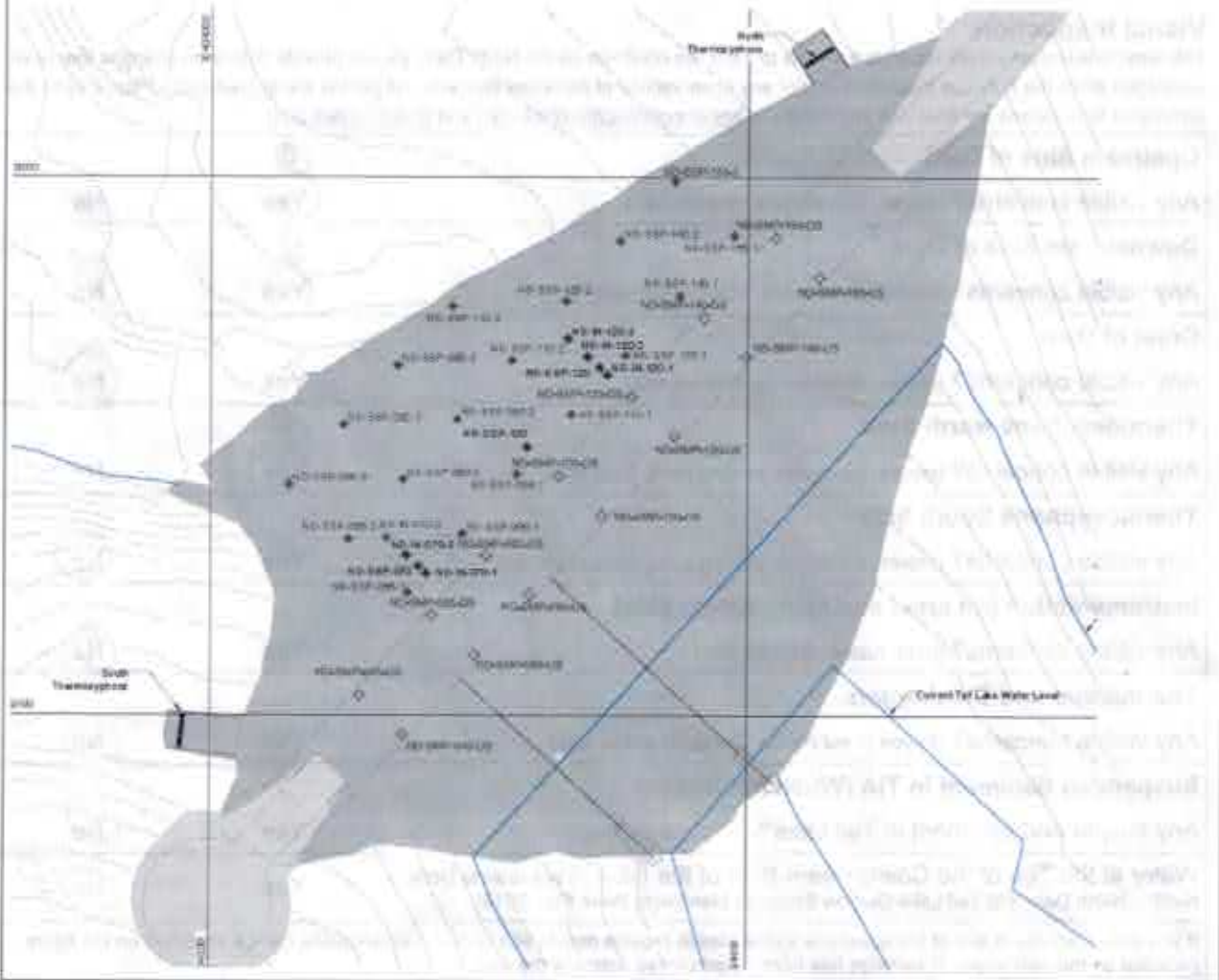

Photos:

Please collect the following photos:

Photo from north end looking south along the dam

Photo from south end looking north along the dam

Other photos, please describe





North Dam Weekly Walkover Survey Report

Date:	June 6, 2015
Inspected By:	Robert Maksagak
Conditions:	(ie. snow on ground, clear) Some snow on upstream side, toe of Dam. Some snow on down stream side of Dam.

Visual Inspection:

This weekly walkover survey report is a means to track the condition on the North Dam, please provide details on changes that have developed since the previous inspection and/or any observations of particular concern. All photos are appreciated. Please send the completed form (scans are fine) and any photos to hopebaymonitoring@srk.com and pluedke@srk.com

Upstream Side of Dam		
Any visible concerns? (cracks, depressions, erosion, etc.)	Yes	No
Downstream Side of Dam		
Any visible concerns? (cracks, depressions, erosion, seepage, etc.)	Yes ² ³	No
Crest of Dam		
Any visible concerns? (cracks, depressions, erosion, etc.)	Yes	No
Thermosyphons North Side		
Any visible concerns? (cracks, punctures, peeling paint, birds nests, etc.)	Yes ¹	No
Thermosyphons South Side		
Any visible concerns? (cracks, punctures, peeling paint, birds nests, etc.)	Yes ⁴	No
Instrumentation (on crest and downstream side)		
Any visible concerns? (bent, rusted, cracked, etc.)	Yes	No
Thermistors and Dataloggers		
Any visible concerns? (frayed or cut cables, damaged boxes, etc.)	Yes	No
Suspended Sediment in TIA (When not frozen)		
Any suspended sediment in Tail Lake?	Yes	No
Water at the Toe of the Downstream Side of the Dam (If yes refer to Doris North - North Dam and Tail Lake Outflow Seepage Monitoring Work Plan 2015)		
Any visible concerns? (bent, rusted, cracked, etc.)	Yes	No
If you answered yes to any of the questions above please provide details and photos. Observations can be sketched on the figure provided on the next page. If seepage has been noted please estimate the flow.		
<p>① Some rust @ base of Thermosyphons</p> <p>② Questionable Depressions 1m North of already marked Depression, further up North</p> <p>③ D2 - some painted rocks fallen down into Depression</p> <p>④ Some rust to box of Thermosyphon</p>		

Please provide any other observations you have made or items that did not fit in the space above

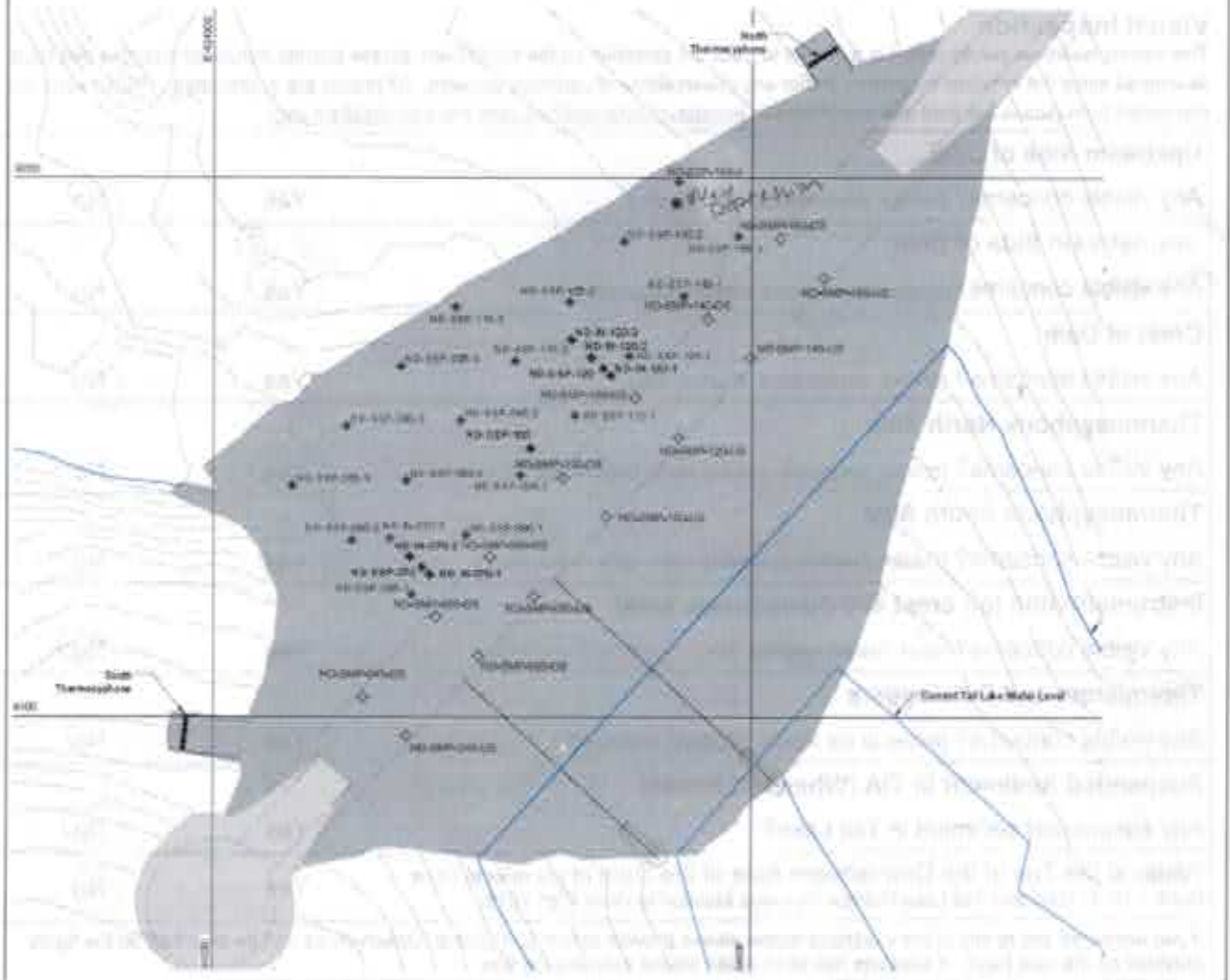

Photos:

Please collect the following photos:

Photo from north end looking south along the dam



Photo from south end looking north along the dam



Other photos, please describe

