



North Dam Weekly Walkover Survey Report

Date:	June 27, 2015
Inspected By:	Darcy Kanayok
Conditions:	(ie. snow on ground, clear) Clear

Visual Inspection:

This weekly walkover survey report is a means to track the condition on the North Dam, please provide details on changes that have developed since the previous inspection and/or any observations of particular concern. All photos are appreciated. Please send the completed form (scans are fine) and any photos to hopebaymonitoring@srk.com and pluedke@srk.com

Upstream Side of Dam		
Any visible concerns? (cracks, depressions, erosion, etc.)	Yes	<input checked="" type="radio"/> No
Downstream Side of Dam		
Any visible concerns? (cracks, depressions, erosion, seepage, etc.)	<input checked="" type="radio"/> Yes	No
Crest of Dam		
Any visible concerns? (cracks, depressions, erosion, etc.)	Yes	<input checked="" type="radio"/> No
Thermosyphons North Side		
Any visible concerns? (cracks, punctures, peeling paint, birds nests, etc.)	Yes	<input checked="" type="radio"/> No
Thermosyphons South Side		
Any visible concerns? (cracks, punctures, peeling paint, birds nests, etc.)	Yes	<input checked="" type="radio"/> No
Instrumentation (on crest and downstream side)		
Any visible concerns? (bent, rusted, cracked, etc.)	Yes	<input checked="" type="radio"/> No
Thermistors and Dataloggers		
Any visible concerns? (frayed or cut cables, damaged boxes, etc.)	Yes	<input checked="" type="radio"/> No
Suspended Sediment in TIA (When not frozen)		
Any suspended sediment in Tail Lake?	Yes	<input checked="" type="radio"/> No
Water at the Toe of the Downstream Side of the Dam (If yes refer to Doris North – North Dam and Tail Lake Outflow Seepage Monitoring Work Plan 2015)		
	<input checked="" type="radio"/> Yes	No
If you answered yes to any of the questions above please provide details and photos. Observations can be sketched on the figure provided on the next page. If seepage has been noted please estimate the flow.		
U4 - is slowly starting to sink in U3 - no change visible U2 - no visible change U1 - no visible change D5 - no visible change D1 - no visible change D4 - no visible change D2 - sinking in D6 - no visible change D7 - no visible change D3 - no visible change D10 - no visible change D9 - no visible change D8 - no visible change D11 - no visible change		

Please provide any other observations you have made or items that did not fit in the space above

D12 - New depression
D13 - New depression

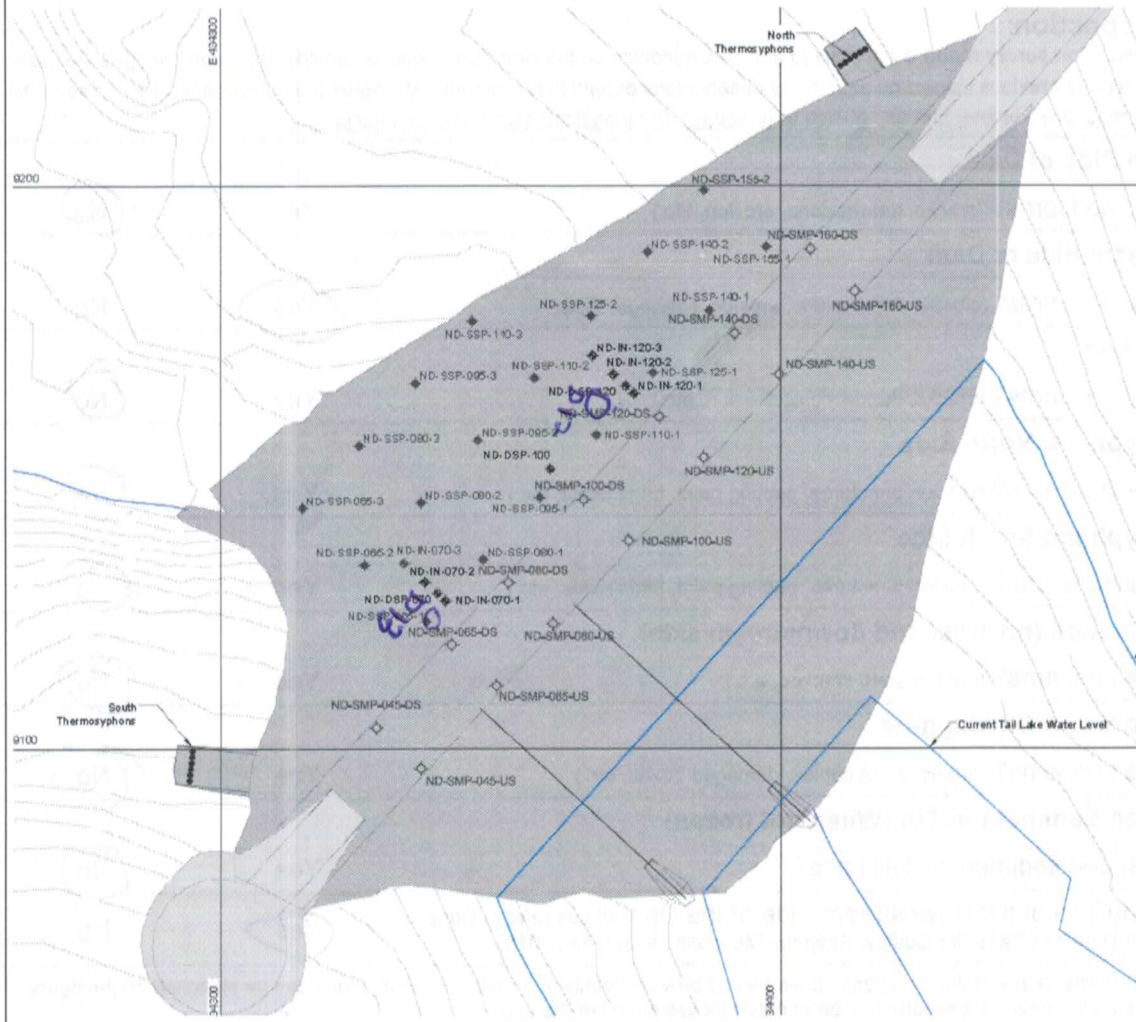

Photos:

Please collect the following photos:

Photo from north end looking south along the dam

Photo from south end looking north along the dam

Other photos, please describe







North Dam Weekly Walkover Survey Report

Date:	July 4/2015
Inspected By:	SARAH WARNOCK
Conditions:	(ie. snow on ground, clear) snow all melted, clear → marked new depressions July 4/15. Rain overnight on into day

Visual Inspection:

This weekly walkover survey report is a means to track the condition on the North Dam, please provide details on changes that have developed since the previous inspection and/or any observations of particular concern. All photos are appreciated. Please send the completed form (scans are fine) and any photos to hopebaymonitoring@srk.com and pluedke@srk.com

Upstream Side of Dam		
Any visible concerns? (cracks, depressions, erosion, etc.)	① Yes	No
Downstream Side of Dam		
Any visible concerns? (cracks, depressions, erosion, seepage, etc.)	② Yes	No
Crest of Dam		
Any visible concerns? (cracks, depressions, erosion, etc.)	Yes	No
Thermosyphons North Side		
Any visible concerns? (cracks, punctures, peeling paint, birds nests, etc.)	③ Yes	No
Thermosyphons South Side		
Any visible concerns? (cracks, punctures, peeling paint, birds nests, etc.)	③ Yes	No
Instrumentation (on crest and downstream side)		
Any visible concerns? (bent, rusted, cracked, etc.)	Yes	No
Thermistors and Dataloggers		
Any visible concerns? (frayed or cut cables, damaged boxes, etc.)	Yes	No
Suspended Sediment in TIA (When not frozen)		
Any suspended sediment in Tail Lake?	Yes	No
Water at the Toe of the Downstream Side of the Dam (If yes refer to Doris North - North Dam and Tail Lake Outflow Seepage Monitoring Work Plan 2015)		
	④ Yes	No
If you answered yes to any of the questions above please provide details and photos. Observations can be sketched on the figure provided on the next page. If seepage has been noted please estimate the flow.		
① Two new depressions marked on u/s side of dam. See reverse. ② Four new depressions marked on d/s side. Two depressions appear to have expanded. See reverse. ③ Rust noted in previous inspections. ④ Seep noted at 13W 0434294 7559147. Water Quality sample collected from seep location, Tail Lake and background location on July 6/2015. Sample ID: NOSP-06JUL15, BKGSP-06JUL15, TLI-06JUL15.		

Please provide any other observations you have made or items that did not fit in the space above

- ✓ U1 - No change
- ✓ U2 - No change
- ✓ U3 - Expanding towards U2
- ✓ U4 - No change
- ✓ U5 - New - 13W 0434415 7559130
- ✓ U6 - New - 13W 0434432 7559166
- ✓ D1 - Expanding towards crest of dam
- ✓ D2 - No change
- ✓ D3 - No change

- ✓ D4 - No change
- ✓ D5 - Backfilled
- ✓ D6 - No change
- ✓ D7 - Expanded towards toe
- ✓ D8 - Expanded towards toe
- ✓ D9 - No change
- ✓ D10 - No change
- ✓ D11 - No change
- ✓ D12 - No change
- ✓ D13 - No change
- ✓ D14 - New 13W 0434432 7559144
- ✓ D15 - New 0434434 7559166
- ✓ D16 - New 0434437 7559177
- ✓ D17 - New 04344363 7559188

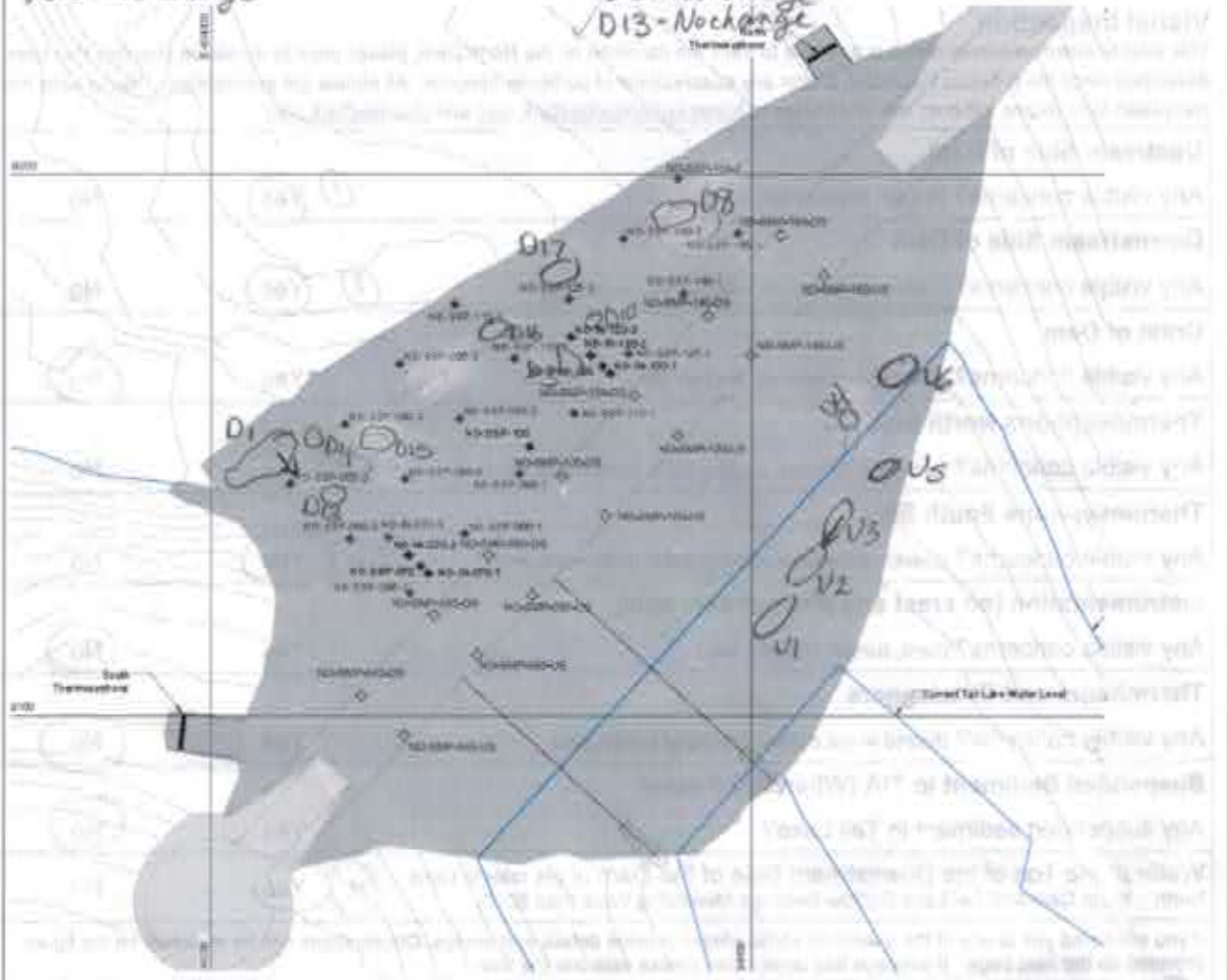

Photos:

Please collect the following photos:

- Photo from north end looking south along the dam
- Photo from south end looking north along the dam



Other photos, please describe *Photos of all depressions attached.*