

C:\01\_SITES\Hope Bay\Madrid Closure\1CT022.001\_Madrid\_North\_Overview.dwg

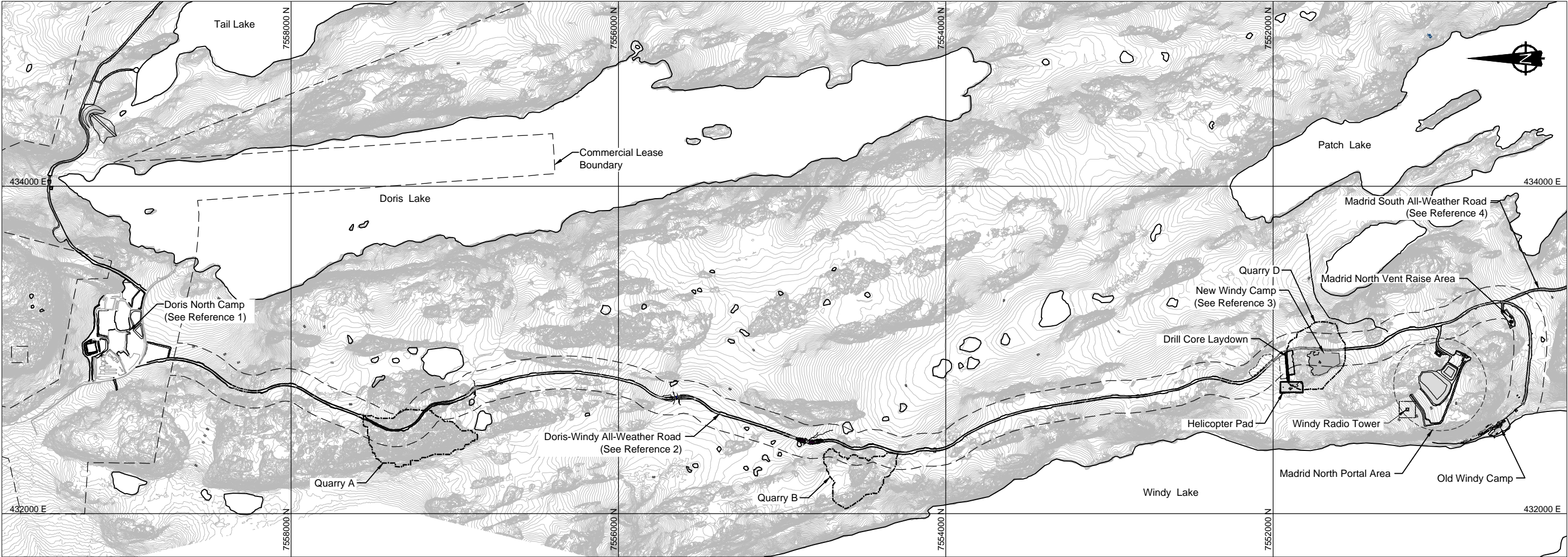

NOTES

1. Topographic contour data for the terrain model were provided by Hope Bay Mining, and is based on 2007 Aerial Photography. Contour intervals are 0.5m.
2. The co-ordinate system is UTM NAD 83, Zone 13.
3. All dimensions are in metric units, unless specifically mentioned.
4. Notes in this drawing apply to all other active drawings.

REFERENCES

- 1) Engineering Drawings for the Doris North Camp Area, Doris North Project, Nunavut, Canada. Revision AB1. As-Built Drawings Prepared for Hope Bay Mining Limited. Project Number 1CH008.033. May 18, 2012
- 2) Engineering Drawings for the Doris-Windy All-Weather Road, Doris Infrastructure Project, Nunavut, Canada. Revision AB1. As-Built Drawings Prepared for Hope Bay Mining Ltd. Project Number: 1CH008.033/.058. May 11, 2012
- 3) Engineering Drawings for the New Windy Camp, Doris North Project, Nunavut, Canada. Revision 3. Issued for Construction Drawings Prepared for Hope Bay Mining Ltd. Project Number 1CH008.033. October 17, 2011
- 4) Engineering Drawings for the Madrid South All-Weather Road, Hope Bay Project, Nunavut, Canada. Revision D. Issued for Discussion Drawings Prepared for TMAC Resources Inc. Project Number 1CT022.001.410. October 31, 2014

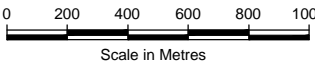

				Madrid Closure and Reclamation Plan	
SRK JOB NO.: 1CH022.001		HOPE BAY PROJECT		General Arrangement Doris North Camp to Madrid North Portal	
FILE NAME: 1CT022.001_Madrid_North_Overview.dwg				DATE: Oct. 2014	APPROVED: LW
				FIGURE:	1