

RECEIVED

By Richard Dwyer at 5:19 pm, Mar 31, 2011

2011 ABANDONMENT AND RECLAMATION PLAN

Appendix B-4

Milne Inlet Tote Road - Water Crossings
(Included with Electronic Version Only)

XREF FILE(S): Base Map, Milne Inlet, Small to Extra Large Crossings; Culverts and Crossings; Extra Small to Extra Large Crossings; BORROW SOURCES; BORROW SOURCE(S); Baffinland logo-bldg corp. b-w; Baffinland logo-bldg corp. b-w; Baffinland logo-bldg corp. b-w; Baffinland logo-bldg corp. b-w

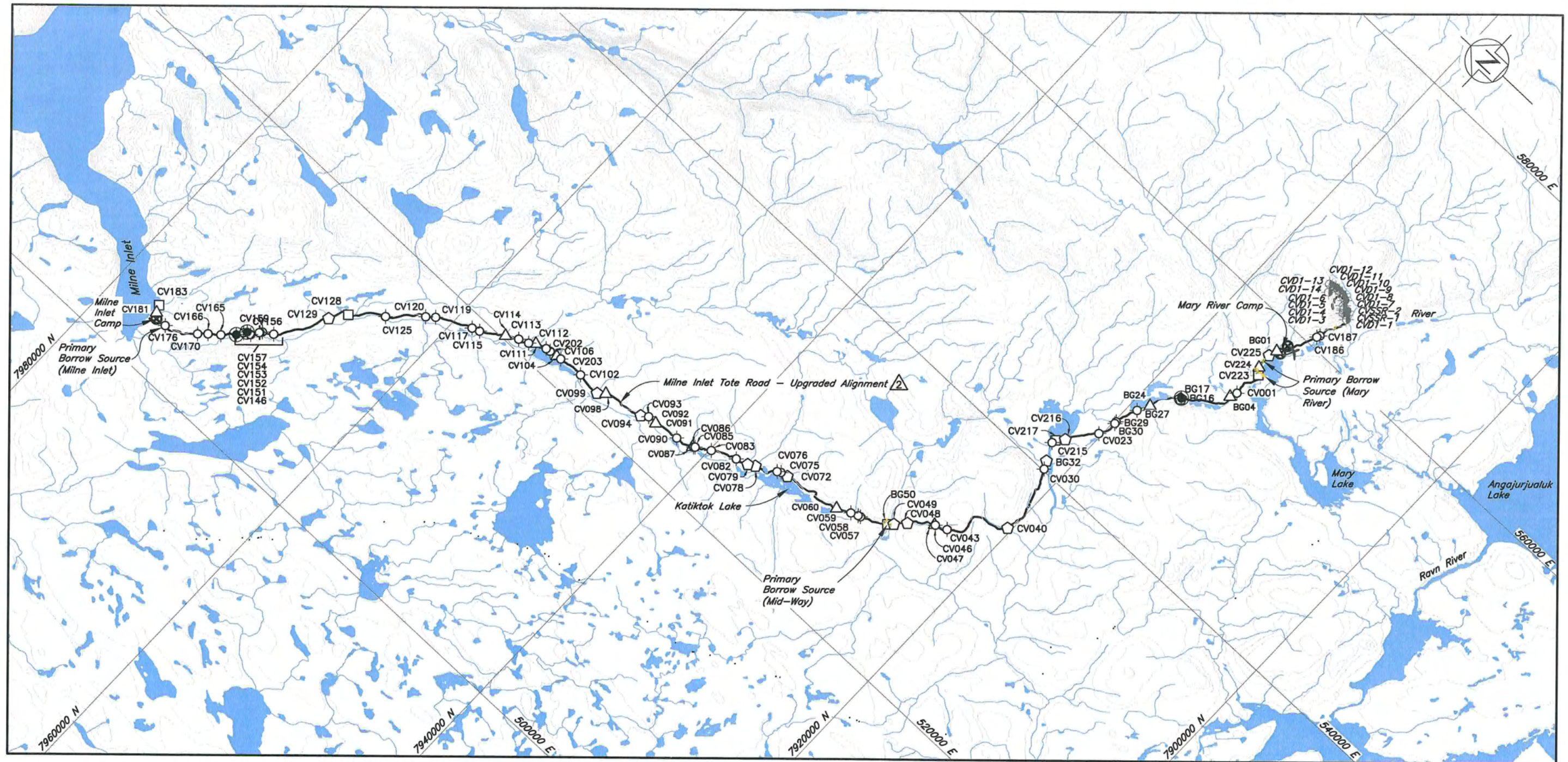

LEGEND:

- Water
- Milne Inlet Tote Road - Upgraded Alignment
- Airstrip
- Exploration Camp Location
- Culvert Locations
- Extra Small Crossing
- Small Crossing
- Medium Crossing
- Large Crossing
- Extra Large Crossing

NOTES:

- Base Map: © Her Majesty the Queen in Rights of Canada, Department of Natural Resources, (2004). All rights reserved.
- Contours are in metres. Contour interval varies.
- Coordinate grid is shown in UTM (NAD 83) Zone 17 and is in metres.
- Milne Inlet Tote Road alignment survey provided by Genivar (Survey Completed in July 2008).

Scale 3 1.5 0 3 6 9 12 15 Km

Knight Piésold CONSULTING	
Baffinland Iron Mines Corporation	
MARY RIVER PROJECT - BULK SAMPLING PROGRAM	
DRAINAGE CROSSING LOCATIONS PLAN (ALL CROSSINGS)	
THIS DRAWING WAS PREPARED FOR OUR CLIENT. ANY USE WHICH A THIRD PARTY MAKES OF IT, OR ANY RELIANCE ON OR DECISIONS BASED ON IT, ARE THE RESPONSIBILITY OF SUCH THIRD PARTY. KNIGHT PIÉSOLD ACCEPTS NO RESPONSIBILITY FOR DAMAGES, IF ANY, SUFFERED BY THE THIRD PARTY AS A RESULT OF DECISIONS MADE OR ACTIONS BASED ON THIS DRAWING. COPIES RESULTING FROM ELECTRONIC TRANSFER OR REPRODUCTION OF THIS DRAWING ARE UNCONTROLLED AND MAY NOT BE THE MOST RECENT REVISION.	
PROJECT/ASSIGNMENT NO. NB102-00181/10	DRAWING NO. 400
REVISION	

REV.	DATE	DESCRIPTION	DESIGN	DRAWN	CHK'D	APP'D
2	19DEC08	UPDATED WITH AS-BUILT INFORMATION	CAP	MD/BSP	AP	KE
1	31JUL07	ISSUED FOR CONSTRUCTION	KH/BP	MD	AP	KE
0	13JUL07	ISSUED IN FINAL	KH/BP	MD	AP	KE

DRG. NO.	DESCRIPTION	REV.	DATE	DESCRIPTION	DESIGN	DRAWN	CHK'D	APP'D
REFERENCE DRAWINGS				REVISIONS				

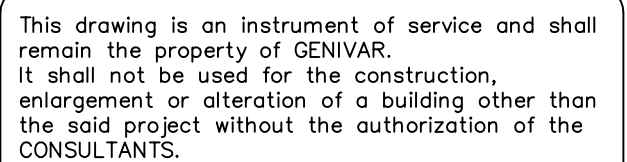
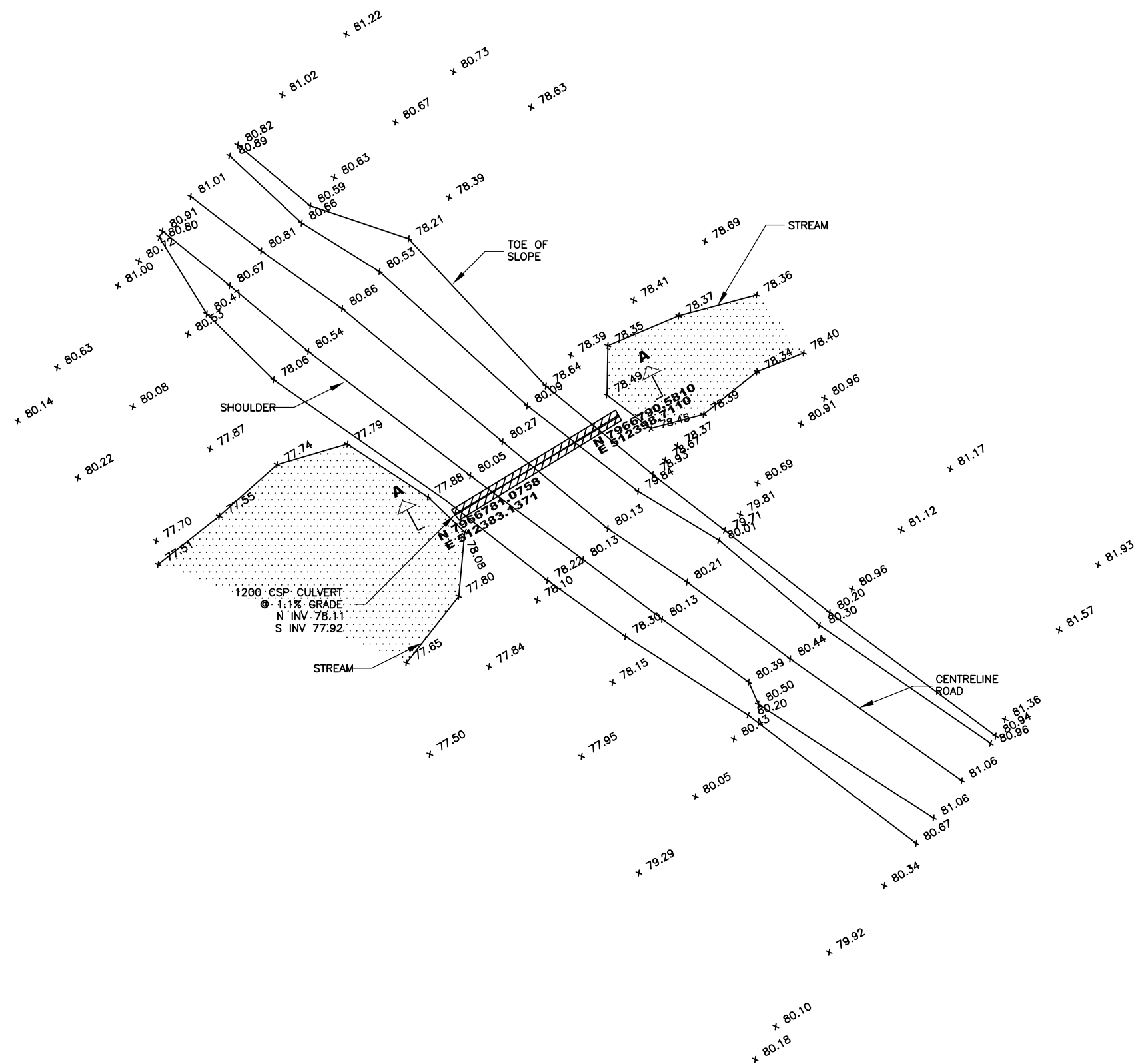

NUNAVUT



Date	SEPT 2008
Scale	1:500
Drawn	SO
Approved	

Job Number
07-039
Dwg. Number
200_02_08

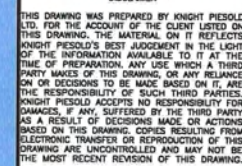

P/A NO.	DRG. NO.	REV
NB102-181/10	441	2

2	30JAN09	UPDATED WITH AS-BUILT INFORMATION	CAP	SIR	AP	KDE
1	31JUL07	ISSUED FOR CONSTRUCTION	BP	MD/SIR	AP	KDE
0	13JUL07	ISSUED IN FINAL	BP	MD/SIR	AP	KDE
REV	DATE	DESCRIPTION	DESIGN	DRAWN	CHK'D	APP'D

REVISIONS

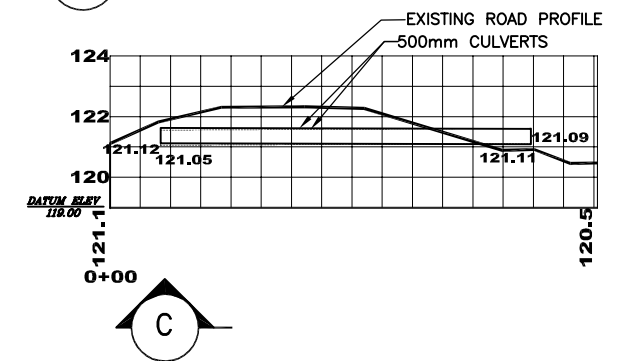
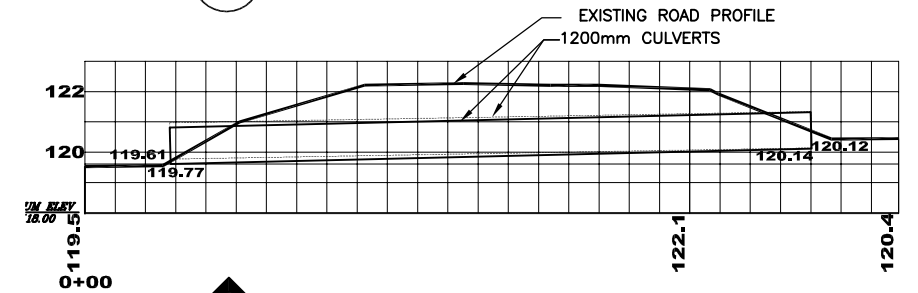
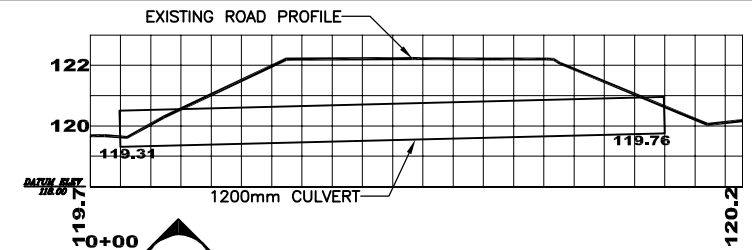
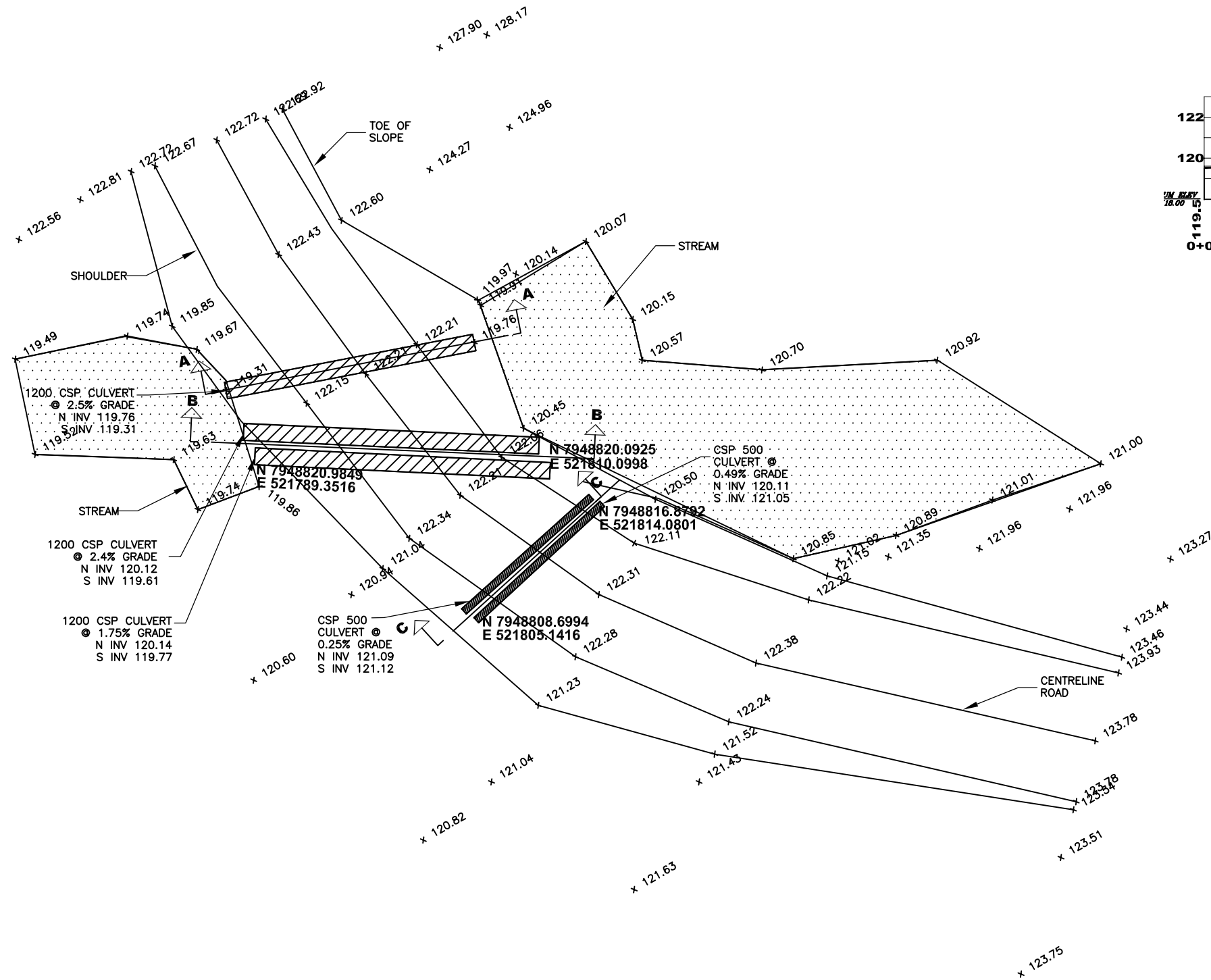

This drawing is an instrument of service and shall remain the property of GENIVAR. It shall not be used for the construction, enlargement or alteration of a building other than the said project without the authorization of the CONSULTANTS.

PROJECT
BAFFINLAND IRON
MINES CORP.
BAFFIN ISLAND NUNAVUT

DRAWING
AS CONSTRUCTED
WATER CROSSING CV099 AT TOTE RD STA. 37+300

GENIVAR
834 Mountjoy Street South
P.O. Box 120
Timmins, Ontario P4N 7C5
www.genivar.com
Tel. 705-264-9413
Fax 705-267-2725

Date SEPT 2008	Job Number 07-039
Scale 1:500	
Drawn SO	Dwg. Number 200_02_06
Approved	

AS CON...TOTE...CCAN-WA...DWG\200_02_06

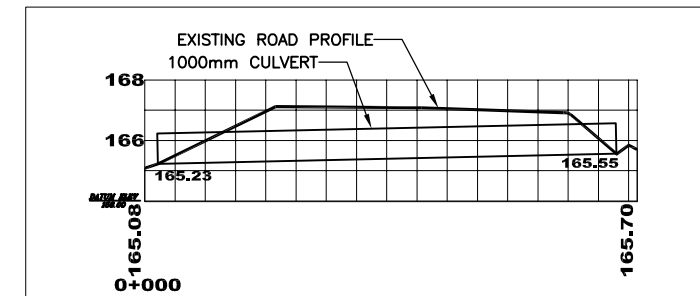
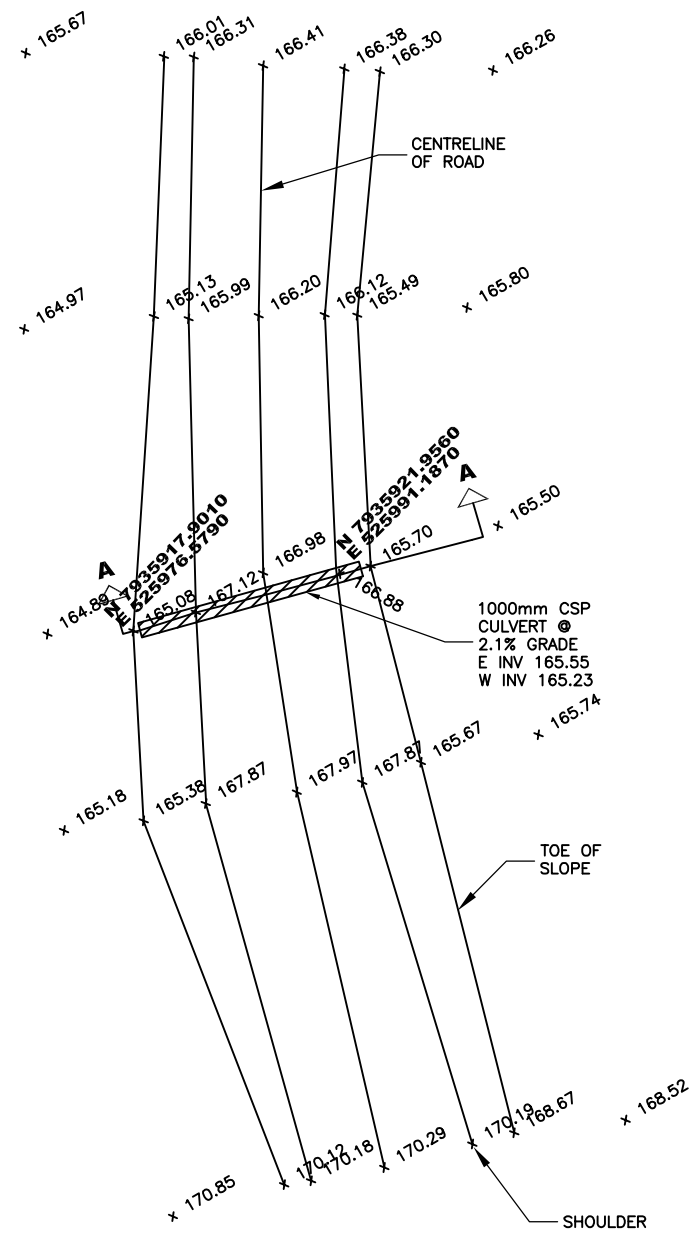

This drawing is an instrument of service and shall remain the property of GENIVAR. It shall not be used for the construction, enlargement or alteration of a building other than the said project without the authorization of the CONSULTANTS.

PROJECT	
BAFFINLAND IRON MINES CORP.	
BAFFIN ISLAND	NUNAVUT
DRAWING	
AS CONSTRUCTED	
WATER CROSSING CV077 AT TOTE ROAD STA. 51+600	

 **GENIVAR**
834 Mountjoy Street South
P.O. Box 120
Timmins, Ontario P4N 7C5
www.genivar.com
Tel. 705-264-9413
Fax 705-267-2725

Date	SEPT 2008	Job Number
Scale	1:500	07-039
Drawn	AB/SO	Dwg. Number
Approved		200_02_05

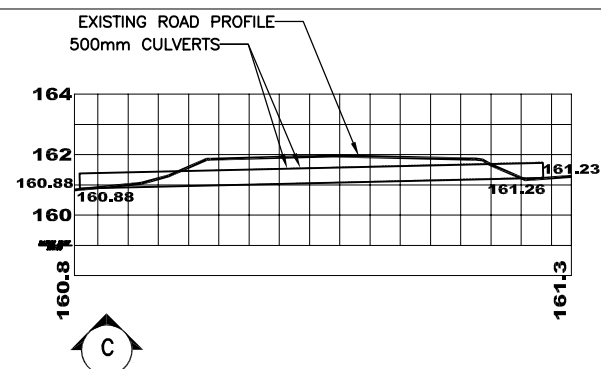
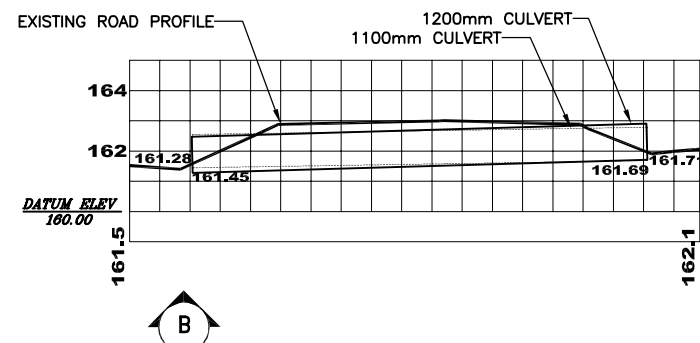
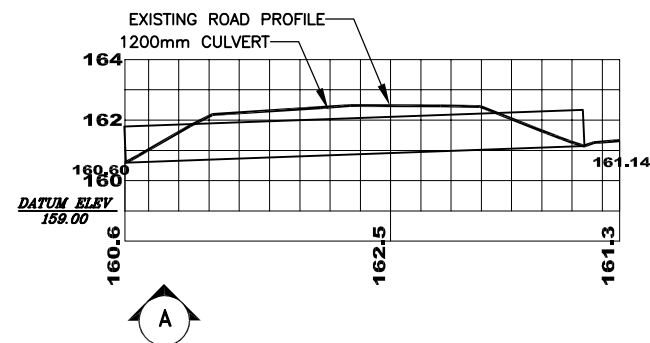
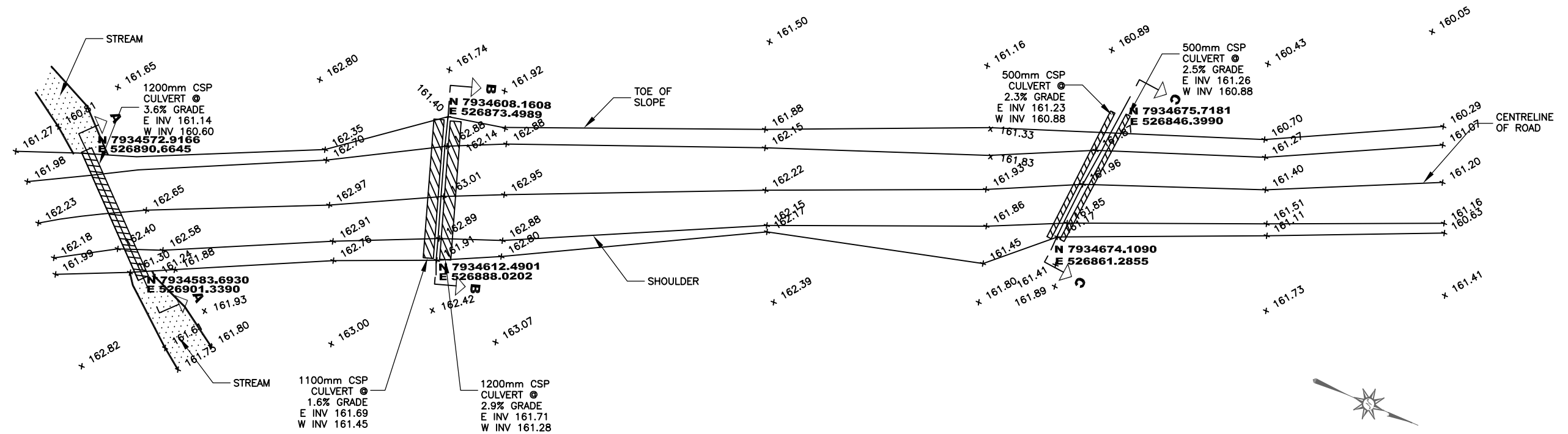

This drawing is an instrument of service and shall remain the property of GENIVAR. It shall not be used for the construction, enlargement or alteration of a building other than the said project without the authorization of the CONSULTANTS.

PROJECT
BAFFINLAND IRON
MINES CORP.
BAFFIN ISLAND
NUNAVUT

DRAWING
AS CONSTRUCTED
WATER CROSSING CV072 AT TOTE ROAD STA. 53+300

GENIVAR
834 Mountjoy Street South
P.O. Box 120
Timmins, Ontario P4N 7C5
www.genivar.com
Tel. 705-264-9413
Fax 705-267-2725

Date SEPT 2008	Job Number 07-039
Scale 1: 500	Dwg. Number 200_02_04
Drawn AB/so	
Approved	

AS CON... \TOTE... \CCAN-WA... \DWG\200_02_04

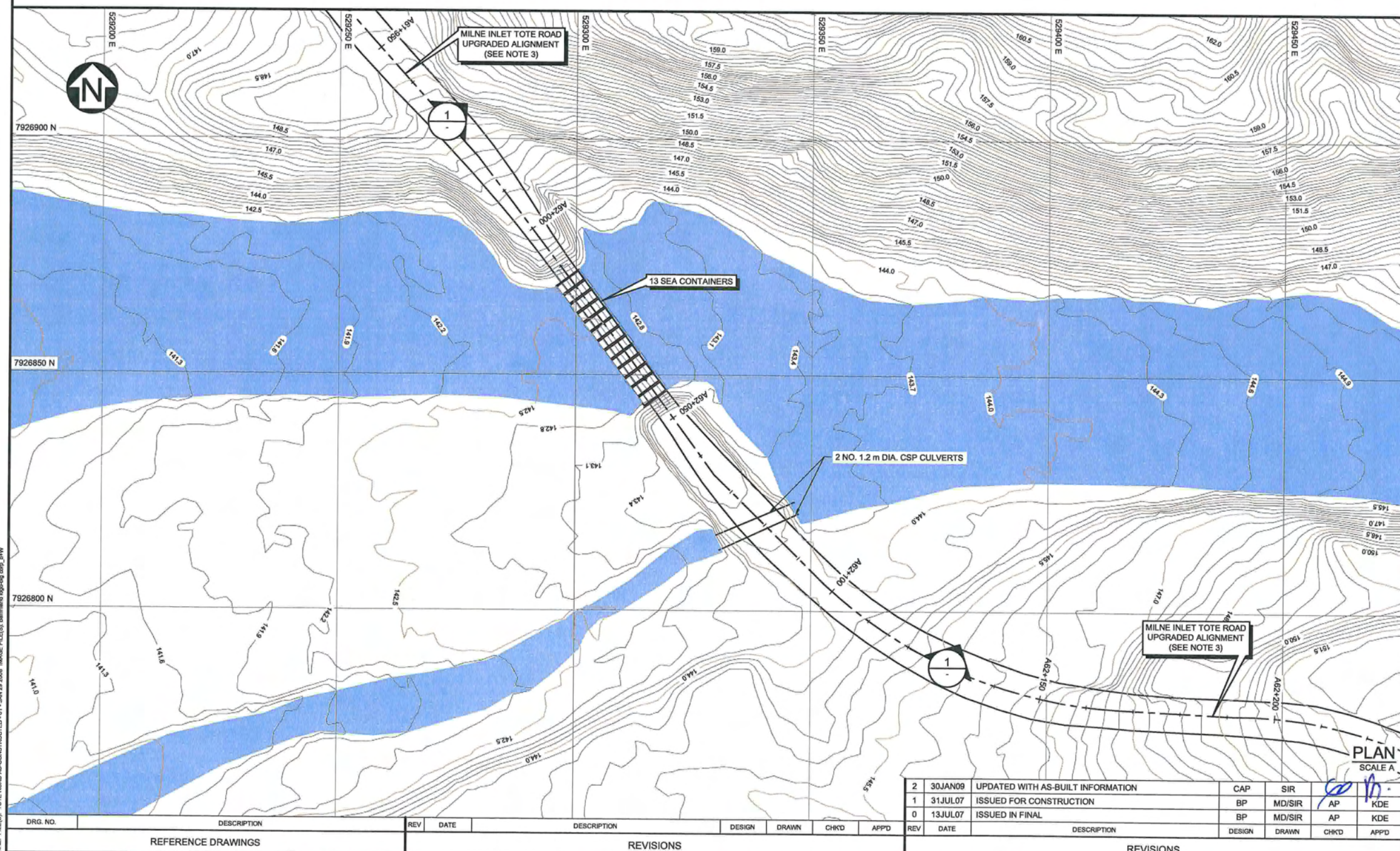
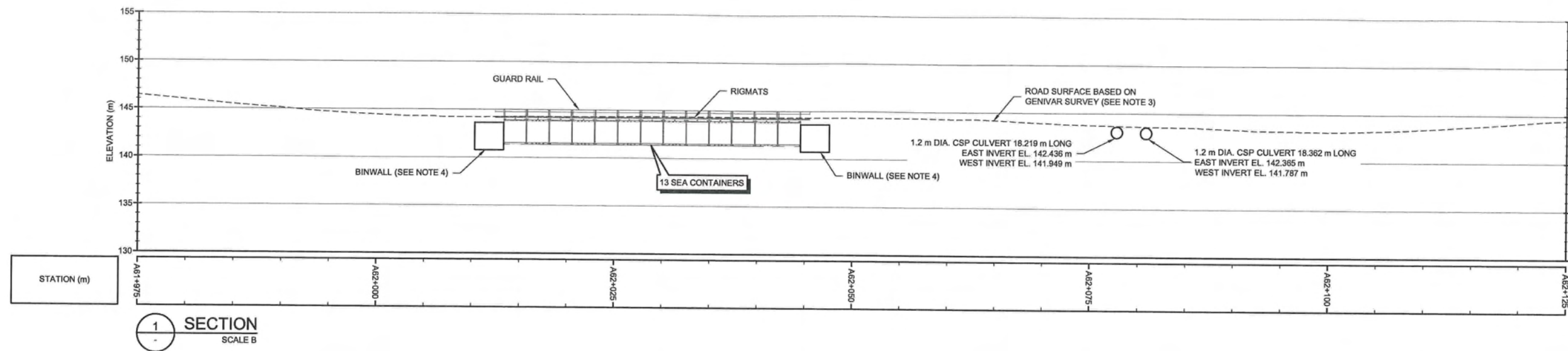

AS-CONSTRUCTED

LEGEND:

- WATER
- MAJOR CONTOUR
- MINOR CONTOUR
- ROAD SURFACE BASED ON GENIVAR SURVEY (SEE NOTE 3)
- ROAD ALIGNMENT (SEE NOTE 3)

NOTE(S):

1. COORDINATE GRID IS UTM (NAD83) ZONE 17 AND IS IN METRES.
2. CONTOURS BASED ON LIDAR SURVEY COMPLETED NOVEMBER 2008. CONTOUR INTERVAL IS 0.3 METRES.
3. AS-CONSTRUCTED ROAD ALIGNMENT PROVIDED BY GENIVAR DATED JULY 2008.
4. BINWALL LOCATIONS AND ELEVATIONS ARE APPROXIMATE AND WERE NOT SURVEYED.



DISCLAIMER
THIS DRAWING WAS PREPARED BY KNIGHT PIESOLD LTD. FOR THE ACCOUNT OF THE CLIENT LISTED ON THIS DRAWING. THE MATERIAL ON IT REFLECTS KNIGHT PIESOLD'S BEST JUDGEMENT IN THE LIGHT OF THE INFORMATION AVAILABLE TO IT AT THE TIME OF PREPARATION. ANY USE WHICH A THIRD PARTY MAKES OF THIS DRAWING, OR ANY RELIANCE ON OR DECISIONS TO BE MADE BASED ON IT, ARE THE RESPONSIBILITY OF SUCH THIRD PARTIES. KNIGHT PIESOLD ACCEPTS NO RESPONSIBILITY FOR DAMAGES, IF ANY, SUFFERED BY THE THIRD PARTY AS A RESULT OF DECISIONS MADE OR ACTIONS BASED ON THIS DRAWING. COPIES RESULTING FROM ELECTRONIC TRANSFER OR REPRODUCTION OF THIS DRAWING ARE UNCONTROLLED AND MAY NOT BE THE MOST RECENT REVISION OF THIS DRAWING.

Knight Piesold
CONSULTING

Baffinland
IRON MINES CORPORATION

MARY RIVER PROJECT - BULK SAMPLING PROGRAM

EXTRA-LARGE CROSSING BG50
PLAN AND SECTIONS

P/A NO. **NB102-181/10** DRG. NO. **442** REV **2**

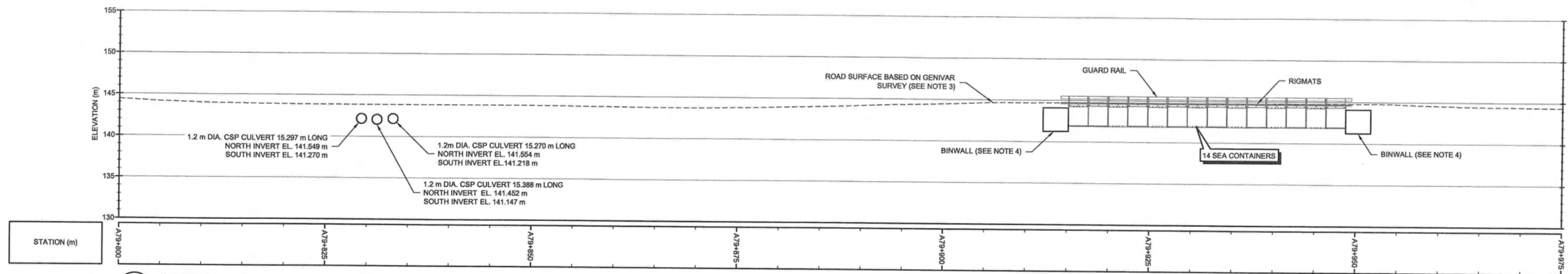

1 SECTION
SCALE B

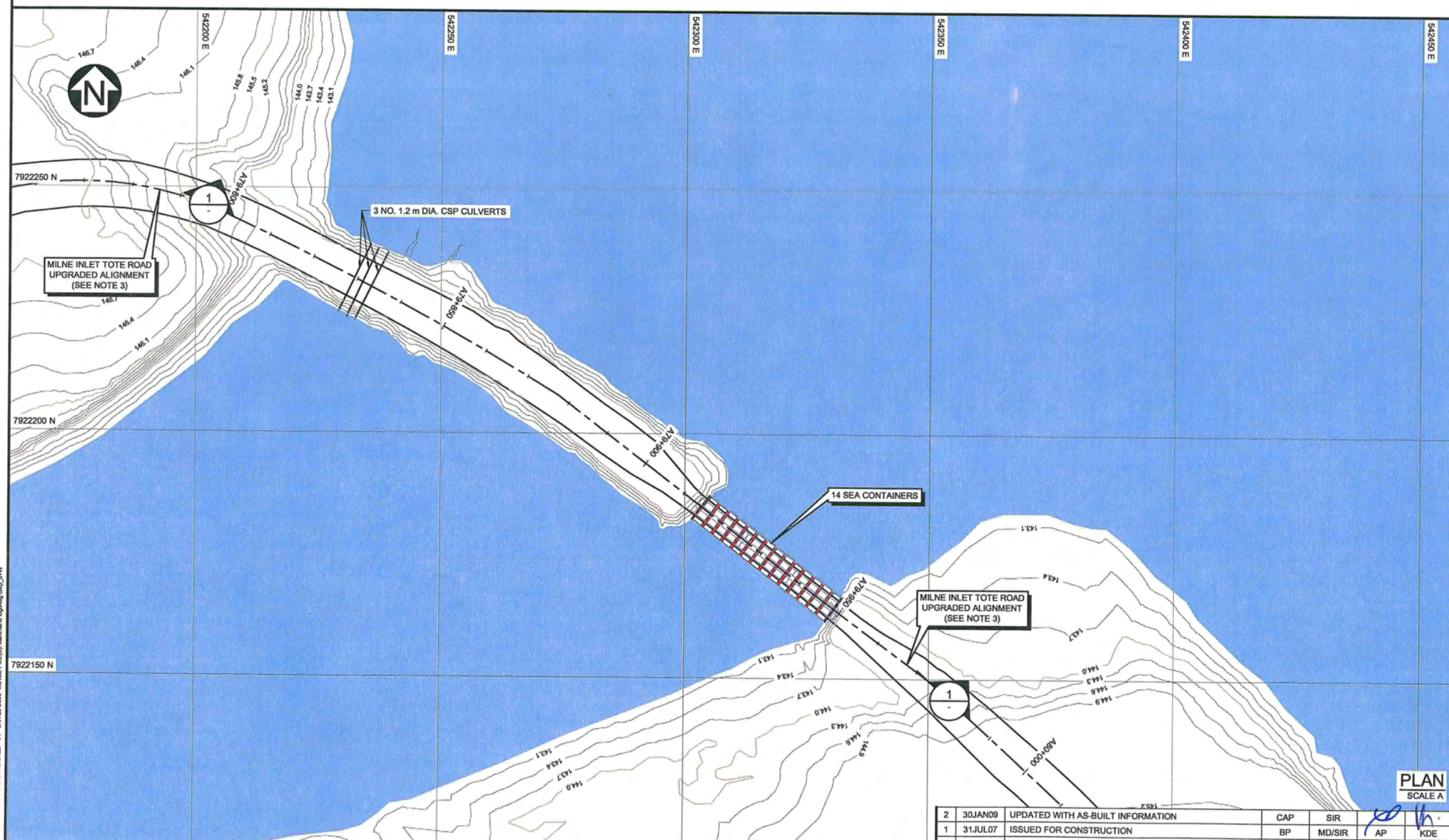

AS-CONSTRUCTED

LEGEND:

- WATER
- MAJOR CONTOUR
- MINOR CONTOUR
- ROAD SURFACE BASED ON GENIVAR SURVEY (SEE NOTE 3)
- ROAD ALIGNMENT (SEE NOTE 3)

NOTE(S):

1. COORDINATE GRID IS UTM (NAD83) ZONE 17 AND IS IN METRES.
2. CONTOURS BASED ON LIDAR SURVEY COMPLETED NOVEMBER 2008. CONTOUR INTERVAL IS 0.3 METRES.
3. AS-CONSTRUCTED ROAD ALIGNMENT PROVIDED BY GENIVAR DATED JULY 2008.
4. BINWALL LOCATIONS AND ELEVATIONS ARE APPROXIMATE AND WERE NOT SURVEYED.

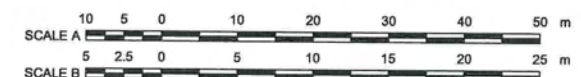

DISCLAIMER
THIS DRAWING WAS PREPARED BY KNIGHT PIESOLD LTD. FOR THE ACCOUNT OF THE CLIENT LISTED ON THIS DRAWING. THE MATERIAL ON IT REFLECTS KNIGHT PIESOLD'S BEST JUDGMENT IN THE LIGHT OF THE INFORMATION AVAILABLE TO IT AT THE TIME OF PREPARATION. ANY USE WHICH A THIRD PARTY MAKES OF THIS DRAWING, OR ANY RELIANCE ON OR DECISIONS TO BE MADE BASED ON IT, ARE THE RESPONSIBILITY OF SUCH THIRD PARTIES. KNIGHT PIESOLD ACCEPTS NO RESPONSIBILITY FOR DAMAGES, IF ANY, SUFFERED BY THE THIRD PARTY AS A RESULT OF DECISIONS MADE OR ACTIONS BASED ON THIS DRAWING. COPIES RESULTING FROM ELECTRONIC TRANSFER OR REPRODUCTION OF THIS DRAWING ARE UNCONTROLLED AND MAY NOT BE THE MOST RECENT REVISION OF THIS DRAWING.

Knight Piésold
CONSULTING

Baffinland
IRON MINES CORPORATION

MARY RIVER PROJECT - BULK SAMPLING PROGRAM

EXTRA-LARGE CROSSING CV217
PLAN AND SECTIONS

P/A NO. **NB102-181/10** DRG. NO. **443** REV **2**

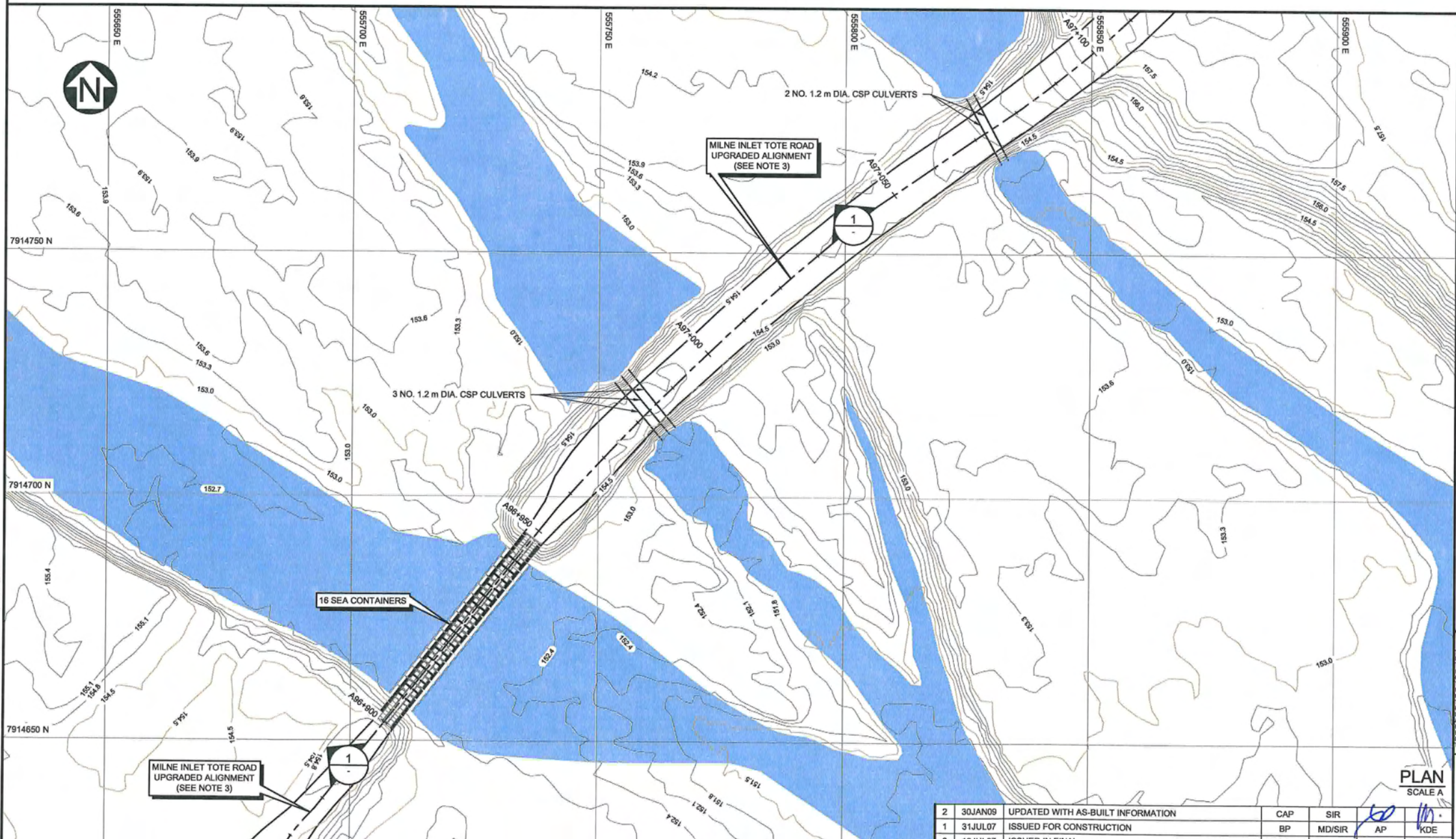

P/A NO.	DRG. NO.	REV
NB102-181/10	444	2