

XREF FILE(S): Southern Route Detailed Mapping; PROJECT SITE PLAN 2m INTERVAL; Limits of Eagle Mapping; Proposed Winter water sources; Proposed Borrow Locations; Updated Winter Drillholes; Updated Summer Drillholes; Updated Summer Drillholes within 30m of High Water Mark; MAY 1

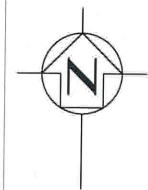
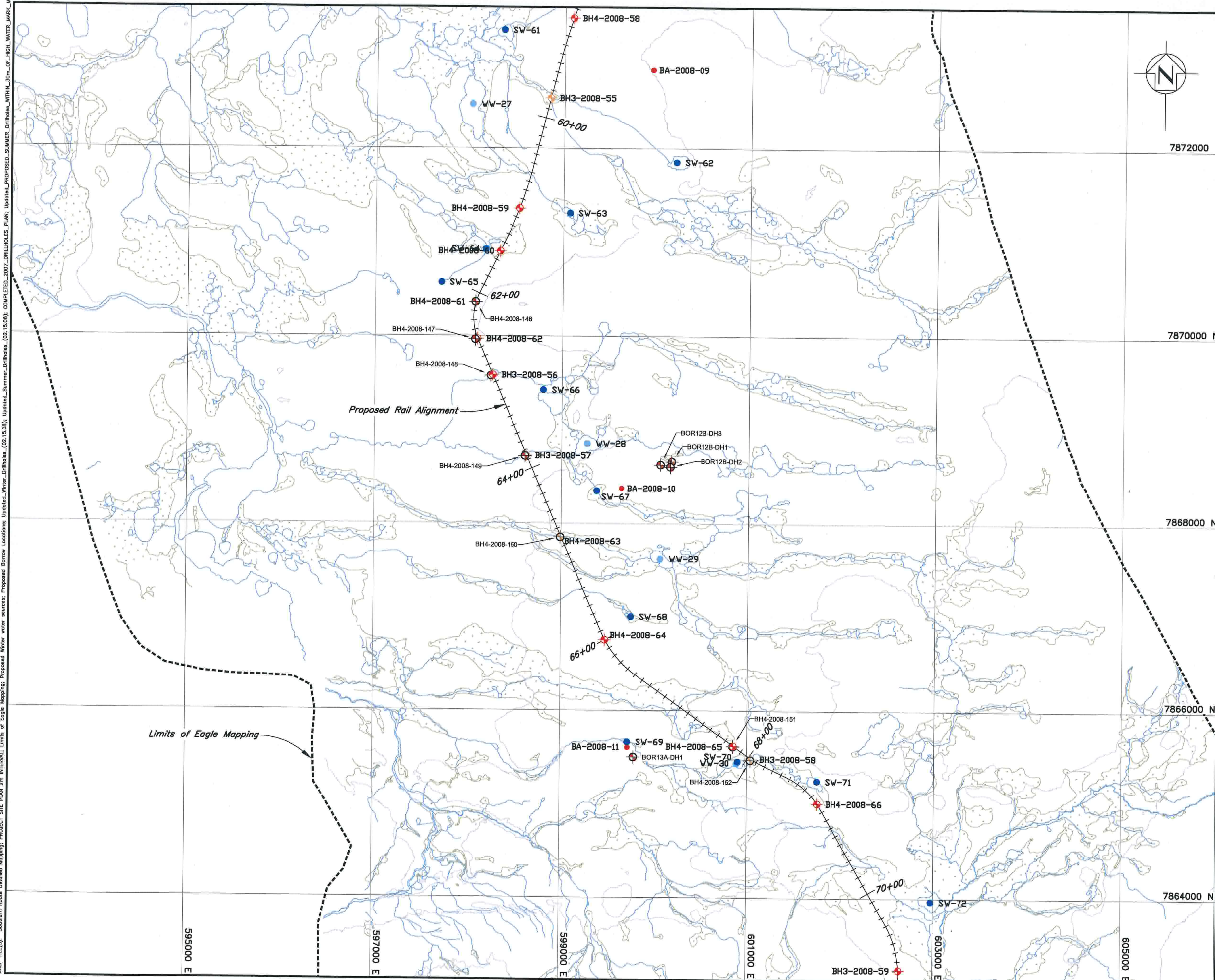

7872000 N

7870000 N

7868000 N

7866000 N

7864000 N

595000 E

597000 E

599000 E

601000 E

603000 E

605000 E

LEGEND:

- Proposed Winter Drillhole
- Proposed Summer and/or Winter Water Source
- Proposed Summer Drillhole
- Proposed Summer Drillhole within 30m of high water mark
- Proposed Summer Water Source
- Proposed Test Pits
- Drillholes Completed in 2007
- Borrow Source Location
- 0+00 Station marker (km)
- River/Stream/Drainage
- Wetland

NOTES:

1. Topography provided by Eagle Mapping (2005).
2. Coordinate grid is shown in UTM (NAD 83) Zone 17 and is in metres.
3. Contours are in metres. Contour interval is 25 metres.
4. Proposed Rail Alignment provided by Canarail in July 2008.
5. Ravn River Alternate Routes provided by Canarail on July 2008.
6. Drillhole and water source locations may vary depending on actual site conditions. Drillhole locations may change due to changes in infrastructure locations.
7. Borrow source locations are approximate and final coordinates will be determined pending site reconnaissance.



MARY RIVER PROJECT

PROPOSED RAIL ALIGNMENT
SITE INVESTIGATION PLAN
(SHEET 6 OF 8)



P/A NO.	REF.	REV.
NB102-00181/12	NB08-00744	0

FIGURE 6

NORTH BY ON. CREATED BY: mdevers SAVED: I:\02-00181-12\Assignment\Local\Fig 1946_7/21/2008 9:37:54 PM PRINTED: 7/21/2008 9:38:53 PM 6 of 8, bprint