



ABANDONMENT AND RECLAMATION PLAN

TUNDRA COPPER CORP

COPPERMINE PROJECT

JULY 2014

INTRODUCTION

This Abandonment and Reclamation Plan pertains to the Coppermine Project of Tundra Copper Corp (TCC) located approximately 60km southwest of the community of Kugluktuk, Nunavut. TCC proposes to explore primarily, but not exclusively, for copper, nickel, silver and platinum-group minerals in the Coppermine River area and TCC is committed to take the necessary precautions to minimize disruption to the natural environment as best as possible and practicable. In addition, TCC will carry out its exploration activities in such a manner as to protect the health and safety of its employees.

Proposed work will consist of the following:

- Prospecting and geological mapping
- Geochemical soil and rock sampling surveys
- Geophysical surveys – potentially both ground and airborne surveys
- Trenching – both hand-dug and mechanized. Likely slated for 2015 field season.
- Diamond drilling – a KD150 portable drill will be used to minimize surface disturbance and to reduce the drillsite footprint.

Tundra Copper's mineral claims cover both crown land and Inuit Owned Land. TCC has a valid permit to "stake and prospect" on the Inuit Owned Lands. A land use permit application is pending from INAC for exploration on crown land.

TCC upon completion of the program will restore the land to its original form and condition as best it can and as best is practicable and possible.

TCC will operate one camp in the Coppermine River area. The specific location is as yet undecided because company personnel have not been on the ground to determine each locations' suitability for a campsite. Thus, the company is applying for permission for two sites as indicated in the permit application but will only occupy one.

SCHEDULE

Final reclamation of the camp will be carried out after the completion of the season's exploration program prior to expiration of the land use permits and water license unless these permits have been renewed. At the end of the phase I program in 2014, the camp will be completely torn down and all gear, equipment, camp structures etc. will be flown out for storage in Kugluktuk or Yellowknife. All waste will be removed from site. Only the drill core will remain at site properly stored for future reference.

INFRASTRUCTURE

Planned Camp Structures (see drawing of camp layout)

- Wood frame canvas tents
- Outhouse toilet

Vehicles and Heavy Equipment

- None in camp
- Small generator for camp electricity (light equipment)

Drilling Equipment

- One KD150 diamond drill
- One Admirac Water Pump with 2km of hoseline, water tanks, 250m of drill rods

Trenching Equipment

- Mechanized trenching is not planned for 2014. Any test pits required will be minimal and dug by hand. A small lightweight backhoe will be flown in in 2015 for mechanized trenching.

Air Transport

- Bell 206B Jet Ranger helicopter for crew transport

SEASONAL SHUTDOWNS

Buildings and Camp Gear

- All buildings will be dismantled and all gear and equipment will be flown to Kugluktuk or Yellowknife for storage. Nothing will be left at site except drill core.

Fuel, Drill and Drill Supplies

- All unconsumed fuel will be flown out to Kugluktuk for storage or sold to other nearby operators. All empty fuel drums, propane cylinders and other fuel containers will be flown out. Nothing will be left at site over the winter except for drill core.
- The drill with all its' ancillary equipment (additives, rods, hose, pumps etc.) will be flown out. No drill equipment will be left at site.
- All drill sites will be cleaned up and each drill site will be reclaimed as best as possible to its natural state. Each site will be inspected for contamination. Any remaining waste will be incinerated or flown out to be disposed of appropriately in facilities in Kugluktuk.

WASTE

- Combustible waste will be incinerated in a burn barrel. The ash will be buried. The non-combustible waste will be flown out and disposed of appropriately in appropriate facilities in Kugluktuk.
- Gray Water Sump will be filled in.
- Black Water Sewage Sump will be filled in.
- Any soil around camp that has become contaminated and gone unnoticed will be treated as per the Spill Prevention and Response Plan and the Hazardous Waste Management Plan.

FINAL ABANDONMENT AND RESTORATION

- All equipment, camp structures, camp gear and fuel will be removed from site prior to expiration of the permit. Only the drill core will remain in appropriately labeled stacks.
- All non-combustible waste will be flown out to Kugluktuk to be disposed of in the appropriate facilities.
- All unconsumed fuel will be flown out or sold to other nearby operators. All empty fuel drums, propane cylinders and other fuel containers will be flown out.

Drill Sites

- The drill with all its' ancillary equipment (additives, rods, hose, pumps etc.) will be flown out. No drill equipment will be left at site.
- All drill sites will be cleaned up and each drill site will be reclaimed as best as possible to its natural state. Each site will be inspected for contamination. Any remaining waste will be incinerated or flown out to be disposed of appropriately in facilities in Kugluktuk.
- Any soil around the drill site that has become contaminated and gone unnoticed will be treated as per the Spill Prevention and Response Plan and the Hazardous Waste Management Plan.
- Sludge sumps will be filled in.
- Each drill hole collar will be monumented with either a short piece of drill pipe or a piece of 2x4 lumber for future reference and collar locations.
- Any artesian water encountered downhole will be sealed off and plugged with cement so that water does not continually run out of the drill hole.
- Photographs will be taken of each drill site before and after completion of each hole.

Trenches

- Any hand dug trenches will be filled in and leveled prior to completion of the program.

Drill Core

The drill core will be stored at the camp site in stacks and each hole appropriately labeled. These stacks will be on well drained pads and fortified to withstand the elements for long term storage. These must be accessible for future reference.

INSPECTION AND DOCUMENTATION

A thorough inspection of the camp site, all drill sites and any hand-dug trench sites will be conducted prior to closure and de-mobilization. Photos will be taken to document the conditions prior to leaving the site and all appropriate agencies will be notified once the cleanup and de-mobilization is complete. The photos will be included in the final closure reports to be submitted to INAC and the Nunavut Water Board.

EMERGENCY CONTACT NUMBERS

| | |
|---|--------------------|
| Donald Penner, President & Director of Tundra Copper Corp | cell: 778-212-1950 |
| Email: dpenner@tundracopper.com | |
| Cor Coe, CEO of Tundra Copper Corp | cell: 604-817-4753 |
| ccoe@tundracopper.com | |
| Department of Environment and Natural Resources -Spill Reports 24hr | 867-920-8130 |
| Department of Fisheries and Oceans | 867-979-8000 |
| INAC Land Use Department | 867-975-4283 |
| Nunavut Water Board | 867-360-6338 |

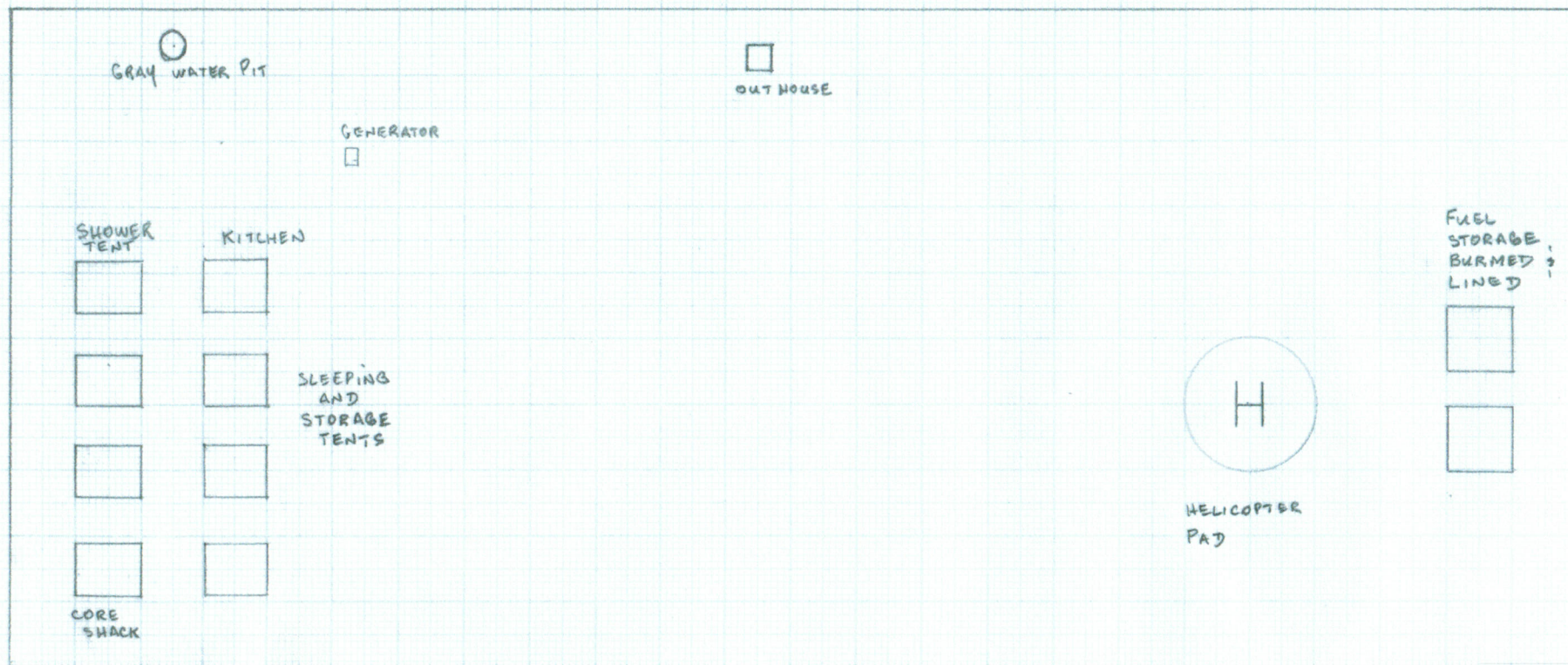

CAMP AREA
APPROX 0.6 HECTARES

↑
NORTH

TUNDRA COPPER CORP
CAMP LAYOUT
SCALE 1cm = 5m
DONALD PENNER
MAY 12, 2014
FIGURE 5