

Table of Contents

	Page
1. Preamble	3
2. Introduction	3
3. Schedule	3
4. Infrastructure	4
5. Seasonal Shutdowns	4
6. Final Abandonment and Restoration	5

Kirwan Lake Remote Camp Abandonment and Restoration Plan

1. Preamble

This Abandonment and Restoration (A&R) Plan is in effect as of June 01, 2005. It applies specifically to the Mountain Lake Claims, Dismal Lake Permits, Dismal Lake claims and the Kirwan Lake Camp, which will be located at approximately N 67° 18', W 116° 53', see attached map. The camp will be constructed to support a mapping and sampling program to explore for uranium once the appropriate approvals, permits and licences are in place. A DIAND Land Use Permit and Water Licence have been applied for.

2. Introduction

This A&R Plan has been prepared specifically for the Kirwan Lake Camp located on the western shore of Kirwan Lake. The location of the camp was chosen based on the need for deep water, closeness to Kugluktuk for staging and supplies and the proximal location to the claims and permits. The temporary camp will be located approximately 100 km SW of Kugluktuk. At peak times, the camp could populate a maximum of 22 people but for the most part there will be 18 people. The camp will operate from August through to late September this year and early April until mid September the next.

This project is in the very early stages of exploration. The project being applied for consists of airborne surveys, mapping and soil sampling, the project summary describes in more detail the activities planned. A separate application is being submitted for a drill program that would start in 2006. The camp being applied for will be temporary, but it is our desire to have the camp remain in position for the duration of the land use permit and water licence. No buildings, equipment or waste will remain once the project is complete.

3. Schedule

The final restoration of the camp site will begin once the program is complete. All work under the Abandonment and Restoration Plan will be completed prior to the date of expiry of the land use permits and water licence unless a renewal is applied for. Empty fuel drums will be removed from site regularly. Once a fuel cache is retired, a thorough inspection will be conducted. Any contamination will be cleaned up according to the Spill Contingency Plan and debris will be removed from the site.

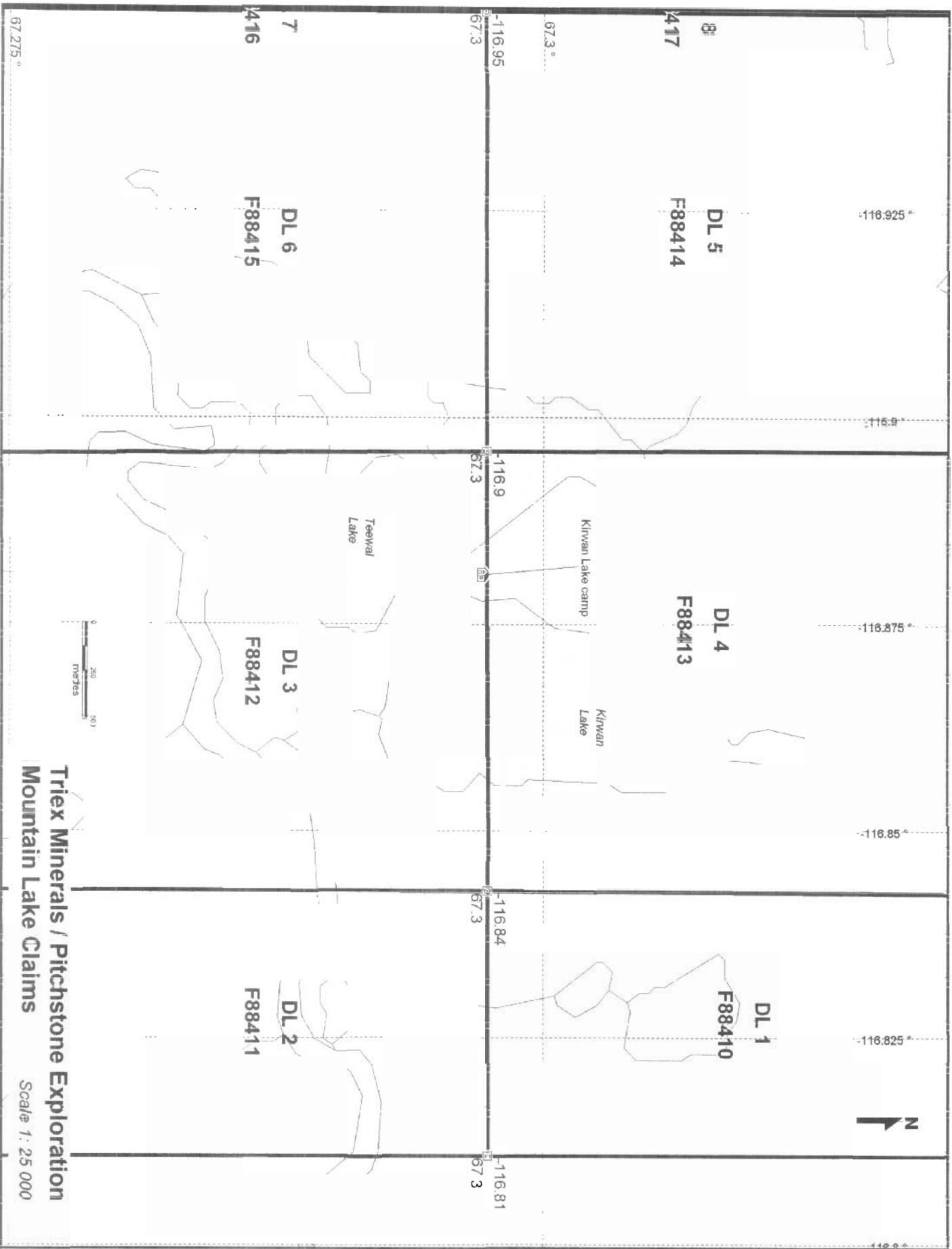

4. Infrastructure

1 storage tent
1 dry tent
1 kitchen tent
1 office tent
6 sleep tents
1 generator shack
1 toilet shack
fuel storage area
burn barrel – incineration

Seasonal Shutdown

Buildings and Contents

All tents will be dismantled and the canvas tents removed from site for drying and proper storage. Wood structures (generator and toilet shacks) and wooden floors of tents will be kept secured. Wooden bed frames will be turned upside down and secured to the wooden floors for over-winter storage. The generator will be removed from site for servicing and storage.

Water system

Pumps and hoses will be drained and dismantled. Pumps will be removed from site for servicing and storage. Hoses will be stored on site in the generator shack.

Fuel caches and Chemical Storage

An inventory will be conducted prior to leaving at the end of the field season. A thorough inspection of all fuel caches will be completed and empty fuel drums will be removed from site.

Chemicals will not be stored on site over winter. All chemicals, including cleaning products, will be removed from site for storage and or disposal.

Waste

Combustible waste: All combustible waste will be incinerated. The burn barrel will be stored at the camp site for use the following year.

Grey water sump: The grey water sump will be inspected, marked and covered securely for the winter.

Black water: The latrine sump will be inspected, marked and covered securely for the winter.

Drill sites – Not applicable

This Plan deals specifically with the Kirwan Lake camp.

Contamination Clean Up

Any soil around camp that has become contaminated and gone unnoticed will be treated as per the Spill Contingency Plan. Before and after photos will be taken to document the contamination and the clean up.

Inspection and Documentation

A complete inspection will be conducted of all areas prior to seasonal closure. Photos will be taken to document the conditions prior to leaving the site for the winter. A full inventory will be conducted.

Final Abandonment and Restoration

Buildings and Contents

All buildings will be dismantled and removed. All wooden structures including floors will either be burned or removed.

Equipment

All equipment, including pumps, generators, etc. will be dismantled and removed from the project area.

Fuel caches and Chemical Storage

All fuel drums will be removed. All areas where there have been fuel caches will be thoroughly inspected. Any contamination will be cleaned up as well as any debris removed. Contaminated soil will be handled as per the Spill Contingency Plan. Final photos will be taken of all fuel caches for inclusion in the final report.

All chemicals will be removed from site. Areas where chemicals have been stored will be inspected to ensure that there has been no contamination.

Sumps

All sumps will be inspected to ensure that there is no leaching or run-off. Sumps will be back-filled and leveled as required. Final photos will be taken.

Camp Site

A final inspection of the camp site area will be conducted to ensure that there is no waste left behind. All wastes that are not burnable will be removed from site.

Drill Sites

Not applicable.

Contamination Clean Up

Any contamination will be treated as per the Spill Contingency Plan. Before and after photos will be taken to document the contamination and the clean up.

Inspection and Documentation

A complete inspection will be conducted of all areas prior to closure. Photos will be taken to document the conditions prior to leaving the site for use in the final plan. All appropriate agencies will be contacted and notified once the final clean up has been conducted.

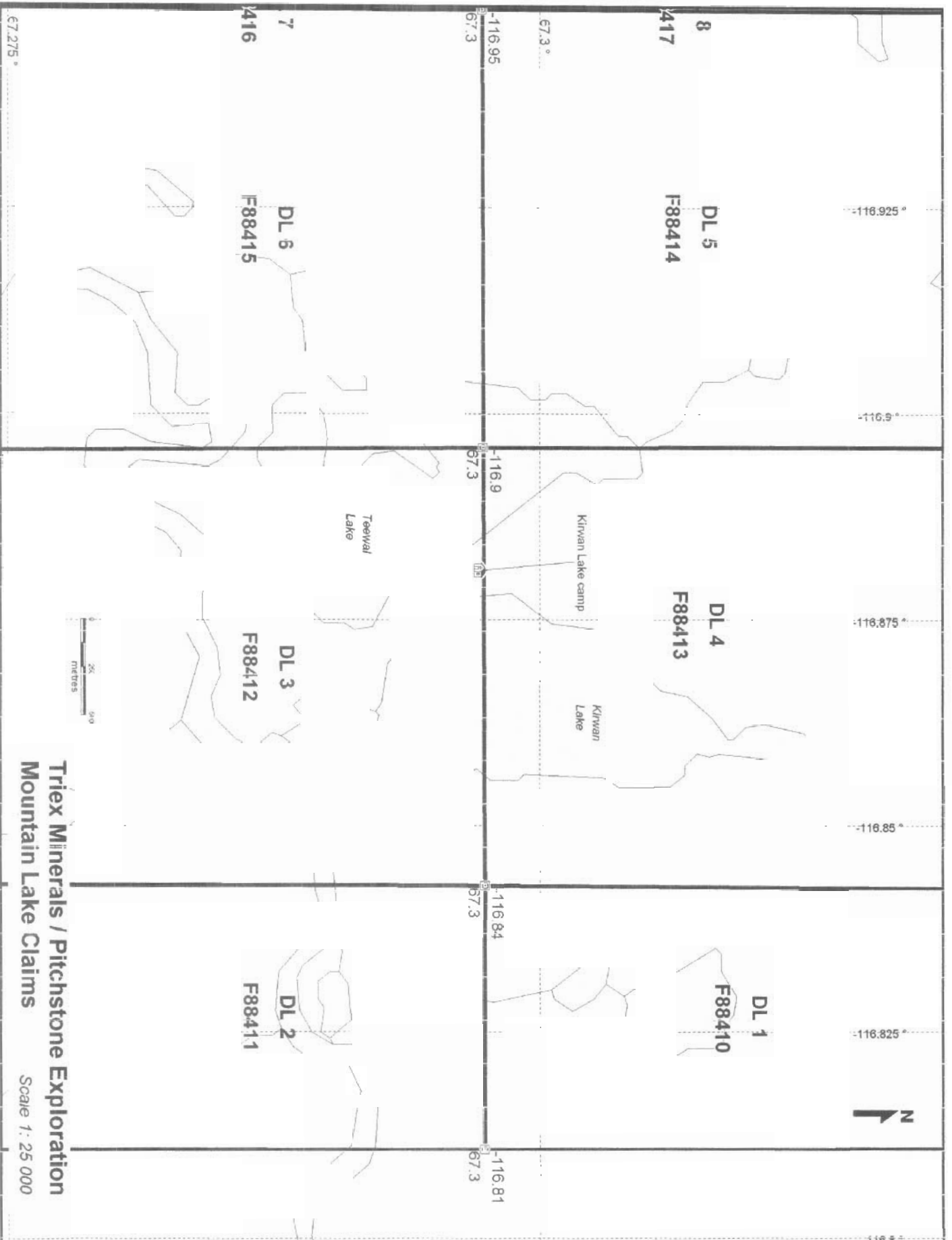

Triex Minerals / Pitchstone Exploration
Mountain Lake Claims

Scale 1: 25 000

