

SECTION 1  
SCALE - 1 : 10  
S1, S2

SECTION 2  
SCALE - 1 : 10  
S1, S2

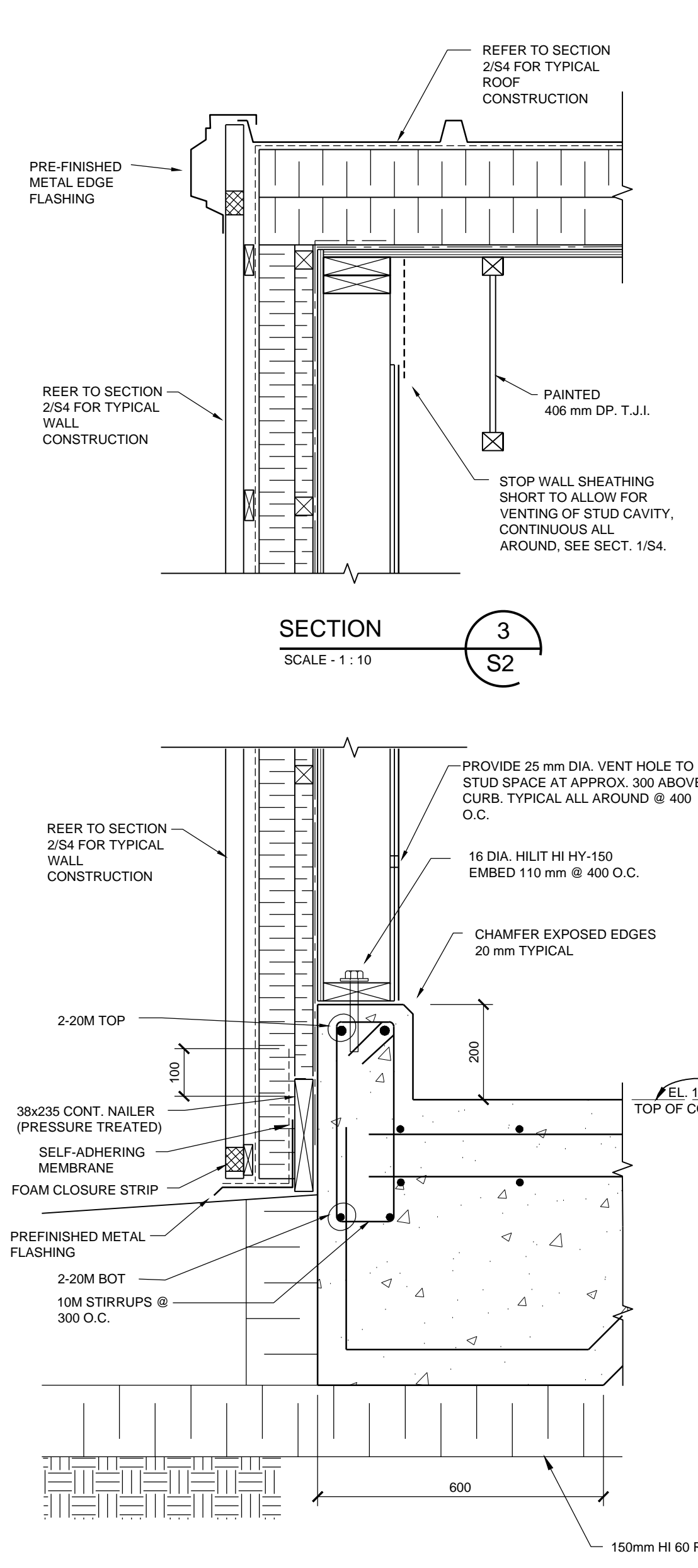

SECTION 3  
SCALE - 1 : 10  
S2

SECTION 4  
SCALE - 1 : 10  
S1

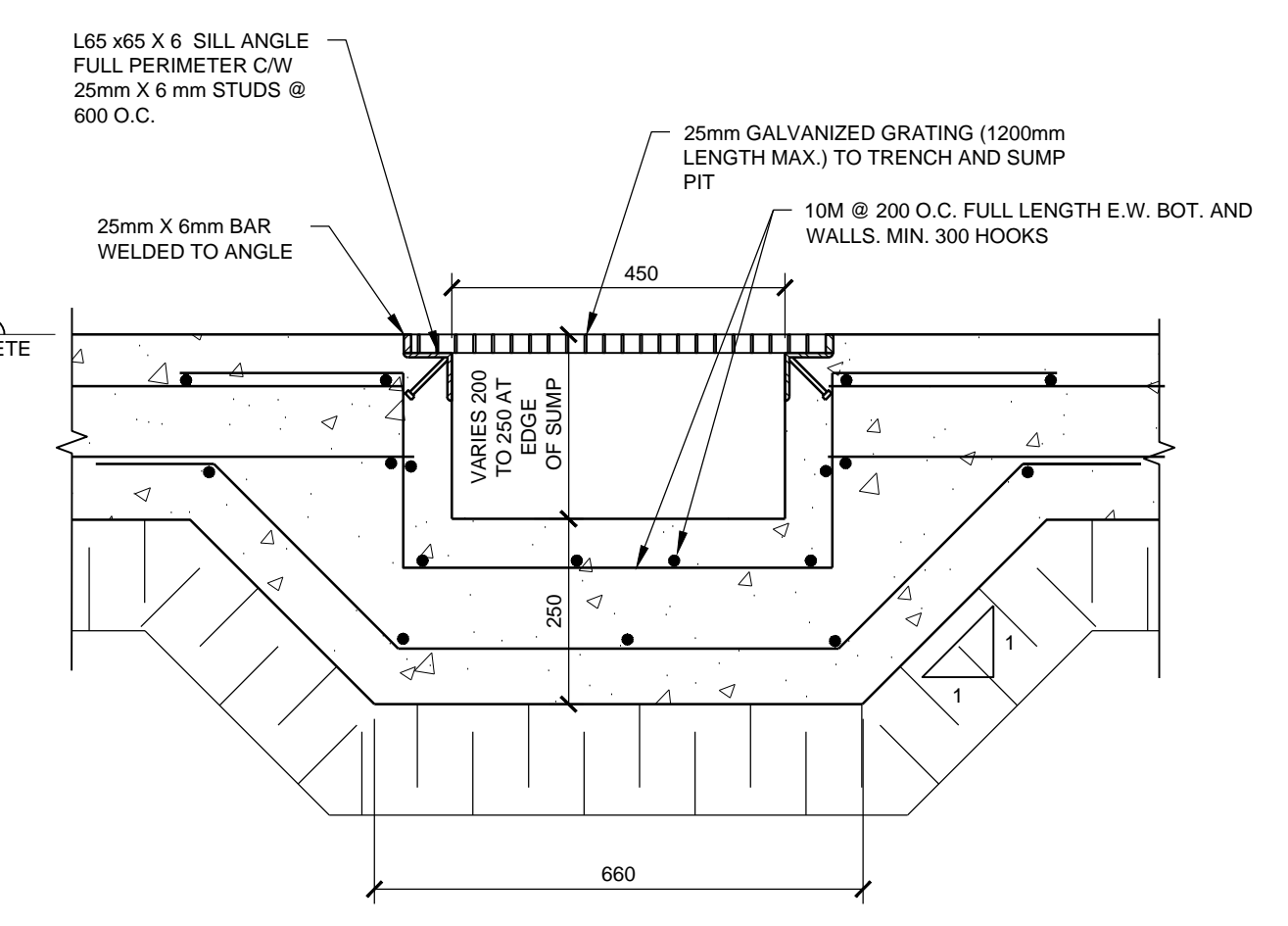

SECTION 5  
SCALE - 1 : 10  
S1

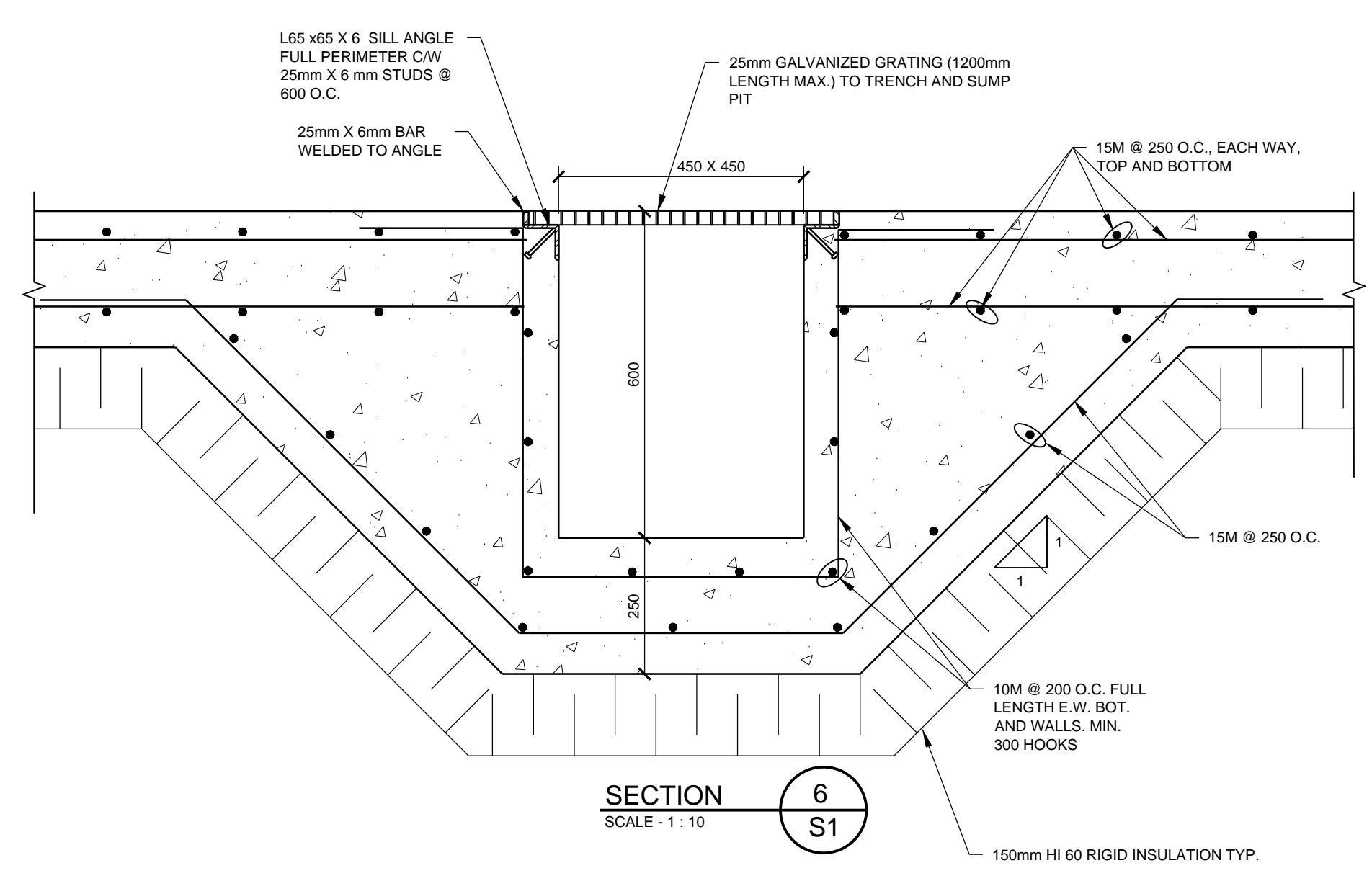

SECTION 6  
SCALE - 1 : 10  
S1

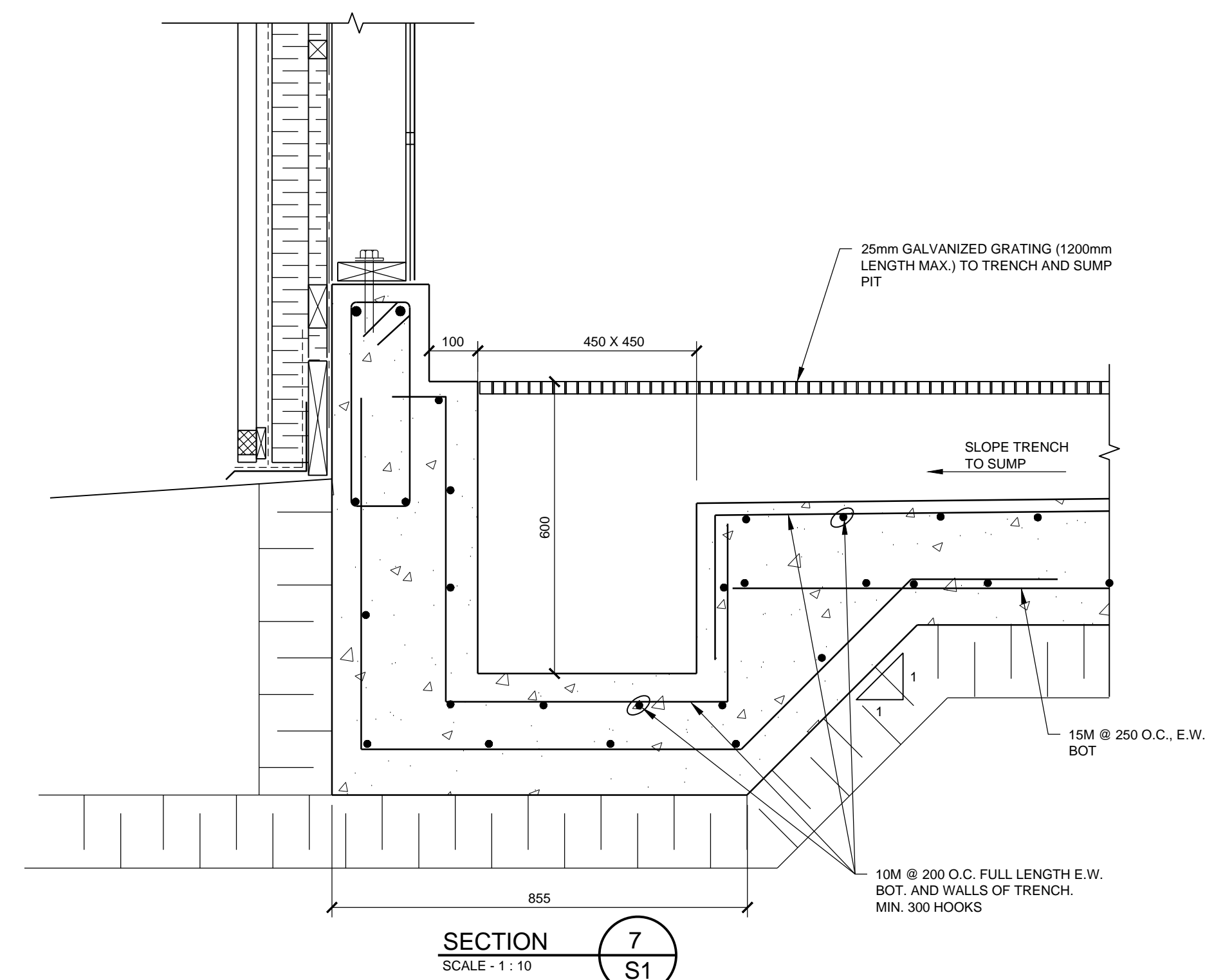

SECTION 7  
SCALE - 1 : 10  
S1

NOTES: GENERAL CONTRACTOR TO VERIFY ALL DIMENSIONS WITH FINAL ARCHITECTURAL AND MECHANICAL DRAWINGS. NOTIFY THE ENGINEERS OF ANY ERRORS AND/OR OMISSIONS PRIOR TO CONSTRUCTION FOR DIRECTION. DO NOT SCALE THIS DRAWING.

No.	DESCRIPTION	DATE	BY	APPD
0	90% SUBMISSION	06/12/2013	M.N. K.A.B.	

REVISIONS

**exp.** Services Inc.  
1-813-888-1888 | 1-813-225-7337  
2650 Queenville Drive, Suite 100  
Ottawa, ON K2B 9H4  
Canada  
www.exp.com  
• BUILDINGS • EARTH & ENVIRONMENT • ENERGY •  
• INDUSTRIAL • INFRASTRUCTURE • SUSTAINABILITY •

CLIENT  
**GOVERNMENT OF NUNAVUT**  
DEPARTMENT OF COMMUNITY  
AND GOVERNMENT SERVICES

PROJECT  
**CORAL HARBOUR, NUNAVUT**  
WATER TRUCK FILL STATION  
PROJECT: 11-3018

TITLE  
**SECTIONS**

design by	K.A. BAKER	project no.	OTT-00203694-A0
drawn by	M. NUGENT	drawing no.	S4
checked by	K.A. BAKER		
date	NOV. 2013		
scale	AS NOTED		