

NOTE:
THE OPERATIONS OF THE SEWAGE TREATMENT FACILITY
MUST BE MAINTAINED WITHOUT INTERRUPTION
THROUGHOUT DURATION OF PLANT UPGRADES.

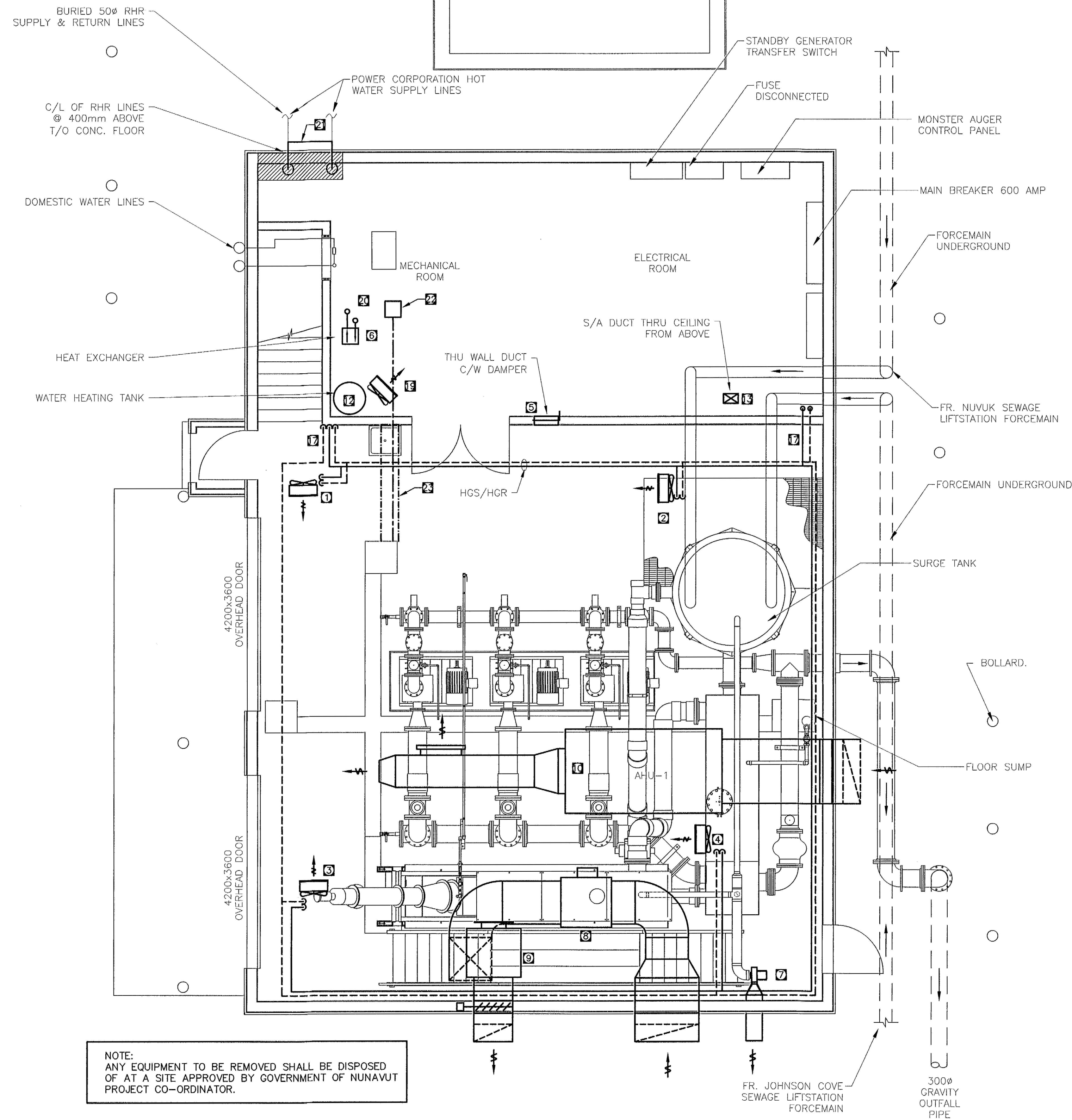

DEMO - EXISTING MAIN FLOOR PLAN
1:50

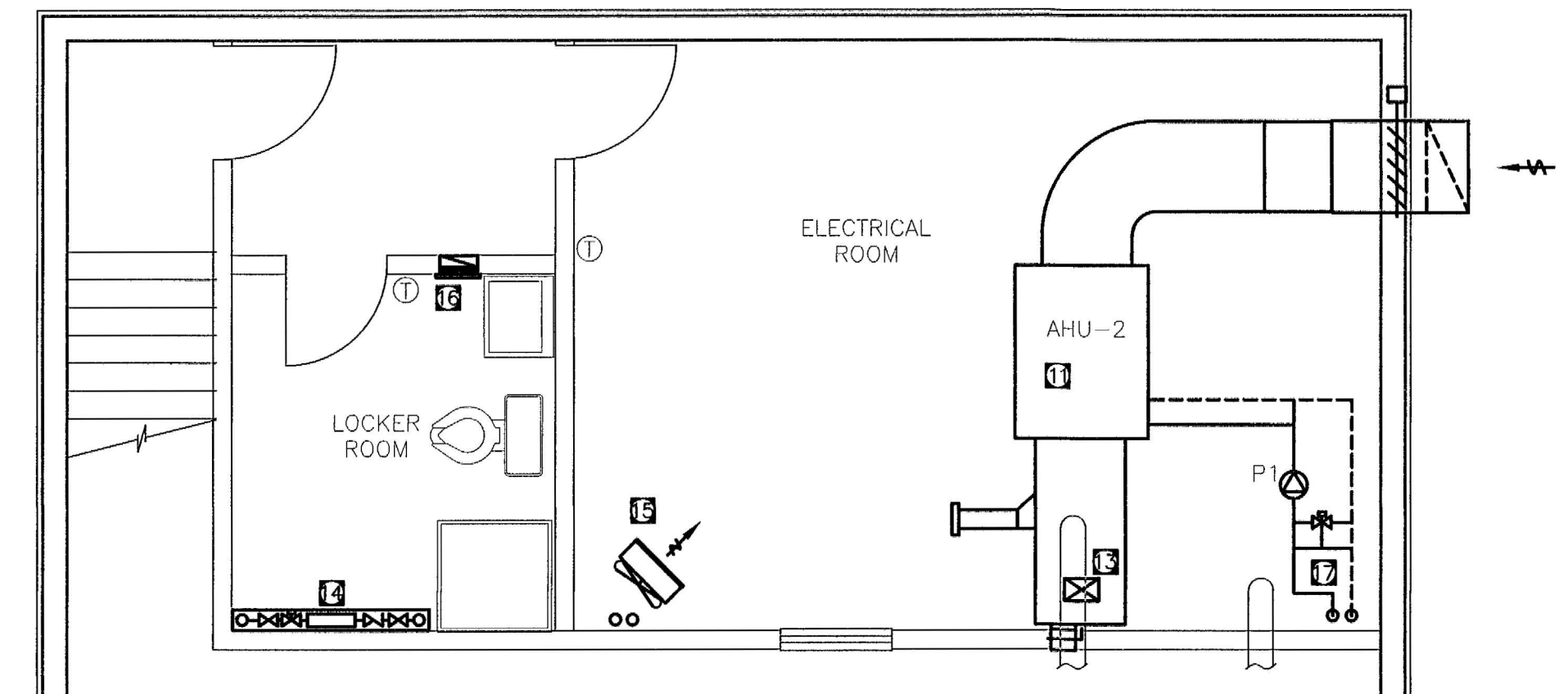
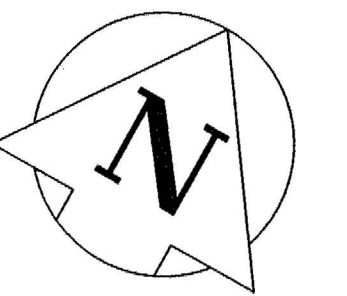

DEMO - SECOND FLOOR LEVEL
1:50

EXIST. SEWAGE PLANT DECOMMISSIONING NOTES

- 1 REMOVE & RELOCATE OF UNIT HEATER. TO BE RE-USED IN NEW TRUCK BAY.
- 2 REMOVE & RELOCATE OF UNIT HEATER. TO BE RE-USED IN NEW TRUCK BAY.
- 3 REMOVE & RELOCATE OF UNIT HEATER. TO BE RE-USED IN NEW TRUCK BAY.
- 4 REMOVE & RELOCATE OF UNIT HEATER. TO BE RE-USED IN NEW TRUCK BAY.
- 5 REMOVE THRU WALL DUCT AND SEAL OPENING TO MATCH EXISTING.
- 6 EXISTING PLATE HEAT EXCHANGER TO BE RELOCATED
- 7 REMOVE & DISPOSE OF EXHAUST FAN, REPLACE WITH EXPLOSION PROOF MODEL.
- 8 REMOVE & DISPOSE OF EXHAUST FAN C/W ALL ASSOCIATED HARDWARE, WALL PENETRATIONS TO BE PATCHED TO MATCH EXISTING.
- 9 REMOVE AND DISPOSE OF EXHAUST FAN, WALL PENETRATIONS TO BE PATCHED TO MATCH EXISTING.
- 10 REMOVE AND DISPOSE OF AHU-1
- 11 REMOVE AND DISPOSE OF AHU-2
- 12 EXISTING HOT WATER STORAGE TANK TO BE RELOCATED
- 13 EXISTING DUCT WORK TO BE REMOVED, WALL/FLOOR PENETRATIONS TO BE PATCHED TO MATCH EXISTING.
- 14 EXISTING FIN TUBE RADIANT HEATER TO REMAIN.
- 15 EXISTING RADIANT HEATER TO REMAIN.
- 16 EXISTING EXHAUST FAN TO REMAIN.
- 17 REMOVE AND DISPOSE OF ALL EXISTING HYDRONIC HEATING PIPE WORK LOCATED IN PROCESS ROOM.
- 18 DELETED
- 19 EXISTING UNIT HEATER TO BE RELOCATED
- 20 REMOVE AND DISPOSE OF ALL EXISTING HYDRONIC HEATING PIPE WORK LOCATED IN MECHANICAL ROOM.
- 21 CUT BACK AND LOOP PIPING, WITH FLANGED FITTINGS, AS CLOSE TO GRADE AS REASONABLE, EXISTING HOT WATER LINES FROM POWER CORPORATION. (TYP. OF 2)
- 22 REMOVE EXISTING GRATED FLOOR DRAIN COVER. DRAIN TO BE PLUGGED AND PATCHED WITH CONCRETE TO MATCH EXISTING FLOOR SURFACE. FLOOR DRAIN PIPE TO BE ABANDONED.
- 23 SAW-CUT EXISTING CONCRETE FLOOR SECTION TO SUIT NEW PLUMBING MODIFICATIONS REQUIRED FOR NEW FLOOR DRAIN, CLEANOUT & RELOCATED SINK. (FLOOR TO BE PATCHED TO MATCH EXISTING UPON COMPLETION)



1. This drawing is the exclusive property of Nuna Burnside and the reproduction of any part without prior written consent of this office is strictly prohibited.
2. The contractor shall verify all dimensions, levels, and datum on site and report any discrepancies or omissions to this office prior to construction.
3. This drawing is to be read and understood in conjunction with all other plans and documents applicable to this project.
4. Do not scale the drawings.

Issue / Revision	Date
1 ISSUED FOR 66% SUBMISSION	NOVEMBER 2012
2 ISSUED FOR 99% SUBMISSION	JANUARY 2012
3 ISSUED FOR TENDER	FEBRUARY 2013
4 REVISED AS PER ADDENDUM 1 TO 4 AND ISSUED FOR CONSTRUCTION	APRIL 2013

PERMIT TO PRACTICE
Nuna Burnside Engineering and Environmental Ltd.
Signature: *G. J. Popowich*
Date: *Mar 27/13*
PERMIT NUMBER: P 535
The Association of Professional Engineers,
Geologists and Geophysicists of NWT/NU

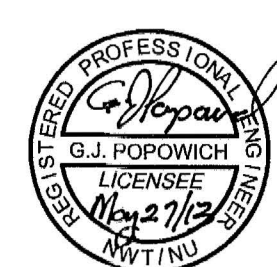

Nuna BURNSIDE
Nuna Burnside Engineering & Environmental LTD.
106B Scurfield Blvd., Winnipeg, Manitoba
telephone (204) 949-7110 fax (204) 949-7111
web www.neeganburnside.com

Client
GOVERNMENT OF NUNAVUT
COMMUNITY & GOVERNMENT
SERVICES
RANKIN INLET
SEWAGE TREATMENT PLANT

Drawing Title		
DEMOLITION - EXISTING MECHANICAL EQUIPMENT		
Drawn By A.H.	Checked By D.Mack.	Drawing No. M-1
Scale 1:50	Project No. 300031281	