

1 NEW PIPELINE SITE PLAN
C100 1:2500

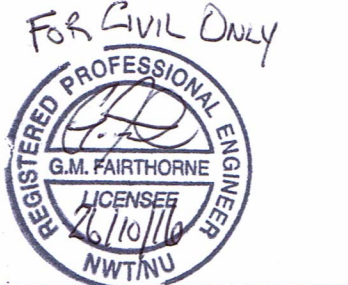

1. THIS DRAWING IS NOT TO BE SCALED.
2. CONTRACTOR IS TO VERIFY ALL DIMENSIONS ON SITE, INCLUDING EXTERIOR R.O. AND EXISTING INTERIOR R.O.
3. ALL WORK TO BE COMPLETED IN STRICT ACCORDANCE WITH THE NATIONAL BUILDING CODE OF CANADA 2010 AND MANUFACTURER'S INSTRUCTIONS.
4. ALL PARTIES USING THESE DRAWINGS SHALL REVIEW THEM PRIOR TO QUOTING AND CONSTRUCTION OF ANY AND ALL ASPECTS OF THE WORK AND REPORT ANY ERRORS, OMISSIONS AND/OR DEFICIENCIES IMMEDIATELY TO ARKTIS PIUSITIPPAA INC.



PERMIT TO PRACTICE
FAIRTHORNE ENGINEERING INC.
Signature: [Signature]
Date: Oct 26, 2016
PERMIT NUMBER: P 1035
NT/NU Association of Professional Engineers and Geoscientists

PERMIT TO PRACTICE
ARKTIS PIUSITIPPAA INC.
Signature: [Signature]
Date: Oct 26, 2016
PERMIT NUMBER: P 745
NWT/NU Association of Professional Engineers and Geoscientists



06	10/26/16	ISSUED FOR CONSTRUCTION
05	04/25/16	ADDENDUM NO. 1
04	03/28/16	RE-ISSUED FOR TENDER
03	04/16/14	ISSUED FOR TENDER
02	01/13/14	ISSUED AT 99% COMPLETE
01	11/25/13	ISSUED AT 50% COMPLETE
No.	DATE:	REVISION:



P.O. BOX 242, GJOA HAVEN, NU, X0B 1J0
TEL: (867) 446-0036 Fax: (866) 475-1147

THIS DRAWING IS THE SOLE PROPERTY OF ARKTIS PIUSITIPPAA INC.
UNAUTHORIZED REPRODUCTION IS NOT PERMITTED.

DRAWN BY:	KH, GF	DESIGNED BY:	KH, PB, GF
DATE:	OCTOBER 2016	CHECKED BY:	GF
SCALE:	AS NOTED	PLOT DATE:	10/26/16

PROJECT:
IMPROVEMENT OF WATER SUPPLY SYSTEM
IGLOOLIK, NUNAVUT

DRAWING NAME:
NEW TRUCK FILL STATION & PIPELINE SITE PLAN

DRAWING NO.:
C100

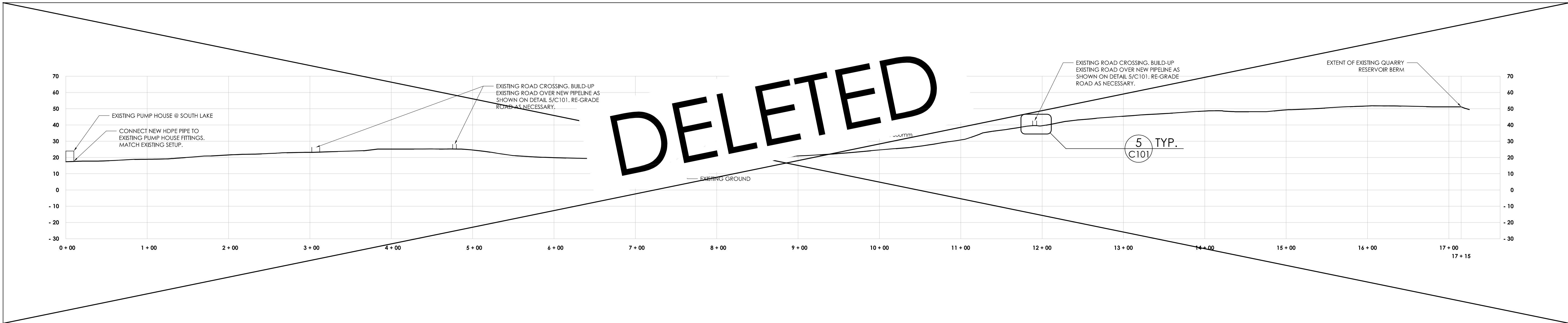

1 EXISTING & NEW FILLER PIPELINE PROFILE
1:2500

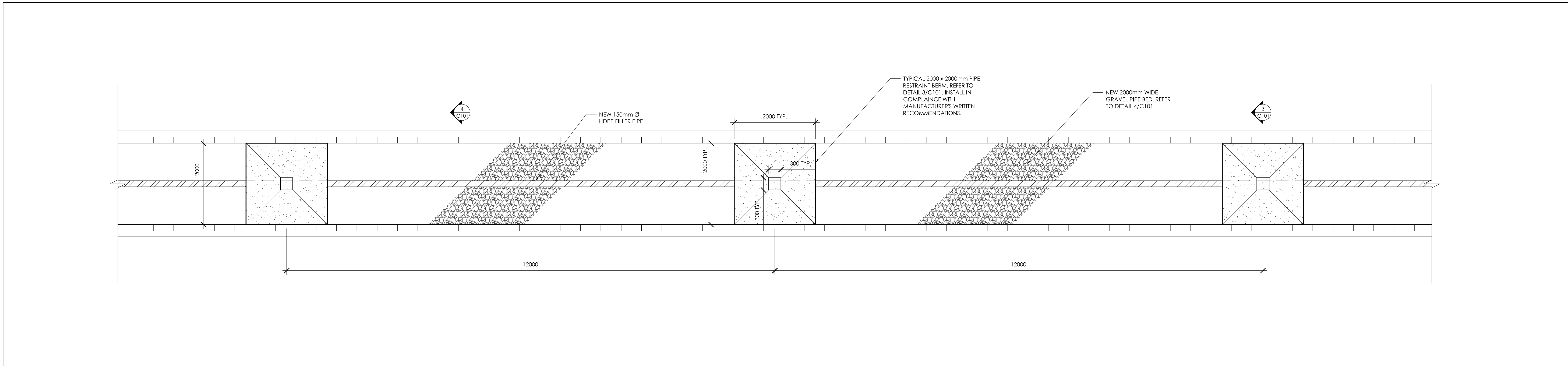

2 NEW FILLER PIPELINE (PARTIAL PLAN)
1:50

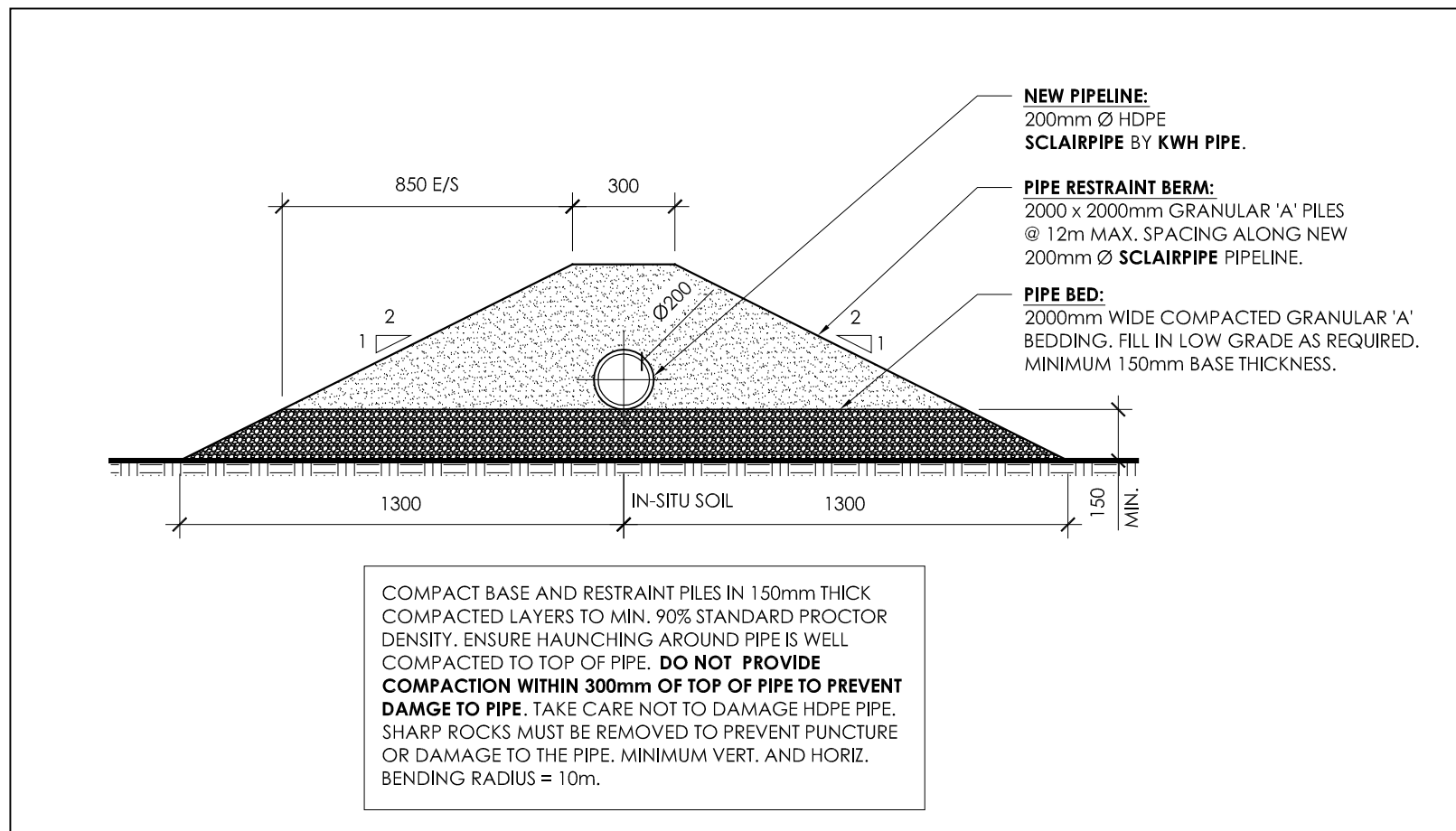

3 TYPICAL SECTION: PIPE RESTRAINT BERM
1:20

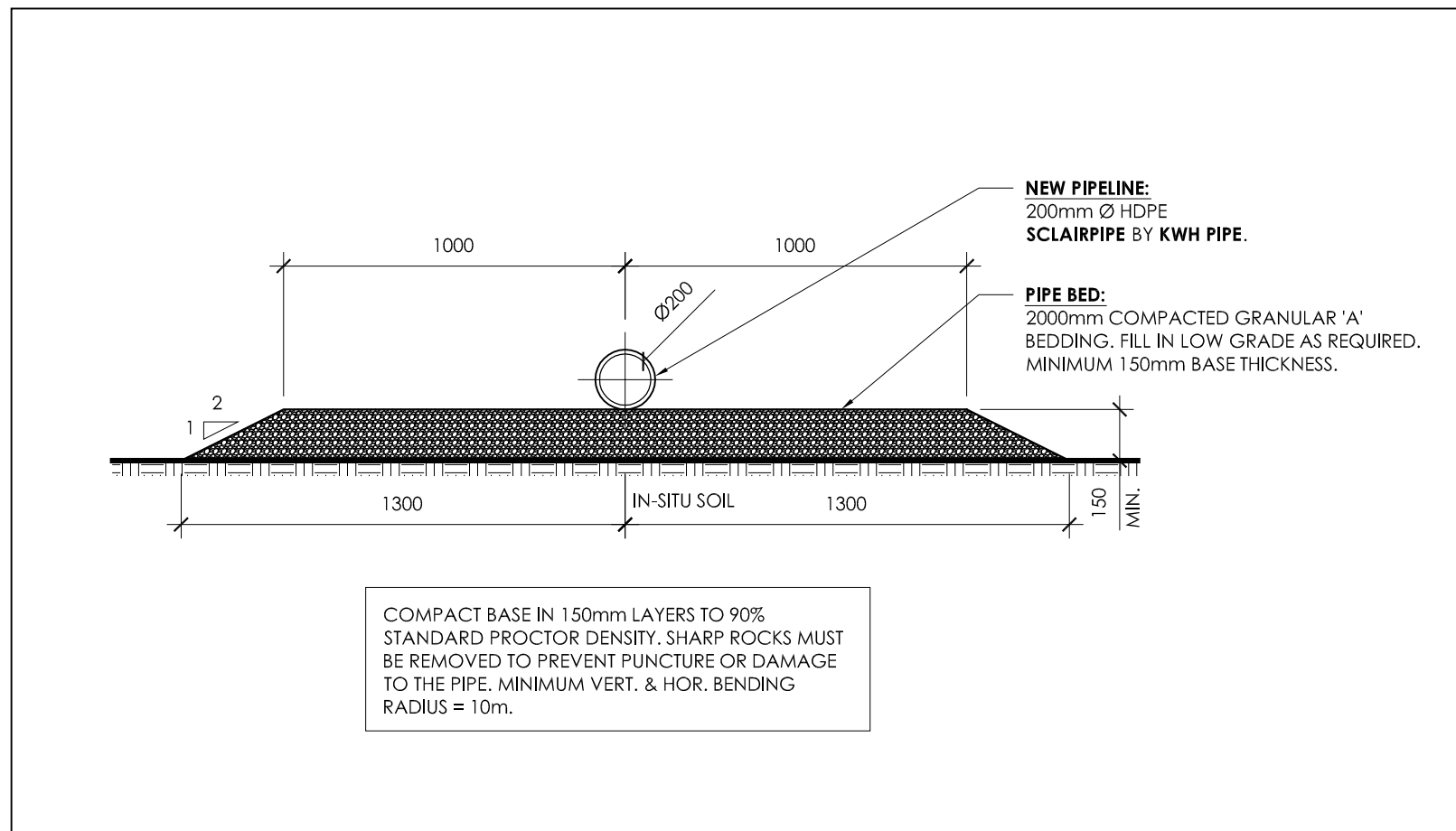

4 TYPICAL SECTION: PIPE UNRESTRAINED
1:20

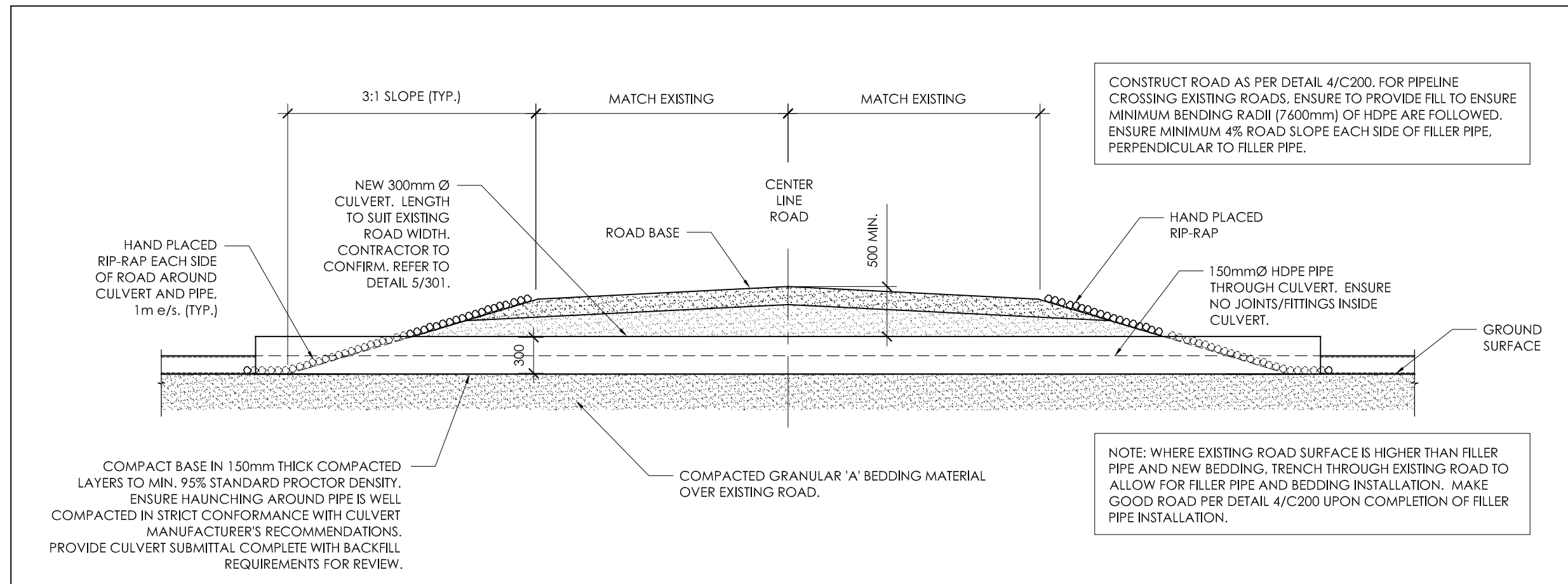

5 TYPICAL SECTION: ROAD OVER NEW PIPELINE
1:40



- THIS DRAWING IS NOT TO BE SCALED.
- CONTRACTOR IS TO VERIFY ALL DIMENSIONS ON SITE, INCLUDING EXTERIOR R.O. AND EXISTING INTERIOR R.O.
- ALL WORK TO BE COMPLETED IN STRICT ACCORDANCE WITH THE NATIONAL BUILDING CODE OF CANADA 2010 AND MANUFACTURER'S INSTRUCTIONS.
- ALL PARTIES USING THESE DRAWINGS SHALL REVIEW THEM PRIOR TO QUOTING AND CONSTRUCTION OF ANY AND ALL ASPECTS OF THE WORK AND REPORT ANY ERRORS, OMISSIONS AND/OR DEFICIENCIES IMMEDIATELY TO ARKTIS PIUSITIPPA INC.

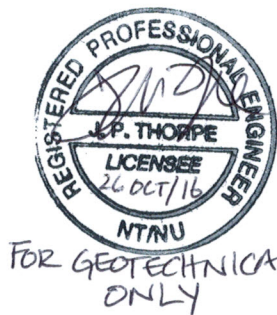
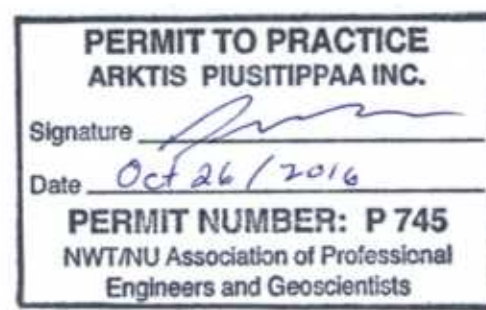
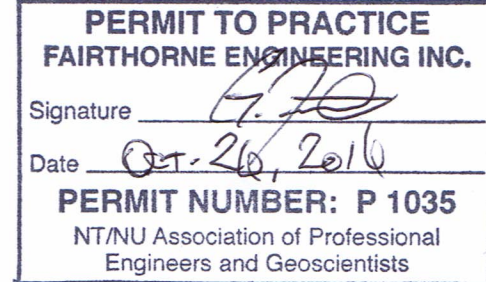
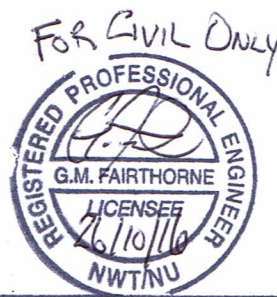

06	10/26/16	ISSUED FOR CONSTRUCTION
05	04/25/16	ADDENDUM NO. 1
04	03/28/16	RE-ISSUED FOR TENDER
03	04/16/14	ISSUED FOR TENDER
02	01/13/14	ISSUED AT 99% COMPLETE
01	11/25/13	ISSUED AT 50% COMPLETE

No.	DATE:	REVISION:
-----	-------	-----------



P.O. BOX 242, GJOA HAVEN, NU, X0B 1J0
TEL: (867) 446-0036 Fax: (866) 475-1147

THIS DRAWING IS THE SOLE PROPERTY OF ARKTIS PIUSITIPPA INC. UNAUTHORIZED REPRODUCTION IS NOT PERMITTED.

DRAWN BY:	KH, GF	DESIGNED BY:	KH, PB, GF
DATE:	OCTOBER 2016	CHECKED BY:	GF
SCALE:	AS NOTED	PLOT DATE:	10/26/16

PROJECT:
IMPROVEMENT OF WATER SUPPLY SYSTEM
IGLOOLIK, NUNAVUT

DRAWING NAME:
NEW FILLER PIPELINE PROFILE, PARTIAL PLAN & DETAILS

DRAWING NO.:
C101

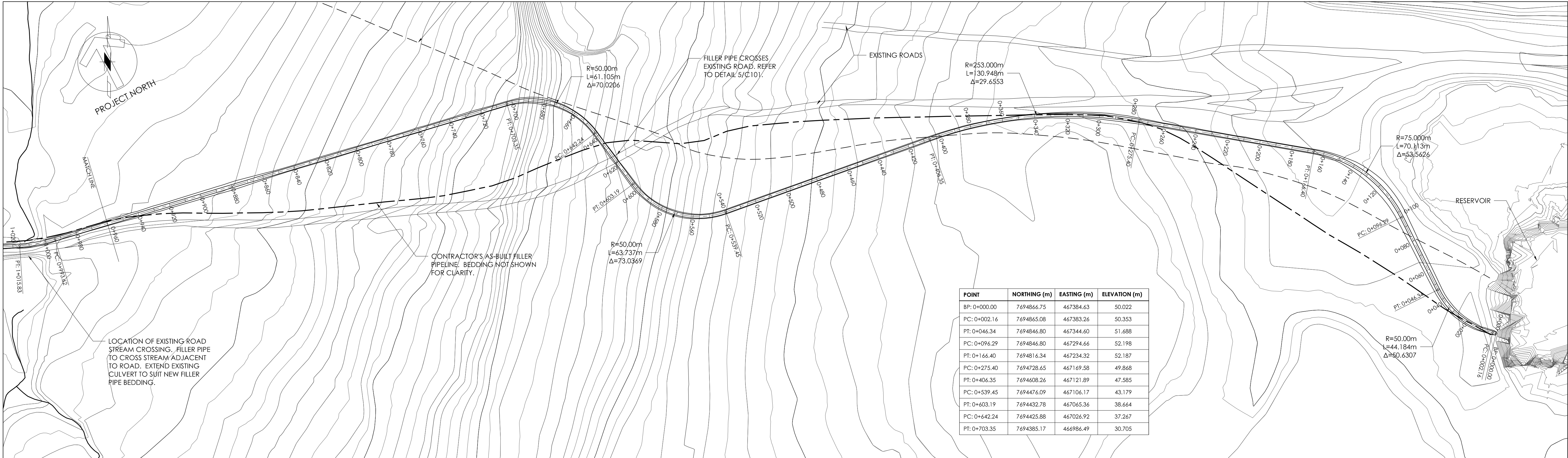

1 NEW FILLER PIPE PARTIAL PLAN
C102 1:1250

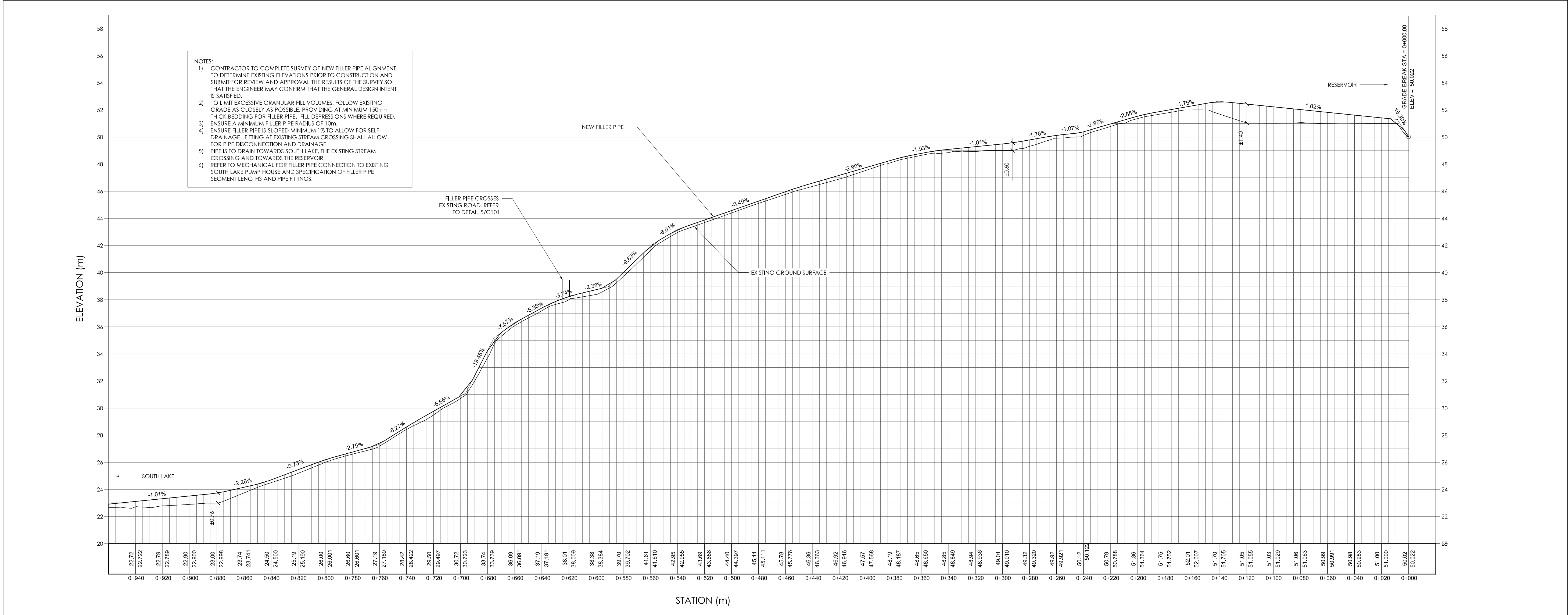

2 NEW FILLER PIPE PROFILE
C102 1:1500 H; 1:15000 V



1. THIS DRAWING IS NOT TO BE SCALED.
2. CONTRACTOR IS TO VERIFY ALL DIMENSIONS ON SITE, INCLUDING EXTERIOR R.O. AND EXISTING INTERIOR R.O.
3. ALL WORK TO BE COMPLETED IN STRICT ACCORDANCE WITH THE NATIONAL BUILDING CODE OF CANADA 2010 AND MANUFACTURER'S INSTRUCTIONS.
4. ALL PARTIES USING THESE DRAWINGS SHALL REVIEW THEM PRIOR TO QUOTING AND CONSTRUCTION OF ANY AND ALL ASPECTS OF THE WORK AND REPORT ANY ERRORS, OMISSIONS AND/OR DEFICIENCIES IMMEDIATELY TO ARKTIS PIUSITIPPAA INC.

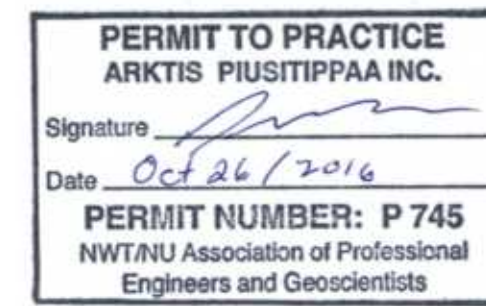
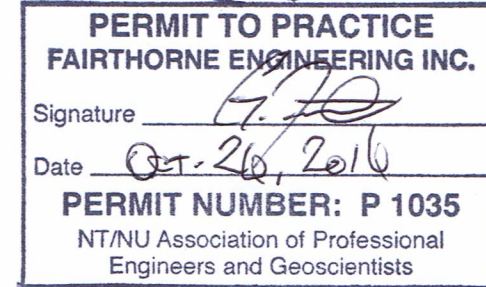
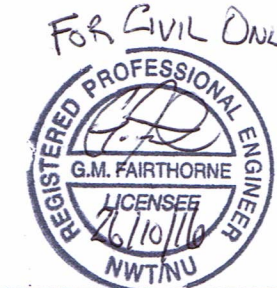

06	10/26/16	ISSUED FOR CONSTRUCTION
05	04/25/16	ADDENDUM NO. 1
04	03/28/16	RE-ISSUED FOR TENDER
03	04/16/14	ISSUED FOR TENDER
02	01/13/14	ISSUED AT 99% COMPLETE
01	11/25/13	ISSUED AT 50% COMPLETE
No.	DATE:	REVISION:



P.O. BOX 242, GJOA HAVEN, NU, X0B 1J0
TEL: (867) 446-0036 Fax: (866) 475-1147

THIS DRAWING IS THE SOLE PROPERTY OF ARKTIS PIUSITIPPAA INC.
UNAUTHORIZED REPRODUCTION IS NOT PERMITTED.

DRAWN BY:	KH, GF	DESIGNED BY:	KH, PB, GF
DATE:	OCTOBER 2016	CHECKED BY:	GF
SCALE:	AS NOTED	PLOT DATE:	10/26/16

PROJECT:
IMPROVEMENT OF WATER SUPPLY SYSTEM
IGLOOLIK, NUNAVUT

DRAWING NAME:
NEW FILLER PIPELINE PARTIAL PLAN AND PROFILE
(STA. 0+000 TO 0+960)

DRAWING NO.:
C102

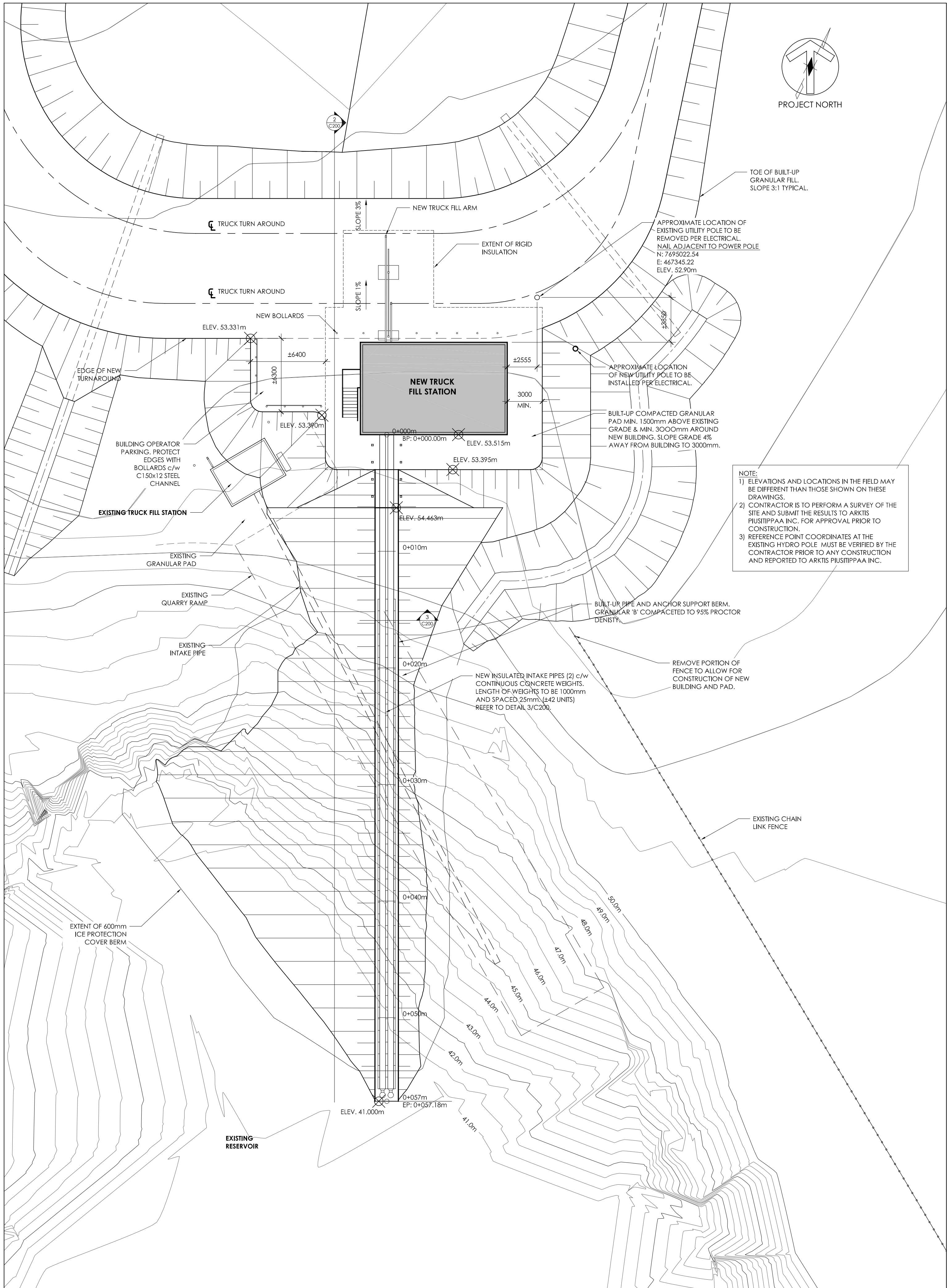

1
C200
NEW TRUCK FILL STATION SITE PLAN
1:200

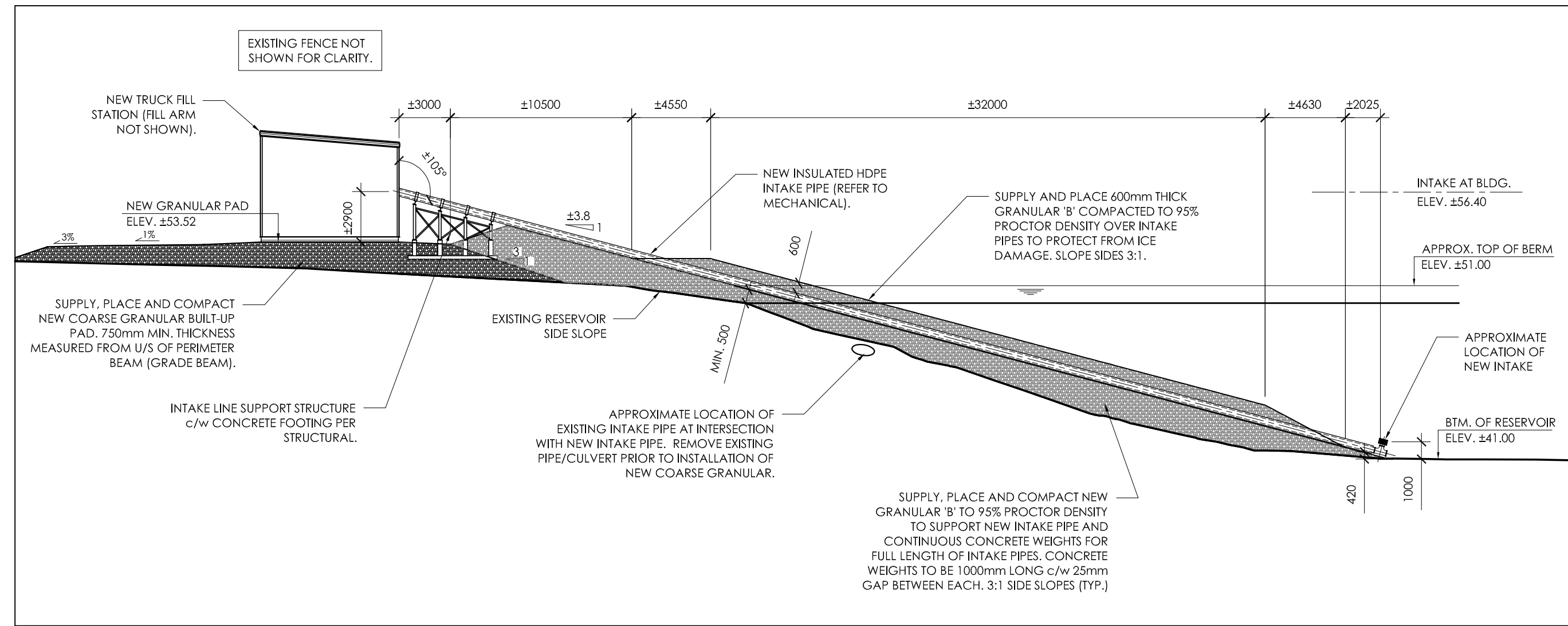

2
C200
NEW TRUCK FILL INTAKE PROFILE
1:200

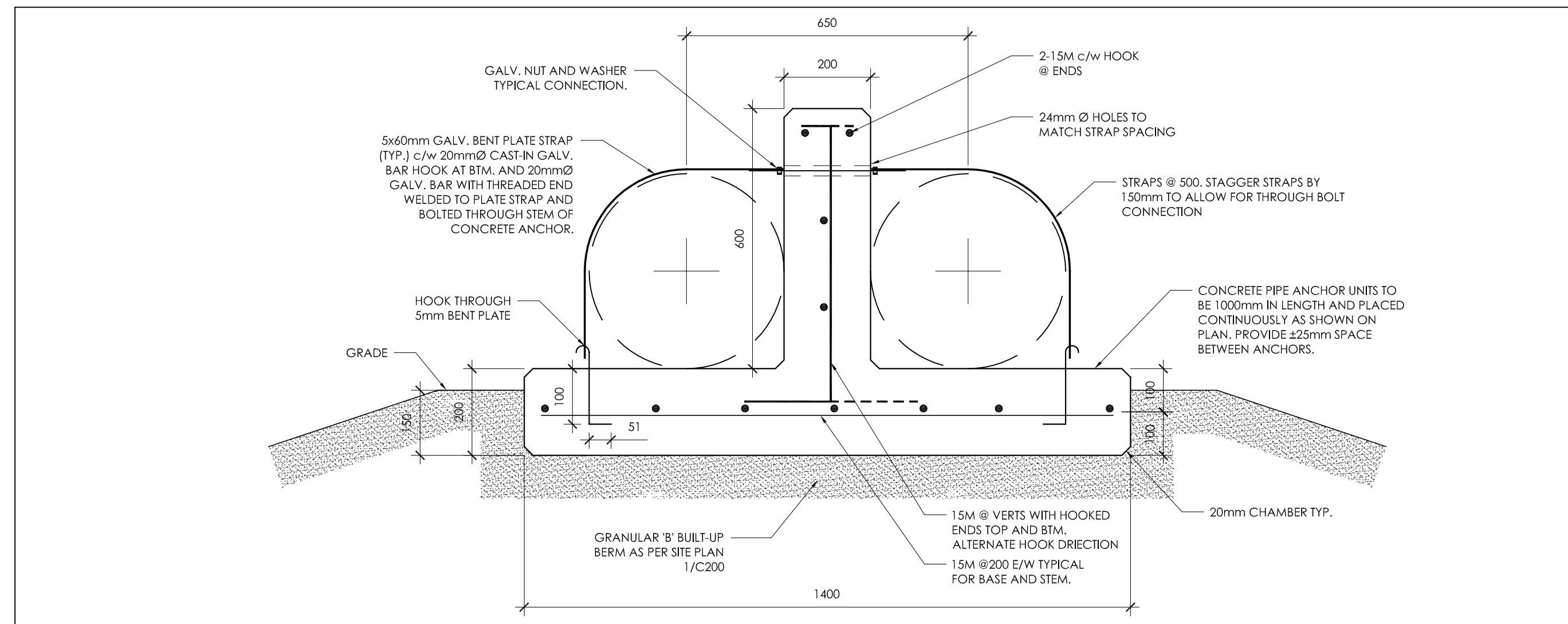

3
C200
TYPICAL INTAKE CONC. ANCHOR
1:10

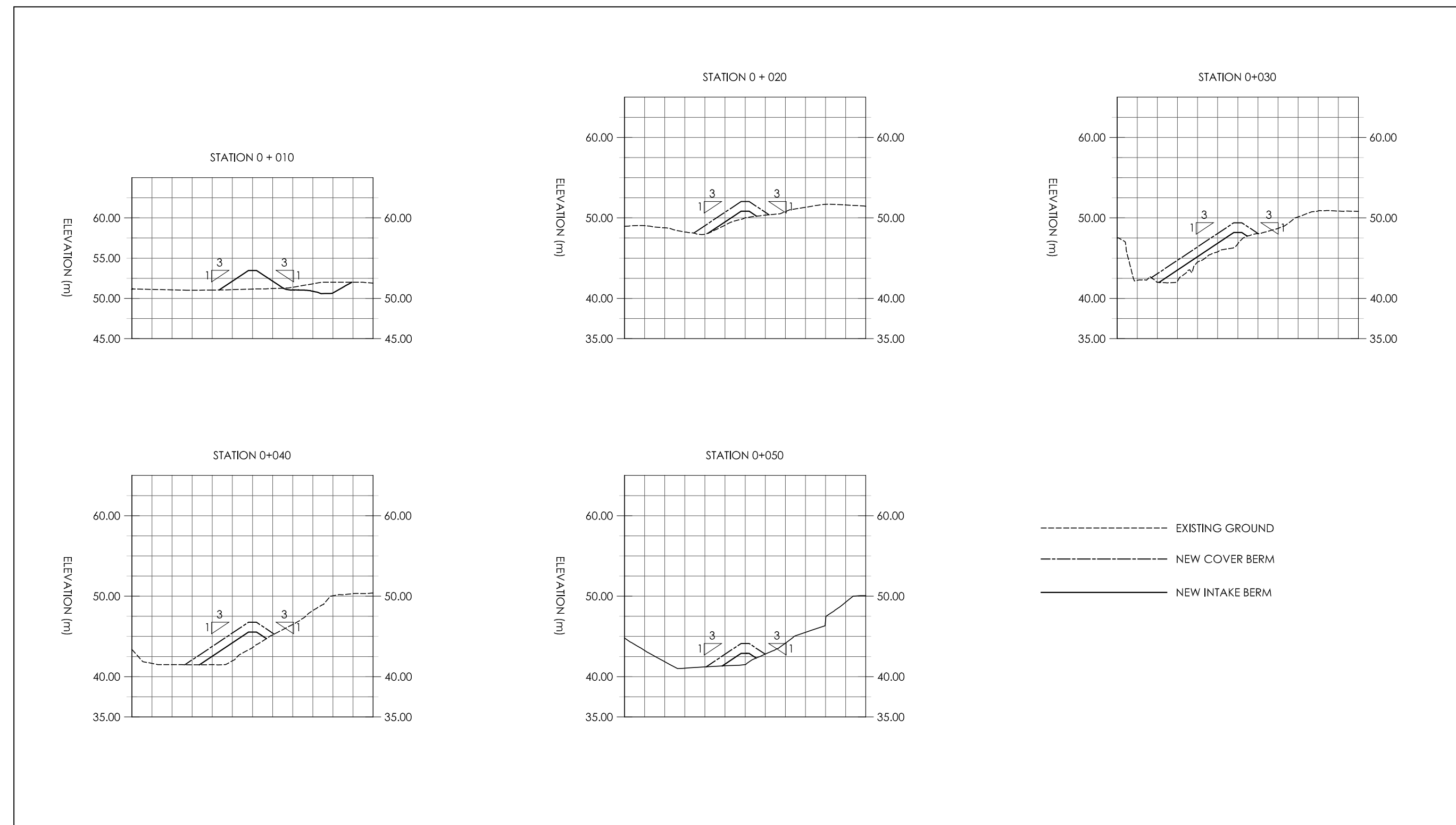

4
C200
INTAKE BERM SECTIONS
1:1000 H 1:2000 V



- THIS DRAWING IS NOT TO BE SCALED.
- CONTRACTOR IS TO VERIFY ALL DIMENSIONS ON SITE, INCLUDING EXTERIOR R.O. AND EXISTING INTERIOR R.O.
- ALL WORK TO BE COMPLETED IN STRICT ACCORDANCE WITH THE NATIONAL BUILDING CODE OF CANADA 2010 AND MANUFACTURER'S INSTRUCTIONS.
- ALL PARTIES USING THESE DRAWINGS SHALL REVIEW THEM PRIOR TO QUOTING AND CONSTRUCTION OF ANY AND ALL ASPECTS OF THE WORK AND REPORT ANY ERRORS, OMISSIONS AND/OR DEFICIENCIES IMMEDIATELY TO ARKTIS PIUSITIPPA INC.

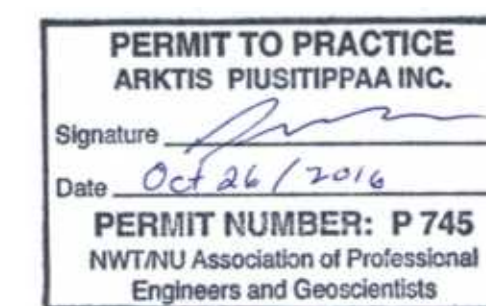
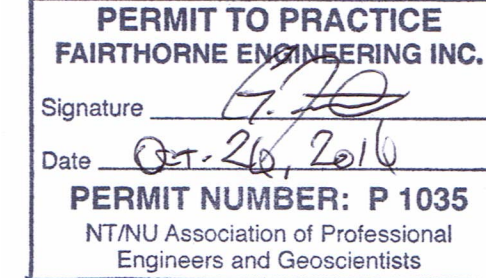
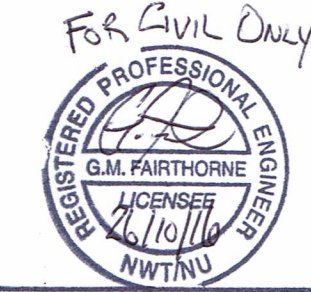

No.	DATE:	REVISION:
06	10/26/16	ISSUED FOR CONSTRUCTION
05	04/25/16	ADDENDUM NO. 1
04	03/28/16	RE-ISSUED FOR TENDER
03	04/16/14	ISSUED FOR TENDER
02	01/13/14	ISSUED AT 99% COMPLETE
01	11/25/13	ISSUED AT 50% COMPLETE



P.O. BOX 242, GJOA HAVEN, NU, X0B 1J0
TEL: (867) 446-0036 Fax: (866) 475-1147

THIS DRAWING IS THE SOLE PROPERTY OF ARKTIS PIUSITIPPA INC. UNAUTHORIZED REPRODUCTION IS NOT PERMITTED.

DRAWN BY: KH, GF	DESIGNED BY: KH, FB, GF
DATE: OCTOBER 2016	CHECKED BY: GF
SCALE: AS NOTED	PLOT DATE: 10/26/16

PROJECT:

IMPROVEMENT OF WATER SUPPLY SYSTEM

IGLOOLIK, NUNAVUT

DRAWING NAME:

NEW TRUCK FILL STATION SITE PLAN, SECTIONS & DETAIL

DRAWING NO.:

C200

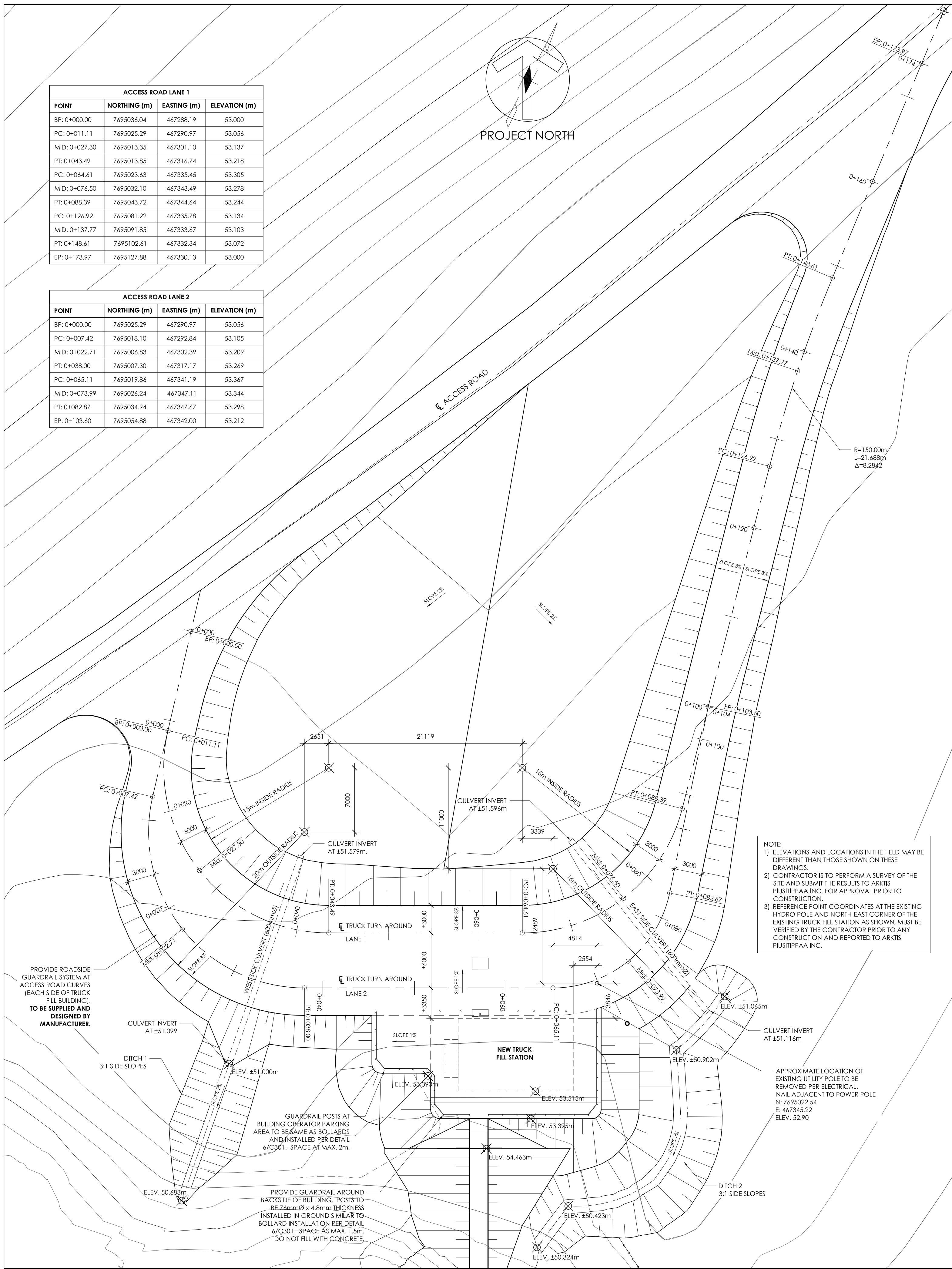

1
C300
NEW ACCES ROAD SITE PLAN
1:250

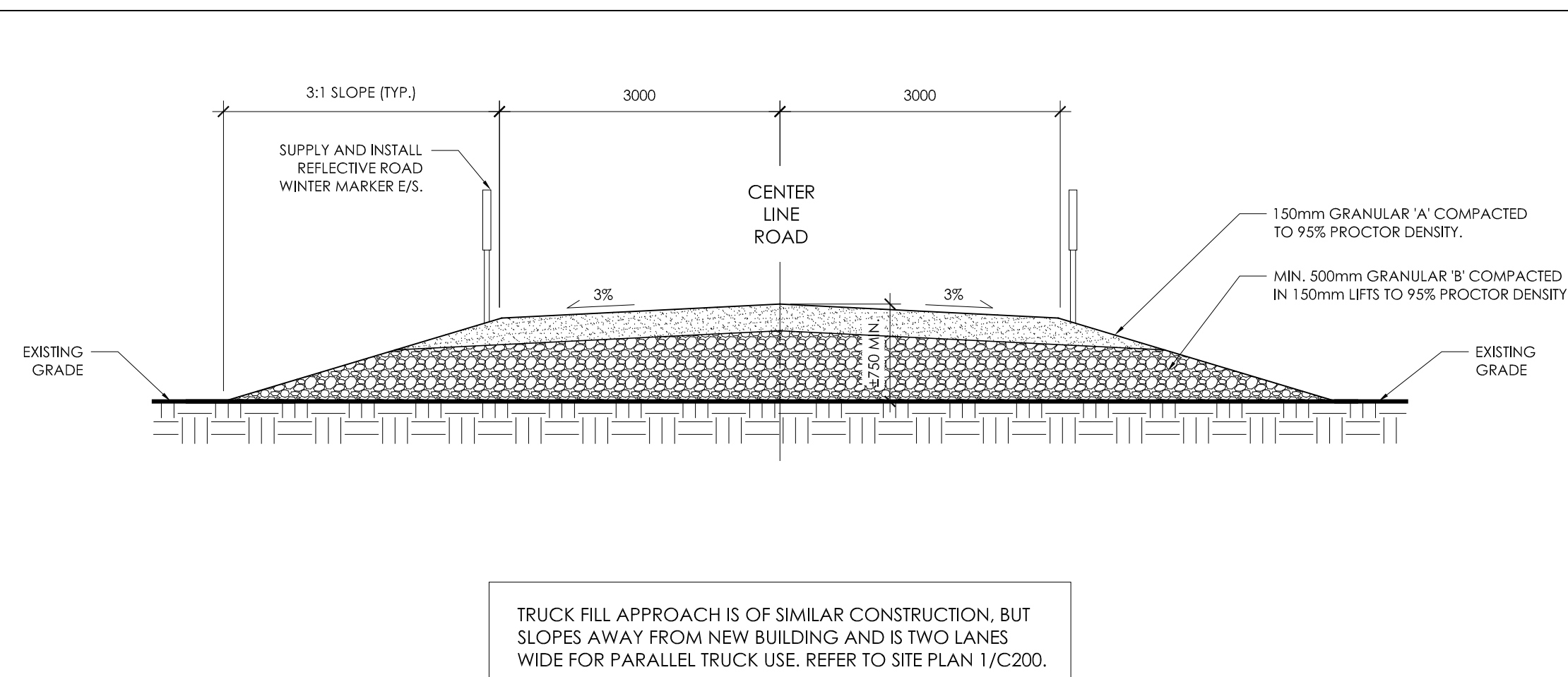

2
C300
TYPICAL ROAD SECTION
1:40

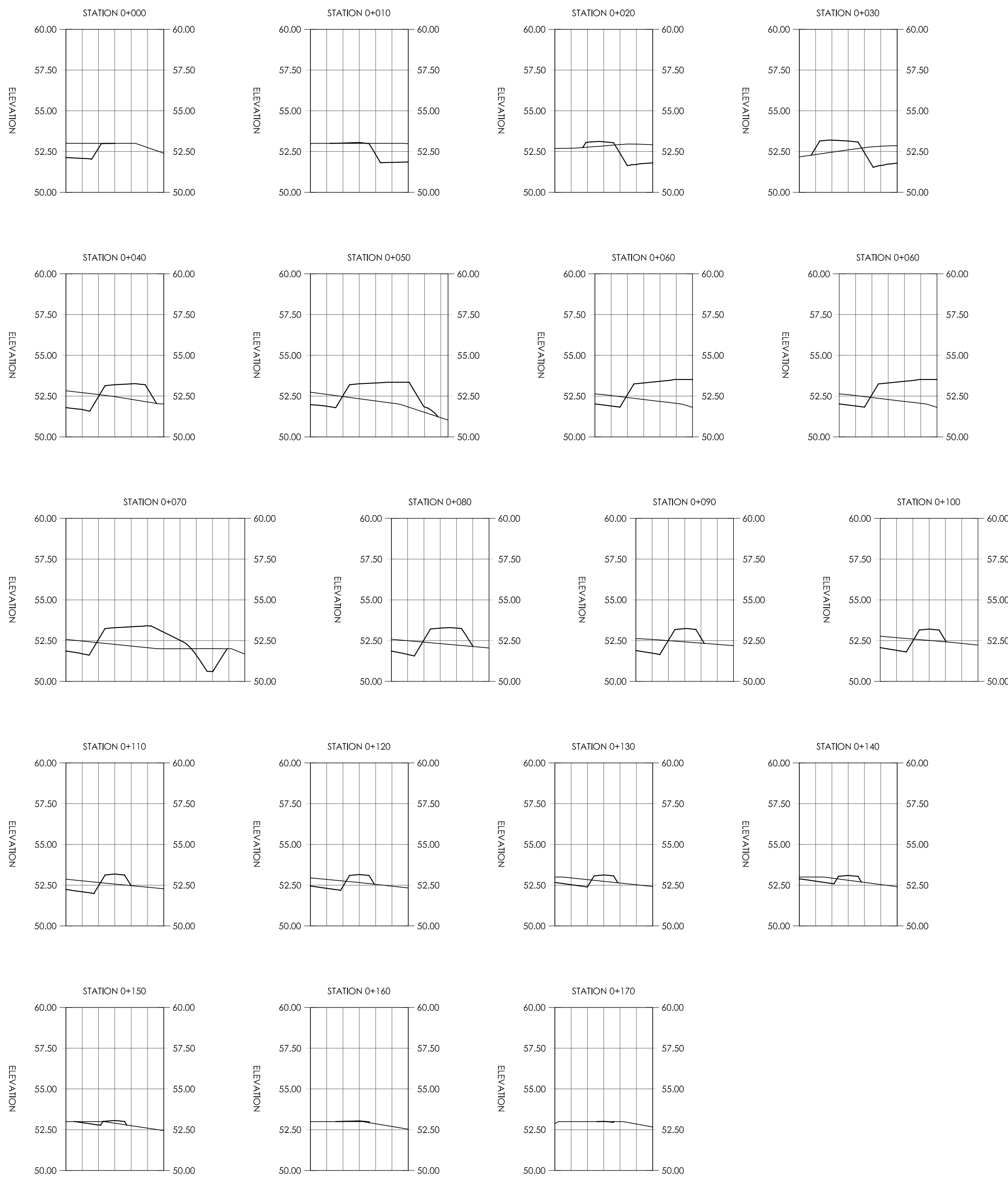

3
C300
ACCESS ROAD SECTIONS
1:1000 H 1:2000 V



- THIS DRAWING IS NOT TO BE SCALED.
- CONTRACTOR IS TO VERIFY ALL DIMENSIONS ON SITE, INCLUDING EXTERIOR R.O. AND EXISTING INTERIOR R.O.
- ALL WORK TO BE COMPLETED IN STRICT ACCORDANCE WITH THE NATIONAL BUILDING CODE OF CANADA 2010 AND MANUFACTURER'S INSTRUCTIONS.
- ALL PARTIES USING THESE DRAWINGS SHALL REVIEW THEM PRIOR TO QUOTING AND CONSTRUCTION OF ANY AND ALL ASPECTS OF THE WORK AND REPORT ANY ERRORS, OMISSIONS AND/OR DEFICIENCIES IMMEDIATELY TO ARKTIS PIUSITIPPA INC.

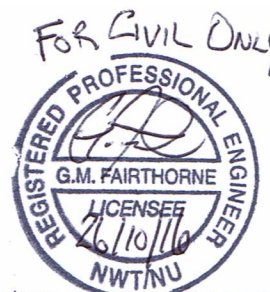

PERMIT TO PRACTICE
FAIRTHORNE ENGINEERING INC.
 Signature: *G.M. Fairthorne*
 Date: *Oct 26, 2016*
PERMIT NUMBER: P 1035
 NWTNU Association of Professional Engineers and Geoscientists

PERMIT TO PRACTICE
ARKTIS PIUSITIPPA INC.
 Signature: *Arktis Piusitippa*
 Date: *Oct 26, 2016*
PERMIT NUMBER: P 745
 NWTNU Association of Professional Engineers and Geoscientists

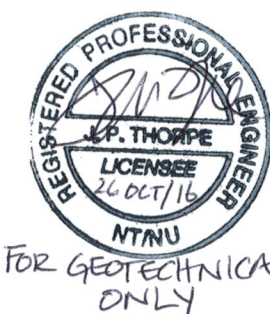

06	10/26/16	ISSUED FOR CONSTRUCTION
05	04/25/16	ADDENDUM NO. 1
04	03/28/16	RE-ISSUED FOR TENDER
03	04/16/14	ISSUED FOR TENDER
02	01/13/14	ISSUED AT 99% COMPLETE
01	11/25/13	ISSUED AT 50% COMPLETE
No.	DATE:	REVISION:



P.O. BOX 242, GJOA HAVEN, NU, X0B 1J0
 TEL: (867) 446-0036 Fax: (866) 475-1147

THIS DRAWING IS THE SOLE PROPERTY OF ARKTIS PIUSITIPPA INC. UNAUTHORIZED REPRODUCTION IS NOT PERMITTED.

DRAWN BY:	KH, GF	DESIGNED BY:	KH, PB, GF
DATE:	OCTOBER 2016	CHECKED BY:	GF
SCALE:	AS NOTED	PLOT DATE:	10/26/16

PROJECT:

**IMPROVEMENT
 OF WATER
 SUPPLY SYSTEM**
 IGLOOLIK, NUNAVUT

DRAWING NAME:

**NEW ACCESS ROAD
 SITE PLAN, SECTIONS &
 DETAIL**

DRAWING NO.:

C300

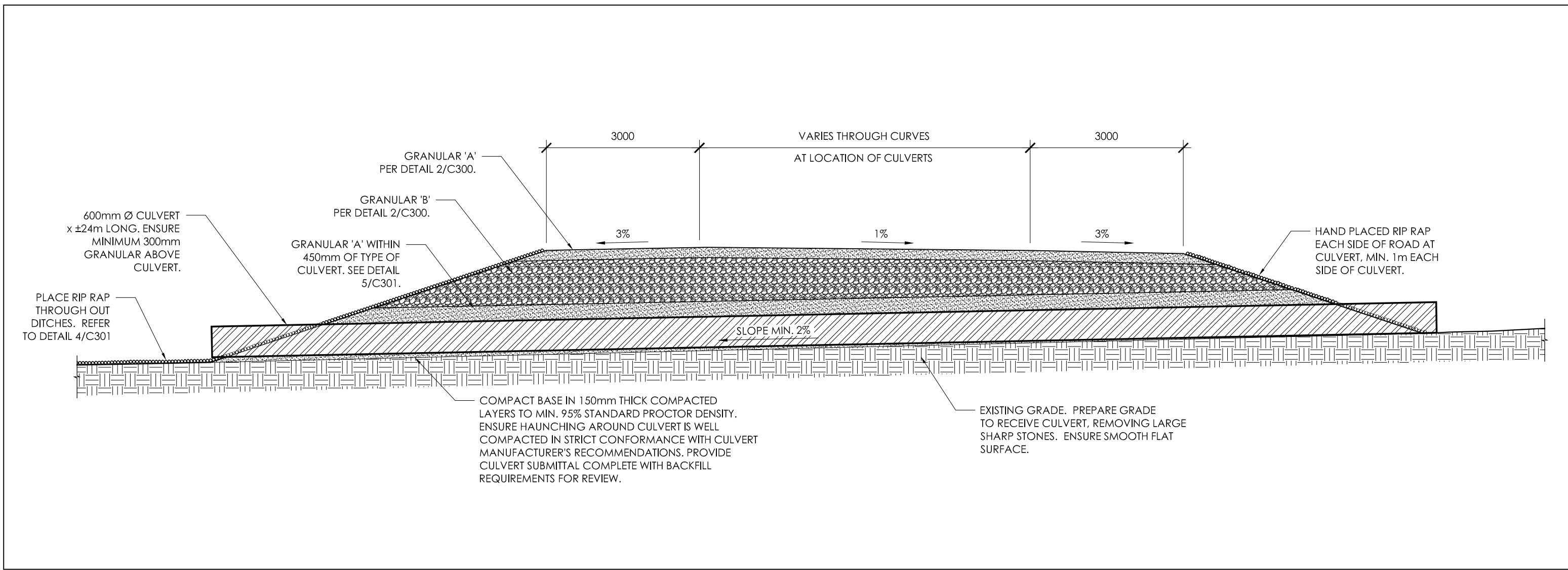

1 TYPICAL CULVERT DETAIL

C301 1:75

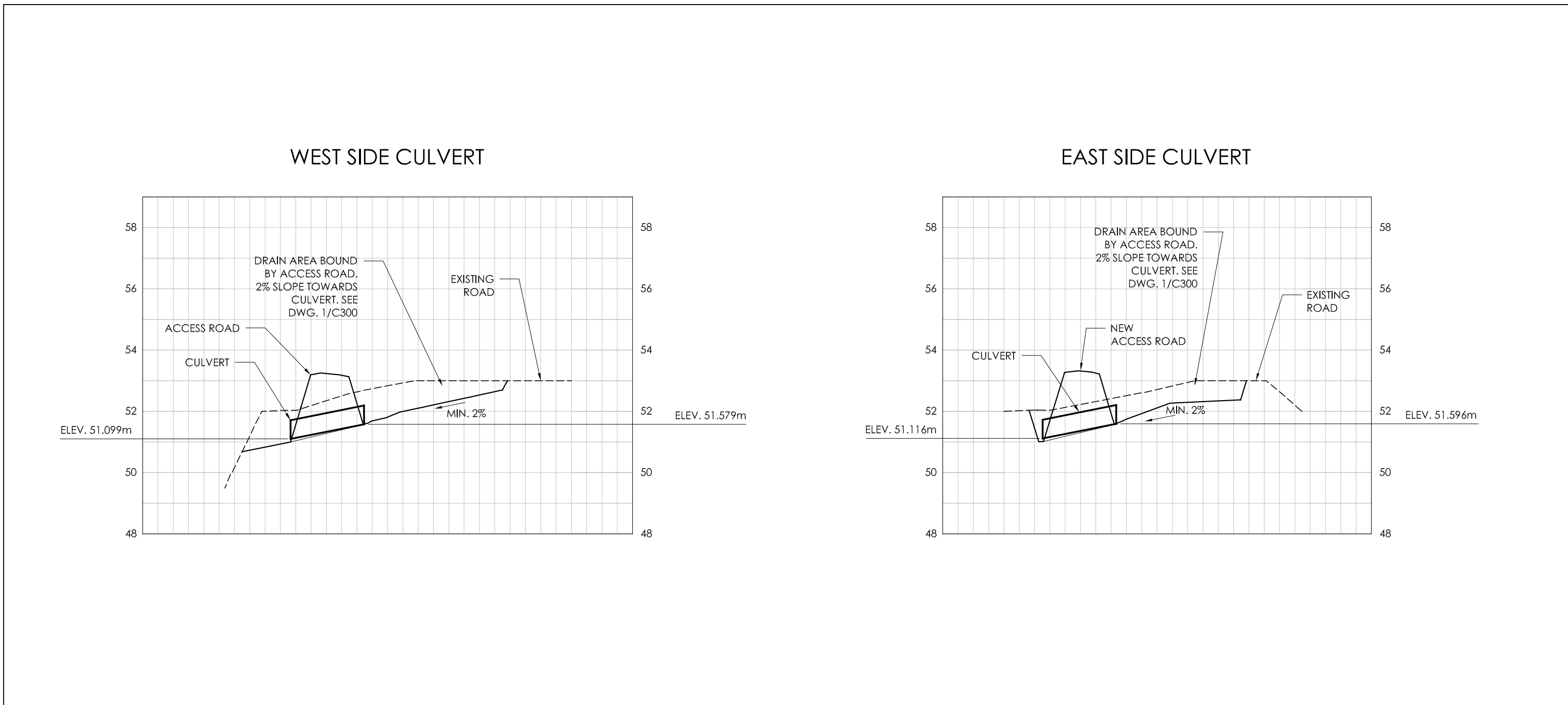

2 CULVERT SECTIONS

C301 1:1250

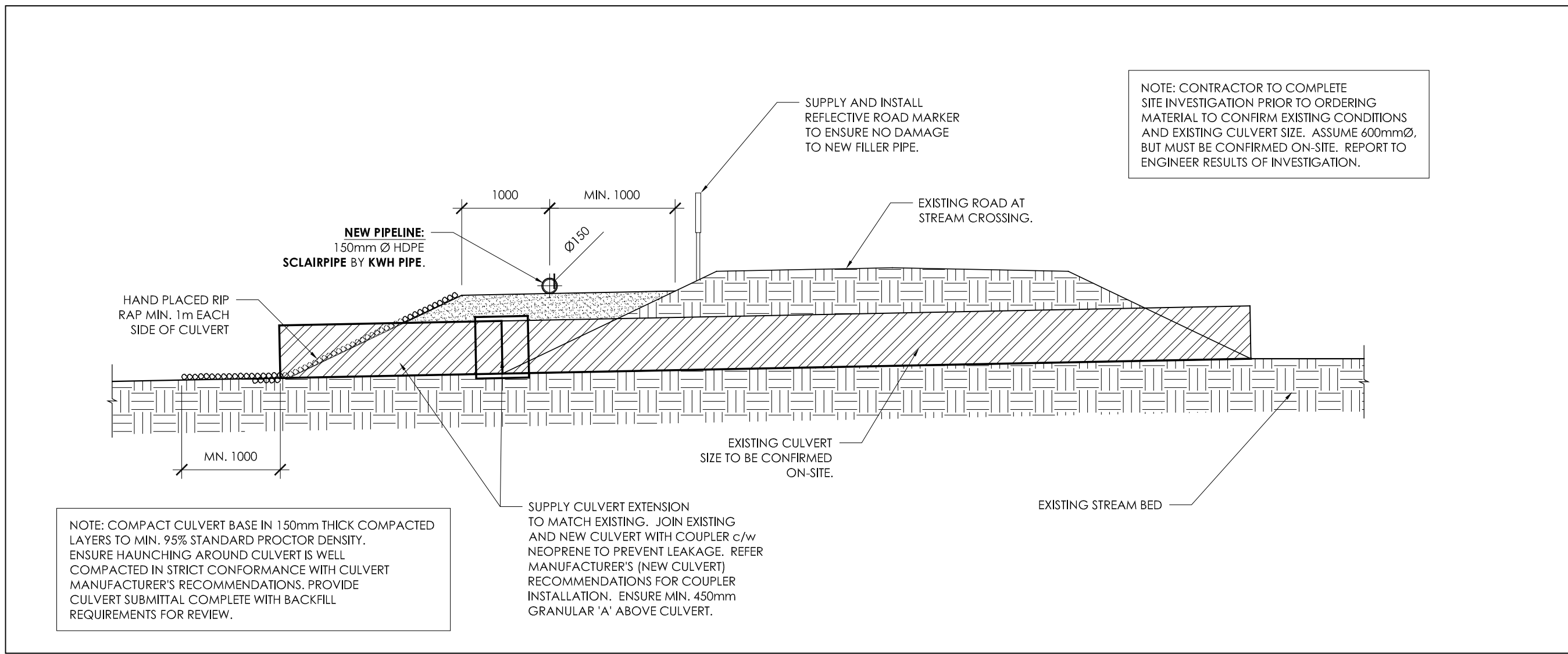

3 CULVERT EXTENSION AT FILLER PIPE STREAM CROSSING

C301 1:50

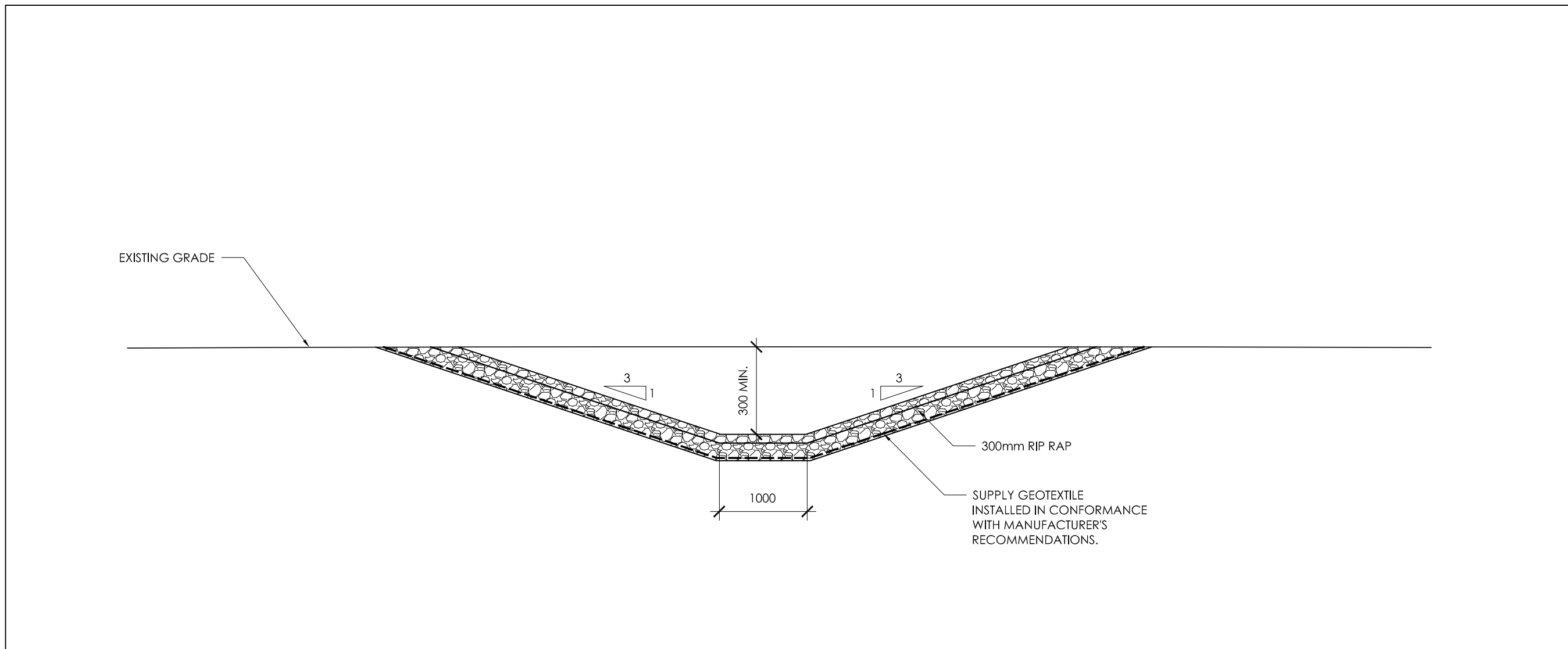

4 TYPICAL DITCH DETAIL

C301 1:50

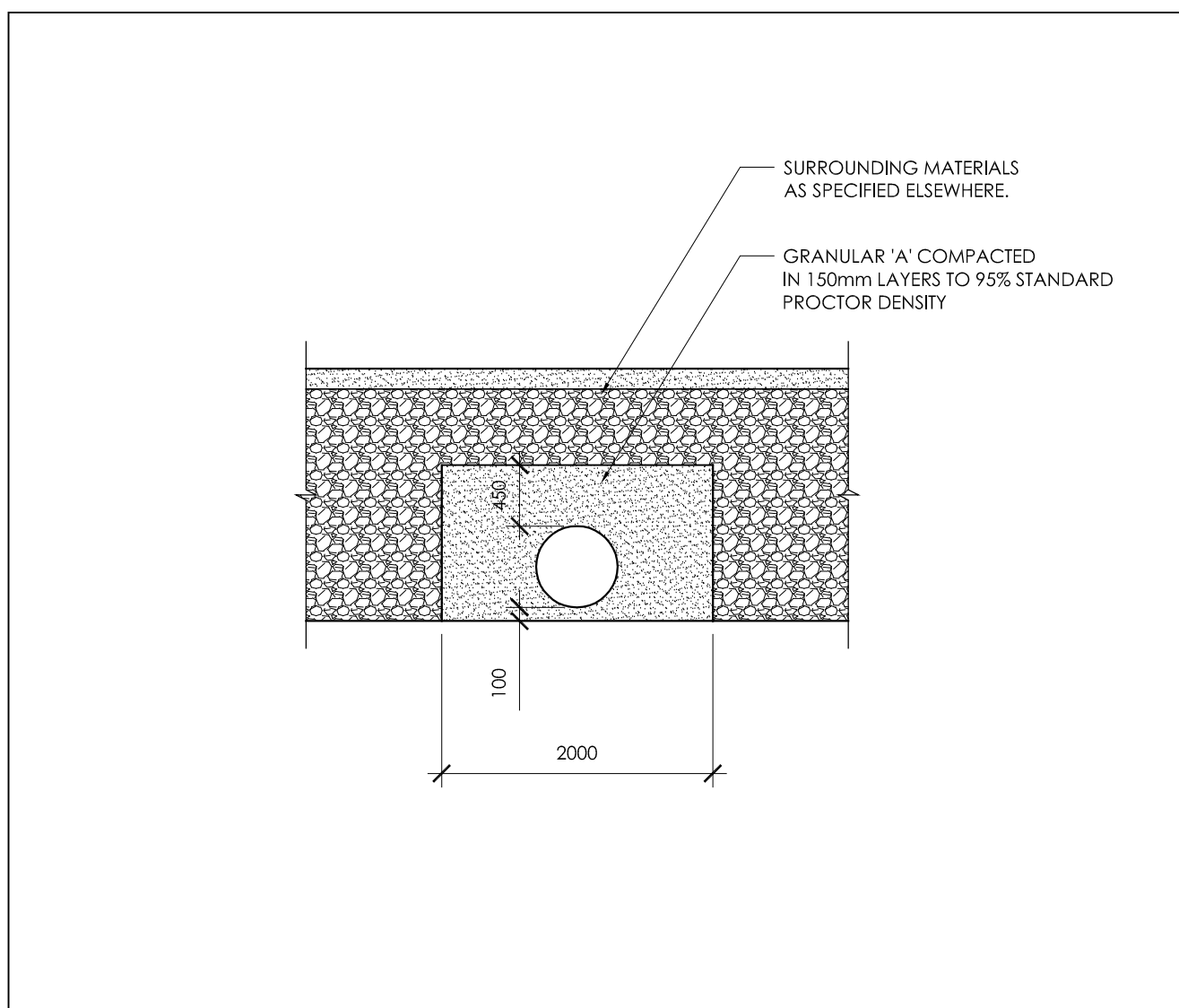

5 TYPICAL CULVERT SECTION

C301 1:50

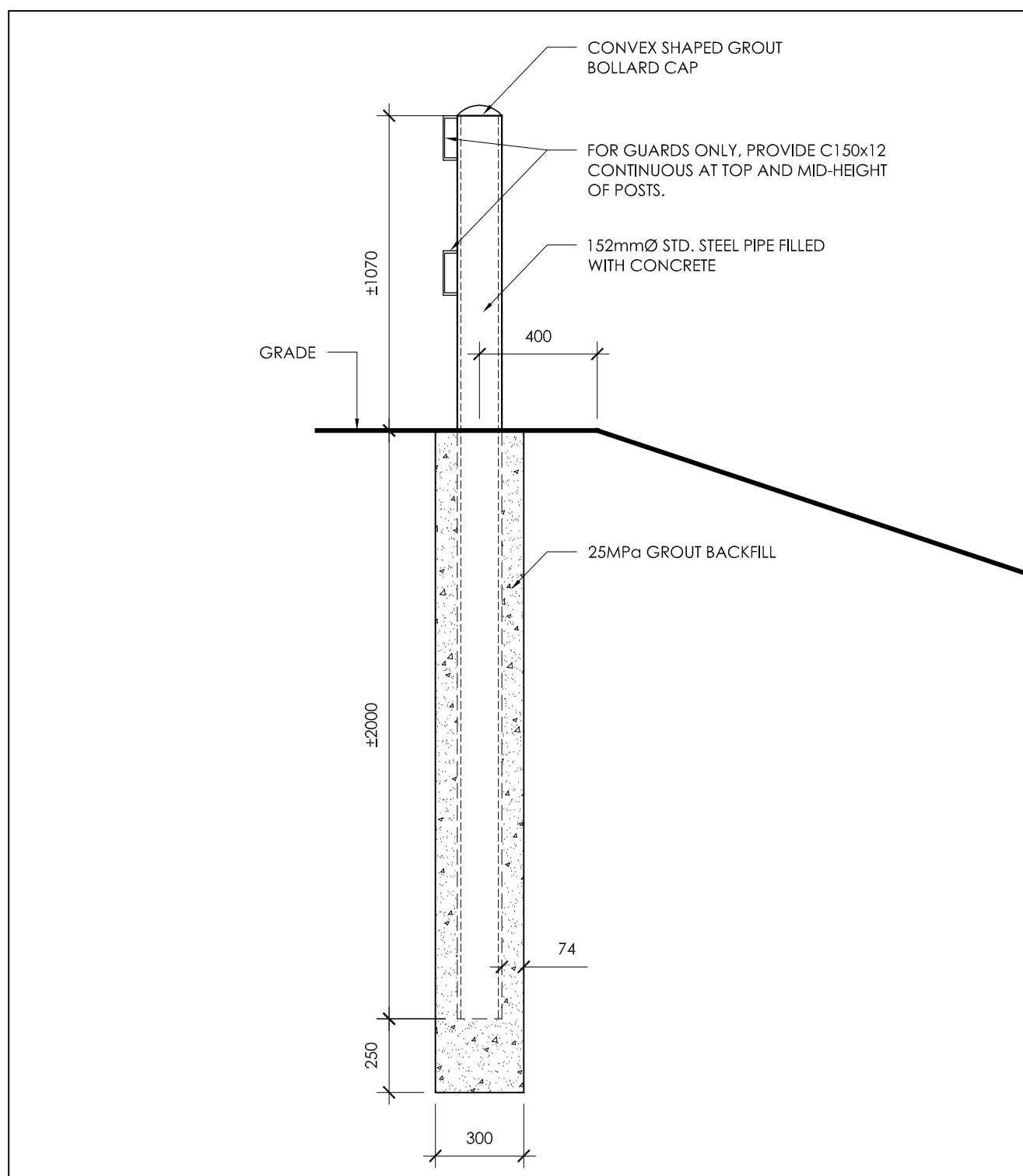

6 TYPICAL BOLLARD SECTION

C301 1:20



1. THIS DRAWING IS NOT TO BE SCALED.
2. CONTRACTOR IS TO VERIFY ALL DIMENSIONS ON SITE, INCLUDING EXTERIOR R.O. AND EXISTING INTERIOR R.O.
3. ALL WORK TO BE COMPLETED IN STRICT ACCORDANCE WITH THE NATIONAL BUILDING CODE OF CANADA 2010 AND MANUFACTURER'S INSTRUCTIONS.
4. ALL PARTIES USING THESE DRAWINGS SHALL REVIEW THEM PRIOR TO QUOTING AND CONSTRUCTION OF ANY AND ALL ASPECTS OF THE WORK AND REPORT ANY ERRORS, OMISSIONS AND/OR DEFICIENCIES IMMEDIATELY TO ARKTIS PIUSITIPPAA INC.

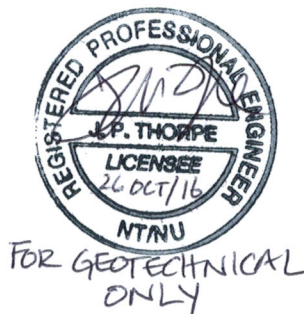
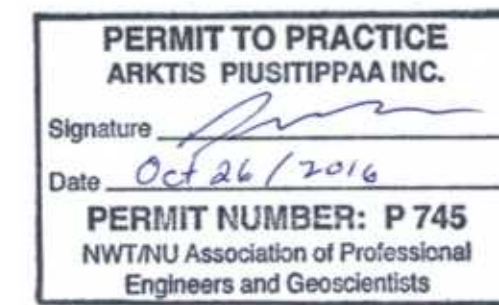
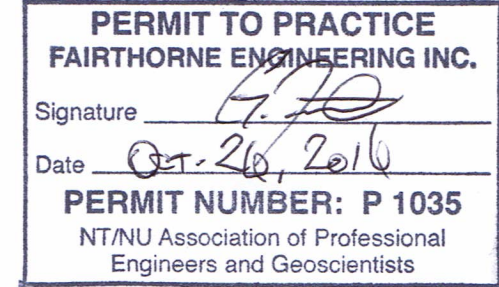
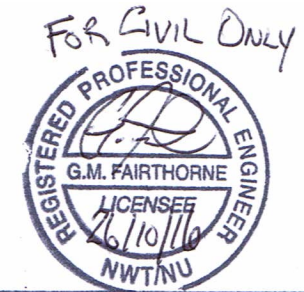

06	10/26/16	ISSUED FOR CONSTRUCTION
05	04/25/16	ADDENDUM NO. 1
04	03/28/16	RE-ISSUED FOR TENDER
03	04/16/14	ISSUED FOR TENDER
02	01/13/14	ISSUED AT 99% COMPLETE
01	11/25/13	ISSUED AT 50% COMPLETE

No.	DATE:	REVISION:
-----	-------	-----------



Arktis
piusitippaa

P.O. BOX 242, GJOA HAVEN, NU, X0B 1J0
TEL: (867) 446-0036 Fax: (866) 475-1147

THIS DRAWING IS THE SOLE PROPERTY OF ARKTIS PIUSITIPPAA INC. UNAUTHORIZED REPRODUCTION IS NOT PERMITTED.

DRAWN BY:	KH, GF	DESIGNED BY:	KH, PB, GF
DATE:	OCTOBER 2016	CHECKED BY:	GF
SCALE:	AS NOTED	PLOT DATE:	10/26/16

PROJECT:
IMPROVEMENT OF WATER SUPPLY SYSTEM
IGLOOLIK, NUNAVUT

DRAWING NAME:
CULVERT AND MISC. DETAILS

DRAWING NO.:
C301