

GENERAL NOTES:

1. ALL WORK SHALL BE PERFORMED IN ACCORDANCE WITH THE REQUIREMENTS OF THE OCCUPATIONAL HEALTH AND SAFETY ACT AND REGULATIONS FOR CONSTRUCTION PROJECTS (INCLUDING LATEST AMENDMENTS) AND OTHER LOCAL AUTHORITIES HAVING JURISDICTION.
2. WHERE DOCUMENTS AND STANDARDS ARE REFERENCED IN THE NOTES, THEY SHALL BE THE LATEST EDITIONS, UNLESS OTHERWISE NOTED OR SHOWN.
3. ALL DIMENSIONS AND ELEVATIONS SHALL BE VERIFIED ON THE JOB BY THE CONTRACTOR. CONTRACTOR IS TO REPORT DISCREPANCIES TO THE ENGINEER PROMPTLY AND BEFORE CONSTRUCTION.
4. READ DRAWINGS IN CONJUNCTION WITH SPECIFICATIONS AND ALL OTHER CONTRACT DOCUMENTS, WHERE APPLICABLE.
5. BEFORE PROCEEDING WITH WORK, CHECK ALL THE DIMENSIONS SHOWN ON THE STRUCTURAL DRAWINGS AGAINST THE ARCHITECTURAL, MECHANICAL, AND ELECTRICAL DRAWINGS (WHERE APPLICABLE) AND REPORT DISCREPANCIES TO THE CONSULTANT.
6. ANY HORIZONTAL AND VERTICAL DESIGN LOADINGS NOTED SHALL NOT BE EXCEEDED DURING CONSTRUCTION.
7. DRAWINGS ARE NOT TO BE SCALED.

MATERIALS AND EXECUTION:

CONCRETE

1. CONCRETE MATERIALS, PROCEDURES, TOLERANCES AND WORKMANSHIP SHALL CONFORM TO THE LATEST ISSUE OF CSA A23.1 AND A23.2. A COPY OF THIS STANDARD SHALL BE AVAILABLE ON SITE.
2. PROVIDE CERTIFICATION THAT MIX PROPORTIONS SELECTED WILL PRODUCE CONCRETE OF SPECIFIED QUALITY AND STRENGTH.
3. CONCRETE ADMIXTURES SHALL CONFORM TO CSA STANDARD CAN3-A266.4, SHALL BE COMPATIBLE WITH EACH OTHER WHERE MORE THAN ONE IS USED, AND USED IN ACCORDANCE WITH MANUFACTURER'S INSTRUCTIONS.
4. FINISH EXPOSED PERIMETER EDGES/CORNERS WITH A STEEL EDGING TOOL OR CHAMFER ¼".
5. PLACE CONCRETE REPAIR MATERIAL WHEN WATER IS 4°C OR WARMER.
6. CONCRETE REPAIR MATERIAL TO BE DURO-CRETE MINIMUM OR APPROVED EQUIVALENT.
7. INSTALL AS PER MANUFACTURERS INSTRUCTIONS.

SEALANT

1. VERTICAL AND HORIZONTAL JOINTS TO BE INJECTED WITH URETHANE INJECTION WHICH IS APPROPRIATE FOR USE IN POTABLE WATER, F1000 OR APPROVED EQUIVALENT.
2. INSTALL AS PER MANUFACTURERS INSTRUCTIONS.

NOTES:

CONTRACTOR TO PROVIDE ALL EQUIPMENT AND MATERIALS REQUIRED TO COMPLETE THE WORK INCLUDED WITHIN SCOPE OF WORK. ALL CONCRETE AND SEALANT REPAIRS TO BE LIMITED TO BELOW THE WATERLINE ON THE DOWNSTREAM ELEVATION.

SCOPE OF WORK:

CONTRACTOR SHALL SURVEY THE ENTIRE CONCRETE SURFACE OF THE UPSTREAM SURFACE OF THE LAKE GERALDINE DAM AND MAKE LOCALIZED REPAIRS AS FOLLOWS:

MOBILIZATION:
CONTRACTOR SHALL INCLUDE FOR SIGNAGE, BARRIERS, AND HOARDING NECESSARY TO PROTECT THE WORK SITE AND MATERIALS AS REQUIRED. CONTRACTOR SHALL PROVIDE ALL EQUIPMENT AND MATERIALS REQUIRED TO COMPLETE THE WORK INCLUDED WITHIN THE CONTRACT DOCUMENTS.

ENVIRONMENTAL PROTECTION:
PROVIDE ENVIRONMENTAL PROTECTION MEASURES AS REQUIRED BY PLAN, CITY OF IQALUIT, GOVERNING BODIES, AND BEST PRACTICES. WORK WILL BE PERFORMED WITHIN A DRINKING WATER RESERVOIR. ELIMINATE, OR MINIMIZE AND CONTROL PARTICULATE AS WORK PROGRESSES AND PROVIDE MEANS OF CONTAINING OR COLLECTING PARTICULATE AS THE WORK PROGRESSES. SEE SPEC 35 42 19.

SEALANT INSTALLATION:
CONTRACTOR SHALL INSPECT ALL VERTICAL EXPANSION JOINTS AND HORIZONTAL POUR JOINTS.
• AT VERTICAL EXPANSION JOINTS BELOW THE 2006 ADDITION THE EXISTING JOINT APPEARS TO CONTAIN NO SEALANT, OR SEALANT IN POOR CONDITION, CONTRACTOR SHALL INJECT ALL VERTICAL EXPANSION JOINTS BELOW THE 2006 ADDITION. ESTIMATED QUANTITY~ 40 LINEAR METRES.
• AT HORIZONTAL POUR JOINTS LOCATED WITHIN THE SPILLWAY BETWEEN J1 & J3 THE TOP THREE (3) HORIZONTAL POUR JOINTS APPEAR TO CONTAIN NO SEALANT, OR SEALANT IN POOR CONDITION, CONTRACTOR SHALL INJECT HORIZONTAL POUR JOINTS BETWEEN J1 & J3. ESTIMATED QUANTITY~ 45 LINEAR METRES.
• AT HORIZONTAL POUR JOINTS LOCATED OUTSIDE THE SPILLWAY (J0-J1 & J3-J7) POUR JOINTS ARE SPALLED AND AREAS ARE LEAKING (BASED ON LAST YEARS INJECTION PROGRAM COMPLETED FROM THE DOWNSTREAM SIDE), CONTRACTOR SHALL LOCALLY INJECT HORIZONTAL POUR JOINTS BETWEEN J1 & J3 WHERE REQUIRED. ESTIMATED QUANTITY~ 20 LINEAR METRES.

CONCRETE REPAIR:
CONTRACTOR SHALL INSPECT ALL UPSTREAM CONCRETE SURFACES (ABOVE AND BELOW WATER) AND MAKE LOCALIZED REPAIRS TO DETERIORATED CONCRETE. THE AREAS OF CONCRETE SPALLING AND CRACKING ON DRAWING S2 ARE FOR REFERENCE ONLY BASED ON PREVIOUS REPORTS.
• CONTRACTOR SHALL LOCALLY REMOVE DETERIORATED CONCRETE, CHIP TO SOUND CONCRETE, AND PLACE/ FINISH REPAIR CONCRETE AS REQUIRED. ESTIMATED QUANTITY~ 5 SQUARE METRES.

FISH SCREEN AT WATER INTAKE:
THE EXISTING WATER INTAKE LOCATED AT THE BOTTOM OF THE WATER RESERVOIR IS NOT CURRENTLY PROTECTED BY A SCREEN. NO RECORD DRAWINGS OF THE EXISTING WATER INTAKE ARE AVAILABLE. THE CONTRACTOR SHALL MEASURE THE EXISTING INTAKE AND DESIGN, SUPPLY, AND INSTALL A NEW FISH SCREEN TO THE DESIGN REQUIREMENTS AS SPECIFIED IN THE CONTRACT DOCUMENTS.



PLAN - LAKE GERALDINE DAM

SCALE: 1:500

NO.	REVISION	DATE
1	ISSUED FOR 80% CLIENT REVIEW	JAN. 24, 2018
2	ISSUED FOR FINAL REVIEW	APR. 6, 2018
3		
4		
5		
6		
7		

NOTES:

CONTRACTOR SHALL CHECK AND VERIFY ALL DIMENSIONS AND BE RESPONSIBLE FOR REPORTING ALL DISCREPANCIES TO OWNER AND/OR CONSULTANT PRIOR TO TENDER CLOSING

LATEST APPROVED DRAWINGS ONLY TO BE USED FOR CONSTRUCTION.

PRINTS ARE NOT TO BE SCALED.

ALL DIMENSIONS INDICATED ARE IN MILLIMETRES (mm) UNLESS OTHER WISE NOTED.

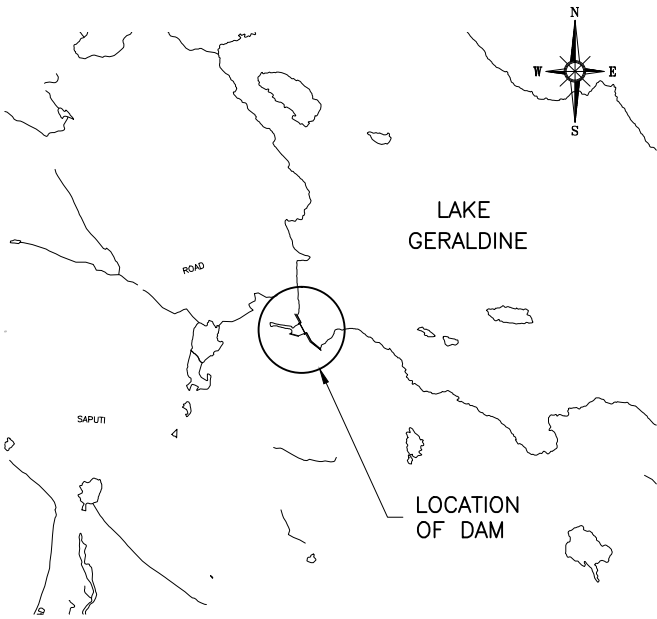

LEGEND

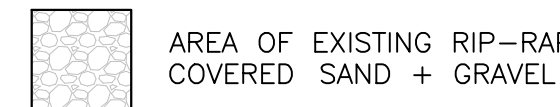

LONDON Tel. 1-519-452-7700 Toll Free 1-866-919-4531	OTTAWA Tel. 1-613-824-8900 Toll Free 1-866-919-4530
IQALUIT Tel. 1-867-979-3300 Toll Free 1-866-919-4533	SASKATOON Tel. 1-306-343-5500 Toll Free 1-866-919-8899
WINNIPEG Tel. 1-204-783-1276 Toll Free 1-866-919-4531	MISSISSAUGA Tel. 1-905-286-1100

CLIENT NAME:

CITY OF IQALUIT

PROJECT ADDRESS:

IQALUIT, NUNAVUT

PROJECT NAME:

LAKE GERALDINE DAM
UNDERWATER REPAIRS

DRAWING TITLE:

SITE PLAN

DESIGN: WRS	SCALE: AS SHOWN
DRAWN: BHR	DATE: JAN.2018
APVD: ADM	FILE No: 17-7582

SHEET No.

S1

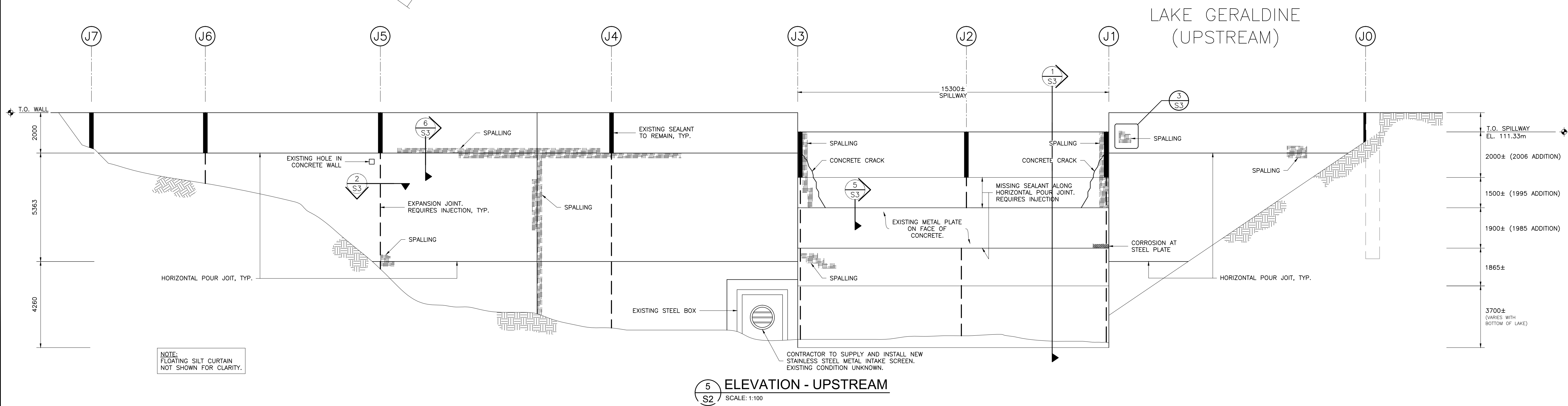
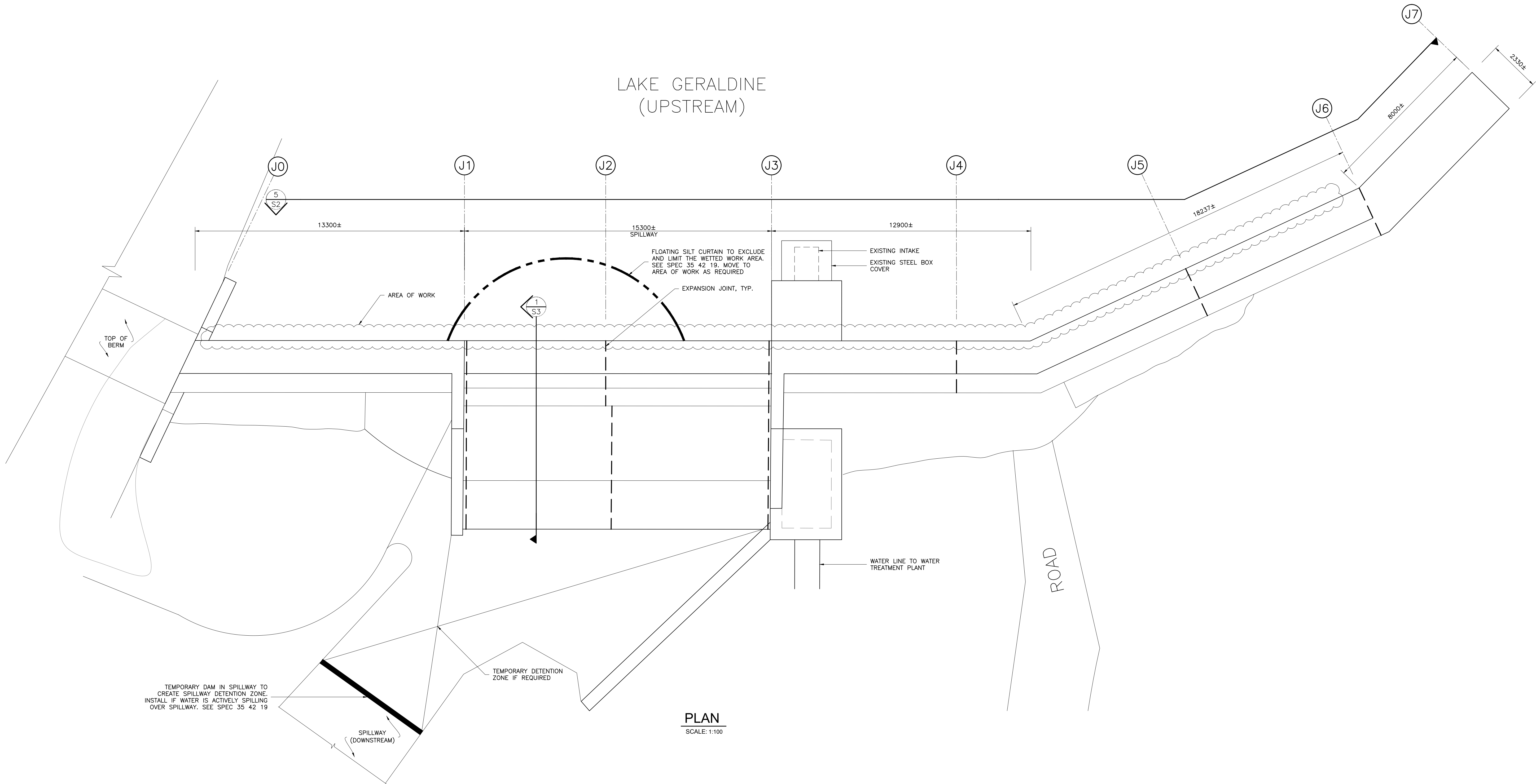

NO.	REVISION	DATE
1	ISSUED FOR 80% CLIENT REVIEW	JAN. 24, 2018
2	ISSUED FOR FINAL REVIEW	APR. 6, 2018
3		
4		
5		
6		
7		

NOTES:

CONTRACTOR SHALL CHECK AND VERIFY ALL DIMENSIONS AND BE RESPONSIBLE FOR REPORTING ALL DISCREPANCIES TO OWNER AND/OR CONSULTANT PRIOR TO TENDER CLOSING

LATEST APPROVED DRAWINGS ONLY TO BE USED FOR CONSTRUCTION.

PRINTS ARE NOT TO BE SCALED.

ALL DIMENSIONS INDICATED ARE IN MILLIMETRES (mm) UNLESS OTHER WISE NOTED.

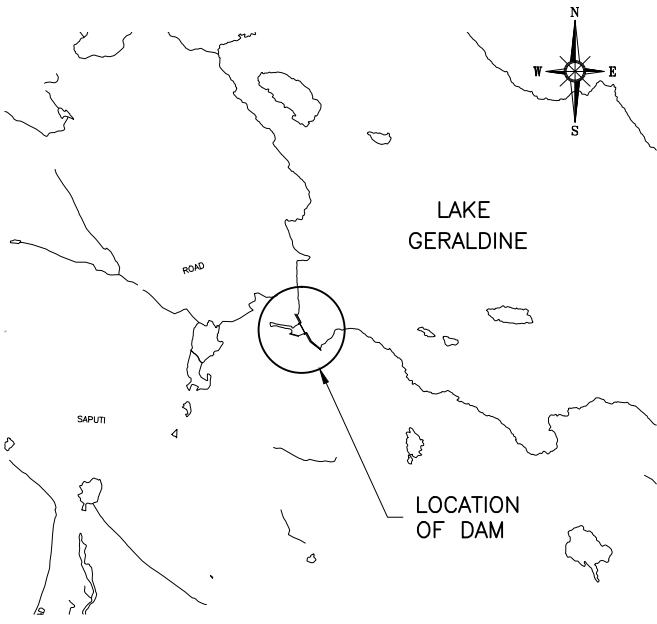

LONDON
Tel. 1-519-452-7700
Toll Free 1-866-919-4531

OTTAWA
Tel. 1-613-824-8900
Toll Free 1-866-919-4530

IQALUIT
Tel. 1-867-979-3300
Toll Free 1-866-919-4533

SASKATOON
Tel. 1-306-343-5500
Toll Free 1-866-919-8899

WINNIPEG
Tel. 1-204-783-1276
Toll Free 1-866-919-4531

MISSISSAUGA
Tel. 1-905-286-1100

CLIENT NAME:
CITY OF IQALUIT

PROJECT ADDRESS:
IQALUIT, NUNAVUT

PROJECT NAME:
LAKE GERALDINE DAM UNDERWATER REPAIRS

DRAWING TITLE:
UPSTREAM PLAN AND ELEVATION

DESIGN: WRS
DRAWN: BHR
APPVD: ADM

SCALE: AS SHOWN
DATE: JAN.2018
FILE No: 17-7582

SHEET No.

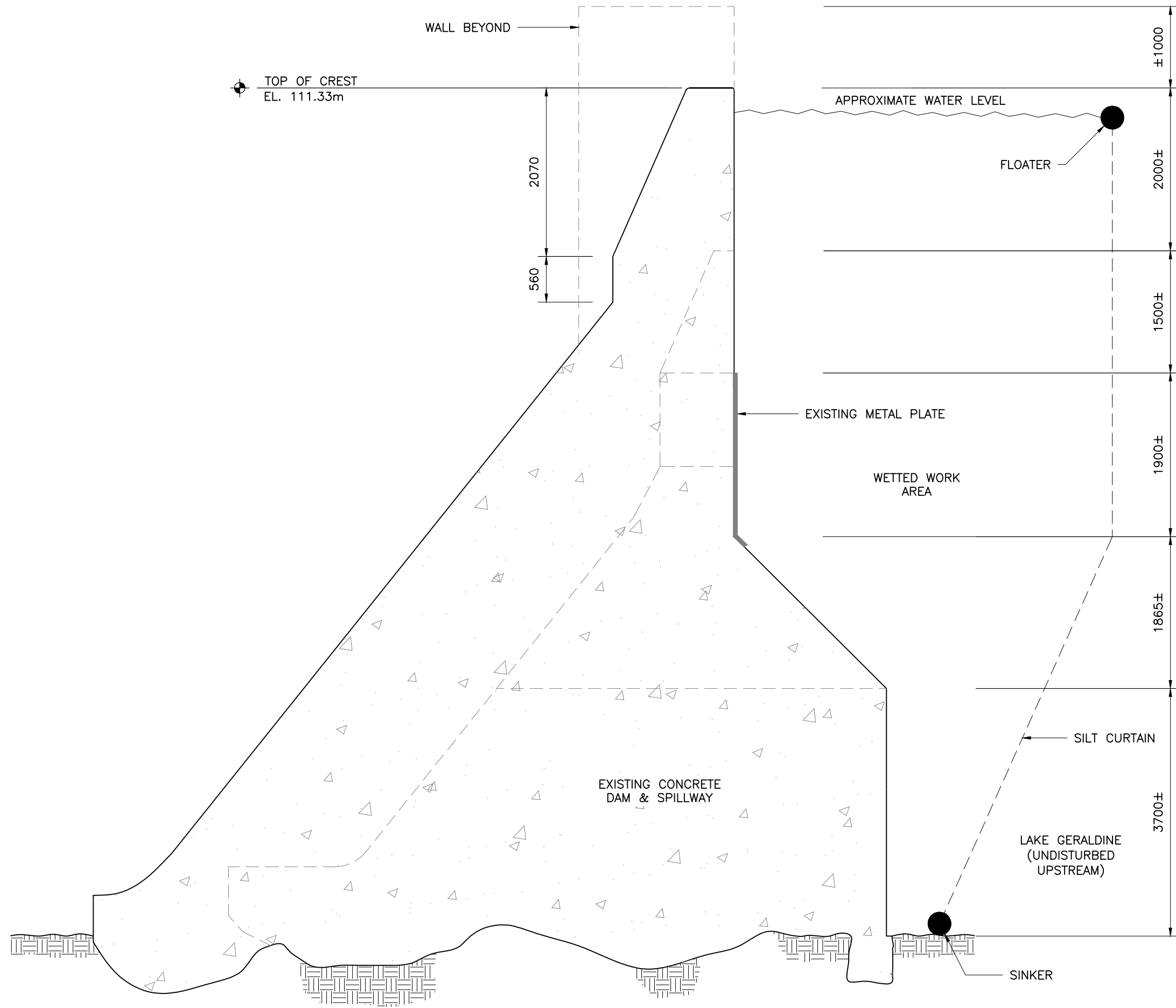

1
S3 / SCALE: 1:50

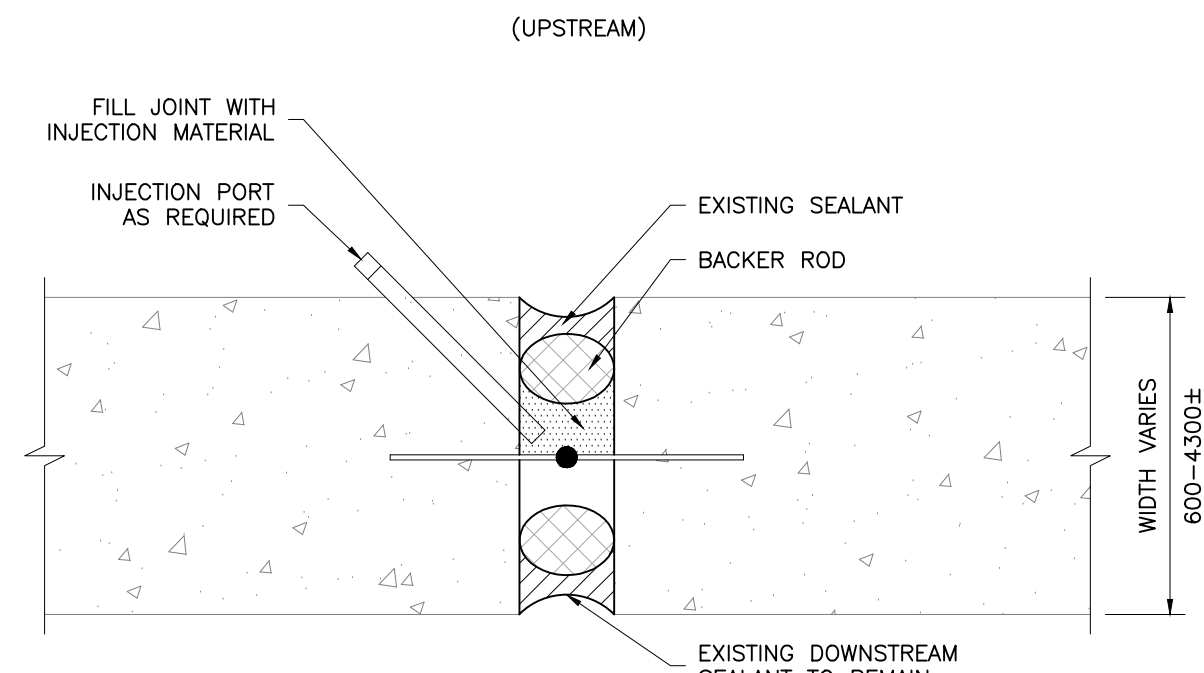

2
S3 / SCALE: N.T.S.

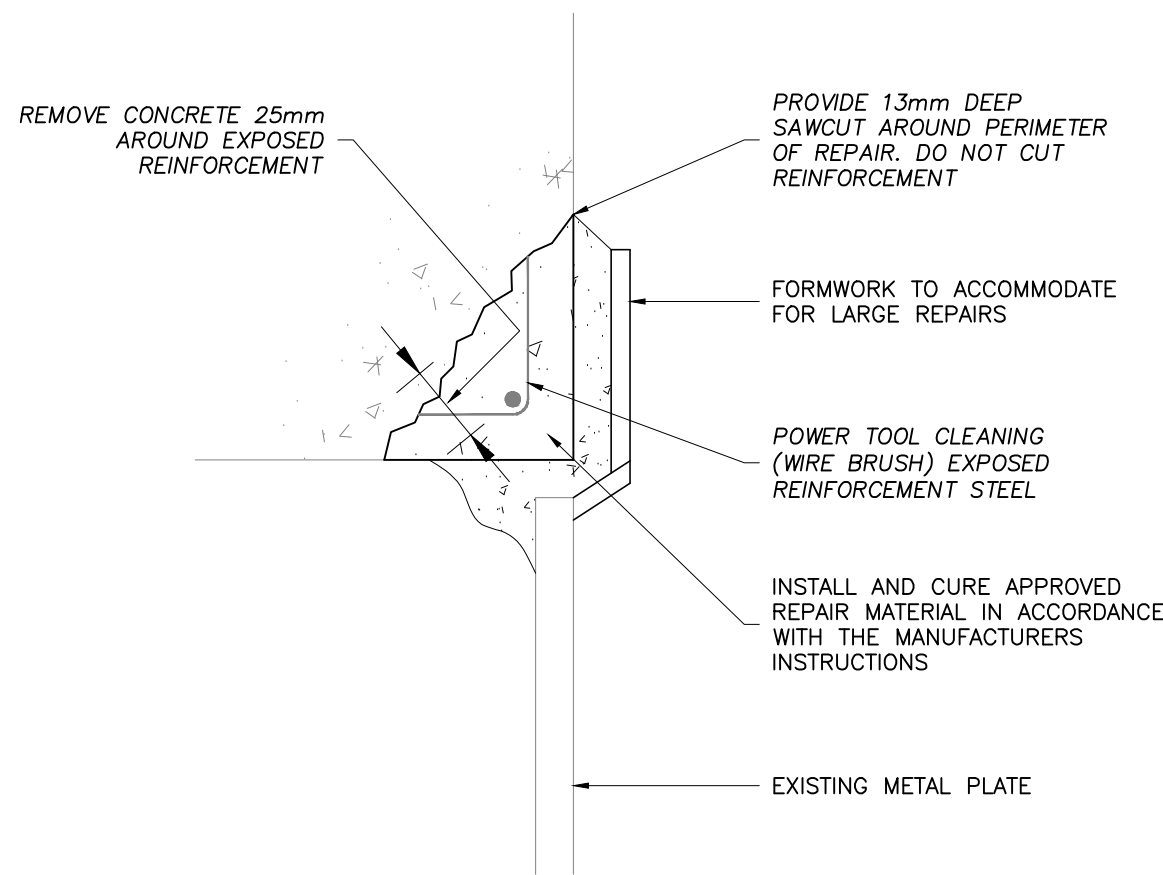

5
S3 / SCALE: N.T.S.

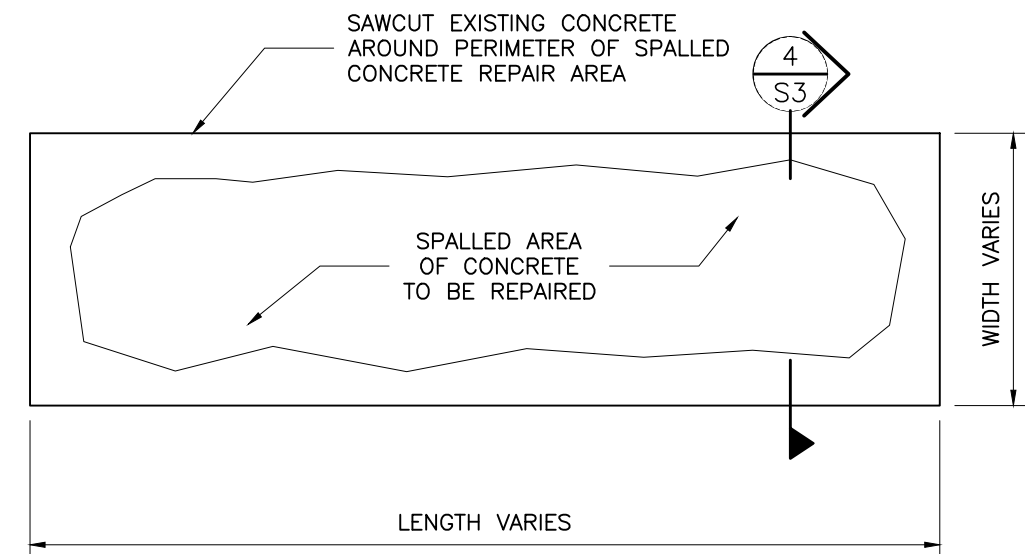

3
S3 / SCALE: N.T.S.

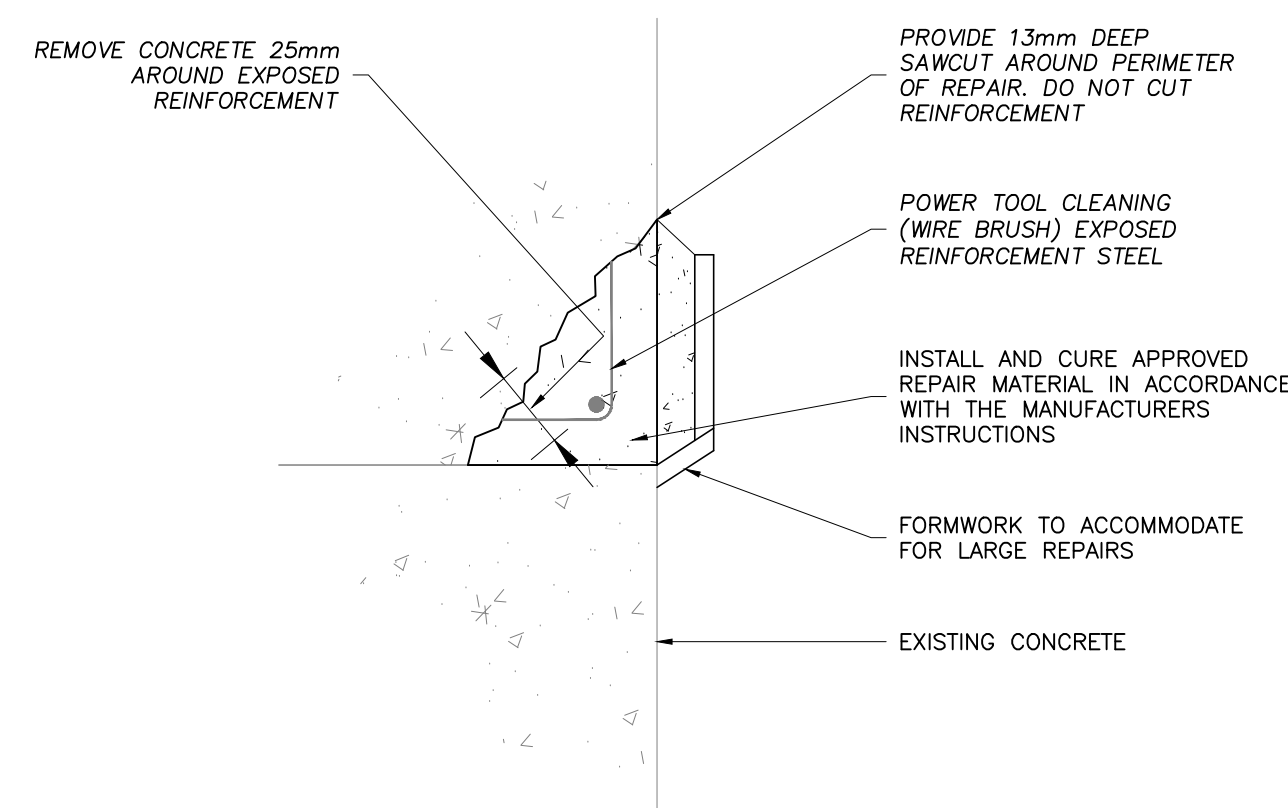

6
S3 / SCALE: N.T.S.

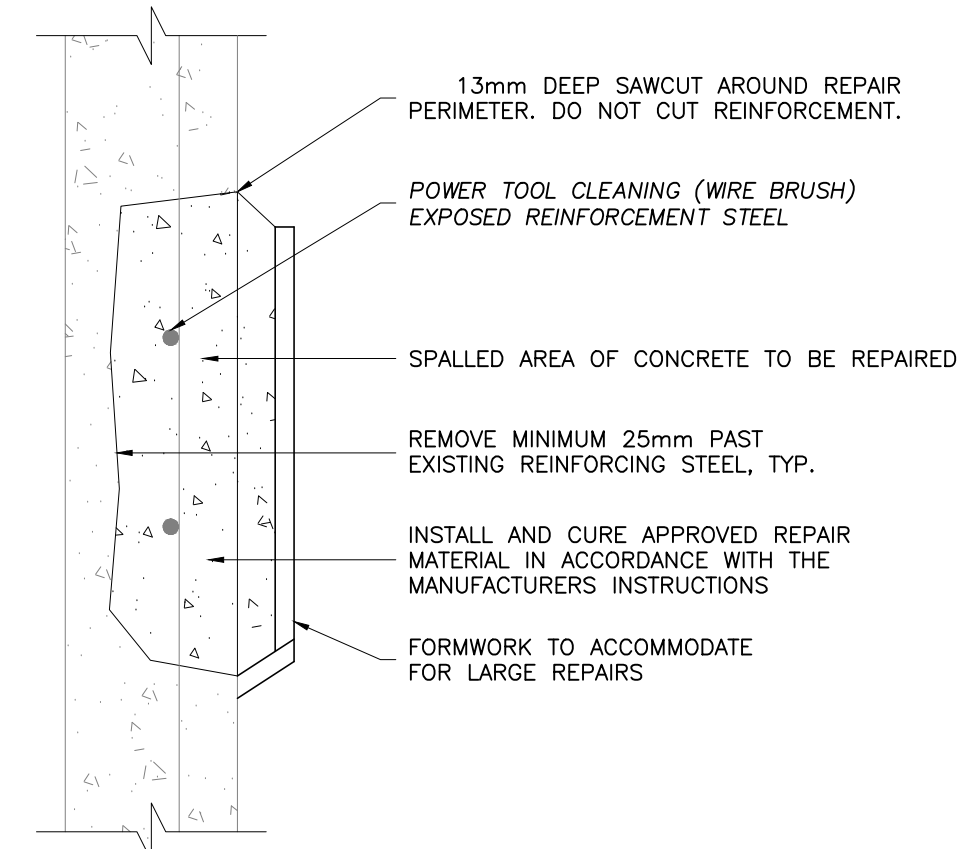

4
S3 / SCALE: N.T.S.

NO.	REVISION	DATE
1	ISSUED FOR 80% CLIENT REVIEW	JAN. 24, 2018
2	ISSUED FOR FINAL REVIEW	APR. 6, 2018
3		
4		
5		
6		
7		

NOTES:
CONTRACTOR SHALL CHECK AND VERIFY ALL DIMENSIONS AND BE RESPONSIBLE FOR REPORTING ALL DISCREPANCIES TO OWNER AND/OR CONSULTANT PRIOR TO TENDER CLOSING

LATEST APPROVED DRAWINGS ONLY TO BE USED FOR CONSTRUCTION.

PRINTS ARE NOT TO BE SCALED.
ALL DIMENSIONS INDICATED ARE IN MILLIMETRES (mm) UNLESS OTHER WISE NOTED.

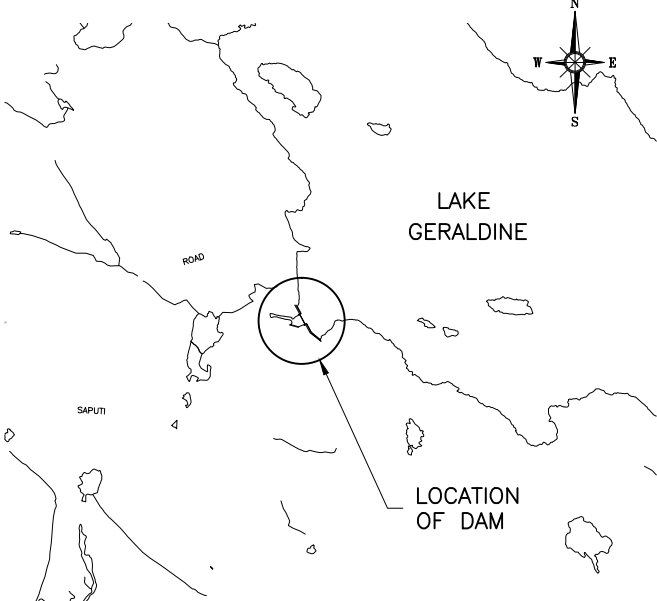

LONDON Tel. 1-519-452-7700 Toll Free 1-866-919-4531	OTTAWA Tel. 1-613-824-8900 Toll Free 1-866-919-4530
IQALUIT Tel. 1-867-979-3300 Toll Free 1-866-919-4533	SASKATOON Tel. 1-306-343-5500 Toll Free 1-866-919-8899
WINNIPEG Tel. 1-204-783-1276 Toll Free 1-866-919-4531	MISSISSAUGA Tel. 1-905-286-1100

CLIENT NAME:
CITY OF IQALUIT

PROJECT ADDRESS:
IQALUIT, NUNAVUT

PROJECT NAME:
LAKE GERALDINE DAM
UNDERWATER REPAIRS

DRAWING TITLE:
DETAILS

DESIGN: WRS | SCALE: AS SHOWN
DRAWN: BHR | DATE: JAN.2018
APPVD: ADM | FILE No: 17-7582