

SOUTHERN LIGHT ORIENTED TO NEW UNUSUAL DIRECTION OF 65/202/100/15/15

EXP SERVICES INC. IS A REGISTERED PROFESSIONAL ENGINEER

### KEYNOTES:

1. INSTALL OWNER-SUPPLIED INSTRUMENTATION PER MANUFACTURER'S GUIDELINES. PROVIDE ANY ADDITIONAL FITTINGS REQUIRED.
2. APPROXIMATE LOCATIONS SHOWN.

### NOTES:

1. THE EXISTING PLANT FACILITIES HAVE BEEN BASED ON CONSTRUCTION DRAWINGS PROVIDED BY THE GOVERNMENT OF NUNAVUT. SITE PHOTOGRAPHS AND OBSERVATIONS. NO ATTEMPT HAS BEEN MADE TO VERIFY THE ACCURACY OF THESE DRAWINGS AND THE ENGINEER ASSUMES NO RESPONSIBILITY FOR THIS INFORMATION.  
  
THE CONTRACTOR IS TOTALLY RESPONSIBLE TO DETERMINE THE LOCATION OF EXISTING FACILITIES AND REPORT ANY DISCREPANCIES AFFECTING THE WORK.  
  
THE CONTRACTOR IS RESPONSIBLE FOR ALL LAYOUT. FIELD VERIFY THE SIZE AND LOCATION OF EXISTING EQUIPMENT, PIPING AND RELATED ACCESSORIES DEPICTED ON THE DRAWINGS. IF UNFORSEEN SITE CONSTRAINTS NECESSITATE COMPONENT RELOCATION THEN NOTIFY THE ENGINEER OF THE PROPOSED MODIFICATION AND OBTAIN APPROVAL PRIOR TO CONSTRUCTION.
2. REFER TO P401 SERIES DRAWINGS FOR PROCESS ABBREVIATIONS, SYMBOLS, LEGENDS AND P&ID'S.
3. COORDINATE LOCATION OF DEFOAMER METERING SYSTEM WITH STRUCTURAL AND MECHANICAL DRAWINGS. MAKE ADJUSTMENTS TO PIPING AS REQUIRED TO SUIT LOCATION.

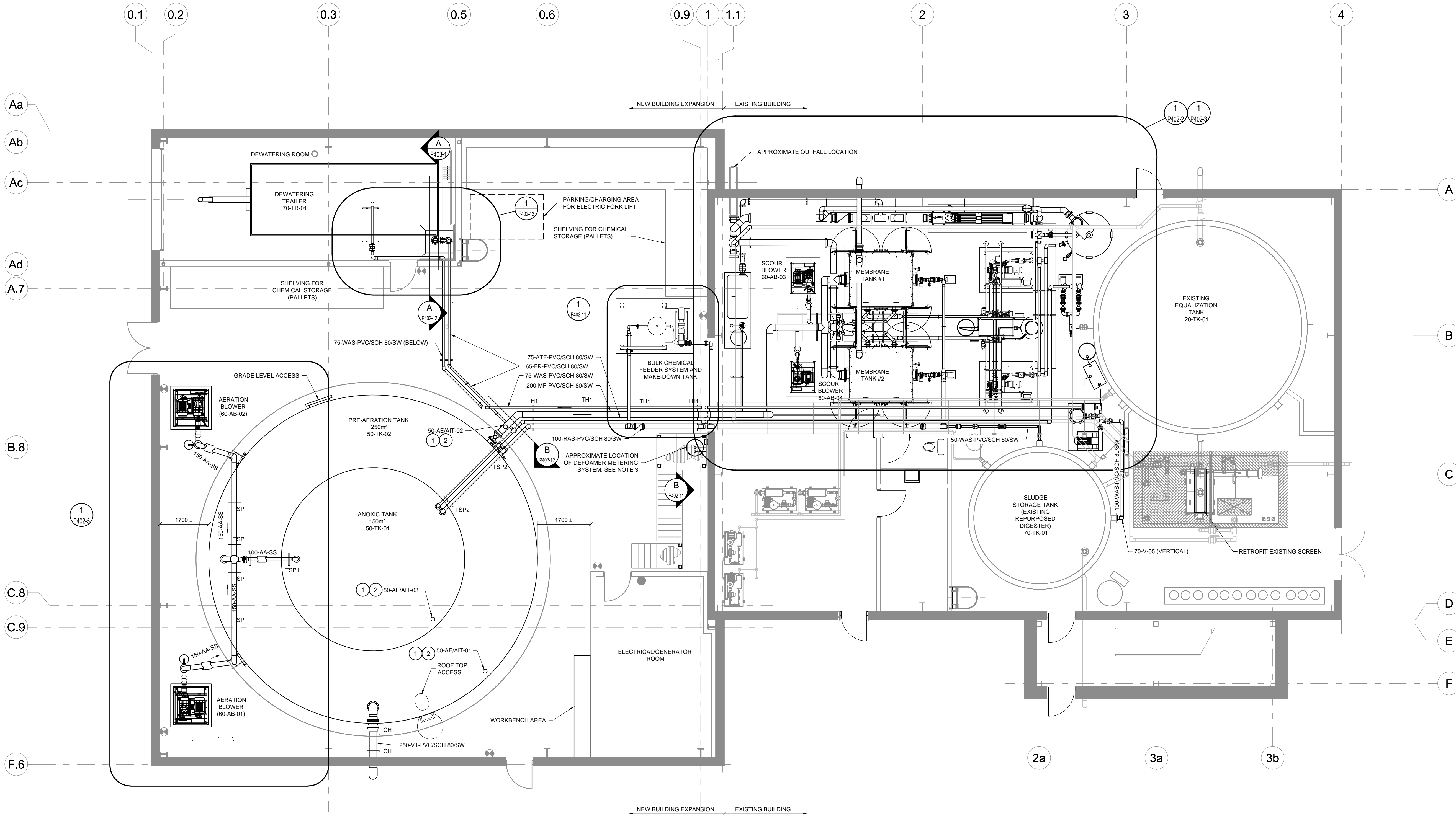

No.	Issue	Date
1	60% REVIEW SUBMISSION	2013-MAR-08
2	ISSUED FOR TENDER	2013-APR-10
3	RELEASED FOR CONSTRUCTION	2013-JUN-27



No.	Revision	Ckd. By	Date
-----	----------	---------	------

PERMIT OF PRACTICE EXP SERVICES INC.	
Signature	<i>[Signature]</i>
Date	2013/JUNE/27
PERMIT NUMBER: P483 NT/NU Association of Professional Engineers and Geoscientists	

RELEASED FOR CONSTRUCTION

	Const. North
	Drawn By: ARL/PD
	Dwg. Standards Ckd. By: PD
	Designed By: DFB
Date Printed	Dwg. Design Ckd. By: SAO

exp Services Inc.  
t: +1.613.688.1899 | f: +1.613.225.7330  
2650 Queensview Drive, Unit 100  
Ottawa, ON K2B 8H6  
CANADA  
[www.exp.com](http://www.exp.com)



- BUILDINGS • EARTH & ENVIRONMENT • ENERGY •
- INDUSTRIAL • INFRASTRUCTURE • SUSTAINABILITY •

Project Title  
**WASTE WATER  
TREATMENT PLANT  
UPGRADE  
PANGNIRTUNG, NU**

Dwg. Title  
**PROCESS EQUIPMENT  
AND PIPING PLAN**

Project No.	OTT-00204430-A0	
Dwg. No.	<b>P402-1</b>	Rev. No. 0
Scale	1:75 This drawing is not to be scaled	