

- 62 HOUSE NUMBER (AS PER SITE VISIT 2009)
- WATER LINE
- DIRECTION OF FLOW
- AV21
- AV5(HYD)
- AV40
- ACCESS VAULT
- ACCESS VAULT WITH FIRE HYDRANT
- ACCESS VAULT PART OF 2005 NEW DEVELOPMENTS

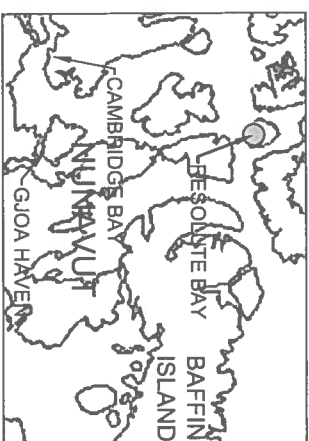
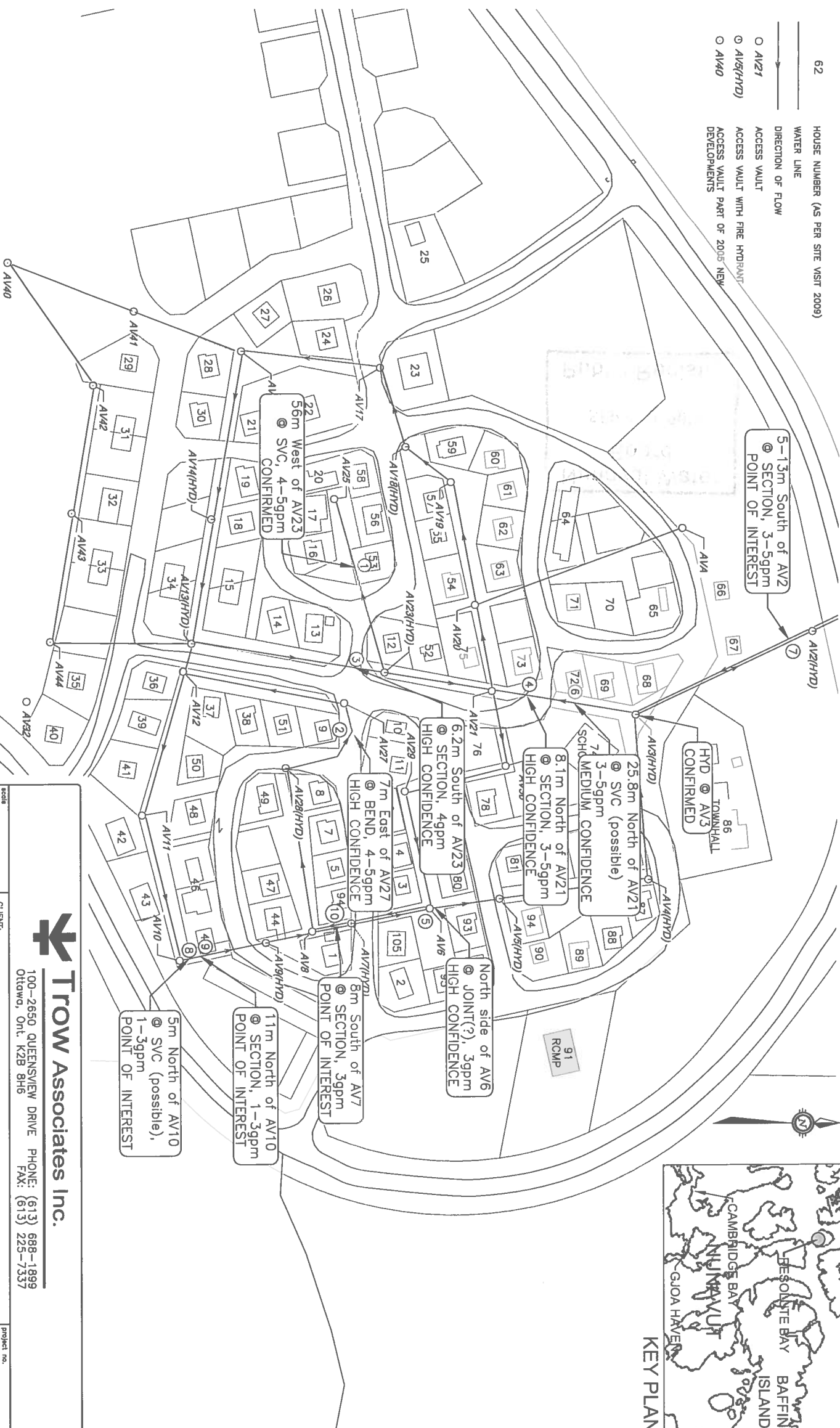

Trow Associates Inc.
100-2650 QUEENSVIEW DRIVE PHONE: (613) 688-1899
Ottawa, Ont. K2B 8H6 FAX: (613) 225-7337

scale	1:2000	CLIENT:	GOVERNMENT OF NUNAVUT	project no.	OTCD00020430A
date	20/09/10	TITLE:	LEAK DETECTION DEFICIENCIES		
drawn by	C.ROACH			D1	