

DIMENSIONS

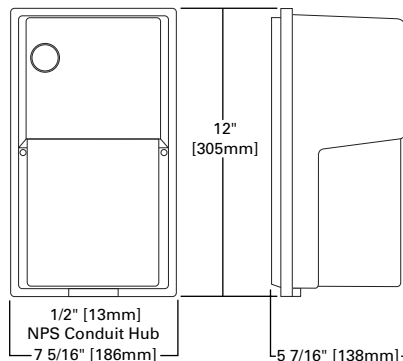

MOUNTING DETAIL

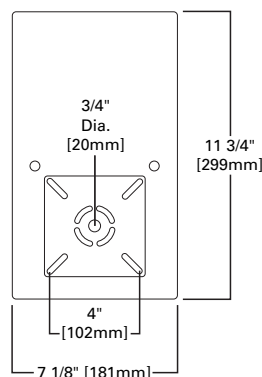

ORDERING INFORMATION

SAMPLE NUMBER: MHWM10G

Lamp Type ¹ MH=Metal Halide	Series WM=Wal-Lite	Lamp Wattage 50=50W 70=70W 10=100W	Lens Type G=Glass
--	------------------------------	--	-----------------------------

Accessories²

PB120V=Button Photocontrol 120V (Field Installed)
PB208/240V=Button Photocontrol 208/240V (Field Installed)
PB277V=Button Photocontrol 277V (Field Installed)
PE/MT=External Photocontrol 120/208/240/277V (Field Installed)

DESCRIPTION

The Lumark Wal-Lite Glass features a clear prismatic impact-resistant borosilicate glass lens and a die-cast aluminum back plate for rugged durability. U.L. Listed for wet locations. CSA certified.

Wal-Lite Glass can be mounted to any vertical surface, and delivers excellent beam control for areas such as entrance/eaves, corridors, parking garages, pathways, recreational, retail, security, transportation and warehouse applications.



WM WAL-LITE GLASS

50 - 100 W
Metal Halide

COMPACT GLASS
WALL MOUNT
LUMINAIRE

- Die-cast aluminum back plate
- Die-cast aluminum housing finished in bronze polyester powder coat
- Formed aluminum reflector and prismatic borosilicate glass refractor
- 4KV pulse-rated medium-base porcelain socket
- 50W is Dual-Tap, 70 & 100W is Multi-Tap
- Housing is sealed and gasketed
- 1/2" NPS entry point for direct mount applications where internal wiring is desired
- Flush-mount to vertical surface via die-cast aluminum back plate over recessed J-box or direct to wall and run supply wires through bottom 1/2" NPS entry
- U.L. listed for wet locations. CSA certified
- Approximate net weight: 12 lbs. (5.4 kgs.)

LAMP TYPE	WATTAGE
Metal Halide	50, 70, 100W

NOTES: 1 All lamps are medium-base. Lamp is included. 2 Order separately. 3 Products also available in non-US voltages and frequencies for international markets. 4 Consult your Cooper Lighting Representative for availability and ordering information. 5 Specifications and dimensions subject to change without notice.