

GENERAL NOTES:

- ALL WORK SHALL BE PERFORMED IN ACCORDANCE WITH THE REQUIREMENTS OF THE SAFETY ACT AND REGULATIONS FOR CONSTRUCTION PROJECTS (INCLUDING LATEST AMENDMENTS) AND OTHER LOCAL AUTHORITIES HAVING JURISDICTION.
- WHERE DOCUMENTS AND STANDARDS ARE REFERENCED IN THE NOTES, THEY SHALL BE THE LATEST EDITIONS, UNLESS OTHERWISE NOTED OR SHOWN.
- ALL DIMENSIONS AND ELEVATIONS SHALL BE VERIFIED ON THE JOB BY THE CONTRACTOR. CONTRACTOR IS TO REPORT DISCREPANCIES TO THE ENGINEER PROMPTLY AND BEFORE CONSTRUCTION.
- READ DRAWINGS IN CONJUNCTION WITH SPECIFICATIONS AND ALL OTHER CONTRACT DOCUMENTS, WHERE APPLICABLE.
- BEFORE PROCEEDING WITH WORK, CHECK ALL THE DIMENSIONS SHOWN ON THE STRUCTURAL DRAWINGS AGAINST THE ARCHITECTURAL, MECHANICAL, AND ELECTRICAL DRAWINGS (WHERE APPLICABLE) AND REPORT DISCREPANCIES TO THE CONSULTANT.
- ANY HORIZONTAL AND VERTICAL DESIGN LOADINGS NOTED SHALL NOT BE EXCEEDED DURING CONSTRUCTION.
- DRAWINGS ARE NOT TO BE SCALED.

CONTRACTOR SAFETY:

- PERSONNEL, EQUIPMENT, AND BUILDING MATERIALS SHALL BE REMOVED FROM THE ISOLATED WORK ZONE PRIOR TO WATER REACHING THE MAXIMUM ALLOWABLE WATER LEVEL INDICATED.
- CONTRACTOR TO CONTINUOUSLY MONITOR PRECIPITATION AND ASSOCIATED CHANGES IN WATER LEVEL.

ENVIRONMENTAL REQUIREMENTS

- THE CONTRACTOR SHALL ENSURE COMPLIANCE WITH ALL MUNICIPAL, TERRITORIAL, AND FEDERAL AUTHORITIES HAVING JURISDICTION OVER THE DURATION OF THE PROJECT.
- WHERE NOTIFICATION, EVALUATION, AND APPROVALS ARE REQUIRED FOR THE WORK, THE CONTRACTOR SHALL BE RESPONSIBLE FOR SUPPLYING THE REQUIRED INFORMATION AND PAYMENT OF ASSOCIATED FEES OR PERMITS.
- THE NOTIFICATION AND APPROVAL PROCESS SHALL INCLUDE, BUT IS NOT LIMITED TO, CONSTRUCTION OVER A WATERCOURSE (DEPARTMENT OF FISHERIES & OCEANS) DISPOSAL OF MATERIALS (CITY OF IQALUIT) AND ENVIRONMENTAL COMPLIANCE. SEE SPECIFICATIONS.

SITE PROTECTION:

- CONTRACTOR IS RESPONSIBLE FOR PROVIDING ADEQUATE SAFETY BARRIERS/ HOARDING DURING THE CONSTRUCTION PHASE.
- CONTRACTOR IS RESPONSIBLE FOR PROVIDING ADEQUATE SIGNAGE ON THE ROADWAY TO CLOSE THE BRIDGE TO VEHICULAR TRAFFIC DURING CONSTRUCTION.
- CONTRACTOR IS RESPONSIBLE FOR PROVIDING ADEQUATE FLAG PERSONS AT EACH END OF WORK AREA FOR DIRECTING TRAFFIC DURING CONSTRUCTION.
- ASTRO HILL BRIDGE IS TO REMAIN OPEN DURING REPAIRS. REPAIR WORK TO BE COMPLETED ONLY DURING NON-RUSH HOUR.
- ROAD TO NOWHERE AND APEX MAY BE TEMPORARILY CLOSED. SEE SPECIFICATIONS.

CONSTRUCTION LOADS:

- CONSTRUCTION WORK SHALL NOT EXCEED 50psf DURING THE COURSE OF THE WORK FOR APEX BRIDGE.

MATERIALS AND EXECUTION:

GRANULARS

- GRANULAR A AGGREGATES SHALL CONSIST OF CRUSHED ROCK COMPOSED OF HARD, UNCOATED, FRACTURED FRAGMENTS, PRODUCED FROM ROCK FORMATIONS OR BOULDERS OF UNIFORM QUALITY, OR A MIXTURE OF CRUSHED GRAVEL, SAND AND FINES COMPOSED OF HARD, DURABLE, UNCOATED PARTICLES, PRODUCED FROM NATURALLY FORMED DEPOSITS, OR CRUSHED SLAG PRODUCED FROM IRON BLAST FURNACE OR NICKEL SLAG. PARTICLE SIZES NO LARGER THAN 25mm. STEEL SLAG SHALL NOT BE USED. RECLAIMED ASPHALT PAVEMENT CONTAINING STEEL SLAG AGGREGATES WILL NOT BE ACCEPTABLE.
- RIP-RAP SHALL BE PRODUCED FROM CRUSHED OR FRACTURED BEDROCK FRAGMENTS WITH 100% FRACTURED FACES OR CRUSHED FROM COBBLES OR BOULDERS GREATER THAN 300mm DIAMETER AND SHALL NOT DETERIORATE WHEN EXPOSED TO AIR AND WATER AND SHALL BE RESISTANT TO DETERIORATION BY CYCLES OF WETTING, DRYING, FREEZING, AND THAWING. RECLAIMED PORTLAND CEMENT CONCRETE MAY NOT BE USED. RIP-RAP SHALL CONFORM TO R10 GRADATION REQUIREMENTS, WITH 100% OF MASS PASSING THROUGH 180MM SCREEN.
- GRANULAR SHALL BE PLACED IN LIFTS NOT GREATER THAN 6".
- GRANULAR SHALL BE COMPACTED TO 98% STANDARD PROCTOR MAXIMUM DRY DENSITY.

GUIDE RAIL

- GUIDE RAIL STEEL SHALL BE NEW MATERIAL CONFORMING TO THE REQUIREMENTS OF CSA G40.20/G40.21-04 WITH A YIELD STRENGTH OF 345MPA
- WASHER SHALL NOT BE INSTALLED AT FRONT FACE OF RAIL. ONE BOLT LOCATED AT CENTRE OF STEEL BEAM GUIDE RAIL. BOLT HEAD SHALL BE ROUNDED.

STRUCTURAL WOOD:

- DESIGN ALL TIMBER IN ACCORDANCE WITH CSA 086-09, ENGINEERING DESIGN IN WOOD.
- SAWN LUMBER PRODUCTS SHALL BE MANUFACTURED IN ACCORDANCE WITH CSA STANDARD 0141, SOFTWOOD LUMBER. THESE PRODUCTS SHALL BE VISUALLY GRADED TO THE NATIONAL LUMBER GRADES AUTHORITY STANDARD GRADING RULES FOR CANADIAN LUMBER.
- WOOD FRAMING TO BE SURFACE DRY NO. 2 GRADE SPF OR BETTER.
- PRESSURE/PRESERVATIVE TREATED LUMBER SHALL BE IN ACCORDANCE WITH CSA STANDARD 080.
- SOFT WOOD PLYWOOD SHALL CONFORM TO THE REQUIREMENTS OF CSA STANDARD 0151, FOR EXTERIOR USE.
- NAILS, SPIKES, AND STAPLES SHALL CONFORM TO THE REQUIREMENTS OF CSA STANDARD B111. POWER DRIVEN FASTENERS MAY ONLY BE SUBSTITUTED IF THE SHANK DIAMETER IS EQUAL OR GREATER THAN THE SPECIFIED DIAMETER.
- LAG SCREW MATERIALS AND DIMENSIONS AS PER CSA STANDARD B34 MISCELLANEOUS BOLTS AND SCREWS.

GEOTEXTILE:

- GEOTEXTILE SHALL BE NON-WOVEN, CLASS II.

GABION WALL:

- BASKETS SHALL BE MANUFACTURED FROM GALVANIZED STEEL WIRE MESH
- GABIONS SHALL BE ASSEMBLED AS PER MANUFACTURER'S SPECIFICATIONS. LIDS AND SIDES SHALL BE SECURED WITH WIRE.
- STONE SHALL BE PRODUCED FROM CRUSHED OR FRACTURED ROCK FRAGMENTS WITH 100% FRACTURED FACES.
- STONES SHALL BE LARGER THAN 2.5 kg AND SMALLER THAN 15 kg.
- STONES SHALL BE PLACED IN A MANNER AS TO NOT DAMAGE THE WIRE MESH. STONES SHALL BE PLACED TO MINIMIZE VOIDS BETWEEN STONES.
- PRIOR TO SECURING LIDS THE BASKET SHALL BE SLIGHTLY OVERFILLED BY 25-50mm TO ALLOW FOR SETTLEMENT.

DRAWING LIST:

- C0 - GENERAL NOTES, DRAWING LIST AND LOCATION PLAN
C1 - ROAD TO NOWHERE BRIDGE SITE PLAN
C2 - ROAD TO NOWHERE BRIDGE CONSTRUCTION DETAILS
C3 - ASTRO HILL BRIDGE SITE PLAN & CONSTRUCTION DETAILS
C4 - APEX BRIDGE SITE PLAN & CONSTRUCTION DETAILS

SCOPE OF WORK:

ROAD TO NOWHERE BRIDGE:

- EXCAVATE AND REPLACE ABUTMENT BALLAST WALL.
- PLACE GABION BASKETS AT EDGES OF ROADWAY.
- RE-GRADING WITH GRANULAR FILL AND RIP-RAP INCLUDING A ROCK APRON

APEX BRIDGE:

- REPLACEMENT OF WOOD CURB.
- REPLACEMENT OF MISSING BOLTS.
- LOCALIZED REPAIRS TO APPROACH BANKS AS INDICATED, CONSISTING OF FILLING AREAS OF WASHOUT AND INSTALLING ADDITIONAL RIP-RAP PROTECTION.

ASTRO HILL BRIDGE:

- LOCALIZED REPAIRS TO APPROACH BANKS AS INDICATED, CONSISTING OF FILLING AREAS OF WASHOUT AND INSTALLING ADDITIONAL RIP-RAP PROTECTION.

NO.	REVISION	DATE
1	ISSUED FOR CLIENT REVIEW	NOV. 21, 2018
2	ISSUED FOR TENDER	JAN. 22, 2019
3		
4		
5		
6		
7		

NOTES:

CONTRACTOR SHALL CHECK AND VERIFY ALL DIMENSIONS AND BE RESPONSIBLE FOR REPORTING ALL DISCREPANCIES TO OWNER AND/OR CONSULTANT PRIOR TO TENDER CLOSING.

LATEST APPROVED DRAWINGS ONLY TO BE USED FOR CONSTRUCTION.

PRINTS ARE NOT TO BE SCALED.

ALL DIMENSIONS INDICATED ARE IN MILLIMETRES (mm)
UNLESS OTHERWISE NOTED.

KEY PLAN:

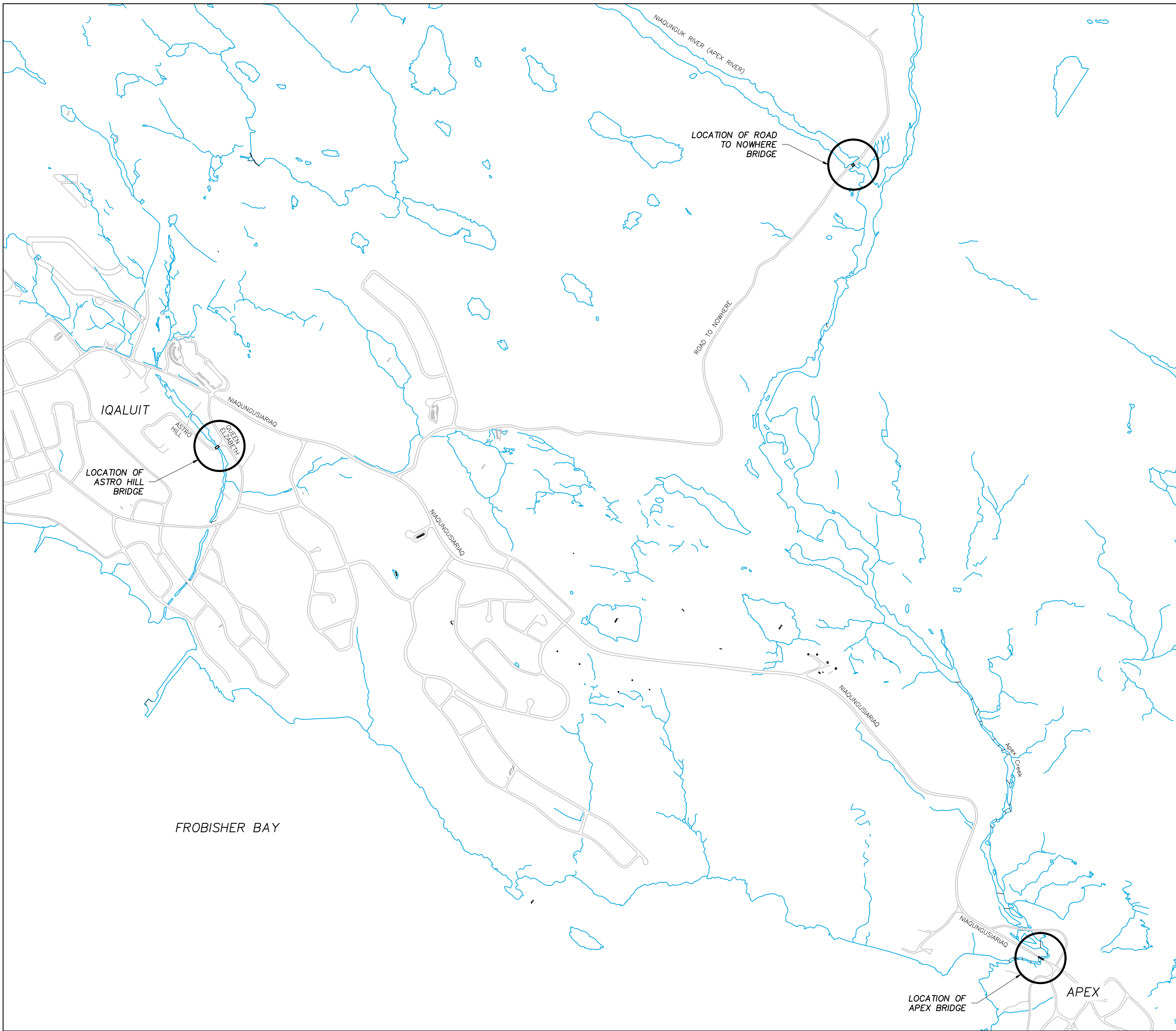

PERMIT TO PRACTICE
Concentric Associates International Inc.
Signature: *[Signature]*
Date: 01/22/2019
PERMIT NUMBER: P 492
The Association of Professional Engineers,
Geologists and Geophysicists of the NWT / NU



LONDON Toll Free 1-866-919-4531
OTTAWA Toll Free 1-866-919-4530
IQALUIT Toll Free 1-866-919-4531
SASKATOON Toll Free 1-866-919-8899
WINNIPEG Toll Free 1-866-919-4531
TORONTO Tel. 1-647-351-0095
COQUITLAM Toll Free 1-866-919-4531

CLIENT NAME:

CITY OF IQALUIT

PROJECT ADDRESS:

IQALUIT, NUNAVUT

PROJECT NAME:

2019 BRIDGE REPAIRS

DRAWING TITLE:

GENERAL NOTES, DRAWING LIST &
LOCATION PLAN

DESIGN: TJP
DRAWN: JAVA
APPVD: STP
SCALE: NTS
DATE: DEC /2017
FILE No: 17-7519

SHEET No.

C0

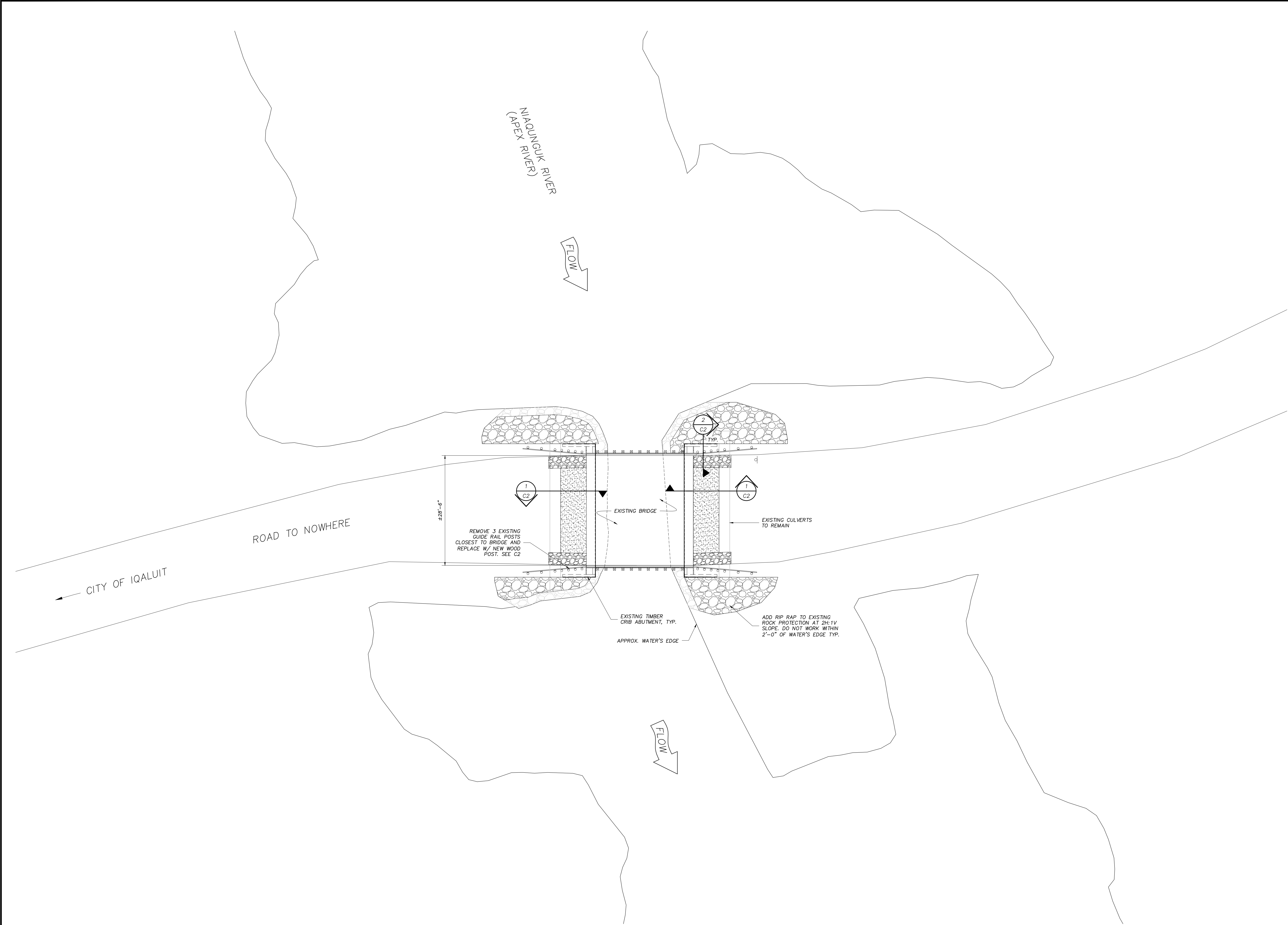

ROAD TO NOWHERE BRIDGE SITE PLAN
SCALE: NTS

NO.	REVISION	DATE
1	ISSUED FOR CLIENT REVIEW	NOV. 21, 2018
2	ISSUED FOR TENDER	JAN. 22, 2019
3		
4		
5		
6		
7		

NOTES:

CONTRACTOR SHALL CHECK AND VERIFY ALL DIMENSIONS AND BE RESPONSIBLE FOR REPORTING ALL DISCREPANCIES TO OWNER AND/OR CONSULTANT PRIOR TO TENDER CLOSING.

LATEST APPROVED DRAWINGS ONLY TO BE USED FOR CONSTRUCTION.

PRINTS ARE NOT TO BE SCALED.

ALL DIMENSIONS INDICATED ARE IN MILLIMETRES (mm) UNLESS OTHERWISE NOTED.

KEY PLAN:

PERMIT TO PRACTICE
Concentric Associates International Inc.
Signature: *[Signature]*
Date: 01/22/2019
PERMIT NUMBER: P 492
The Association of Professional Engineers,
Geologists and Geophysicists of the NWT / NU



- LONDON

Toll Free 1-866-919-4531
- OTTAWA

Toll Free 1-866-919-4530
- IQALUIT

Toll Free 1-866-919-4531
- SASKATOON

Toll Free 1-866-919-8899
- WINNIPEG

Toll Free 1-866-919-4531
- TORONTO

Tel. 1-647-351-0095
- COQUITLAM

Toll Free 1-866-919-4531

CLIENT NAME:

CITY OF IQALUIT

PROJECT ADDRESS:

IQALUIT, NUNAVUT

PROJECT NAME:

2019 BRIDGE REPAIRS

DRAWING TITLE:

ROAD TO NOWHERE BRIDGE SITE PLAN

DESIGN:	TJP	SCALE:	NTS
DRAWN:	JAVA	DATE:	DEC /2017
APPVD:	STP	FILE No:	17-7519

SHEET No.

C1

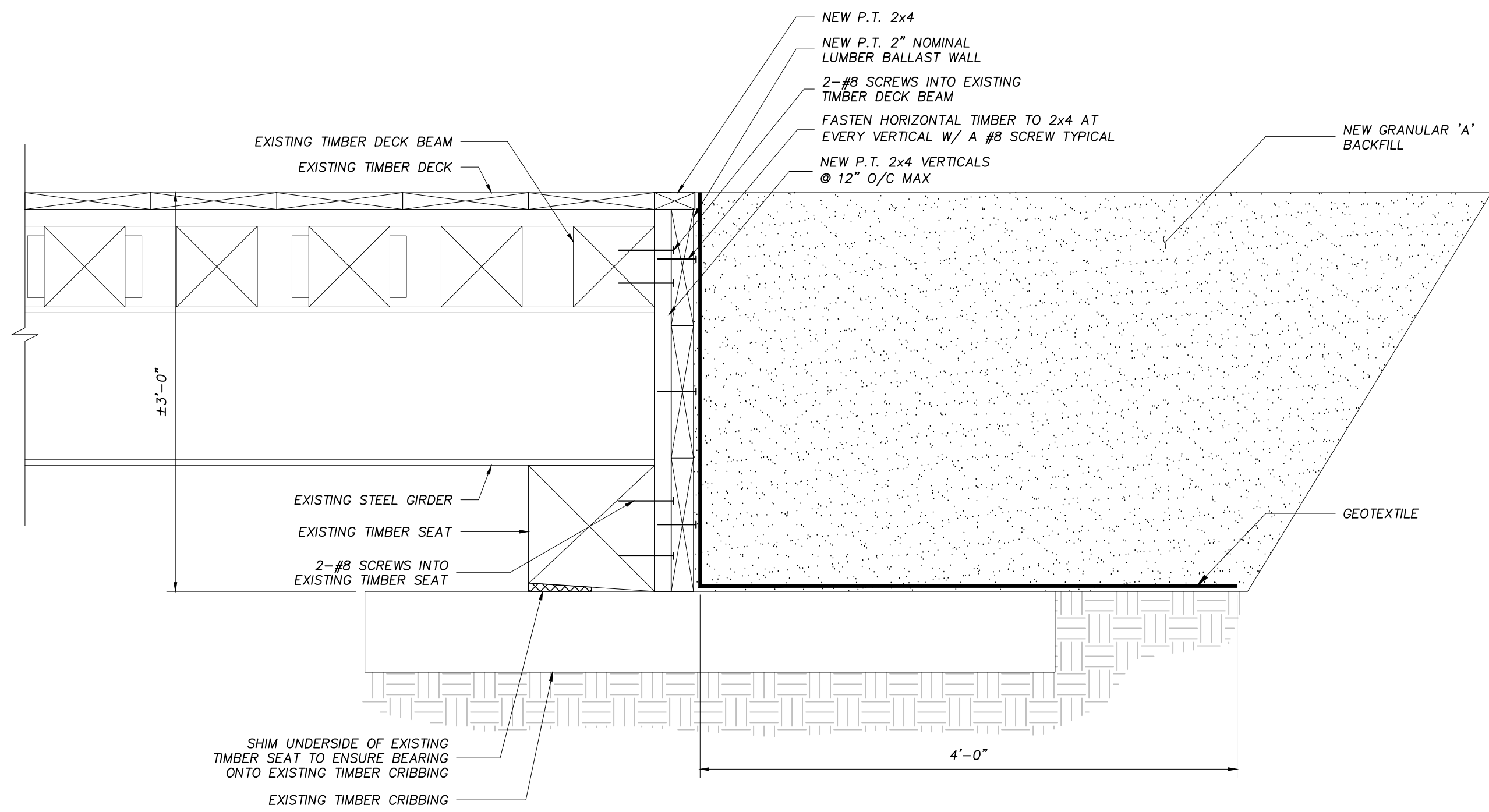

1 DETAIL
C2 SCALE: NTS

NOTE: DETAIL APPLIES TO BOTH SIDES OF BRIDGE

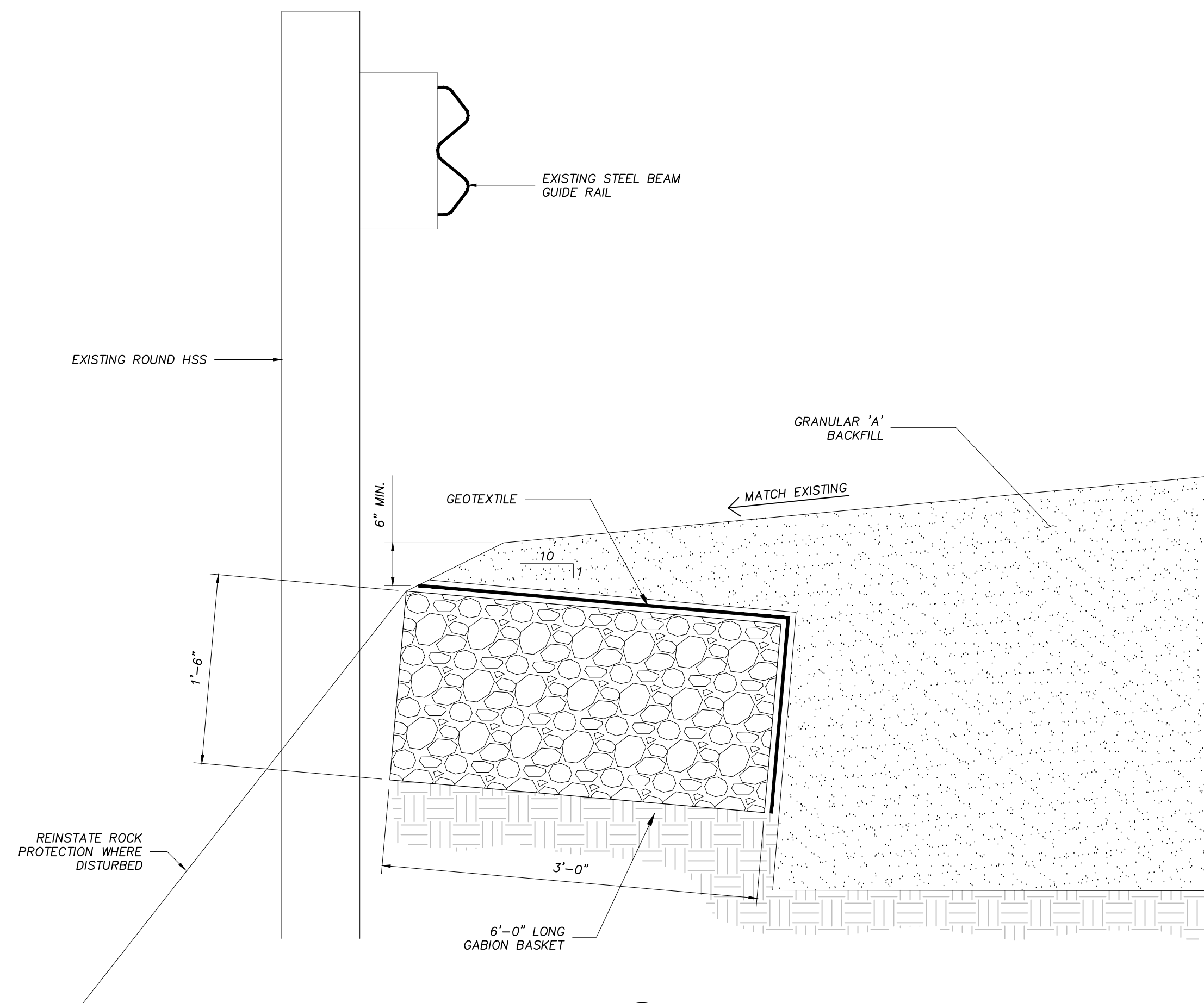

2 DETAIL
C2 SCALE: NTS

NOTE: DETAIL APPLIES TO BOTH SIDES OF BRIDGE

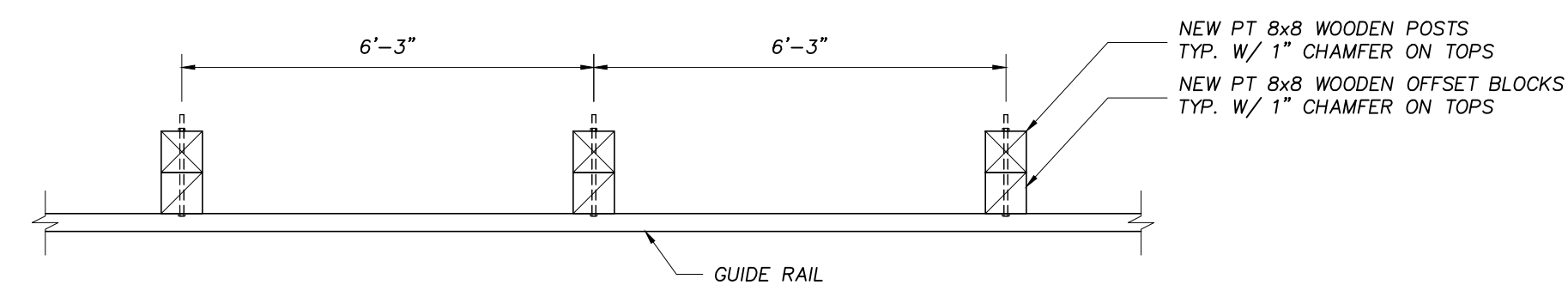

PLAN

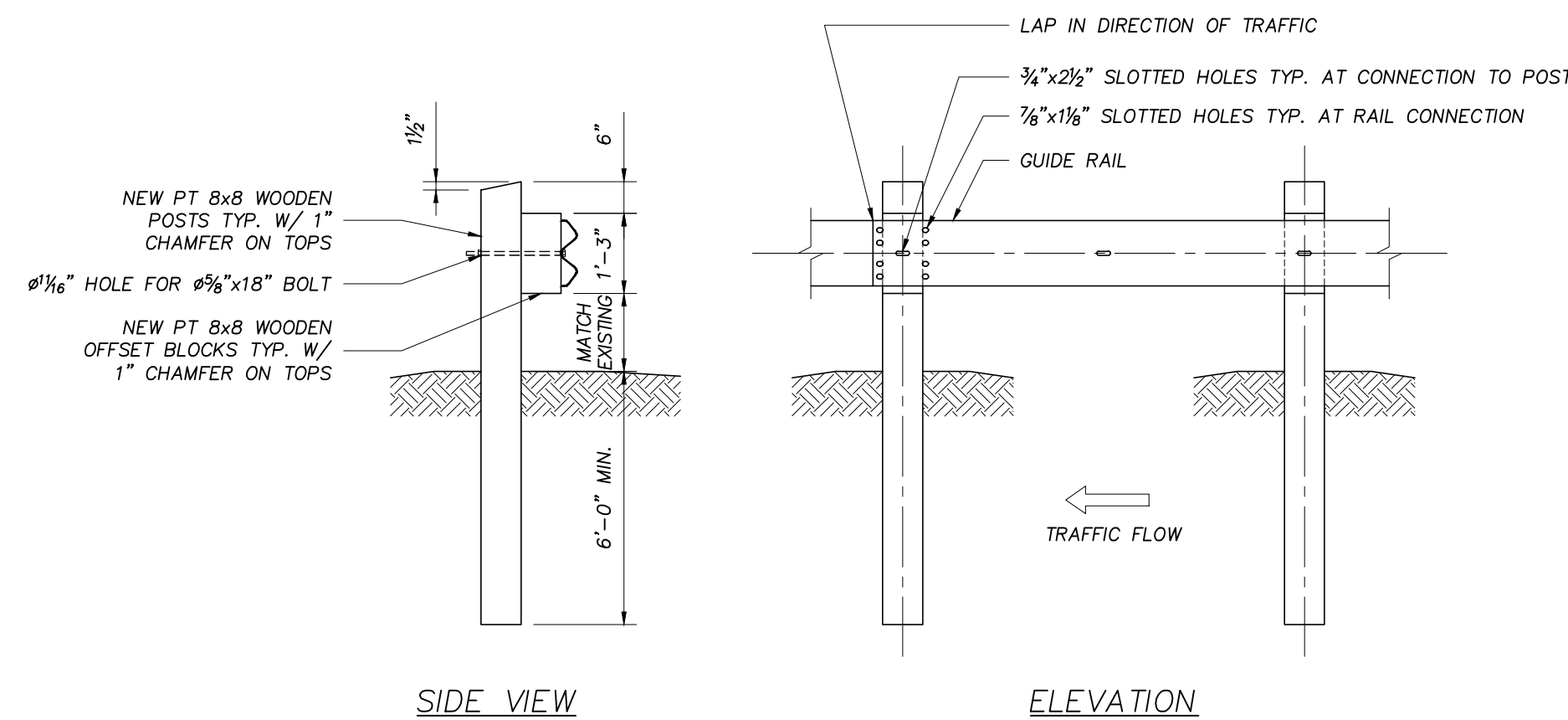

SIDE VIEW

ELEVATION

STEEL BEAM GUIDE RAIL
SCALE: NTS

NO.	REVISION	DATE
1	ISSUED FOR CLIENT REVIEW	NOV. 21, 2018
2	ISSUED FOR TENDER	JAN. 22, 2019
3		
4		
5		
6		
7		

NOTES:

CONTRACTOR SHALL CHECK AND VERIFY ALL DIMENSIONS AND BE RESPONSIBLE FOR REPORTING ALL DISCREPANCIES TO OWNER AND/OR CONSULTANT PRIOR TO TENDER CLOSING.

LATEST APPROVED DRAWINGS ONLY TO BE USED FOR CONSTRUCTION.

PRINTS ARE NOT TO BE SCALED.

ALL DIMENSIONS INDICATED ARE IN MILLIMETRES (mm) UNLESS OTHERWISE NOTED.

KEY PLAN:

PERMIT TO PRACTICE	
Concentric Associates International Inc.	
Signature	
Date	01/22/2019
PERMIT NUMBER: P 492	
The Association of Professional Engineers, Geologists and Geophysicists of the NWT / NU	



LONDON Toll Free 1-866-919-4531	OTTAWA Toll Free 1-866-919-4530
IQALUIT Toll Free 1-866-919-4531	SASKATOON Toll Free 1-866-919-8899
WINNIPEG Toll Free 1-866-919-4531	TORONTO Tel. 1-647-351-0095
COQUITLAM Toll Free 1-866-919-4531	

CLIENT NAME:

CITY OF IQALUIT

PROJECT ADDRESS:

IQALUIT, NUNAVUT

PROJECT NAME:

2019 BRIDGE REPAIRS

DRAWING TITLE:

ROAD TO NOWHERE BRIDGE
CONSTRUCTION DETAILS

DESIGN: TJP	SCALE: NTS
DRAWN: JAVA	DATE: DEC /2017
APPVD: STP	FILE No: 17-7519

SHEET No.

C2

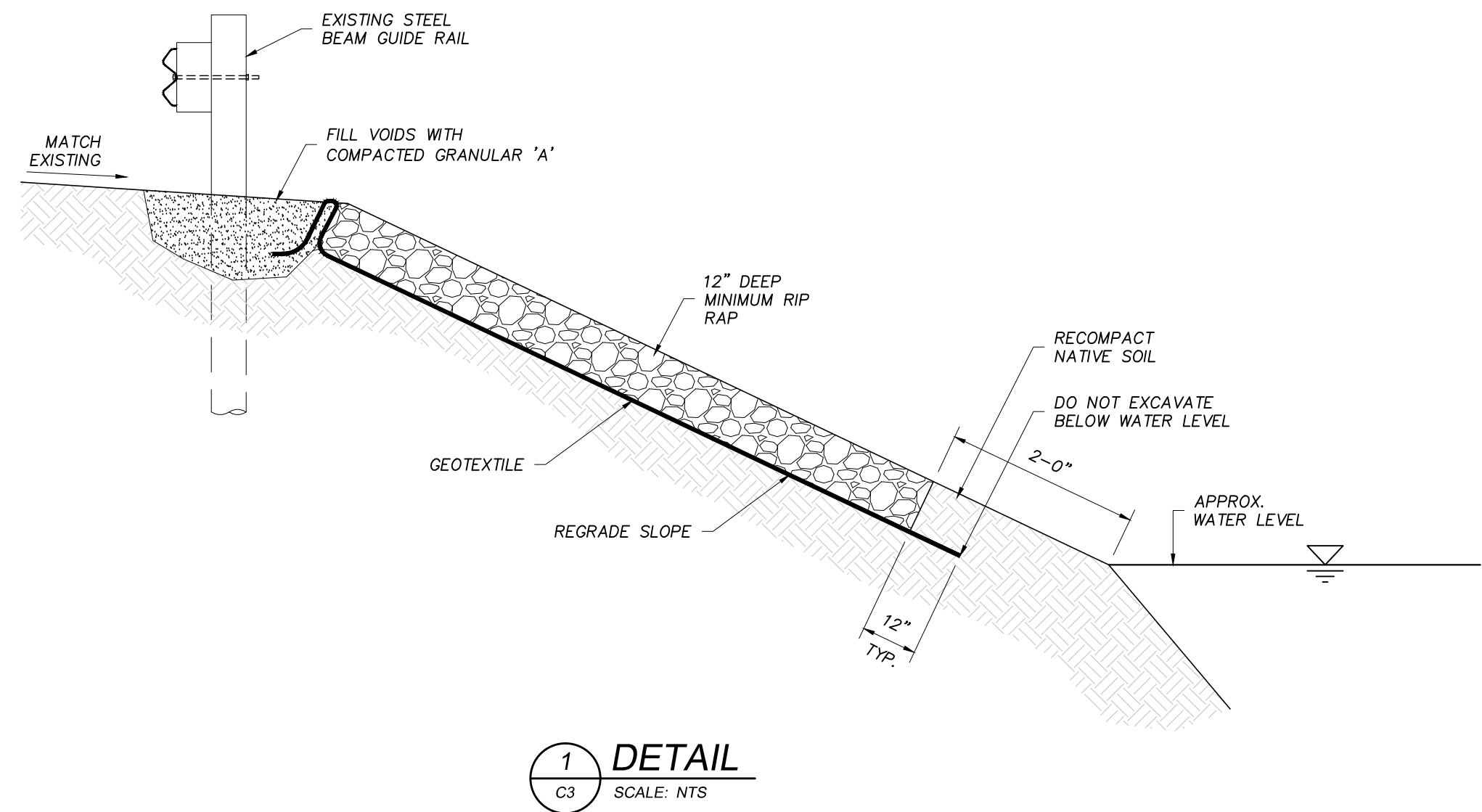
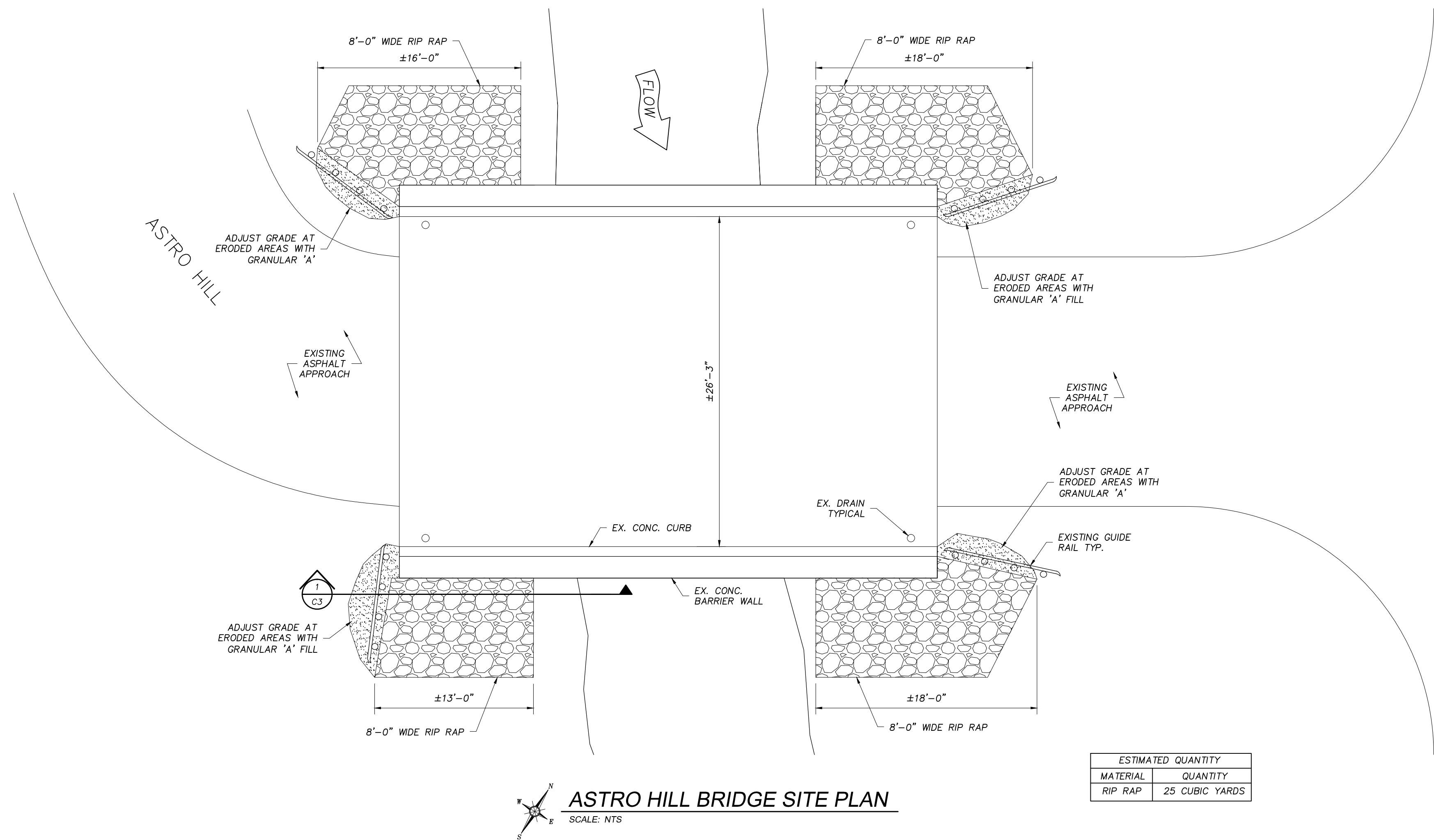

NO.	REVISION	DATE
1	ISSUED FOR CLIENT REVIEW	NOV. 21, 2018
2	ISSUED FOR TENDER	JAN. 22, 2019
3		
4		
5		
6		
7		

NOTES:

CONTRACTOR SHALL CHECK AND VERIFY ALL DIMENSIONS AND BE RESPONSIBLE FOR REPORTING ALL DISCREPANCIES TO OWNER AND/OR CONSULTANT PRIOR TO TENDER CLOSING.

LATEST APPROVED DRAWINGS ONLY TO BE USED FOR CONSTRUCTION.

PRINTS ARE NOT TO BE SCALED.

ALL DIMENSIONS INDICATED ARE IN MILLIMETRES (mm) UNLESS OTHERWISE NOTED.

KEY PLAN:

PERMIT TO PRACTICE
Concentric Associates International Inc.
Signature: *[Signature]*
Date: 01/22/2019
PERMIT NUMBER: P 492
The Association of Professional Engineers,
Geologists and Geophysicists of the NWT / NU



LONDON Toll Free 1-866-919-4531 OTTAWA Toll Free 1-866-919-4530
IQUALUIT Toll Free 1-866-919-4531 SASKATOON Toll Free 1-866-919-8899
WINNIPEG Toll Free 1-866-919-4531 TORONTO Tel. 1-647-351-0095
COQUITLAM Toll Free 1-866-919-4531

CLIENT NAME:

CITY OF IQUALUIT

PROJECT ADDRESS:

IQUALUIT, NUNAVUT

PROJECT NAME:

2019 BRIDGE REPAIRS

DRAWING TITLE:

ASTRO HILL BRIDGE SITE PLAN &
CONSTRUCTION DETAILS

DESIGN: TJP SCALE: NTS
DRAWN: JAVA DATE: DEC /2017
APPVD: STP FILE No: 17-7519

SHEET No.

C3

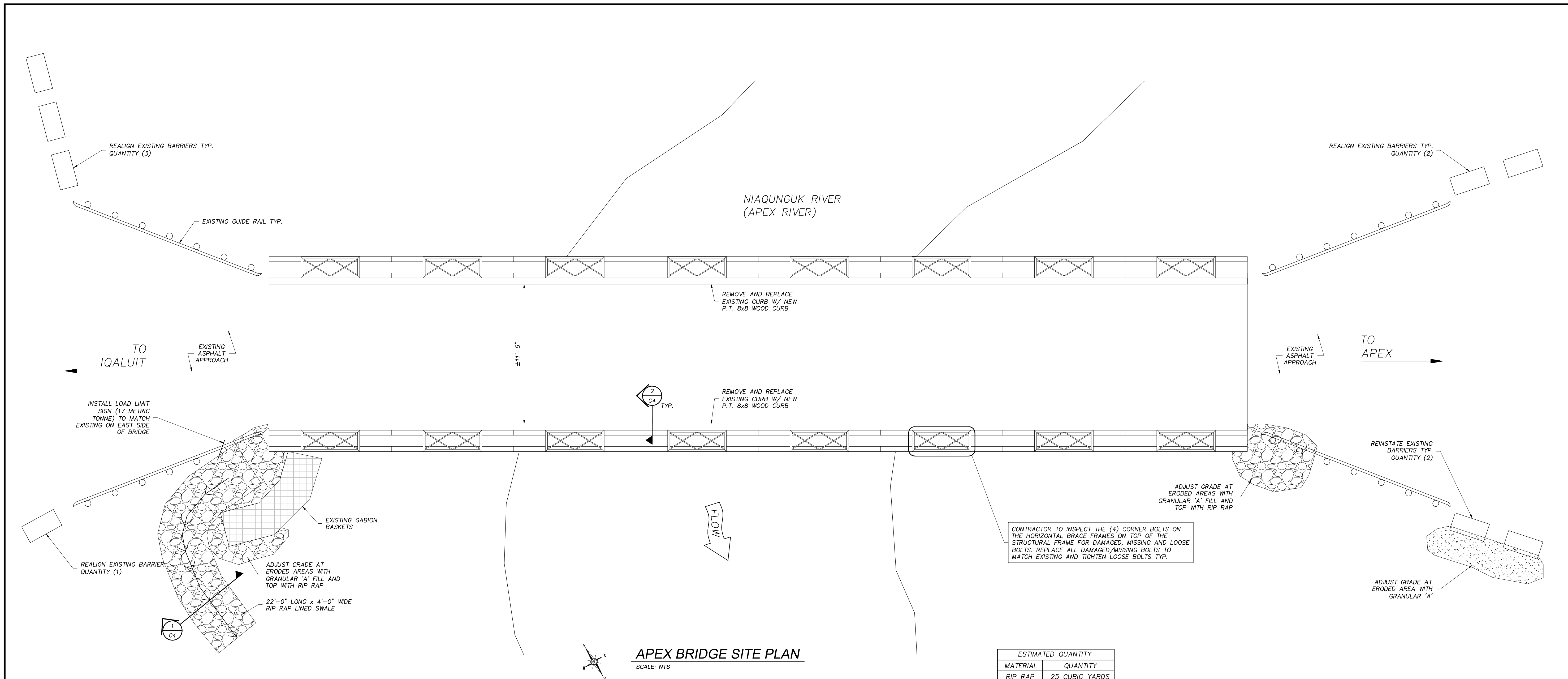

ESTIMATED QUANTITY	
MATERIAL	QUANTITY
RIP RAP	25 CUBIC YARDS

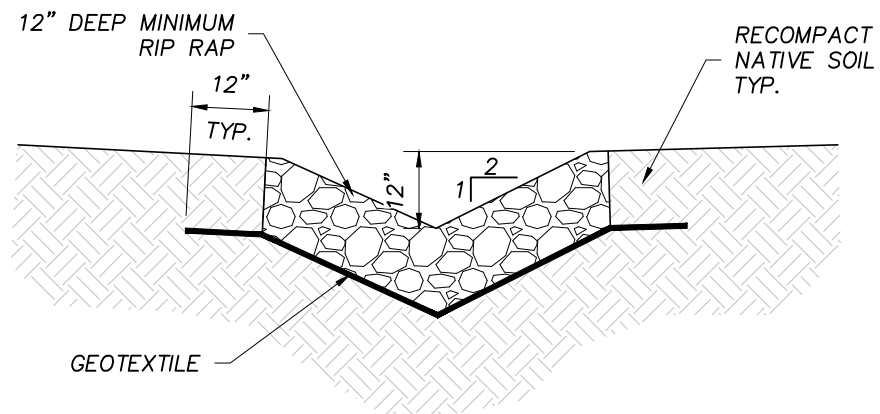

1
C4
DETAIL
SCALE: NTS

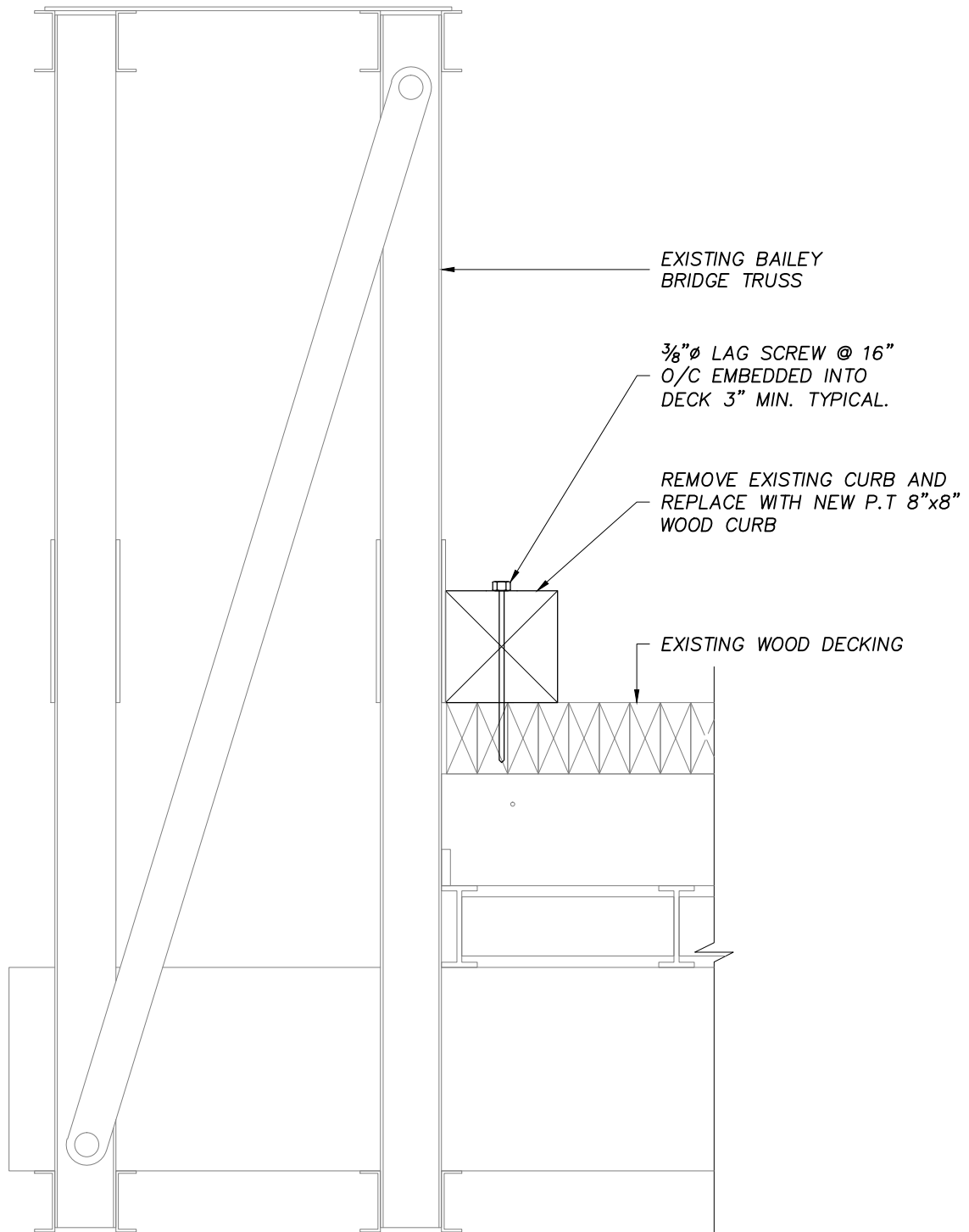

2
C4
CURB REPLACEMENT DETAIL
SCALE: NTS

NOTE: DETAIL APPLIES TO BOTH SIDES OF BRIDGE

NO.	REVISION	DATE
1	ISSUED FOR CLIENT REVIEW	NOV. 21, 2018
2	ISSUED FOR TENDER	JAN. 22, 2019
3		
4		
5		
6		
7		

NOTES:

CONTRACTOR SHALL CHECK AND VERIFY ALL DIMENSIONS AND BE RESPONSIBLE FOR REPORTING ALL DISCREPANCIES TO OWNER AND/OR CONSULTANT PRIOR TO TENDER CLOSING.

LATEST APPROVED DRAWINGS ONLY TO BE USED FOR CONSTRUCTION.

PRINTS ARE NOT TO BE SCALED.

ALL DIMENSIONS INDICATED ARE IN MILLIMETRES (mm) UNLESS OTHERWISE NOTED.

KEY PLAN:

PERMIT TO PRACTICE
Concentric Associates International Inc.
Signature: *[Signature]*
Date: 01/22/2019
PERMIT NUMBER: P 492
The Association of Professional Engineers,
Geologists and Geophysicists of the NWT / NU



LONDON Toll Free 1-866-919-4531
OTTAWA Toll Free 1-866-919-4530
IQALUIT Toll Free 1-866-919-4531
SASKATOON Toll Free 1-866-919-8899
WINNIPEG Toll Free 1-866-919-4531
TORONTO Tel. 1-647-351-0095
COQUITLAM Toll Free 1-866-919-4531

CLIENT NAME:

CITY OF IQALUIT

PROJECT ADDRESS:

IQALUIT, NUNAVUT

PROJECT NAME:

2019 BRIDGE REPAIRS

DRAWING TITLE:

APEX BRIDGE SITE PLAN &
CONSTRUCTION DETAILS

DESIGN: TJP
DRAWN: JAVA
APPVD: STP

SCALE: NTS
DATE: DEC /2017
FILE No: 17-7519

SHEET No.

C4