

DEPARTMENT OF COMMUNITY AND GOVERNMENT SERVICES PROJECT No. 12-3013



INDEX OF DRAWINGS	
DWG No.	DESCRIPTION
G1.00	COVER SHEET
G1.01	INDEX OF DRAWINGS, GENERAL NOTES, SPECIFICATIONS & QUANTITIES
G1.02	GRAVEL SOURCES & SAMPLE LOCATIONS
G1.03	OVERALL DRAINAGE PLAN & CROSSING LOCATIONS
G1.04	GENERAL PHASING NOTES AND PHASING PLAN - PHASE 1
G1.05	PHASING PLAN - PHASE 2 & 3
G1.06	PHASING PLAN - PHASE 4 & 5
G1.07	PHASING PLAN - PHASE 6 & 7
G1.08	BYPASS ROADS - PROFILES & TYPICAL SECTION
C1.00	OVERALL SITE PLAN
C1.01	CROSSING 4 - PLAN & PROFILE
C1.02	CROSSING 4 - BRIDGE ELEVATION & SECTION
C1.03	CROSSING 7 - PLAN & PROFILE
C1.04	CROSSING 7 - BRIDGE ELEVATION & SECTION
C1.05	CROSSING 9 - CULVERT REMOVAL & REPLACEMENT
C1.06	DETAILS
C1.07	CROSSING 4 - 5 m CROSS SECTIONS
C1.08	CROSSING 7 - 5 m CROSS SECTIONS
C1.09	CROSSING 7 - 5 m CROSS SECTIONS

GENERAL NOTES:

1. THIS PROJECT SHALL BE CONSTRUCTED IN ACCORDANCE WITH THE CONTRACT PLANS AND SPECIFICATIONS AND ANY RULES, REGULATIONS, STANDARDS OR SPECIFICATIONS REFERENCED THEREIN. THE PROJECT IS SUBJECT TO INSPECTION BY THE GOVERNMENT OF NUNAVUT (GON) OR ITS REPRESENTATIVES.
2. THE CONTRACTOR SHALL COMPLY WITH ALL LOCAL, PROVINCIAL AND FEDERAL LAWS THAT ARE PERTINENT TO THIS WORK.
3. THE CONTRACTOR IS RESPONSIBLE FOR RESTORING THE SITE CONDITIONS FOLLOWING THE COMPLETION OF THE PROJECT. IT IS THE CONTRACTOR'S RESPONSIBILITY TO DOCUMENT THE EXISTING CONDITIONS AND REINSTATE THE SITE TO EXISTING OR BETTER CONDITIONS.
4. ALL DIMENSIONS ARE IN MILLIMETERS UNLESS NOTED OTHERWISE.
5. ALL CONSTRUCTION ACTIVITIES SHALL BE COMPLETED IN A MANNER SUITABLE FOR PUBLIC USE AND IN A CONDITION MEETING THE APPROVAL OF THE GON OR ITS REPRESENTATIVE.
6. ALL EXCESS OR UNSUITABLE MATERIALS SHALL BE DISPOSED OF OFF SITE AT AN APPROVED FACILITY.
7. ALL MATERIALS OR EQUIPMENT SHIPPED TO CORAL HARBOUR SHALL BE DELIVERED TO AN APPROVED SITE ESTABLISHED AT THE PRE-CONSTRUCTION MEETING.
8. ALL CONSTRUCTION ACTIVITIES AFFECTING THE HAMLET'S OPERATIONS SHALL BE DISCUSSED IN ADVANCE WITH THE HAMLET'S AUTHORITIES AND IT'S REPRESENTATIVES.

REGULATORY REQUIREMENTS:

1. ALL REGULATORY APPROVALS MUST BE IN PLACE BEFORE THE CONTRACTOR IS ALLOWED TO COMMENCE CONSTRUCTION ACTIVITIES.
2. THE CONTRACTOR SHALL BE RESPONSIBLE FOR PROVIDING AND FOLLOWING ITS OWN ENVIRONMENTAL MANAGEMENT PLAN.
3. AS THIS PROJECT INCLUDES CONSTRUCTION ACTIVITIES ON AN ACTIVE ROAD, ALL CONSTRUCTION ACTIVITIES SHALL BE UNDERTAKEN IN A MANNER APPROVED BY THE GON OR ITS REPRESENTATIVE.
4. THE CONTRACTOR IS TO FAMILIARIZE WITH THE REQUIREMENTS IN THE CONSTRUCTION ENVIRONMENTAL MANAGEMENT PLAN.

BRIDGE DESIGN SPECIFICATIONS:

1. FOR CROSSING 7 DESIGN A 30 m SINGLE SPAN, TWIN STEEL GIRDER BRIDGE WITH A TIMBER DECK, PRECAST CONCRETE BALLAST WALLS AND PRECAST CONCRETE FOOTINGS TO CAN/CSA-S6-14 AND THE BC MINISTRY OF FORESTS, LANDS AND NATURAL RESOURCES OPERATIONS BRIDGE DESIGN STANDARDS AND DRAWINGS.
2. BRIDGE TO BE DESIGN FOR THE CL-625 LOADING IN ACCORDANCE WITH XXX.
3. BRIDGE LENGTH OF 30 m OUT TO OUT.
4. BRIDGE CLEAR WIDTH BETWEEN CURBS OF 4.876 m
5. NO SKEW
6. DECK TYPE: TIMBER (STD-EC-XXX-XX)
7. BARRIER SYSTEM: TBD
8. DECK BALLAST WALL INTERFACE (STD-EC-XXX-XX)
9. PRECAST CONCRETE BALLAST WALL, BASE PLATES, BEARINGS AND PRECAST CONCRETE FOOTINGS (STD-ED-XXX-XX).
10. PROVIDE DETAILED CALCULATIONS AND DESIGN DRAWINGS FOR BRIDGE COMPONENTS AS DESCRIBED IN XXXX.

MATERIAL SPECIFICATIONS:

1. STEEL PLATES AND SECTIONS: TO CAN/CSA-G40.21 TYPE 350AT, CATEGORY 3 FOR GIRDERS AND TYPE 350A, CATEGORY 3 FOR OTHER COMPONENTS.
2. TIMBER DECK TIES TO BE TREATED DOUGLAS FIR GRADE XX.

FABRICATION SPECIFICATIONS:

BRIDGE IDENTIFICATION PLATE

1. THE BRIDGE SUPERSTRUCTURE SHALL HAVE ITS STRUCTURE NUMBER, LOAD RATING, DATE OF MANUFACTURE AND MANUFACTURER'S NAME CLEARLY STAMPED OR PERMANENTLY MARKED ON AT LEAST ONE SIDE OF THE STRUCTURE.
- CERTIFICATION AND QUALITY CONTROL**
2. CONTRACTOR TO PROVIDE MILL CERTIFICATES FOR ALL STEEL USED IN THE STRUCTURE.
 3. CSA CERTIFICATION STANDARDS SHALL APPLY THROUGHOUT THE DURATION OF THE PROJECT FROM THE TIME OF TENDER OPENING THROUGH TO MANUFACTURING.

CERTIFICATION AND QUALITY CONTROL

[illegible]

Specifications	Item No.	Item Description	Unit	Est. Quantity	CO#1	CO#2	Final
Preliminaries							
	1	Mob / Demob / Temporary Facilities - Security, Traffic Control Barricades, Quality Control, etc.	lump sum	1			
	2	Post construction Survey	lump sum	1			
Phase 1 - Construction of Temporary Bypass Road at Crossing #7							
	3	Dewatering	lump sum	1			
	4	Clearing and Grubbing	sq.m	990			
	5	Supply and Place Crushed Gravel	cu.m	770			
Phase 2 - Removal and Upgrade of Existing Bridge at Crossing #7							
	6	Remove Existing 13.6 m Bridge	lump sum	1			
	7	Remove and Dispose Existing Gabion Basket Abutments and Concrete Wingwalls	lump sum	1			
	8	Excavate and Onsite Disposal	cu.m	1,500			
	9	Supply and Install Concrete Sill	each	2			
	10	Supply and Place Rip Rap (Class 100 kg)	cu.m.	400			
	11	Supply and Install 30 m Single-Lane Bridge	each	1			
	12	Raise Road Profile	cu.m	1,860			
Phase 3 - Relocation of Temporary Bypass Road to Crossing #4							
	13	Clearing and Grubbing	sq.m	990			
	14	Remove and Place Crushed Gravel	cu.m	770			
Phase 4 - Culvert Removal and Installation of Bridge at Crossing #4							
	15	Remove and Dispose of Culverts	each	8			
	16	Excavation and Onsite Disposal	cu.m	500			
	17	Supply and Install Corrugated Metal Abutment	each	2			
	18	Strip and Paint Girders of Existing Bridge	lump sum	1			
	19	Supply and Install Concrete Sill	each	2			
	20	Replace Existing Timber Deck	lump sum	1			
	21	Install 13.6 m Bridge	lump sum	1			
	22	Supply and Place Rip Rap (Class 100 kg)	cu.m.	180			
	23	Remove Existing Culvert (Crossing 5 and 6)	each	3			
	24	Raise Road Profile	cu.m	500			
Phase 5 - Replace Culvert Crossing 9, Removal of Culvert Crossing 10							
	25	Clearing and Grubbing	sq.m	270			
	26	Remove and Place Crushed Gravel	cu.m	210			
	27	Remove and Dispose of Existing Culverts (Crossing 9, 9a, and 10)	each	3			
	28	Install 1200 mm CSP	each	3			
	29	Remove and Place Crushed Gravel	cu.m	210			
Miscellaneous							
	30	Sediments and Erosion Control Measures	lump sum	1			
	31	New Roadway Signage	each	10			
	32	Supply and Install Barrier Rail	m	240			

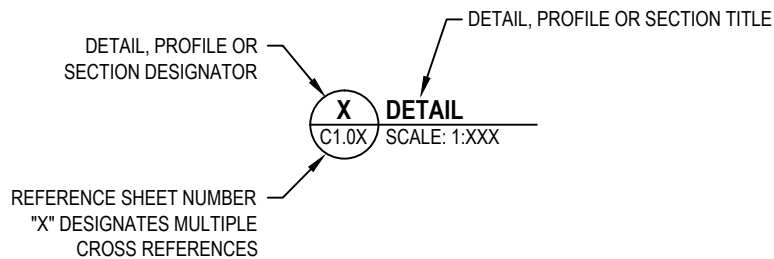
[illegible]

DESCRIPTION OF WORK:

- REMOVAL OF EXISTING 13.6 m BRIDGE
- REMOVAL OF EXISTING ABUTMENTS AND STRUCTURES (CONCRETE WINGWALLS, GABION BASKETS ETC.)
- CONSTRUCTION OF BRIDGE ABUTMENTS AND ERECTION OF NEW 30 m BRIDGE
- RAISING THE ROAD PROFILE TO MATCH PROPOSED BRIDGE GRADES
- INSTALLATION OF NEW GUARDRAILS

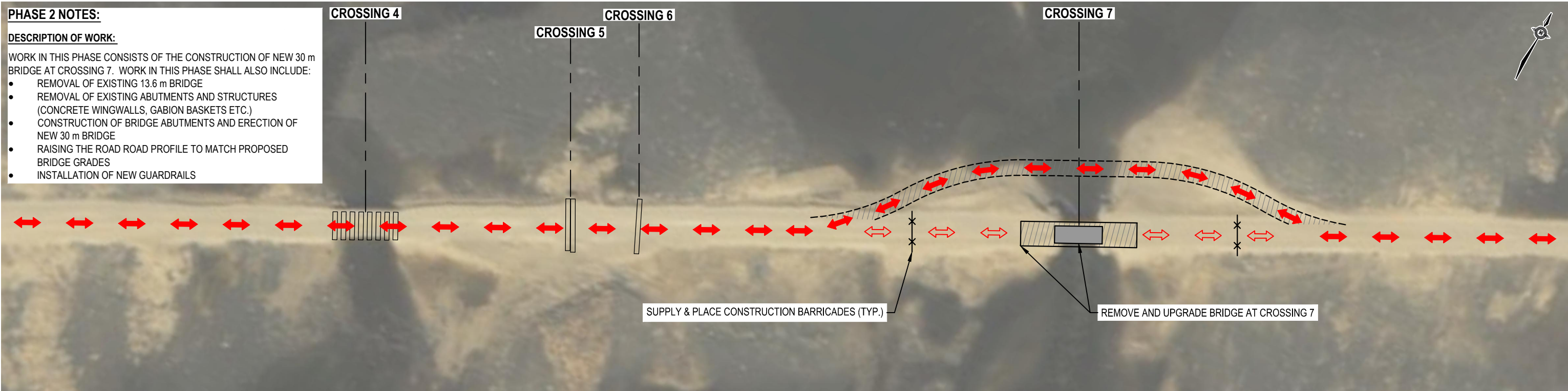

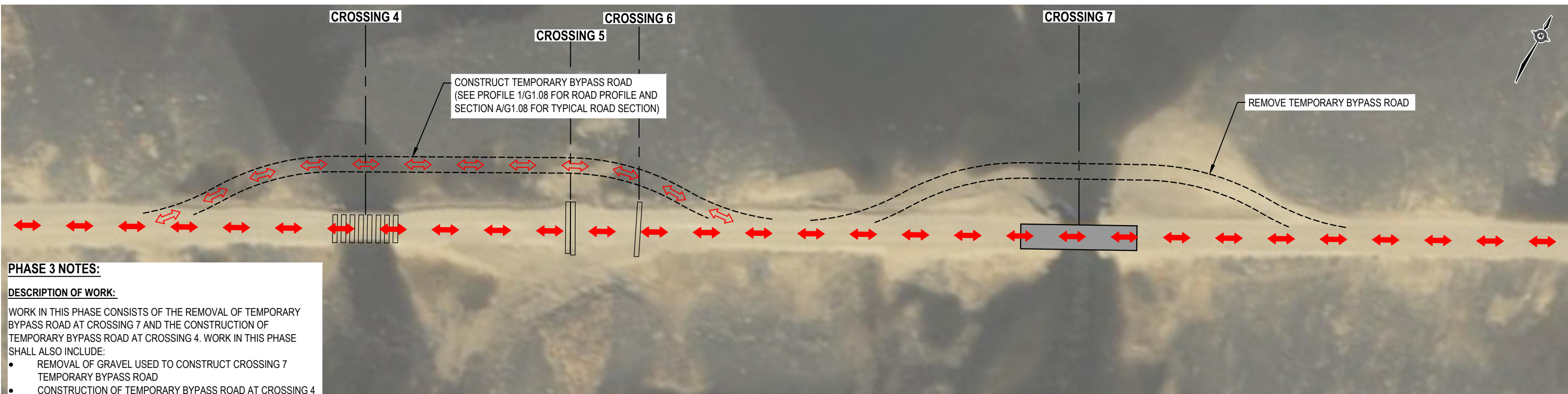

DESCRIPTION OF WORK:

- REMOVAL OF GRAVEL USED TO CONSTRUCT CROSSING 7 TEMPORARY BYPASS ROAD
- CONSTRUCTION OF TEMPORARY BYPASS ROAD AT CROSSING 4 WITH GRAVEL FROM CROSSING 7 TEMPORARY BYPASS ROAD.

NOTES

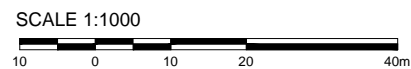
[illegible]

CLIENT

BUCKLAND
& TAYLOR

AIRPORT RD. WASHOUT REHABILITATION CORAL HARBOUR, NU

PHASING PLAN PHASE 2 & 3

PROJECT NO.	V13203282
-------------	-----------

DATE
February 1, 2016

OFFICE
VANC

SHEET N
of

DES
MAN

DWN
JDM

CKD
DNM

APP
DNMREV
0

STATUS

DRAWING

G1.05

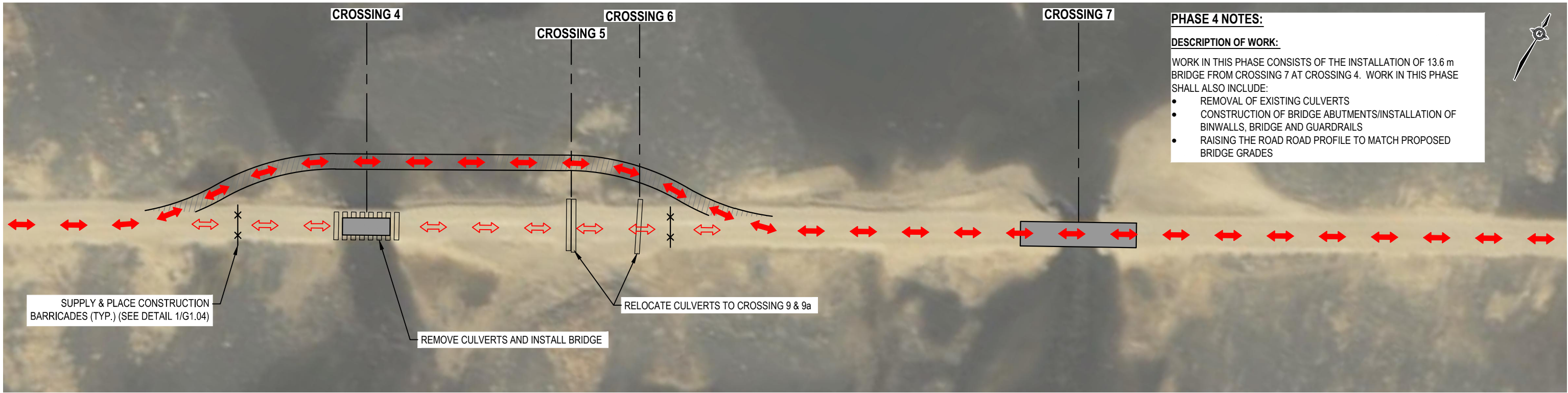

PHASE 4 NOTES:

DESCRIPTION OF WORK:

WORK IN THIS PHASE CONSISTS OF THE INSTALLATION OF 13.6 m BRIDGE FROM CROSSING 7 AT CROSSING 4. WORK IN THIS PHASE SHALL ALSO INCLUDE:

- REMOVAL OF EXISTING CULVERTS
- CONSTRUCTION OF BRIDGE ABUTMENTS/INSTALLATION OF BINWALLS, BRIDGE AND GUARDRAILS
- RAISING THE ROAD ROAD PROFILE TO MATCH PROPOSED BRIDGE GRADES

PHASE 4

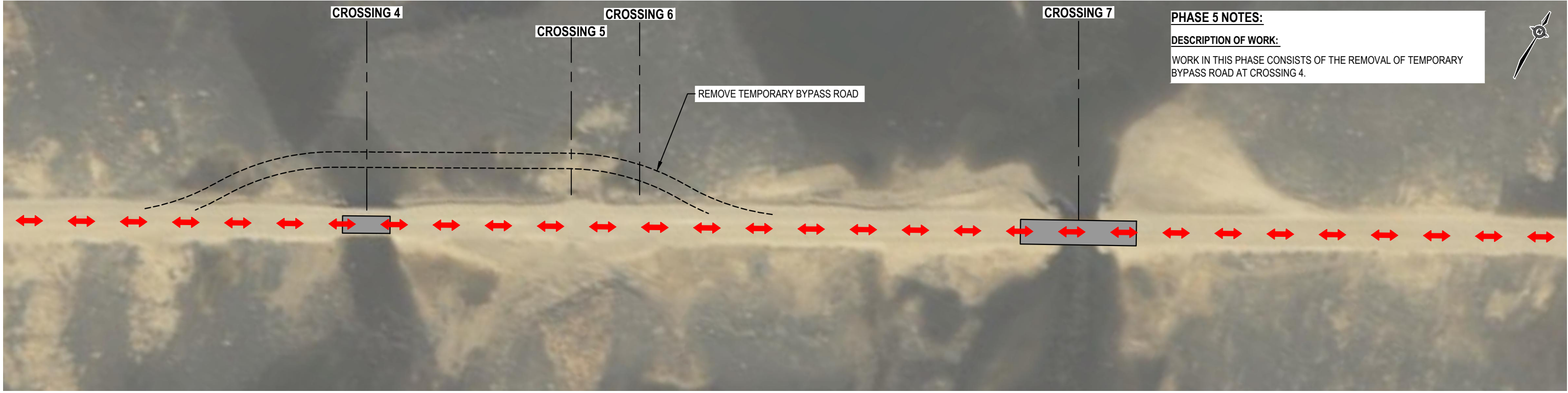

PHASE 5 NOTES:

DESCRIPTION OF WORK:

WORK IN THIS PHASE CONSISTS OF THE REMOVAL OF TEMPORARY BYPASS ROAD AT CROSSING 4.

PHASE 5

LEGEND

↔ PUBLIC TRAFFIC/ACCESS

↔ CONSTRUCTION TRAFFIC/ACCESS

SCALE 1:1000

NOTES

NUM	DATE	DWN	CKD	APR	DESCRIPTION
0	2/1/16	JDM	DNM	DNM	DESIGN DRAWINGS

REVISIONS

PROFESSIONAL SEAL

CLIENT

TETRA TECH EBA BUCKLAND & TAYLOR COWI

AIRPORT RD. WASHOUT REHABILITATION CORAL HARBOUR, NU					
PHASING PLAN PHASE 4 & 5					
PROJECT NO. V13203282	OFFICE VANC	DES MAN	CKD DNM	REV 0	DRAWING G1.06
DATE February 1, 2016	SHEET No. of	DWN JDM	APP DNM	STATUS -	

WORK IN THIS PHASE CONSISTS OF THE CONSTRUCTION OF TEMPORARY BYPASS ROADS AT CROSSING 9, 9a AND 10.

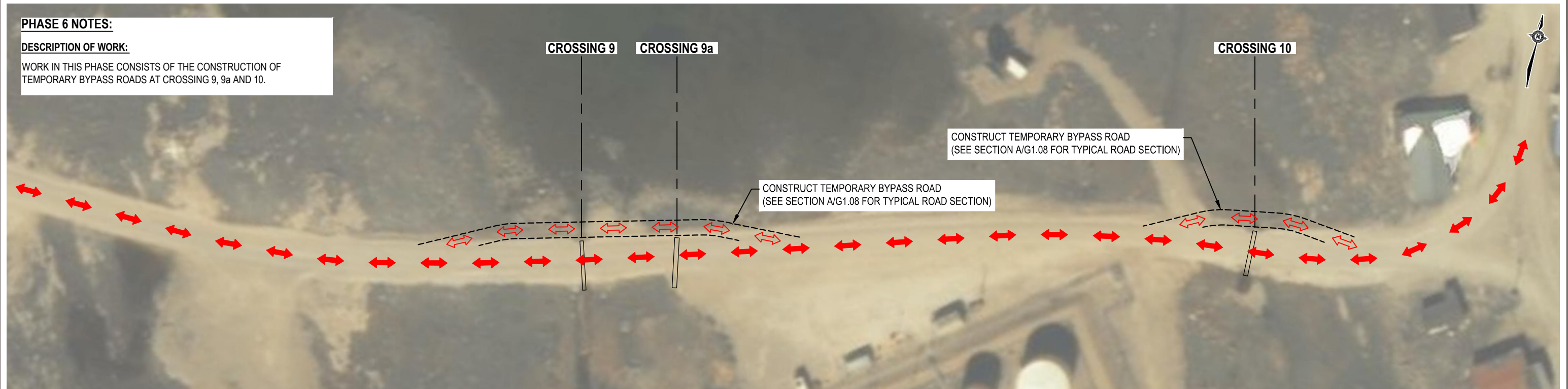

WORK IN THIS PHASE CONSISTS OF THE REMOVAL AND REPLACEMENT OF EXISTING CULVERTS. WORK IN THIS PHASE SHALL INCLUDE:

- REMOVAL OF EXISTING CULVERTS FROM CROSSING 9, 9a & 10
- INSTALLATION OF 3 CULVERTS FROM CROSSING 5 & 6 AT CROSSING 9.
- BACKFILL OF AIRPORT RD AT CROSSING 9a & 10
- REMOVAL OF TEMPORARY BYPASS ROADS AT CROSSING 9 AND 10.

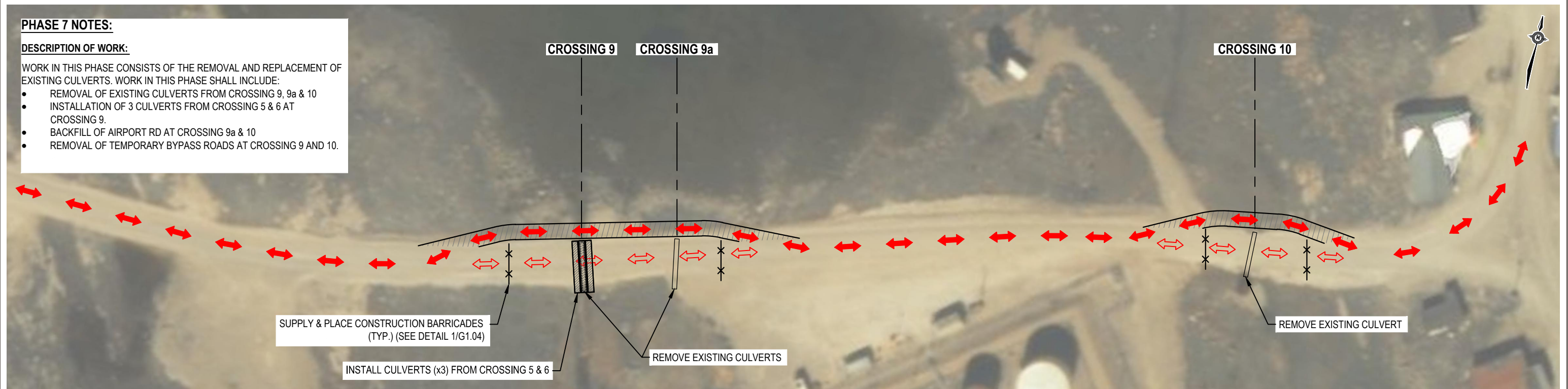

 PUBLIC TRAFFIC/ACCESS

 CONSTRUCTION TRAFFIC/ACCESS

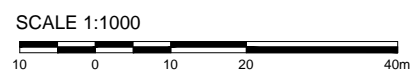
[illegible]

	CLIENT
--	--------



**AIRPORT RD. WASHOUT REHABILITATION
CORAL HARBOUR, NU**

PHASING PLAN PHASE 6 & 7

PROJECT NO. V13203282	OFFICE VANC	DES MAN	CKD DNM	REV 0	DRAWING G1.07
DATE February 1, 2016	SHEET No. of	DWN JDM	APP DNM	STATUS -	

G1.07

Q:\Vancouver\Drafting\Engineering\132\13203282\13203282 - Coral Harbour Airport Rd Environmental Application, RD.dwg [G1.08] February 01, 2016 - 4:42:56 pm (BY: MANG, JUSTIN)

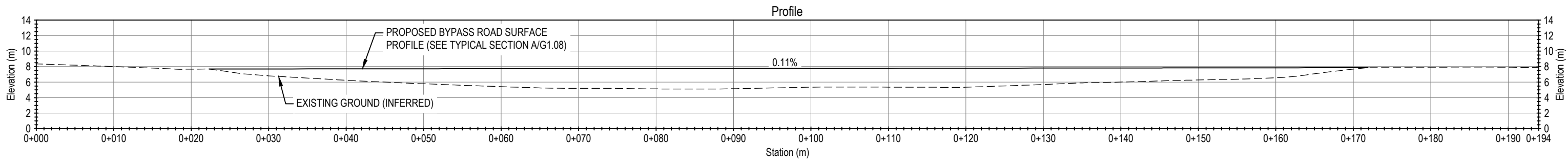

1 CROSSING 4 BYPASS ROAD
G1.08 SCALE: 1:500

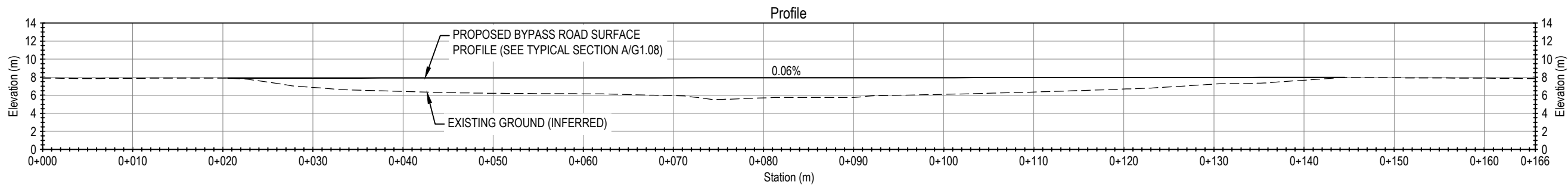

2 CROSSING 7 BYPASS ROAD
G1.08 SCALE: 1:500

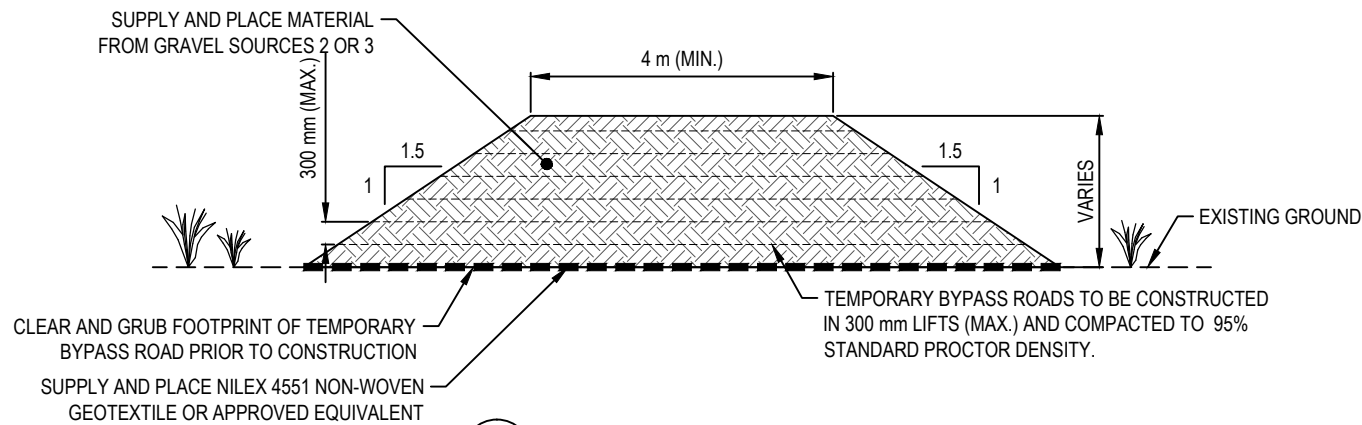

A TYPICAL BYPASS ROAD SECTION
G1.08 SCALE: 1:100

NOTES:

- CONTRACTOR IS TO ENSURE DRIVING SURFACES ARE MAINTAINED TO A CONDITION SATISFACTORY TO THE GON OR IT'S REPRESENTATIVE. TEMPORARY BYPASS ROADS SHALL BE FREE OF POTHOLES AND CROSS GRADES IN EXCESS OF 1.0%.
- THE CONTRACTOR MAY BE REQUIRED BY THE GON OR IT'S REPRESENTATIVE TO RE-GRADE THE SURFACE OF THE TEMPORARY ROADS AT NO ADDITIONAL COST TO THE GON.

LEGEND

NOTES

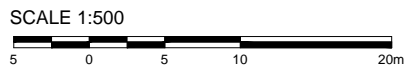

NUM	DATE	DWN	CKD	APR	DESIGN DRAWINGS	DESCRIPTION
0	2/1/16	JDM	DNM	DNM	DESIGN DRAWINGS	
REVISIONS						

CLIENT



TETRA TECH EBA



BUCKLAND & TAYLOR



COWI

**AIRPORT RD. WASHOUT REHABILITATION
CORAL HARBOUR, NU**

**BYPASS ROADS
PROFILES AND TYPICAL SECTION**

PROJECT NO. V13203282	OFFICE VANC	DES MAN	CKD DNM	REV 0	DRAWING G1.08
DATE January 26, 2016	SHEET No. of	DWN JDM	APP DNM	STATUS -	

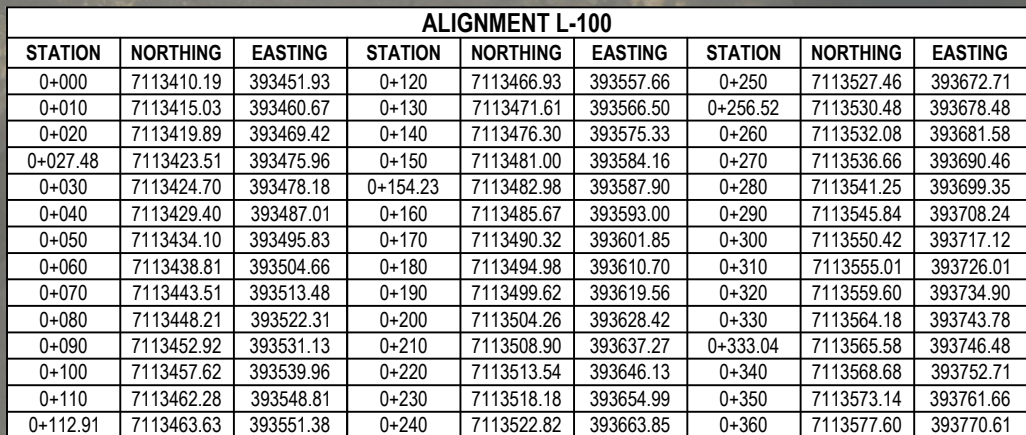

SITE PLAN
SCALE: 1:2000

NOTES

- [illegible]

OVERALL SITE PLAN

C1.00

PROFESSIONAL SEAL

Q:\Vancouver\Drafting\Engineering\132\13203282\13203282 - Coral Harbour Airport Rd Environmental Application, RD.dwg [C1.02] February 01, 2016 - 4:43:38 pm (BY: MANG, JUSTIN)

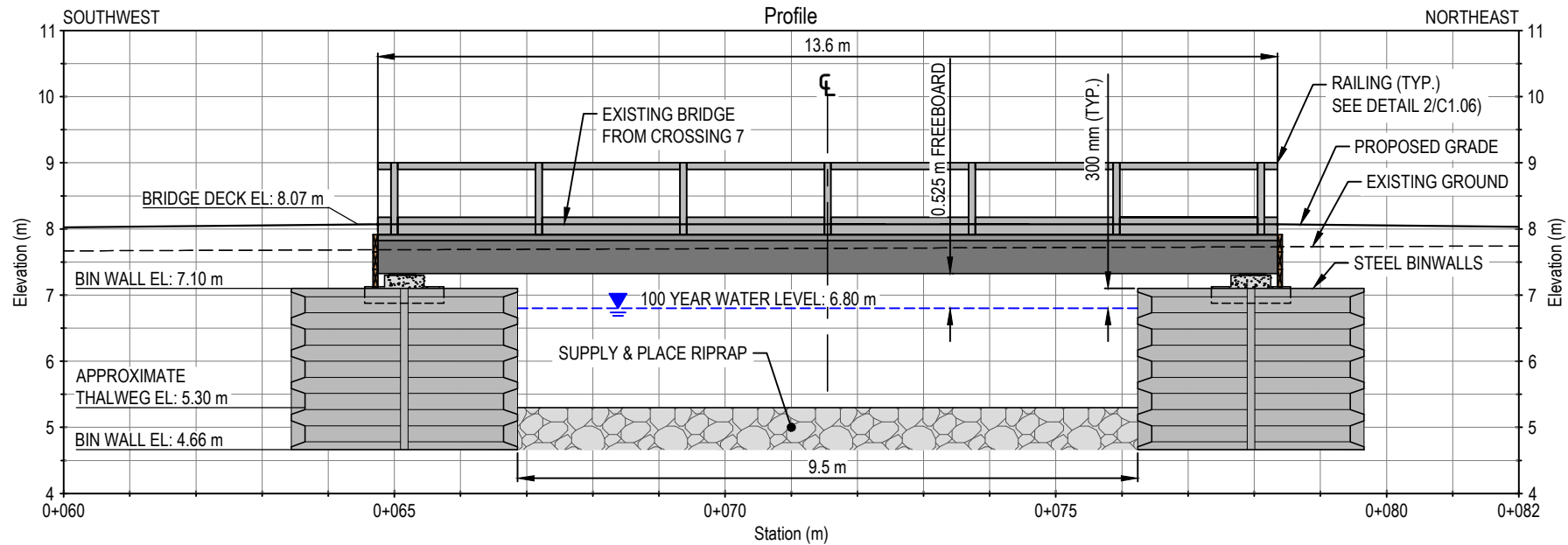

ELEVATION
SCALE: 1:100

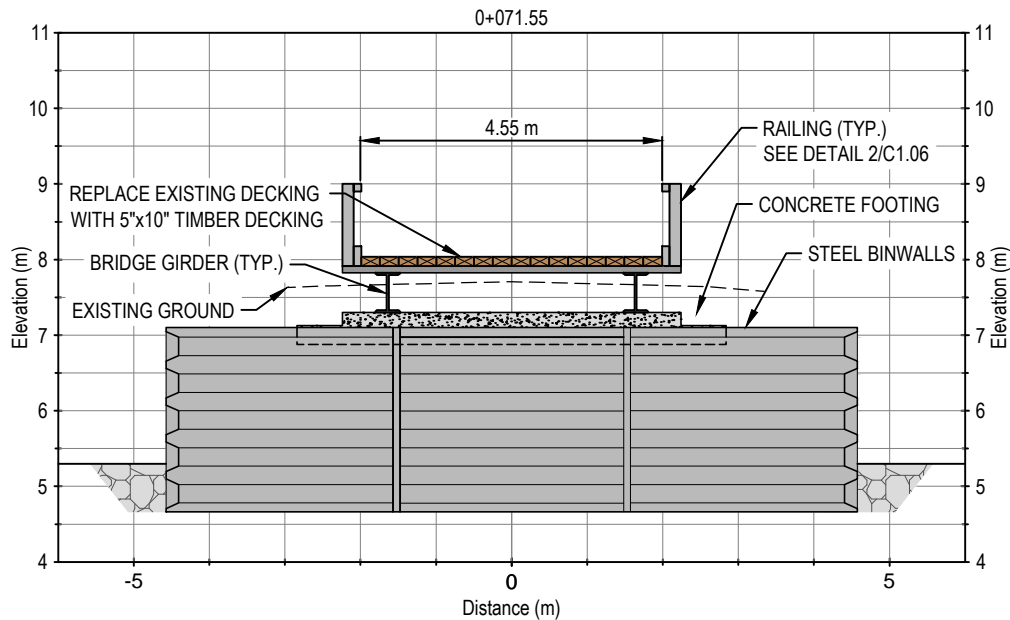

SECTION
SCALE: 1:100

DESIGN SPEED: 60 km/h

LEGEND

NOTES



NUM	DATE	DWN	CKD	APR	DESCRIPTION
0	2/1/16	JDM	DNM	DNM	DESIGN DRAWINGS
REVISIONS					

CLIENT



TETRA TECH EBA



BUCKLAND & TAYLOR



AIRPORT RD. WASHOUT REHABILITATION
CORAL HARBOUR, NU

CROSSING 4
BRIDGE ELEVATION AND SECTION

PROJECT NO. V13203282	OFFICE VANC	DES MAN	CKD DNM	REV 0	DRAWING
DATE February 1, 2016	SHEET No. of	DWN JDM	APP DNM	STATUS -	

C1.02

PROFESSIONAL SEAL

Q:\Vancouver\Drafting\Engineering\132\13203282\13203282 - Coral Harbour Airport Rd Environmental Application, RD.dwg [C1.03] February 01, 2016 - 4:43:54 pm (BY: MANG, JUSTIN)

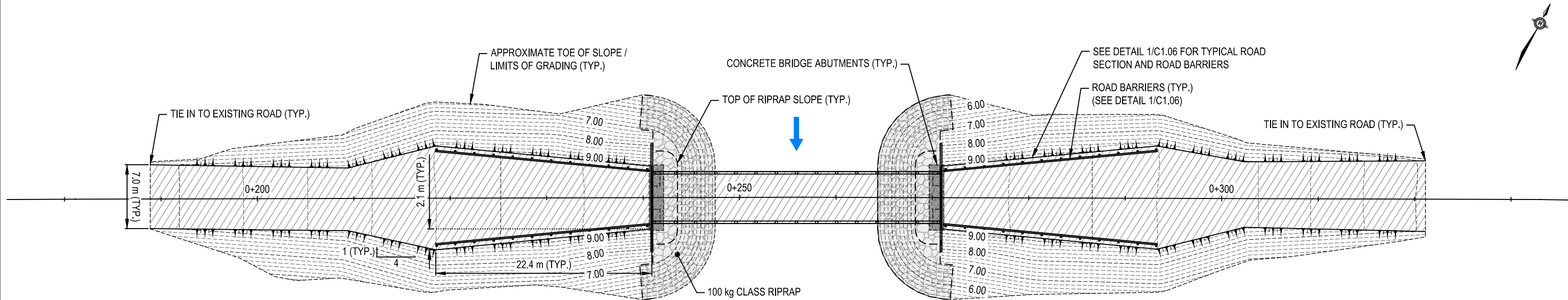

PLAN
SCALE: 1:400

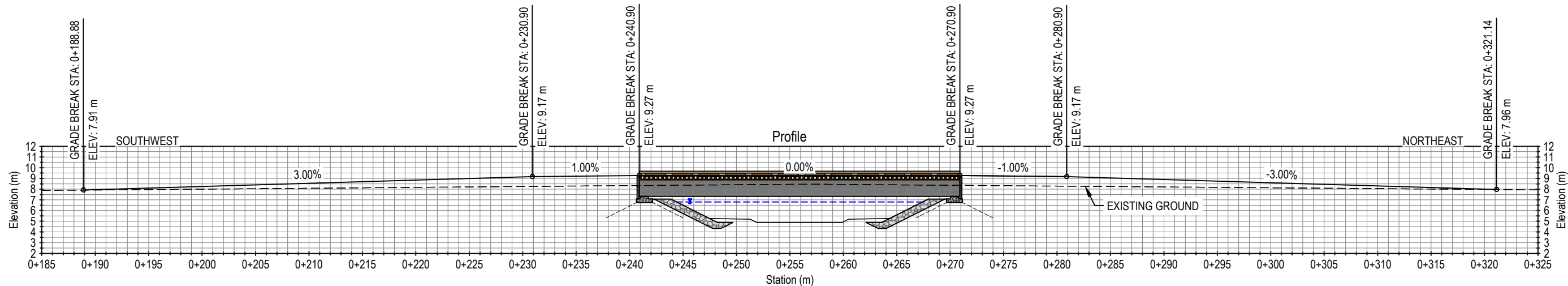

2 CROSSING 7 AIRPORT ROAD
C1.03 SCALE: 1:400

DESIGN SPEED: 60 km/h

ISSUED FOR REVIEW

LEGEND

- Major Contours (1.0 m)
- Minor Contours 0.2 m

NOTES

- Survey of Airport Rd completed by Sub-Arctic Surveys Ltd. on July 29, 2013. Survey extents are limited to Airport Rd prism. Existing ground beyond toe of Airport Rd is inferred and based on site observations.

SCALE 1:400



NUM	DATE	DWN	CKD	APR	DESCRIPTION
0	2/1/16	JDM	DNM	DNM	DESIGN DRAWINGS
REVISIONS					

CLIENT



TETRA TECH EBA



BUCKLAND & TAYLOR



PROJECT NO.
V13203282
DATE
February 1, 2016

OFFICE
VANC
SHEET No.
of

DES
MAN
DWN
JDM

CKD
DNM
APP
DNM

REV
0
STATUS
-

AIRPORT RD. WASHOUT REHABILITATION
CORAL HARBOUR, NU

CROSSING 7
PLAN & PROFILE

C1.03

Q:\Vancouver\Drafting\Engineering\132\13203282\13203282 - Coral Harbour Airport Rd Environmental Application, RD.dwg [C1.05] February 01, 2016 - 4:44:25 pm (BY: MANG, JUSTIN)

CULVERT REMOVAL TABLE					
CROSSING	STATION	CULVERT IN		CULVERT OUT	
		NORTHING	EASTING	NORTHING	EASTING
CROSSING 9	0+041	7113665.62	394296.04	7113653.23	394299.53
CROSSING 9a	0+065.25	7113671.82	394320.13	7113658.92	394322.32
CROSSING 10	0+215.25	7113706.30	394466.83	7113694.45	394466.97

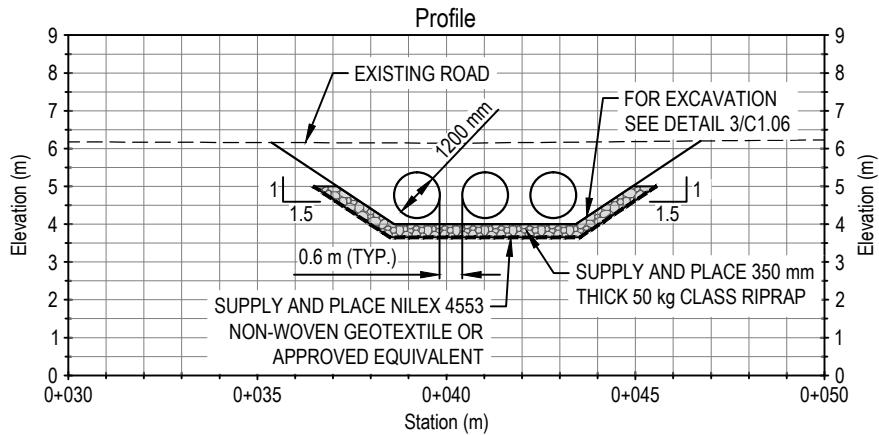
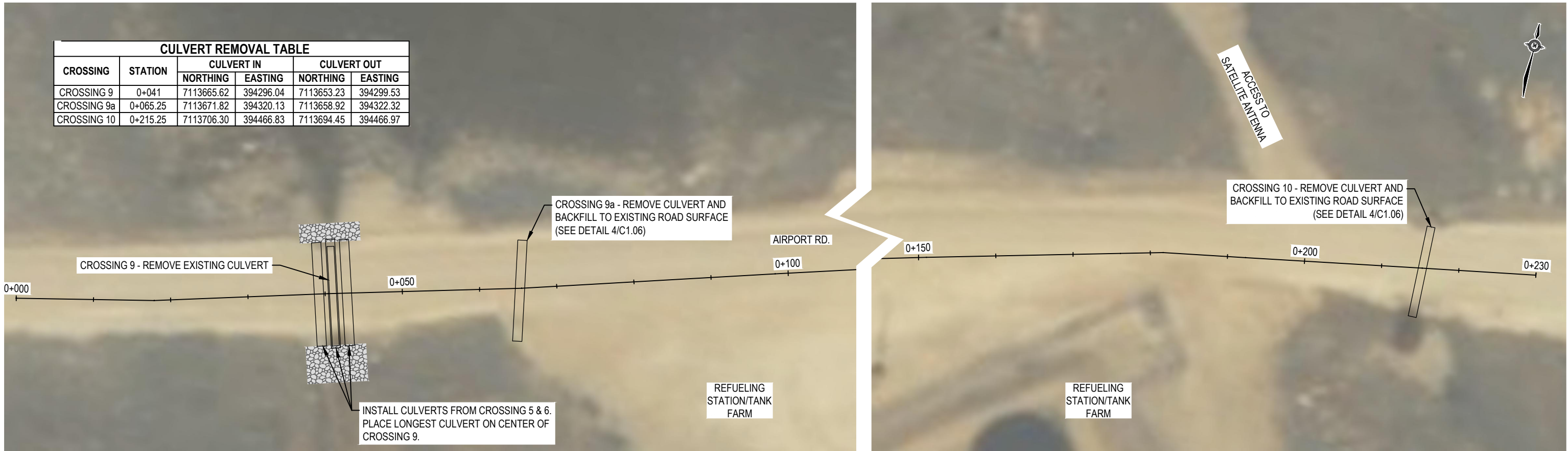

3 CROSSING 9 AIRPORT ROAD PROFILE
C1.05 SCALE: 1:200

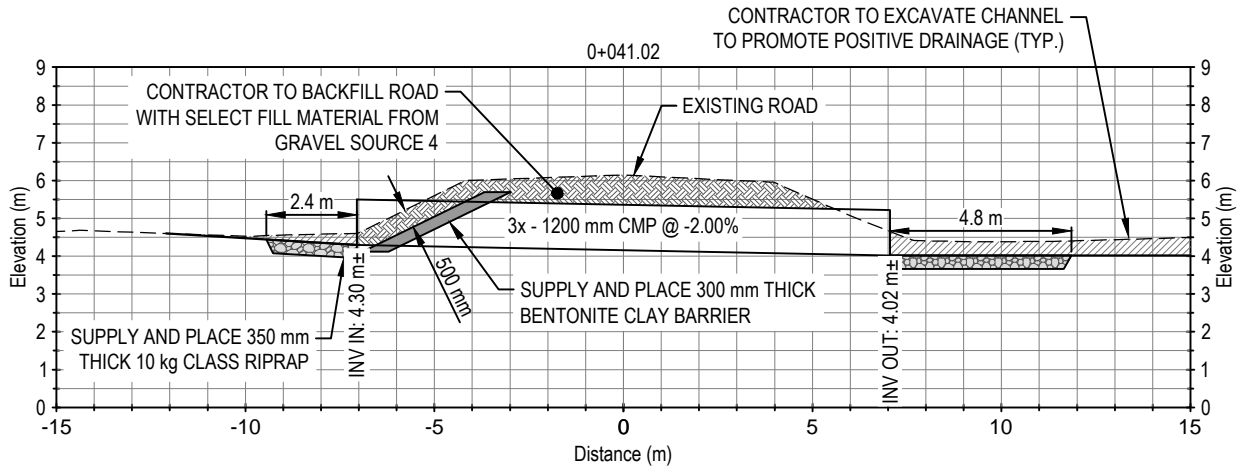

CROSSING 9 CULVERT CROSS SECTION
SCALE: 1:200

DESIGN SPEED: 60 km/h

LEGEND

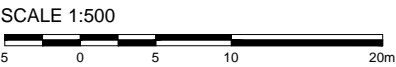

NOTES

- Survey of Airport Rd completed by Sub-Arctic Surveys Ltd. on July 29, 2013. Survey extents are limited to Airport Rd prism. Existing ground beyond toe of Airport Rd is inferred and based on site observations.
- Culvert crossing excavation in channel may vary from what is shown on plans as per Note 1.

NUM	DATE	DWN	CKD	APR	DESCRIPTION
0	2/1/16	JDM	DNM	DNM	DESIGN DRAWINGS
REVISIONS					

PROFESSIONAL SEAL

CLIENT



AIRPORT RD. WASHOUT REHABILITATION
CORAL HARBOUR, NU

CROSSING 9 & 10
CULVERT REMOVAL & REPLACEMENT

PROJECT NO. V13203282	OFFICE VANC	DES MAN	CKD DNM	REV 1	DRAWING
DATE February 1, 2016	SHEET No. of	DWN JDM	APP DNM	STATUS -	C1.05

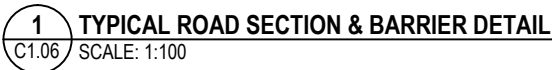

1. FOR "W BEAM" GUARDRAIL DETAIL SEE ALBERTA INFRASTRUCTURE AND TRANSPORTATION DRAWING TEB 3.16a (DETAIL B).



PROJECT NO. V13203282	OFFICE VANC	DES MAN	CKD DNM	REV 0	DRAWING C1.06
DATE February 1, 2016	SHEET No. of	DWN JDM	APP DNM	STATUS -	

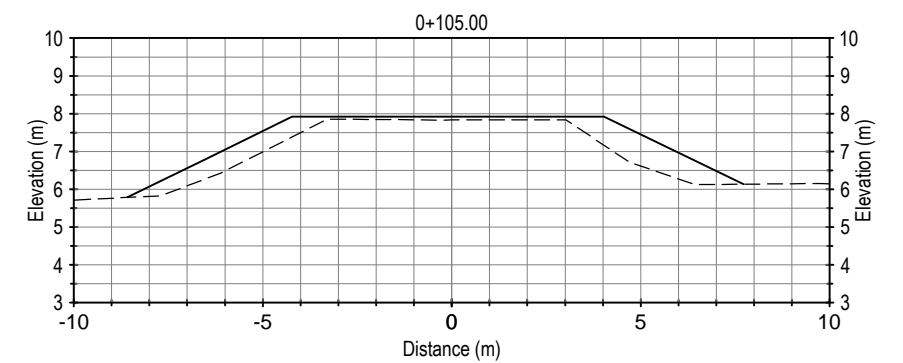
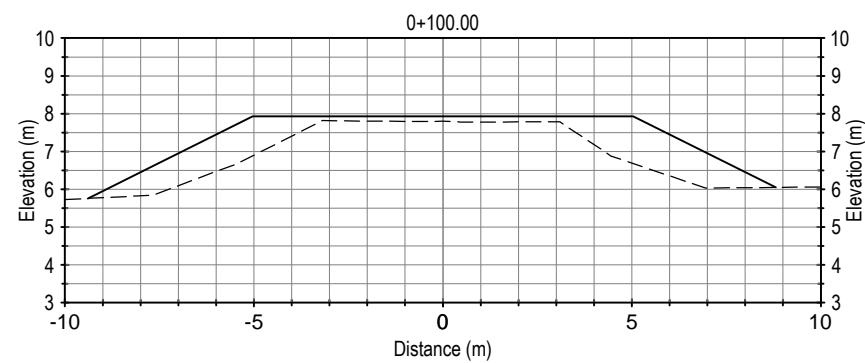
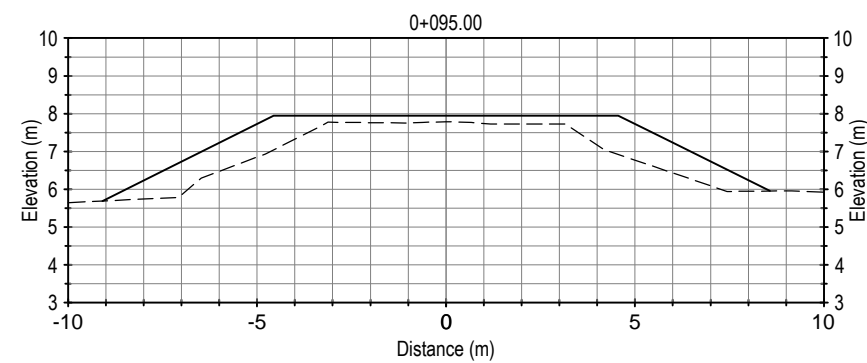
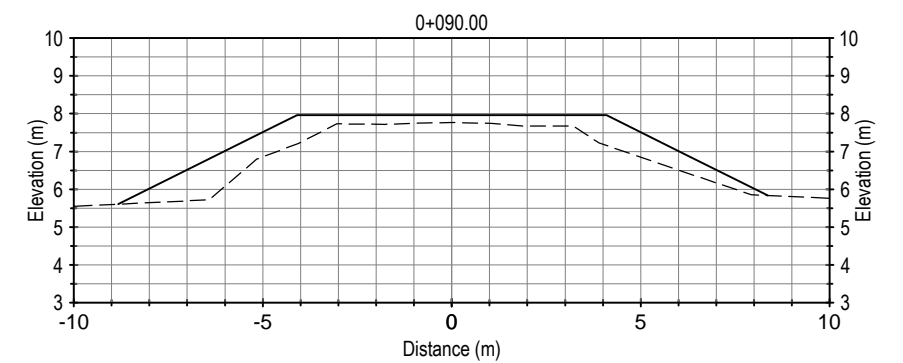
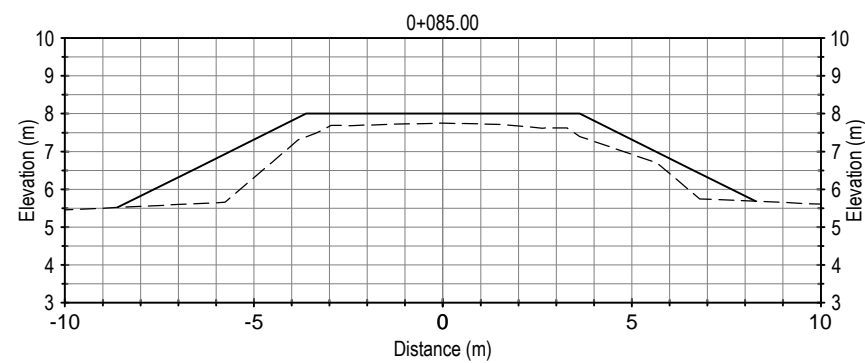
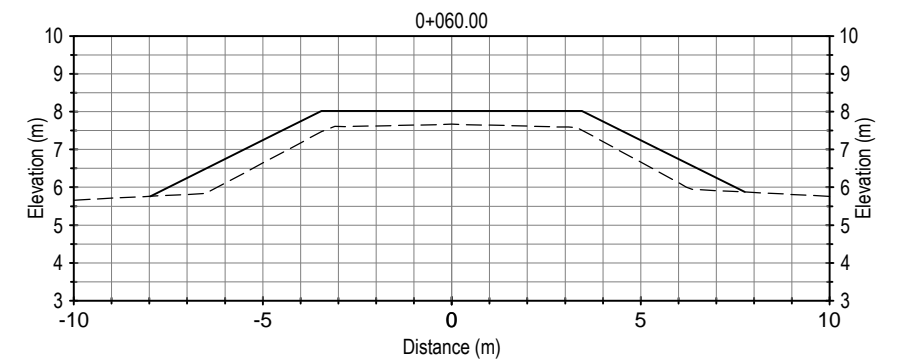
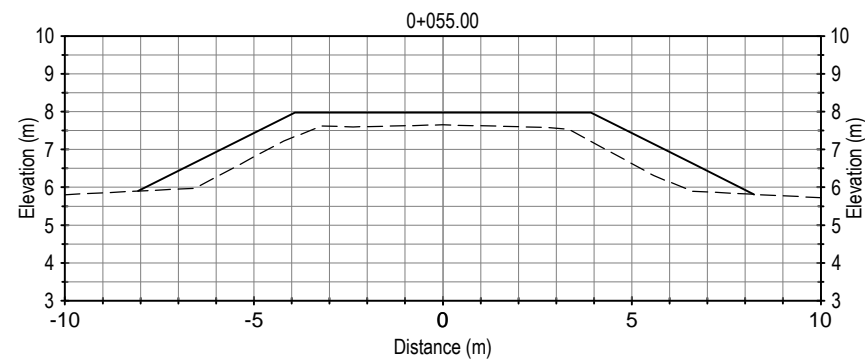
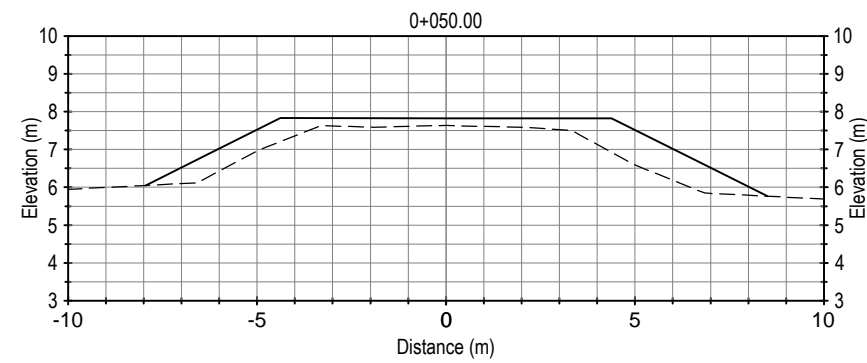
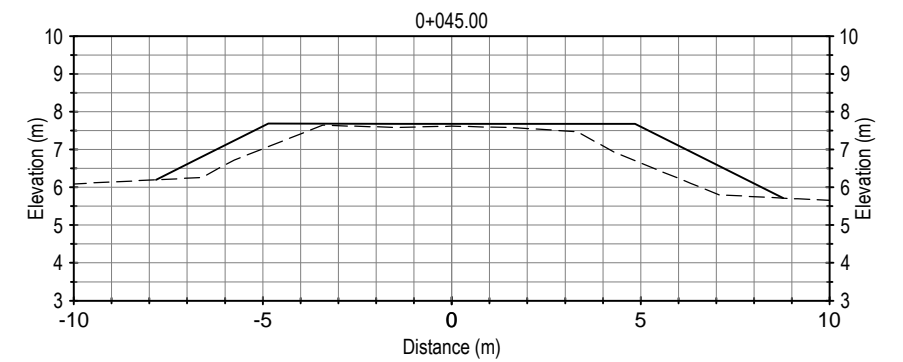
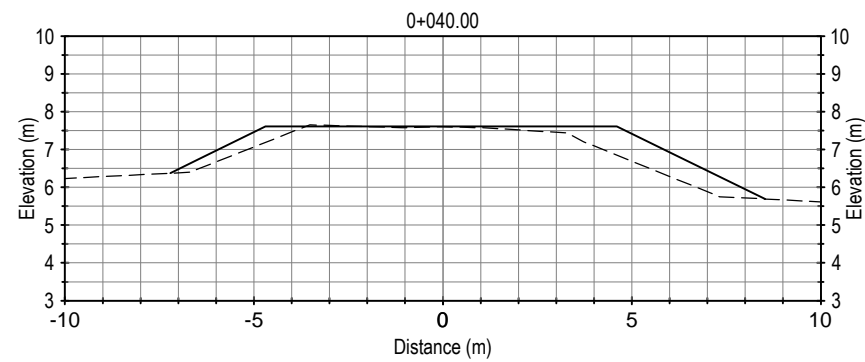
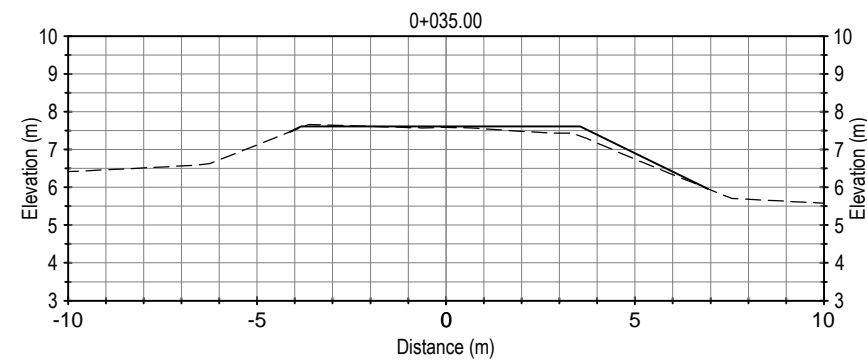

LEGEND

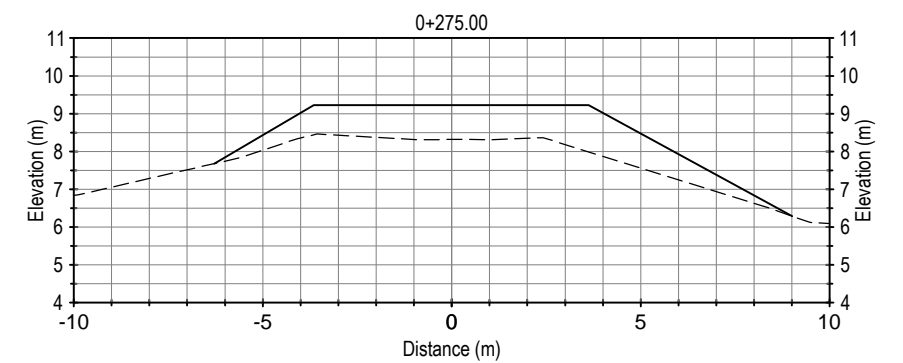
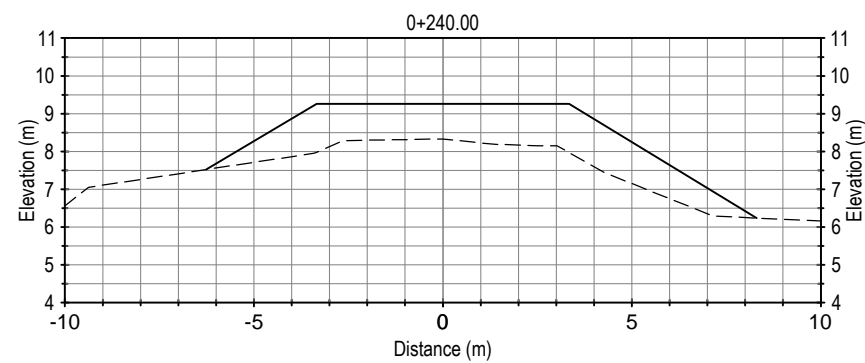
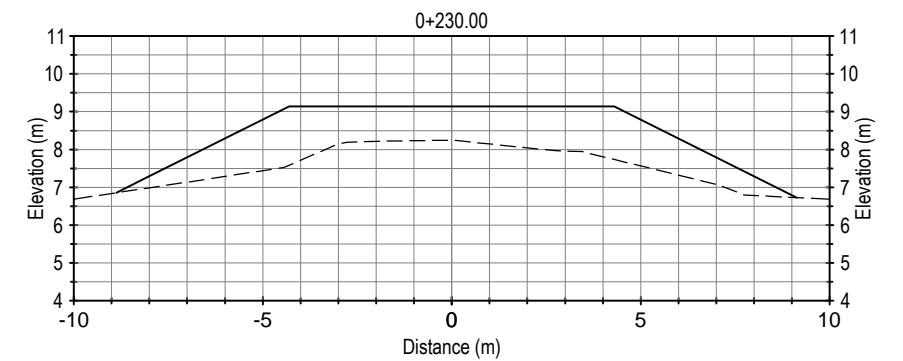
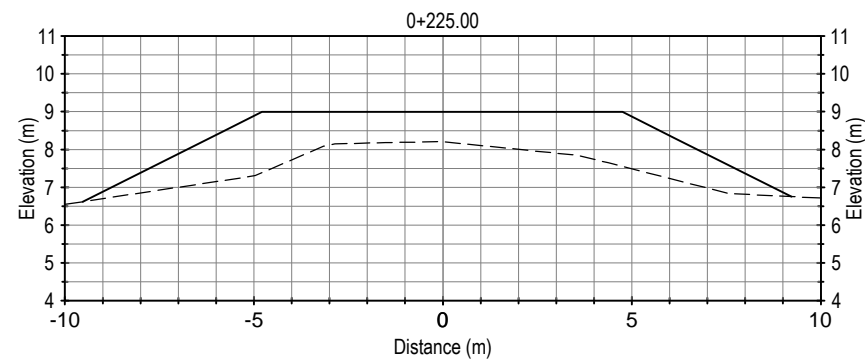
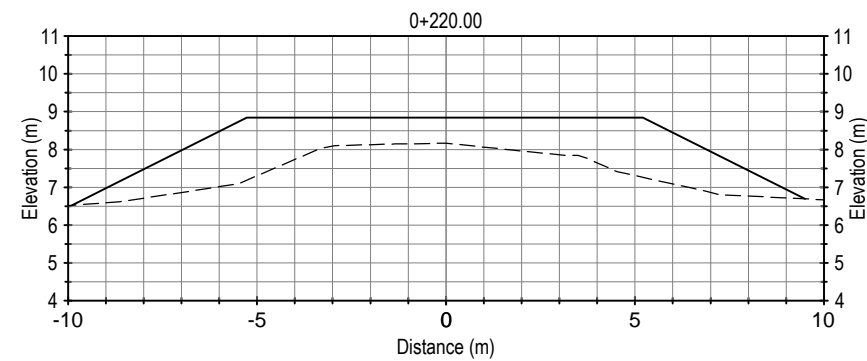
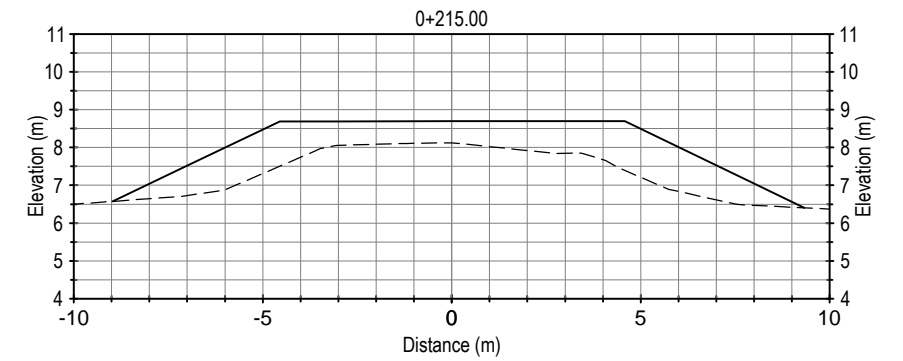
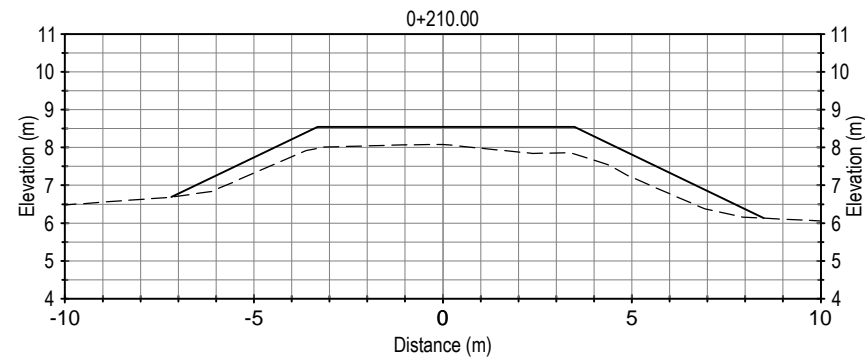
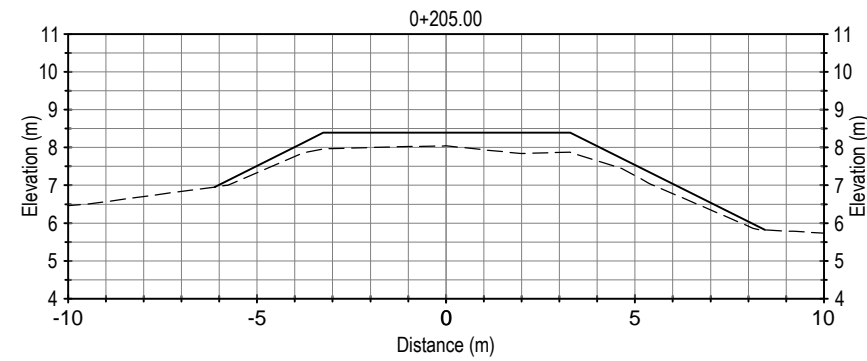
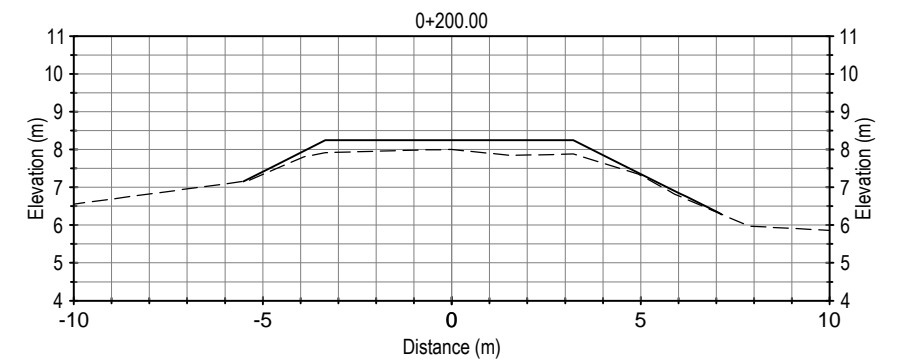
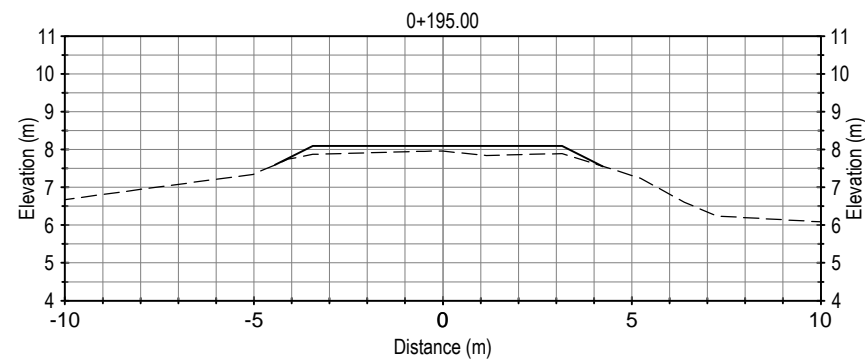
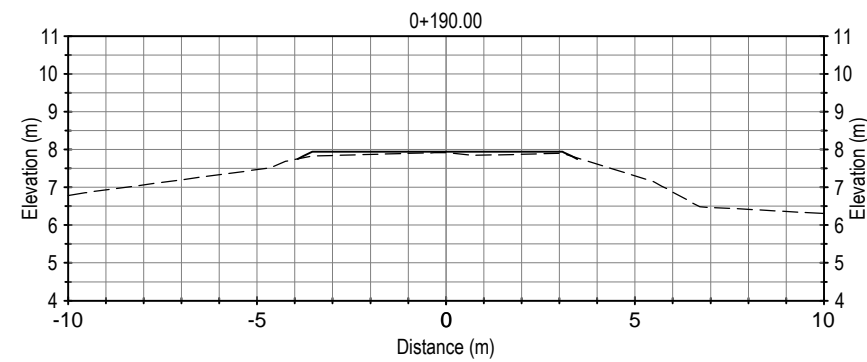

LEGEND

- - - - - Existing Ground
 _____ Finished Ground

SCALE 1:200



NOTES

[illegible]

	CLIENT
--	--------



BUCKLAND & TAYLOR

COWI

**AIRPORT RD. WASHOUT REHABILITATION
CORAL HARBOUR, NU**

CROSSING 7

5 m CROSS SECTIONS

PROJECT NO.	V13203282
-------------	-----------

DATE
February 1, 2016

OFFICE
VANC

	SHEET No
	of

DES	
MAN	

DWN
JDM

CKD	
DNM	

APP	S
DNM	

DRAWING

C1.08

PROFESSIONAL SEAL

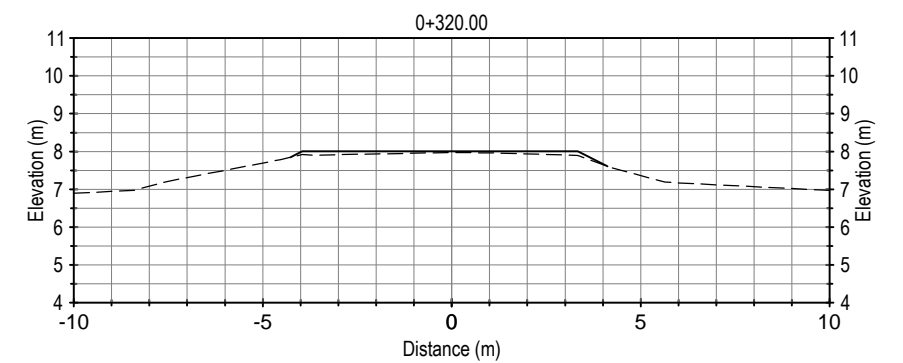
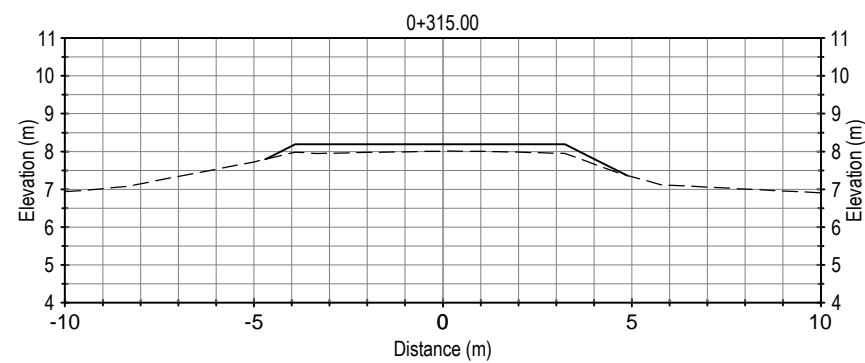
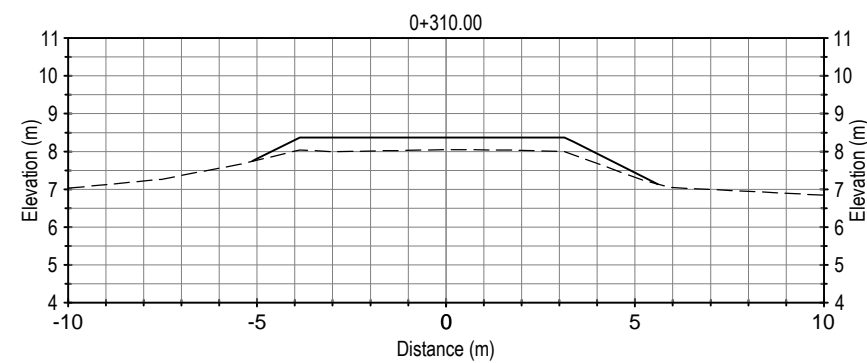
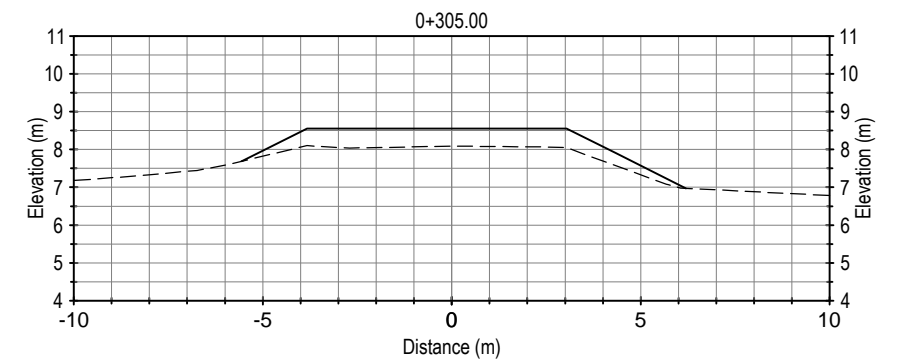
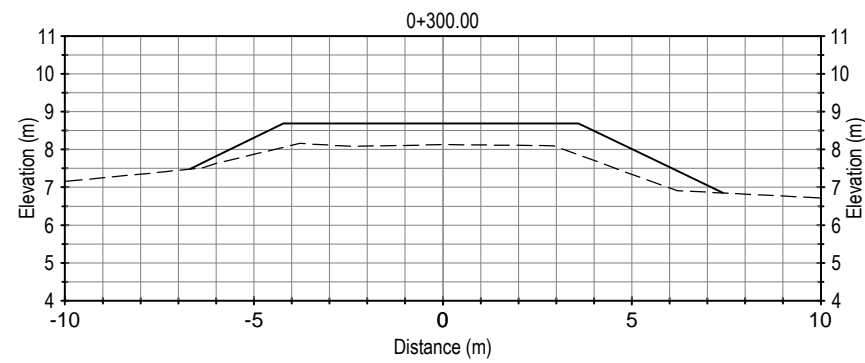
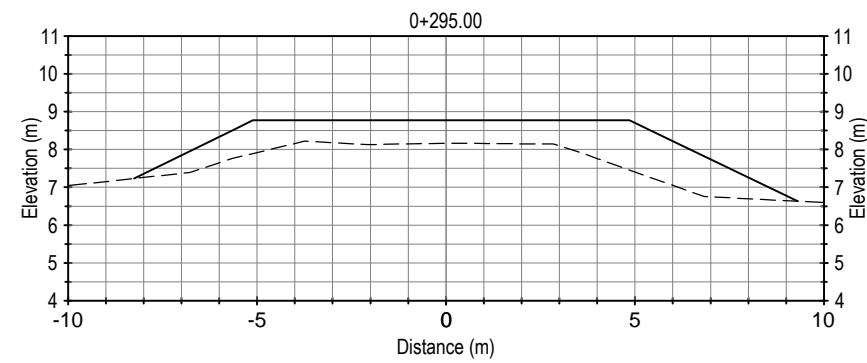
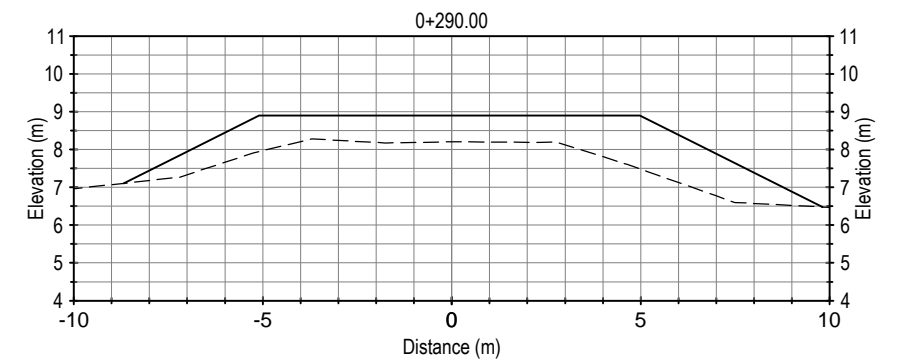
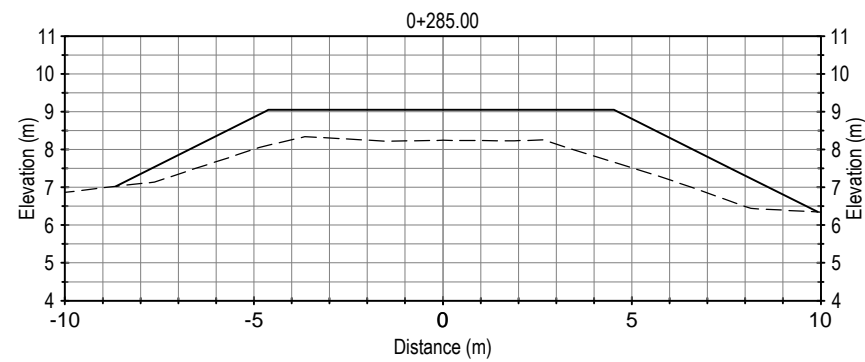
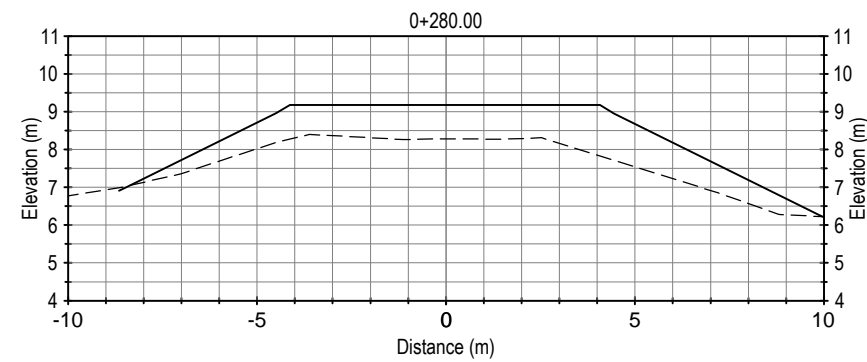

LEGEND

- - - - - Existing Ground
 _____ Finished Ground

SCALE 1:200



NOTES

[illegible]

PROFESSIONAL SEAL

CLIENT



**BUCKLAND
& TAYLOR**

COW

**AIRPORT RD. WASHOUT REHABILITATION
CORAL HARBOUR, NU**

CROSSING 7
5 m CROSS SECTIONS

PROJECT NO.	V13203282
-------------	-----------

OFFICE
VANC

DES
MAN

CKD
DNM

REV
0

DRAWING

DATE
February 1, 2016

	SHEET No
	of

DWN
JDMAPP
DNM

STATU	-
-------	---

C1.09